

2 ELECTRICAL ROOM LAYOUT
1/4"=1'-0"

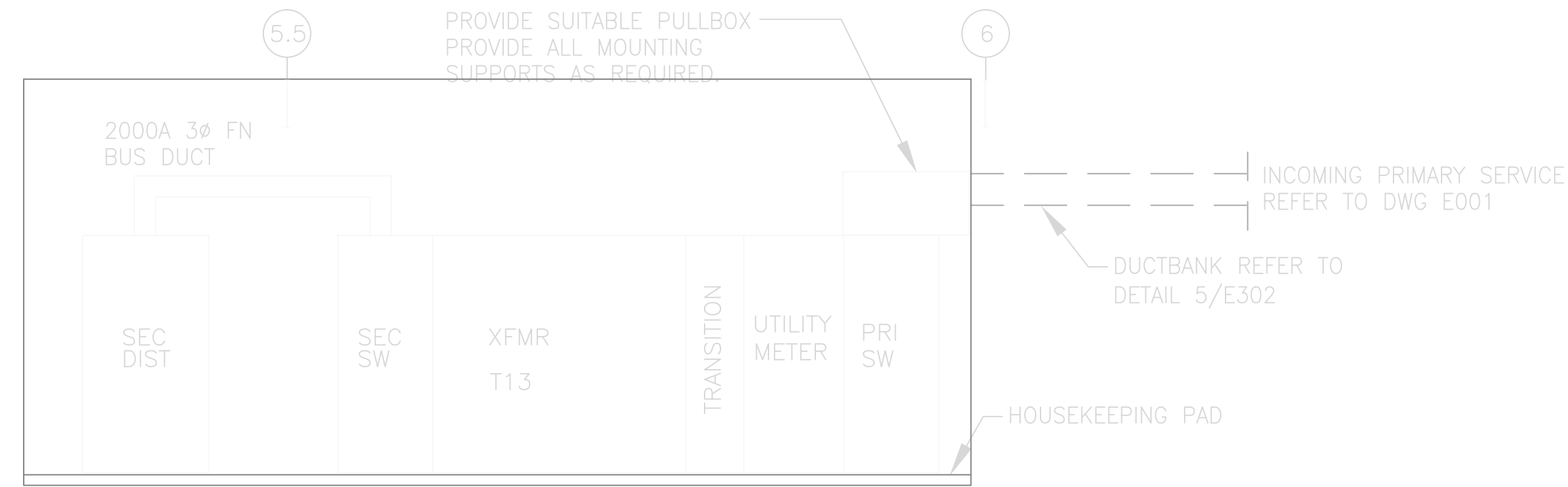

3 ELEVATION OF SUBSTATION
1/4"=1'-0"

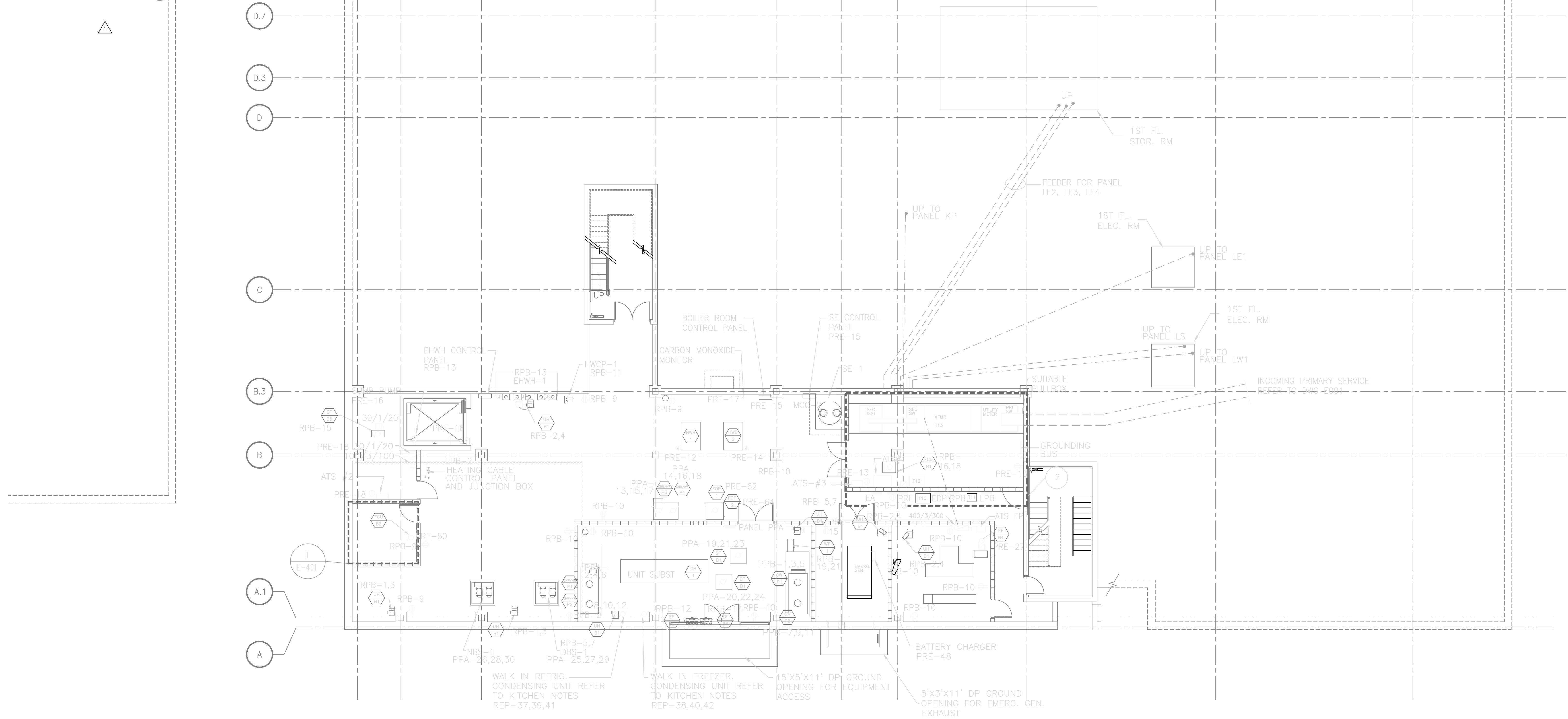

1 BASEMENT PLAN POWER
1/8"=1'-0"

NOTES

1. REFER TO DWG. E001 FOR INCOMING PRIMARY SERVICE.
2. REFER TO DWGS. E500, E501 AND E502 FOR PANEL SCHEDULES.
3. REFER TO DWG. E000 FOR SYMBOLS LIST.
4. REFER TO DWG. E301 FOR EMERGENCY LIGHTING PANEL, WIRING DIAGRAMS AND SCHEDULES.
5. REFER TO DWG. E300 FOR SINGLE LINE DIAGRAM.
6. REFER TO ELECTRICAL ROOM LAYOUT FOR PANEL IDENTIFICATION.
7. PROVIDE A SAFETY SWITCH FOR ALL MECHANICAL EQUIPMENT SIZED PER NEC-SUPPLIED WITH MECHANICAL EQUIPMENT, INSTALLED AND WIRED UNDER ELECTRICAL WORK.



E&M ENGINEERING, INC.
235 PALMONT AVE. STE. #201 HENRICON VALLEY, PA 19008
(215) 467-4900 FAX (215) 467-4901 www.eandmengineers.com

SCHOOL & LOCATION	Commodore John Barry Elementary School 5900 Race Street, Philadelphia PA 19139
PROJECT TITLE	NEW CONSTRUCTION
DRAWING TITLE	BASEMENT PLAN POWER
APPROVED BY	

SCHOOL DISTRICT OF PHILADELPHIA THE SCHOOL REFORM COMMISSION	DEPARTMENT OF DESIGN AND CONSTRUCTION SERVICES
1414 SPRING STREET PHILADELPHIA, PA 19130 (215) 400-4730 FAX (215) 400-4731	CONTRACTOR TO VERIFY ALL CONDITIONS AND DIMENSIONS AT SITE

NO.	DATE	REVISION
9		
8		
7		
6		
5		
4		
3		
2		
1	1/17/07	ADDITION No. 1

SPEC. NO. B-840C of 2005/06	DATE 12/29/06
SCALE 1/8"=1'-0"	LOCATION NO. 120
DRAWN BY CDM	TYPE NO. -
CHECKED BY -	FILE NO. -

DRAWING NO.
E100