

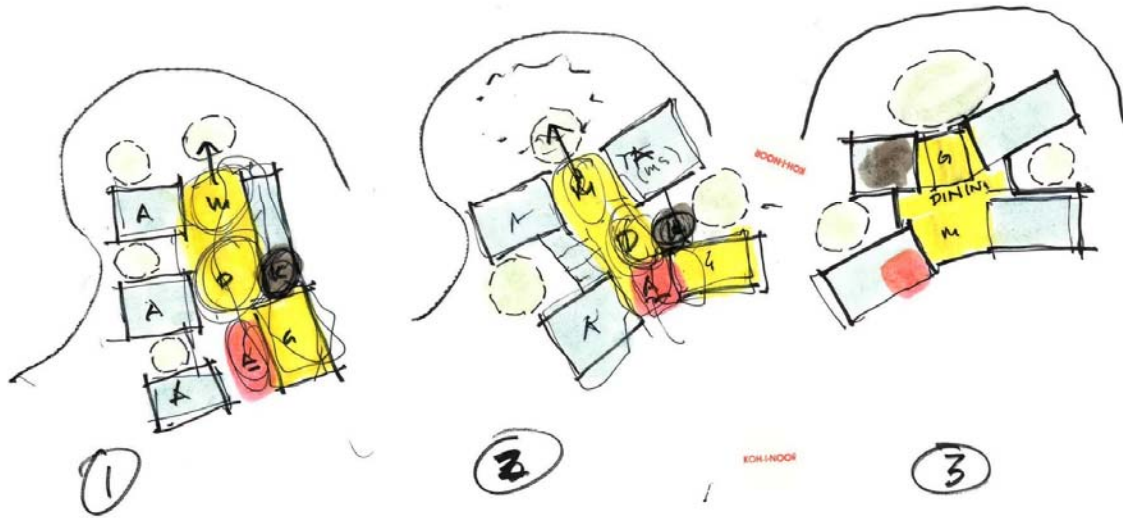

THE SCHOOL DISTRICT OF
PHILADELPHIA



New school on Ryan Ave
Board review & input

Building location

February 1, 2019



Project parameters

- comprehensive K-8 program
- 1,660 students
- 179,880 SF
- \$70 million project cost
- Occupancy by Aug 1, 2020



THE SCHOOL DISTRICT OF
PHILADELPHIA

New school on Ryan Ave

project parameters



Project goals

- Site specific solution.
- Educationally effective.
- Flexible and adaptable.
- Operationally efficient.
- Safe and secure.
- Community resource.
- Source of community pride.



New school on Ryan Ave

project goals



Site options

SDP, Gilbane and Stantec considered 5 potential locations for the New School. Location criteria included:

- Safe access for drop-off and pick-up
- No disruption of existing and future circulation routes and patterns for Lincoln HS and Meehan MS
- Flat site with access to utility infrastructure
- Initial community feedback on use of Lincoln HS campus

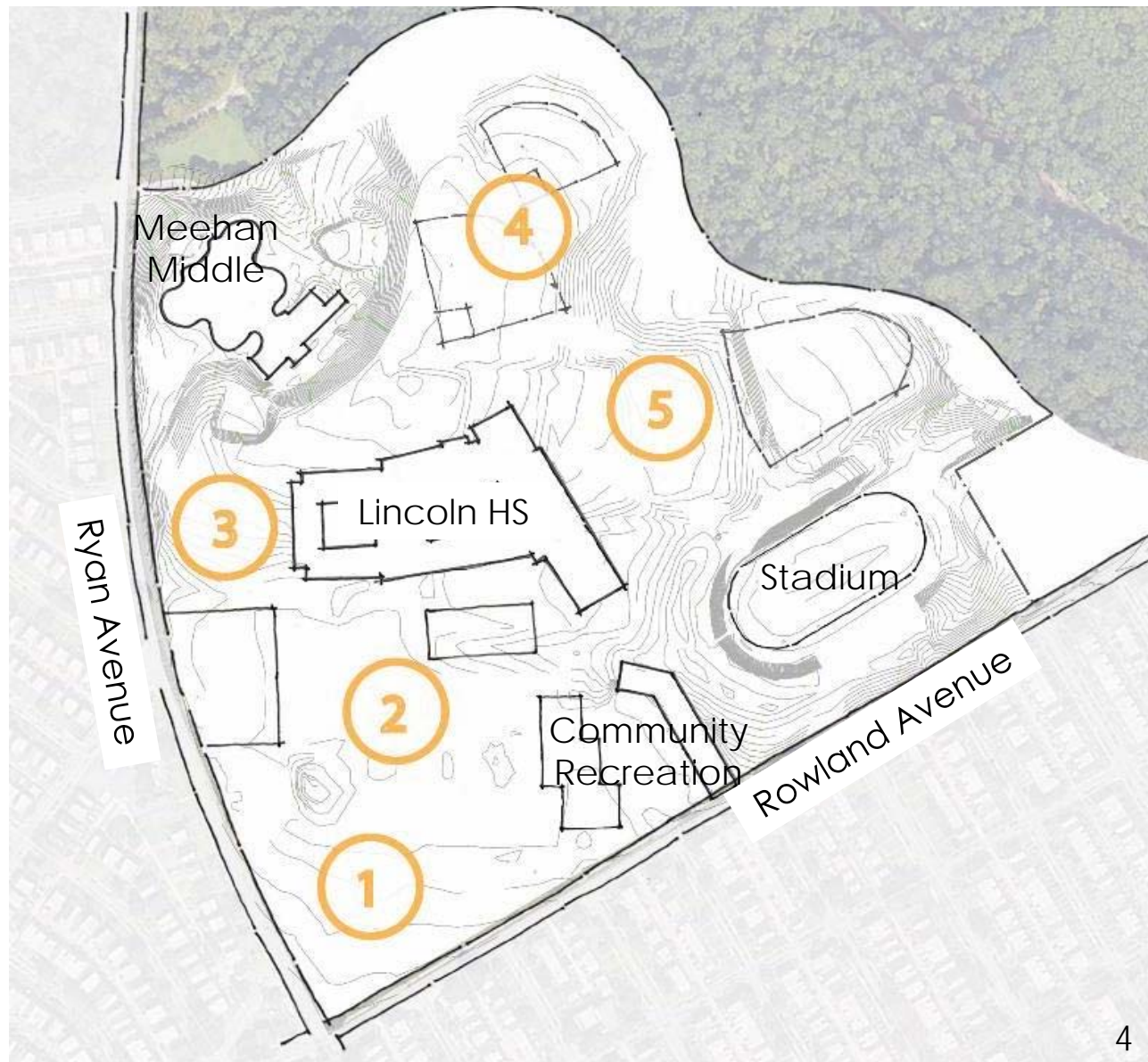

Sites eliminated

Sites 1 and 2

SDP, Gilbane and Stantec performed a site visit to review traffic conditions:

- New site access prohibited within 250 ft of intersection
- Adding traffic to existing LincolnHS vehicle circulation would negatively impact efficiency and safety
- Compromise safety of existing street parking and protected bike lanes at Ryan Avenue

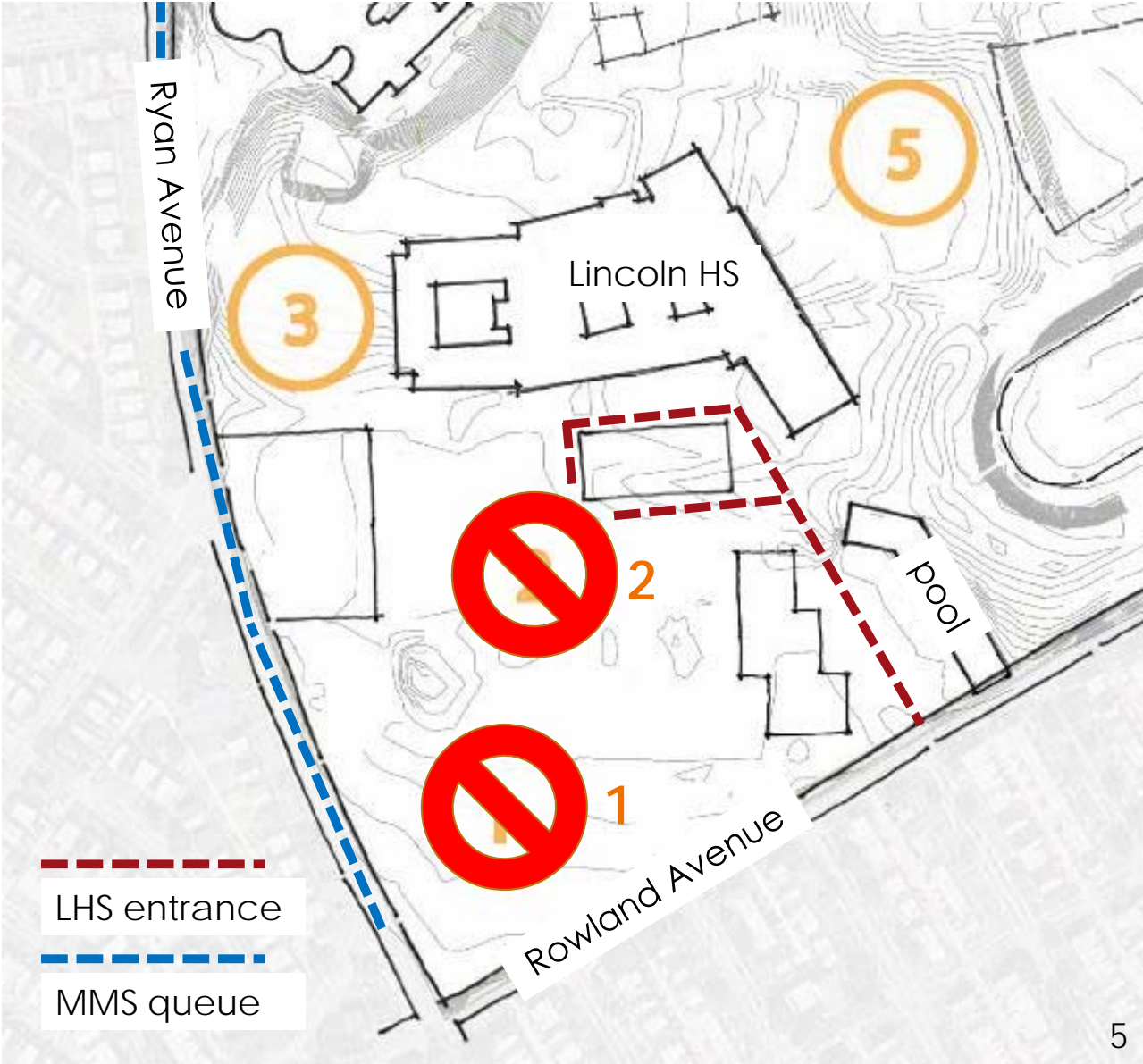

Sites eliminated

Site 3

- Limited footprint, unable to accommodate 180,000 SF new school footprint
- Interruption of Ryan Avenue queue for drop-off and pick-up
- Site terrain is steeply sloped

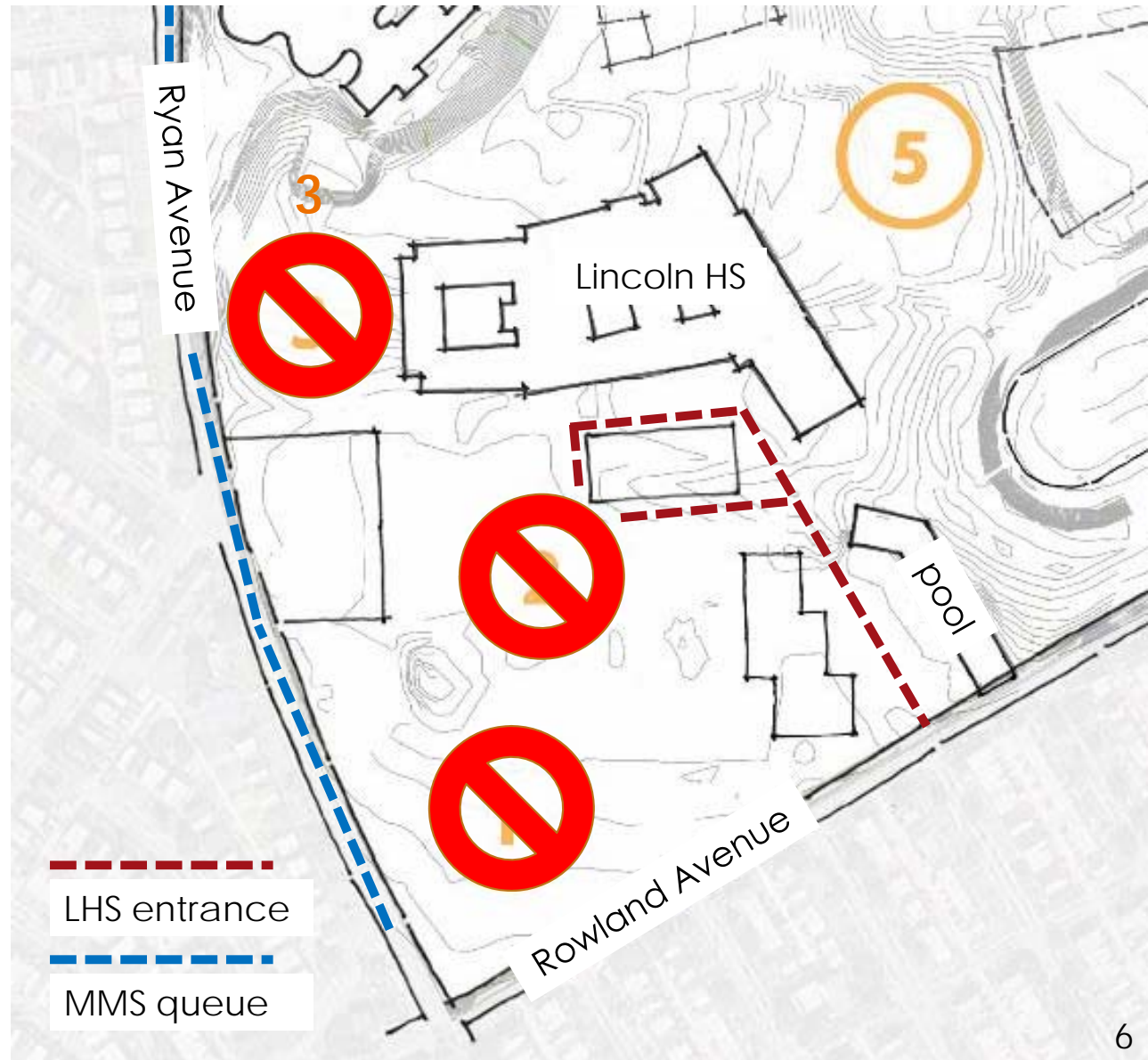

Sites eliminated

Site 5

- Conflicts with existing stormwater infrastructure and basin
- Challenging topography includes varying slopes
- Faces the back-side of Lincoln HS, discouraging opportunities for a campus design or feel
- Parking would need to be located remotely, north of new School

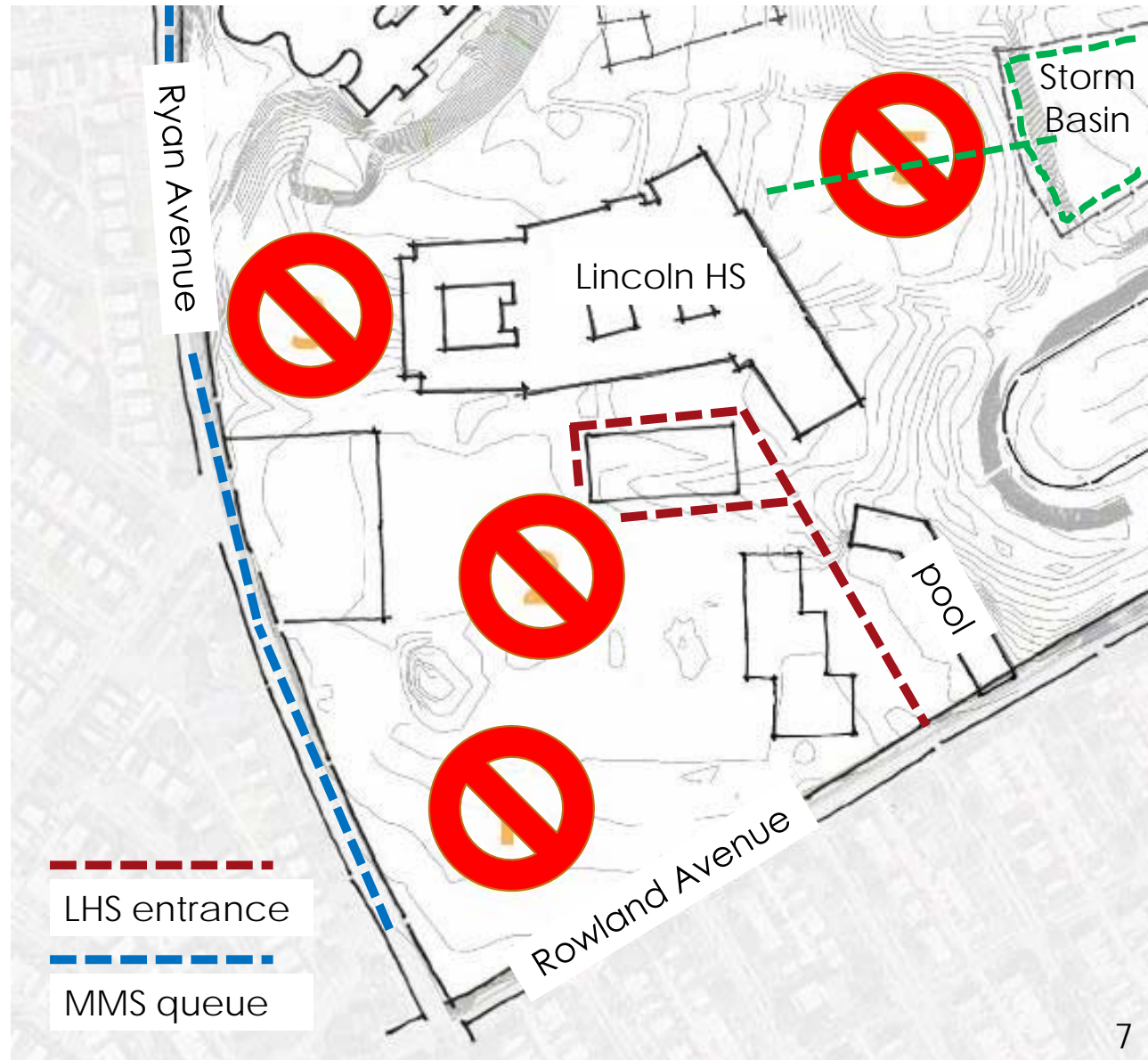

Site recommended

Site 4

SDP, Gilbane and Stantec are recommending Site 4 for the following reasons:

- Appropriate distance from LHS for unique identity
- Opportunity to develop entrance drive and connect campus
- Opportunity for site-specific solution
- Location was shared with the principal of Lincoln HS for feedback

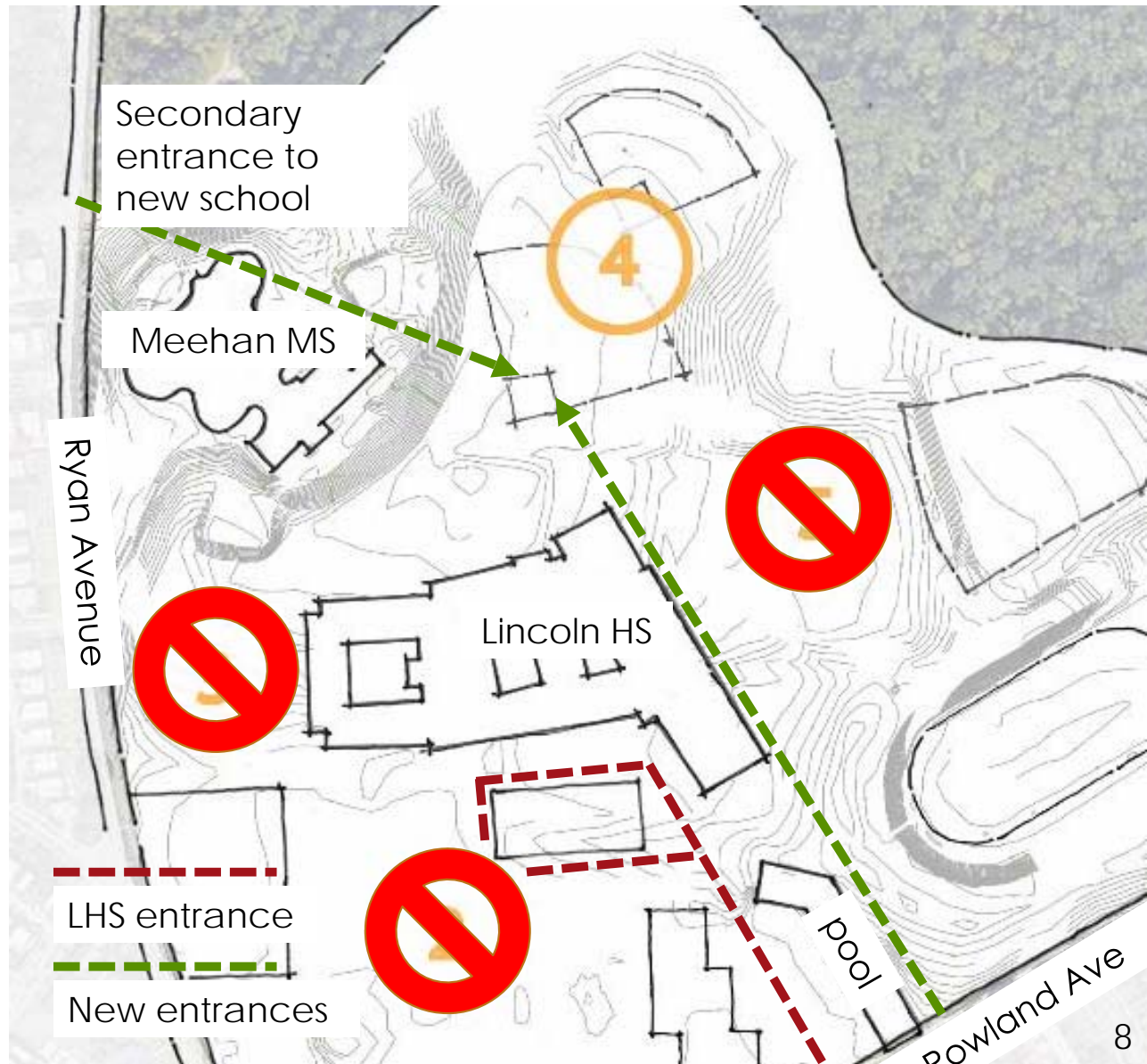



Potential and possibilities

- A special, safe, protected destination
- Separate identity from Abraham Lincoln
- Northern and southern orientations for classrooms to provide quality daylighting and control glare
- Controlled 'courtyards' for outdoor learning and recreation
- Grade-level access to K and 1st grade courtyard
- Re-energized entry drive design for vehicular access & drop-off