

THE SCHOOL DISTRICT OF PHILADLPHIA
SCHOOL REFORM COMMISSION
Office of Capital Programs
440 North Broad Street, 3rd Floor – Suite 371
Philadelphia, PA 19130

TELEPHONE: (215) 400-4730

Addendum No. 03

Subject: Camelot Academy – Generator Replacement
SDP Contract No. B-036C of 2018/19

Location: Camelot Academy
1435 N. 26th Street
Philadelphia, Pennsylvania 19121

This Addendum, dated September 18, 2019, shall modify and become part of the Contract Documents for the work of this project. Any items not mentioned herein, or affected by, shall be performed strictly in accordance with the original documents.

Pre-Bid RFI Questions and Responses:

1. Drawing E-501 Detail #10. Please confirm that re-bar is required in the duct bank

Response – Duct bank is no long required, these details have been removed.

2. Drawing E-501 Detail #4. Please confirm that this footer detail is not required on this project.

Response – As per drawings E-501 Detail #4, the footer detail for each fence post is required.

3. Drawing E-501 Detail #1 and Detail #5. Detail #1 states that metal fence post shall be grounded. Detail #5 states that each corner ground post shall be grounded. Please confirm the number of fence post to be grounded.

Response – As per drawings E-101 and E-501, fence post grounding is required. The EC's fencing contractor shall determine the exact quantity of fence posts. Assume a minimum of (8) metal fence post will be required as per drawing E-501 Detail #1.

Drawing Revisions:

Please note, a complete conformed drawing set has been issued with the following revisions noted below.

E001 – No revisions

ED100 - No revisions

ED101 - No revisions

E100 - No revisions

E101 – Generator location has been moved closer to the building. Duct bank has been removed, all exterior conduit shall be surface mounted. Quantity of bollards have been reduced.

E501 – Duct bank details have been removed.

E601 – No revisions

End of Addendum No. 03.

SEAL:

HAYAN VYRIBHAI PATEL, PE
PHILADELPHIA LICENSE NO. PE 088847

MEP Engineer
NORR
An Ingenium International Company
One Penn Center
1817 JFK Boulevard, Suite 1600
Philadelphia, PA 19103 U.S.A.
norrc.com

LIGHTING

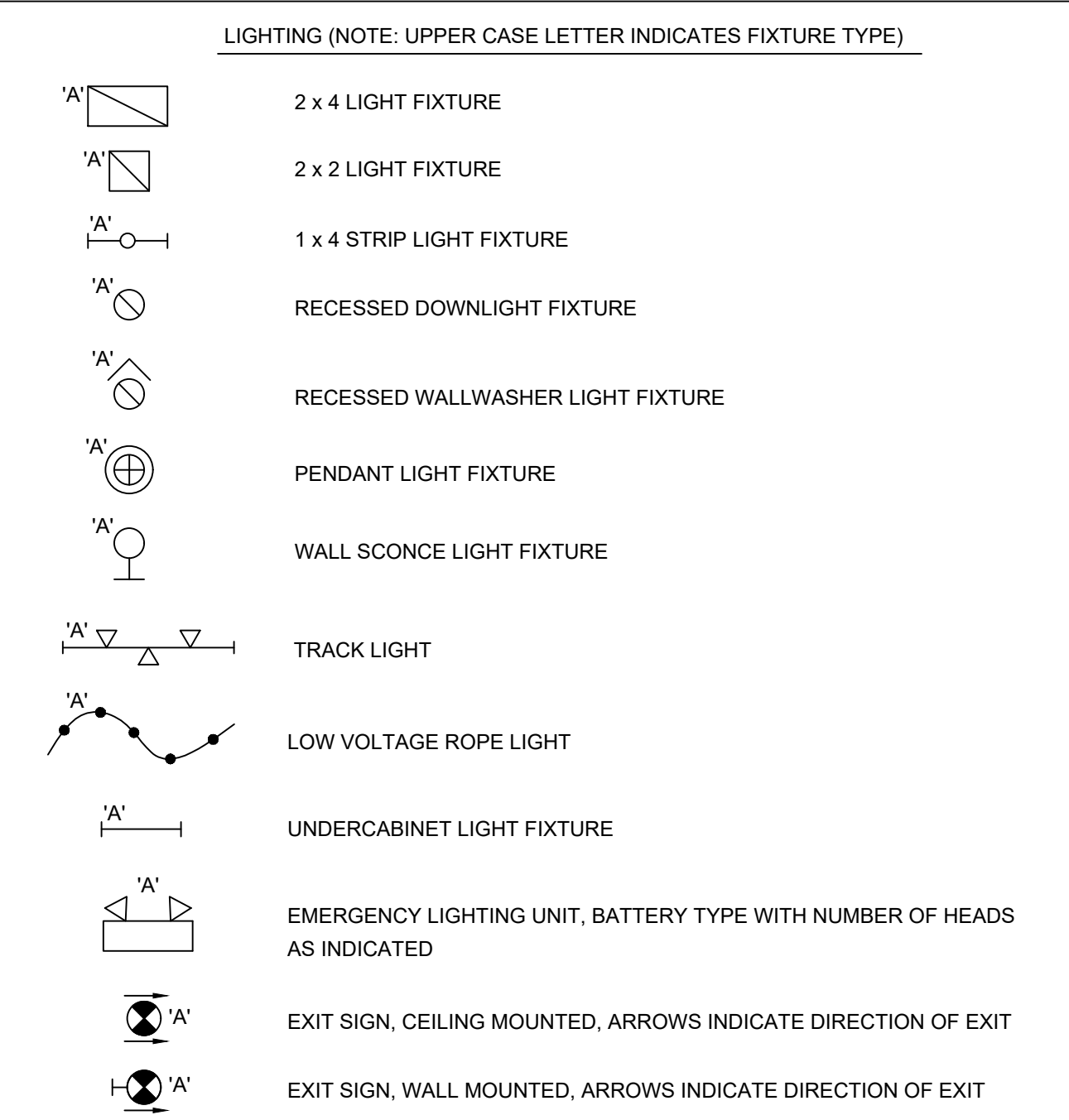

POWER

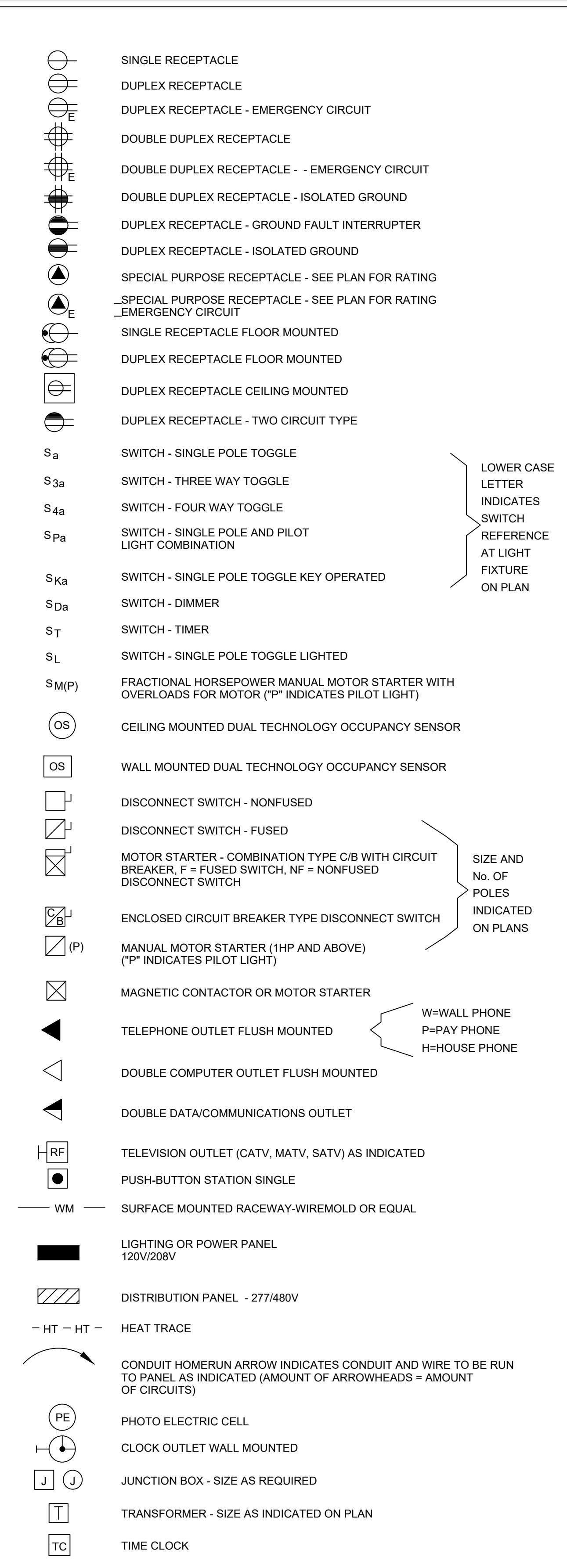

MECHANICAL/ELECTRICAL

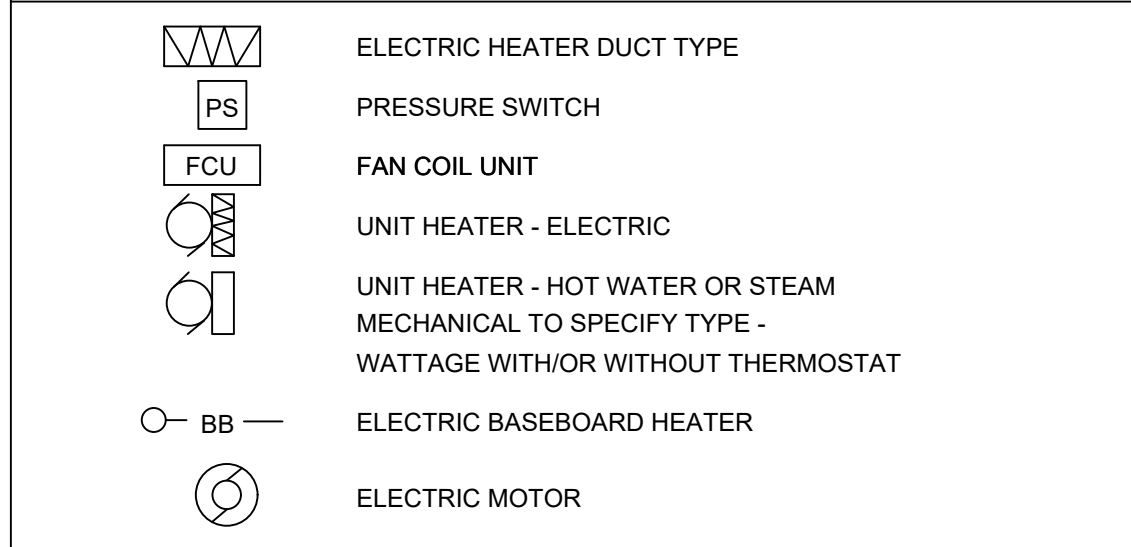

FIRE ALARM

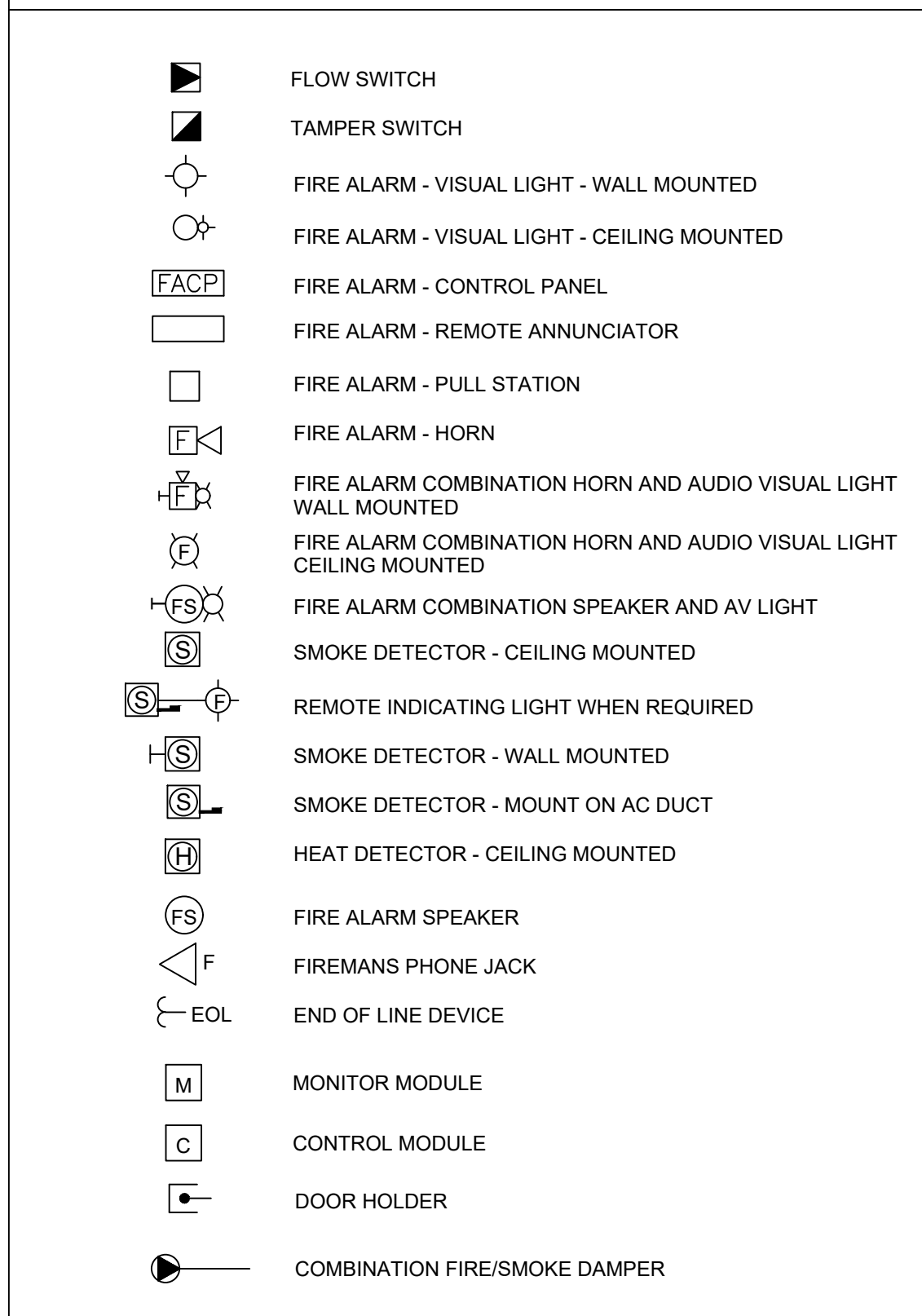

SINGLE LINE SYMBOLS

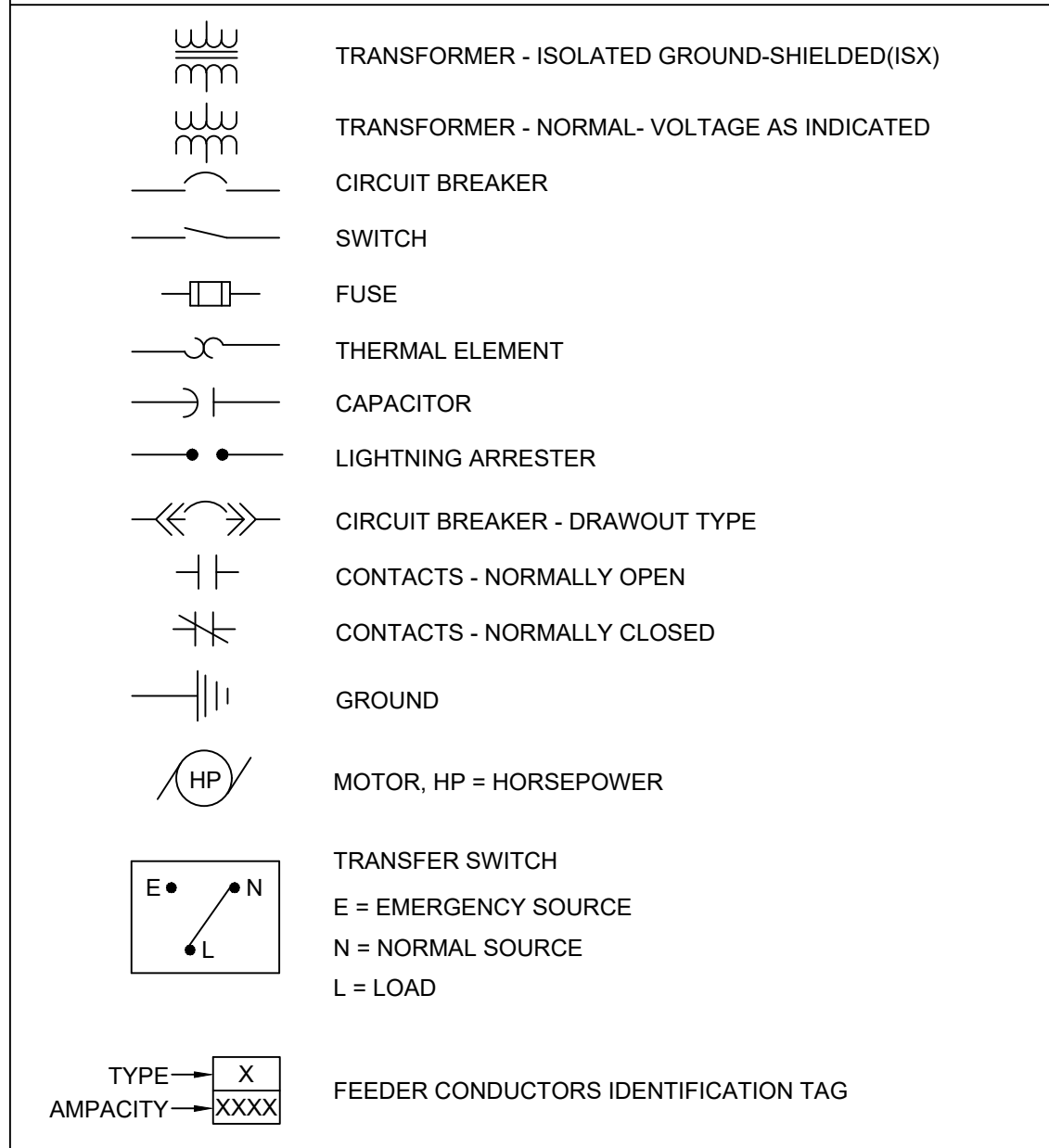

GENERAL

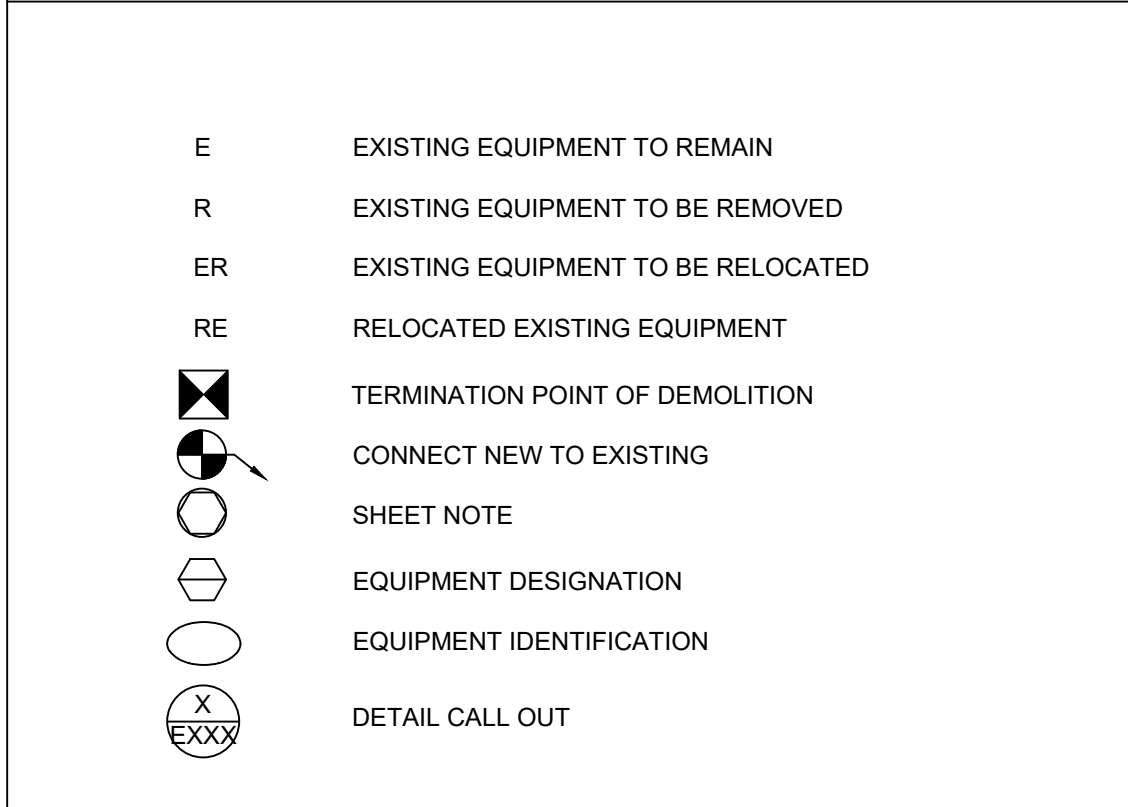

MOUNTING HEIGHTS

1. ALL MOUNTING HEIGHTS LIST ARE TO CENTER OF DEVICE UNLESS OTHERWISE NOTED AND MUST CONFORM TO ADA, NFPA, ANSI 117.1 REQUIREMENTS UNLESS OTHERWISE NOTED.

2. CONTRACTOR TO VERIFY FINAL LOCATION OF ALL DEVICES WITH ARCHITECT AND/OR INTERIOR DESIGNER.

3. WHERE DEVICES FALL ON TWO SURFACE FINISHES, RAISE THE DEVICE TO BE ON A SINGLE FINISH, COORDINATE WITH ARCHITECT.

FIRE ALARM GONG AND BELL (WALL MOUNTED)	6'-8" MAX. HT. OR 6" BELOW CLG. WHICHEVER IS LOWER
FIRE ALARM STROBE LIGHT & SIGNALING DEVICES (WALL MOUNTED)	ENTIRE LENS IS NOT LESS THAN 80" AND NOT GREATER 96" AFF. WHERE LOW CEILINGS DO NOT PERMIT MOUNTING AT MIN. 80" DEVICE SHALL BE MOUNTED WITHIN 6" OF THE CEILING.
TOP OF LIGHTING AND/OR POWER PANELS IN COMMON BUILDING SPACES TOP OF TELEPHONE CABINET (MAXIMUM)	6' - 2" AFF
TOP OF LIGHTING AND/OR POWER PANELS IN LIVING UNITS	4' - 0" AFF TO HIGHEST OPERABLE DEVICE
TOP OF BACK MOUNTED EXIT FIXTURE (NOT LOCATED ABOVE DOORS)	12" BELOW FINISHED CEILING TO CENTERLINE
TOP OF SAFETY DISCONNECT SWITCH, CONTACTORS, MAGNETIC MOTOR STARTERS	6' - 0" MAXIMUM AFF
**	6" BELOW FINISHED CEILING
*	4' - 0" AFF OR 6" ABOVE COUNTER
*	BELOW COUNTER
TELEPHONE (TOP OF COIN SLOT) TELEPHONE OUTLET (WALL), LIGHT SWITCHES	3' - 0" AFF
MANUAL CONTROL DEVICES, FIRE ALARM PULL STATION, FIRE PHONE JACKS	3' - 0" AFF
RECEPTACLES, TELEPHONE OUTLETS (DESK) TELEVISION OUTLETS COMPUTER OUTLETS	1' - 0" (MIN.) AFF
FINISHED FLOOR ELEV. (BASE)	0' - 0"

LEGEND NOTES

THIS SHEET IS A GENERAL LIST OF SYMBOLS AND ABBREVIATIONS AND SHALL BE USED AS A DICTIONARY TO DEFINE ITEMS INDICATED ON DRAWINGS. NOT ALL SYMBOLS OR ABBREVIATIONS ARE NECESSARILY USED ON THIS PROJECT.

BUILDING CODE SUMMARY

APPLICABLE CODES:
2018 INTERNATIONAL BUILDING CODE
2018 INTERNATIONAL EXISTING BUILDING CODE
2017 NATIONAL ELECTRICAL CODE (NFPA 70)
2005 NFPA 110 - STANDARD FOR EMERGENCY AND STANDBY POWER SYSTEMS

GENERIC ELECTRICAL ABBREVIATIONS

A	AMPERE(S)	LP	LIGHTING PANEL
AC	ALTERNATING CURRENT	LPS	LOW PRESSURE SODIUM
AF	AMP FRAME	MATV	MASTER ANTENNA TELEVISION
AFF	ABOVE FINISHED FLOOR	MC	MECHANICAL CONTRACTOR
AFG	ABOVE FINISHED GRADE	MCC	MOTOR CONTROL CENTER
AL	ALUMINUM	MCM	THOUSAND CIRCULAR MIL(S)
AT	AMP TRIP	MAGSTR	MAGNETIC STARTER
ATS	AUTOMATIC TRANSFER SWITCH	MH	MANHOLE
AWG	AMERICAN WIRE GAUGE	MIC	MICROPHONE
BOC	BOTTOM OF CONDUIT	MTD	MOUNTED
BFC	BELOW FINISHED CEILING	MTG	MOUNTING
C	CONDUIT	MTR	MOTOR
CATV	CABLE TELEVISION	MUH	MAKE-UP AIR UNIT
CB	CIRCUIT BREAKER	NC	NORMALLY CLOSED
CC	CONTROL CABINET	NF	NONFUSED
CCTV	CLOSED CIRCUIT TELEVISION	NIC	NOT IN CONTRACT
CKT	CIRCUIT	NL	NIGHT LIGHT
CLG	CEILING	NO	NORMALLY OPEN
CO	CONDUIT ONLY	NTS	NOT TO SCALE
CP	CONTROL PANEL	OL	OVERLOAD ELEMENT
CT	CURRENT TRANSFORMER	PC	PLUMBING CONTRACTOR
CU	COPPER	PE	PHOTO ELECTRIC CELL
DC	DIRECT CURRENT	PF	POWER FACTOR
DE	DUAL ELEMENT	PL	PILOT LIGHT
DP	DOUBLE POLE	PP	POWER PANEL
DS	DISCONNECT SWITCH	PRI	PRIMARY
DT	DOUBLE THROW	PS	PULL SWITCH
EC	ELECTRICAL CONTRACTOR	PTZ	PAN/TILT/ZOOM CAMERA
E	EXHAUST FAN	R	RELAY
E HTR	ELECTRIC HEATER	RC	REMOTE CONTROL
EM	EMERGENCY LIGHTING	RCP	REFLECTED CEILING PLAN
EMT	ELECTRICAL METALLIC TUBING	RECPT	RECEPTACLE
EOL	END OF LINE RESISTOR	SATV	SATELLITE ANTENNA TELEVISION
EUH	ELECTRIC UNIT HEATER	SEC	SECONDARY
EWC	ELECTRIC WATER COOLER	SP	SINGLE POLE
F	FUSED	SPKR	SPEAKER
FA	FIRE ALARM	ST	SHUNT TRIP
FACP	FIRE ALARM CONTROL PANEL	SW	SWITCH
FDR	FEEDER	SWBD	SWITCHBOARD
FL	FLOOR	T	TELEPHONE
GC	GENERAL CONTRACTOR	TC	TIME CLOCK
GFI	GROUND FAULT INTERRUPT	TD	TIME DELAY
GND	GROUND	TDC	TIME DELAYED CLOSED
HID	HIGH INTENSITY DISCHARGE	TDO	TIME DELAYED OPEN
HP	HORSEPOWER	TV	TELEVISION
HPS	HIGH PRESSURE SODIUM	TYP	TYPICAL
HT	ELECTRIC HEAT TRACE	UFD	UNDERFLOOR DUCT
HW	HEAVYWALL RIGID CONDUIT	UG	UNDER GROUND
HZ	HERTZ (FREQ. IN CYCLES PER SECOND)	UH	UNIT HEATER
I	INTERCOM	UON	UNLESS OTHERWISE NOTED
IG	ISOLATED GROUND	V	VOLTS
IMC	INTERMEDIATE METALLIC CONDUIT	VA	VOLT AMPERE(S)
INC	INCANDESCENT	VAR	VOLT AMPS REACTIVE
JB	JUNCTION BOX	VP	VAPOR PROOF
KCMIL	THOUSAND CIRCULAR MIL(S)	W	WATTS
KVA	KILOVOLT AMPERE(S)	WP	WEATHERPROOF
KVAR	KILOVAR(S)	XFMR	TRANSFORMER
KW	KILOWATT(S)	XP	EXPLOSION PROOF

DRAWING SCHEDULE

DRAWING NUMBER	DRAWING TITLE
E001.0	COVER SHEET
ED100.0	BASEMENT DEMOLITION PLAN
ED101.0	FIRST FLOOR DEMOLITION PLAN
E101.0	BASEMENT NEW WORK PLAN
E102.0	FIRST FLOOR NEW WORK PLAN
E501.0	DETAILS
E601.0	SCHEDULES AND DIAGRAMS

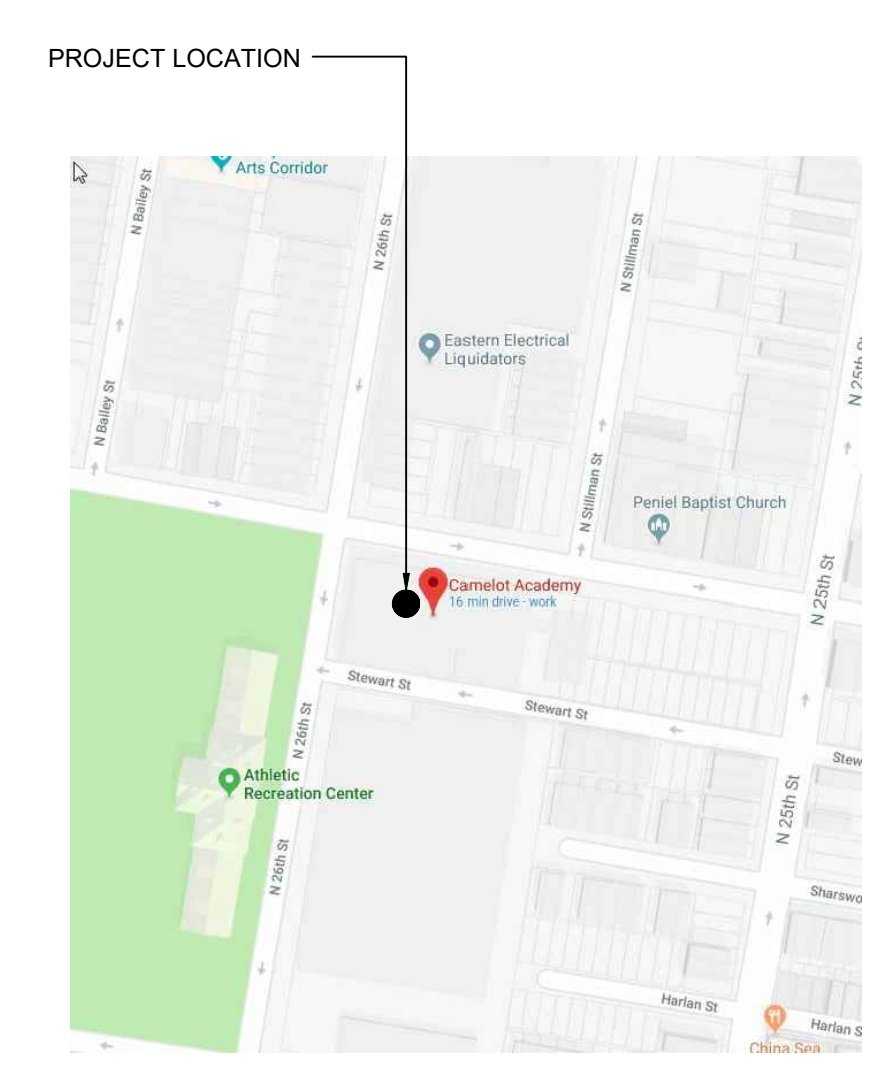

PROJECT VICINITY MAP 1

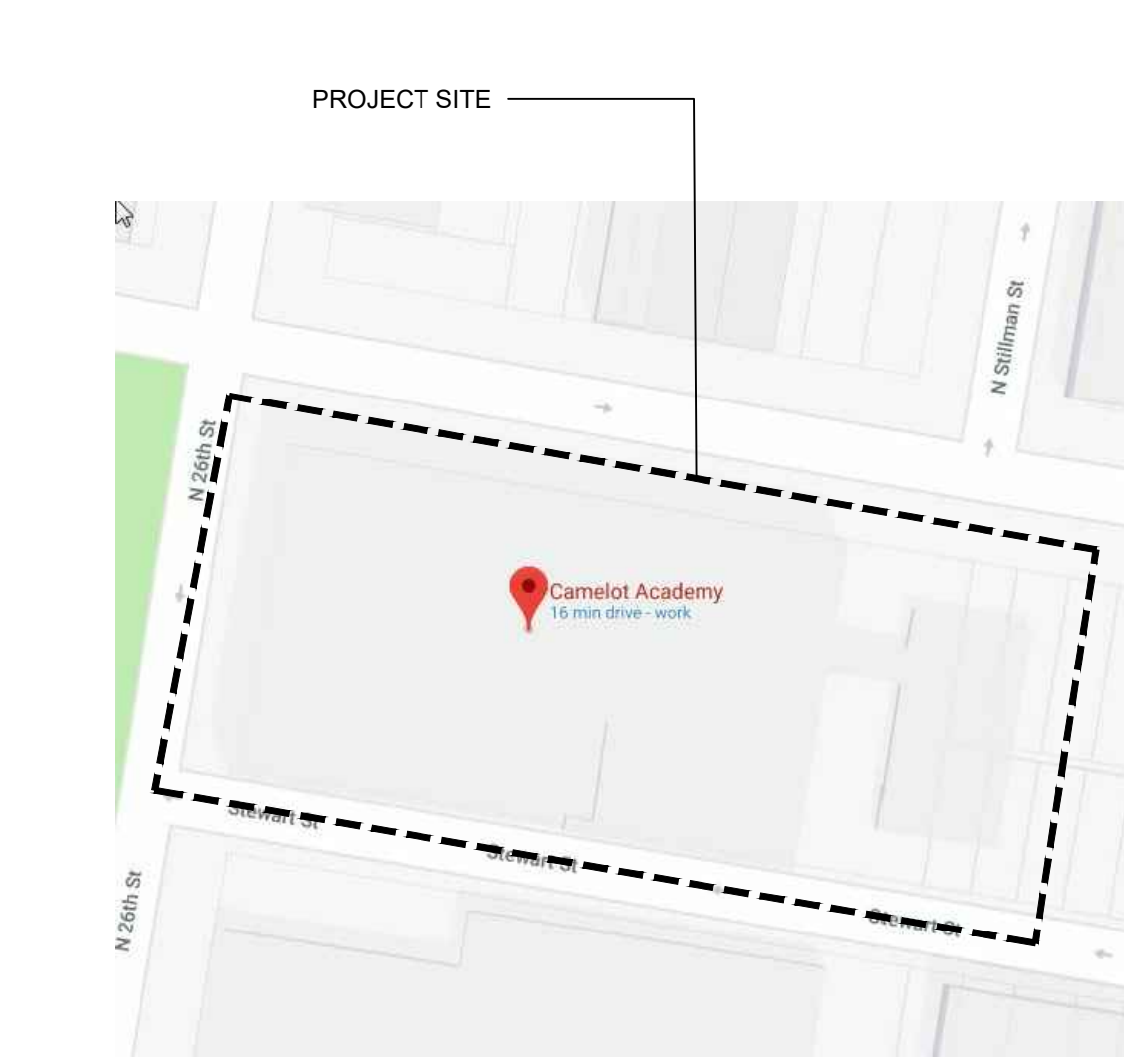

PROJECT STREET MAP 2



PROJECT SITE PLAN 3

**ADDENDUM #03
SEPTEMBER 18, 2019**

NO.	DATE	REVISION
10		
9		
8		
7		
6		
5		
4		
3		
2	09/18/19	ADDENDUM #03
1	08/15/19	ADDENDUM #02

SCHOOL & LOCATION
CAMELOT ACADEMY
1435 N. 26TH STREET
PHILADELPHIA, PA 19121

PROJECT TITLE
GENERATOR REPLACEMENT

DRAWING TITLE
COVER SHEET

DRAWING SCALE AS NOTED	
LOCATION NO. 2310	FILE NO.
DRAWN BY AD	CHECKED BY NVP
8-036C	OF 2018 / 19
	OF

DRAWING NO.
E - 001.0
SHEET 1 OF 7

SEAL:

HAYAN V. RIBHAI PATEL, PE
PENNSYLVANIA LICENSE NO.
PE 088847

MEP Engineer

NORR

An Ingenium International Company
One Penn Center
1817 JFK Boulevard, Suite 1600
Philadelphia, PA 19103 U.S.A.
norri.com

DEMOLITION KEYNOTES	
1	EXISTING GAS SERVICE FOR GENERATOR TO BE REMOVED BACK TO INCOMING GAS SERVICE. CAP AND SEAL PIPING AT TEE OR CROSS FITTING.

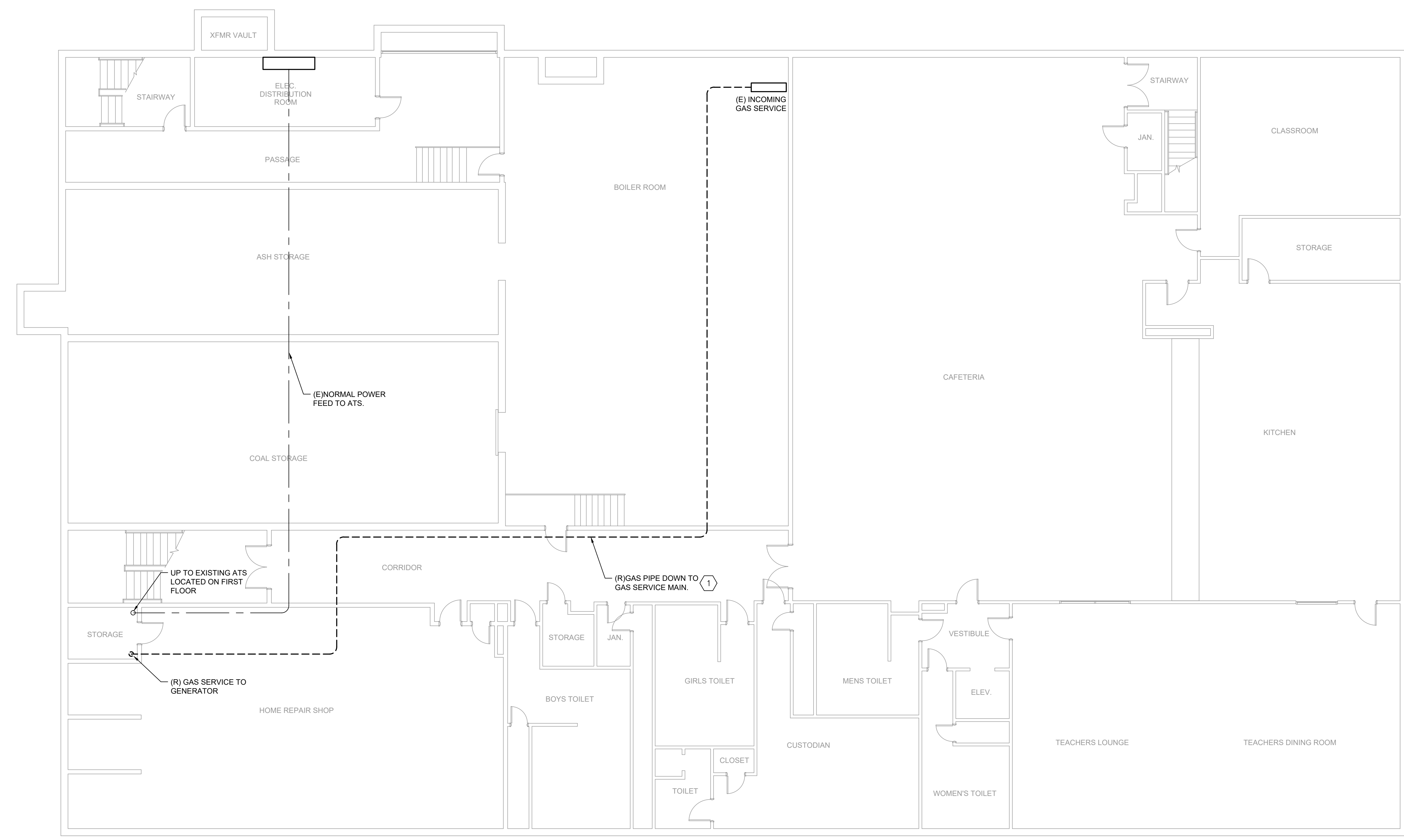

BASEMENT DEMOLITION PLAN
1/8" = 1'-0" **1**

ADDENDUM #03
SEPTEMBER 18, 2019

10		
9		
8		
7		
6		
5		
4		
3		
2	09/18/19	ADDENDUM #03
1	08/15/19	ADDENDUM #02
NO.	DATE	REVISION

SCHOOL & LOCATION
CAMELOT ACADEMY
1435 N. 26TH STREET
PHILADELPHIA, PA 19121

PROJECT TITLE
GENERATOR REPLACEMENT

DRAWING TITLE
BASEMENT DEMOLITION PLAN

DRAWING SCALE	
AS NOTED	
LOCATION NO. 2310	FILE NO.
DRAWN BY AD	CHECKED BY NVP
8-036C	2018 / 19
OF	OF

DRAWING NO.
ED - 100.0
SHEET **2** OF **7**

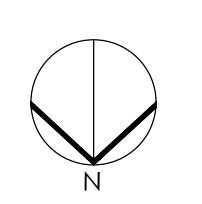

SEAL:

HAYAN VRIJIBHAI PATEL, PE
PENNSYLVANIA LICENSE NO. PE 088847

MEP Engineer

NORR

An Ingenium International Company
One Perm Center
1817 JFK Boulevard, Suite 1600
Philadelphia, PA 19103 U.S.A.
norrc.com

DEMOLITION KEYNOTES	
1	DISCONNECT AND REMOVE GENERATOR, ALL ASSOCIATED ACCESSORIES (BATTERY CHARGERS, EXHAUST MANIFOLD, ETC.), AND ALL ASSOCIATED WIRING AND CONDUIT. EXISTING CONCRETE HOUSEKEEPING PAD FOR GENERATOR TO REMAIN. CLEAN EXISTING HOUSE-KEEPING PAD AND PREPARE FOR EXTENSION UNDER NEW WORK. DISCONNECT AND REMOVE ALL EXHAUST AND GAS PIPING AND HANGERS. PATCH AND REPAIR WALL PENETRATION FOR EXHAUST PIPING.
2	DISCONNECT AND REMOVE 60A, 2-POLE, 240V AUTOMATIC TRANSFER SWITCH (ATS), DISCONNECT EMERGENCY LINE FEEDERS, LOAD FEEDERS, AND ASSOCIATED CONDUIT. NORMAL POWER FEED FROM MDP TO BE DISCONNECTED AND PREPARED FOR CONNECTION TO NEW AUTOMATIC TRANSFER SWITCH.
3	DISCONNECT AND REMOVE FUSED EMERGENCY PANEL. DISCONNECT AND SAFE OFF ALL (20) BRANCH CIRCUITS, PREPARE FOR RECONNECTION TO NEW PANEL BOARD. REMOVE EXISTING POWER FEEDERS AND CONDUIT BACK TO EXISTING AUTOMATIC TRANSFER SWITCH.
4	EXISTING GAS SERVICE FOR GENERATOR TO BE REMOVED BACK TO MAIN INCOMING GAS SERVICE LOCATION. CAP AND SEAL PIPING AT TEE OR CROSS FITTING. REFER TO DRAWING ED100 FOR CONTINUATION OF EXISTING GAS SERVICE.
5	DISCONNECT AND REMOVE EXISTING 60A, 240V, 3 POLE DISCONNECT SWITCH.

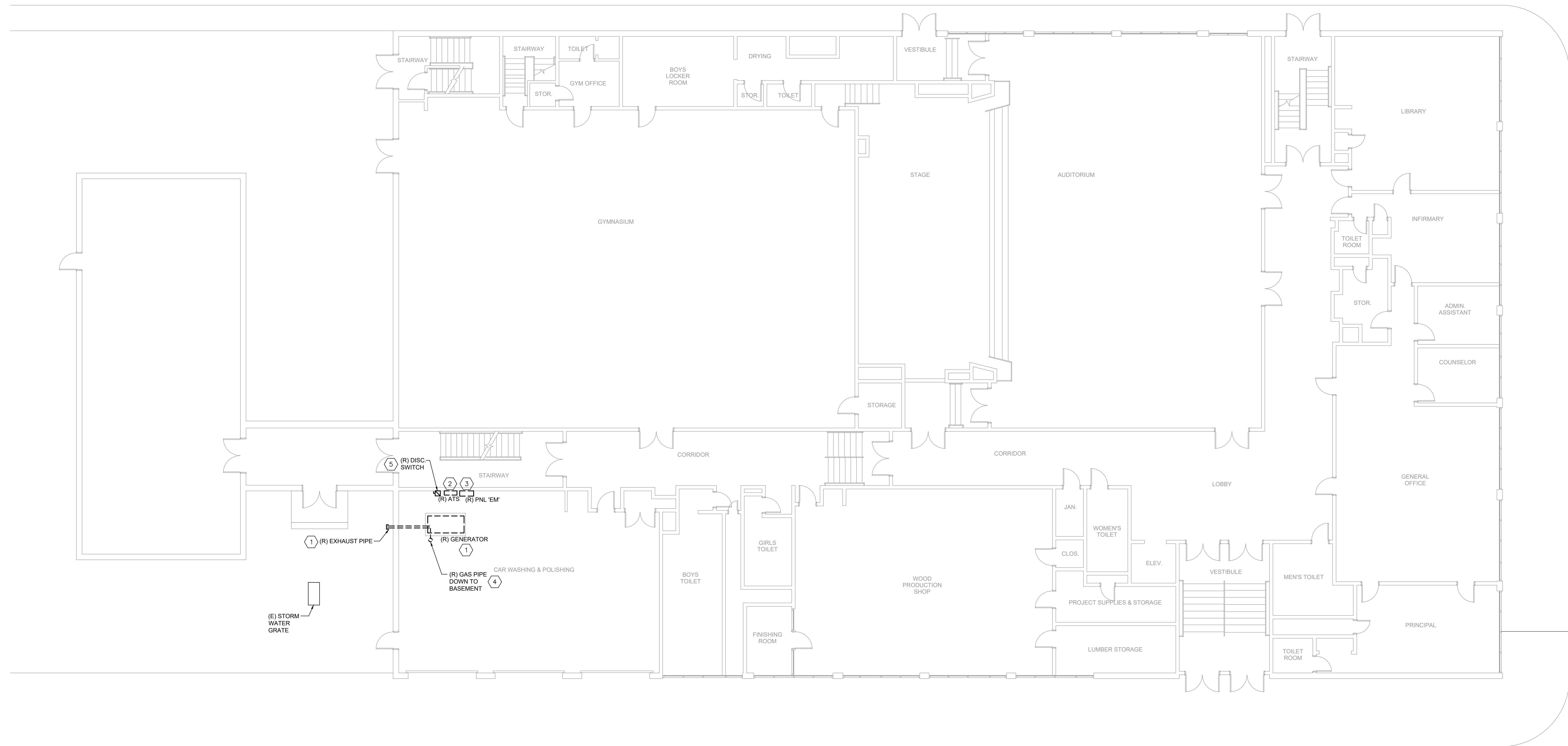

**ADDENDUM #03
SEPTEMBER 18, 2019**

NO.	DATE	REVISION
10		
9		
8		
7		
6		
5		
4		
3		
2	09/18/19	ADDENDUM #03
1	08/15/19	ADDENDUM #02

SCHOOL & LOCATION
CAMELOT ACADEMY
1435 N. 26TH STREET
PHILADELPHIA, PA 19121

PROJECT TITLE
GENERATOR REPLACEMENT

DRAWING TITLE
FIRST FLOOR DEMOLITION PLAN

DRAWING SCALE AS NOTED	
LOCATION NO. 2310	FILE NO.
DRAWN BY AD	CHECKED BY NVP
8-036C	OF 2018 / 19
	OF

DRAWING NO.
ED - 101.0
SHEET **3** OF **7**

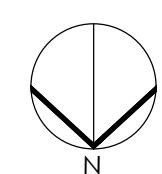

SEAL:

HAYAN VRIJIBHAI PATEL, PE
PENNSYLVANIA LICENSE NO. PE 088847

MEP Engineer

NORR

An Ingenium International Company
One Penn Center
1817 JFK Boulevard, Suite 1600
Philadelphia, PA 19103 U.S.A.
norri.com

GENERAL NOTES:

- A. ALL CONDUIT SHALL BE THREADED GALVANIZED RIGID METAL (STEEL) CONDUIT ONLY.
- B. CONTRACTORS SHALL COORDINATE INSTALLATION WITH SDP ENVIRONMENTAL TEAM.

NEW WORK KEY NOTES

- 1. PROVIDE NEW EMERGENCY STOP BUTTON AND GENERATOR ANNUNCIATOR WITH WIRE GUARD CAGE COMPATIBLE WITH NEW GENERATOR. PROVIDE 1" CONDUIT FROM GENERATOR TO EM STOP BUTTON AND ANNUNCIATOR FOR INTERCONNECTION OF BUTTON AND ANNUNCIATOR TO GENERATOR CONTROL PANEL. PROVIDE WIRING INTERCONNECTION PER GENSET MANUFACTURER REQUIREMENTS. ANNUNCIATOR PANEL AND EM STOP BUTTON TO BE LOCATED WITHIN BUILDING ENGINEER'S OFFICE. ALL EXTERIOR AND INTERIOR WALL PENETRATION SHALL BE FIRE STOPPED.

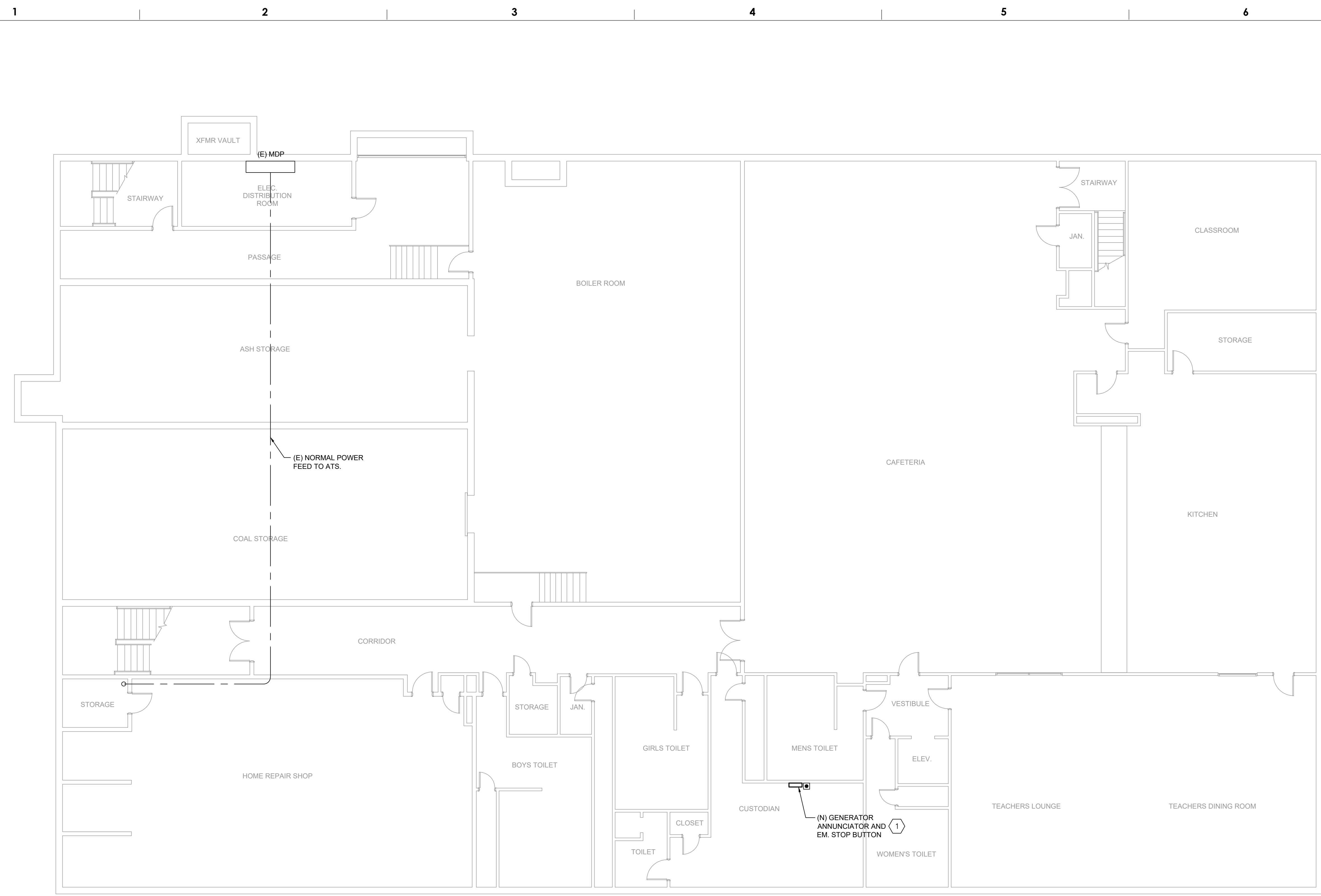

BASEMENT NEW WORK PLAN
1/8" = 1'-0" 1

ADDENDUM #03
SEPTEMBER 18, 2019

10		
9		
8		
7		
6		
5		
4		
3		
2	09/18/19	ADDENDUM #03
1	08/15/19	ADDENDUM #02
NO.	DATE	REVISION

SCHOOL & LOCATION
CAMELOT ACADEMY
1435 N. 26TH STREET
PHILADELPHIA, PA 19121

PROJECT TITLE
GENERATOR REPLACEMENT

DRAWING TITLE
BASEMENT NEW WORK PLAN

DRAWING SCALE	
AS NOTED	
LOCATION NO.	FILE NO.
2310	
DRAWN BY	CHECKED BY
AD	NVP
8-036C	OF 2018 / 19
OF	OF

DRAWING NO.
E - 100.0
SHEET 4 OF 7

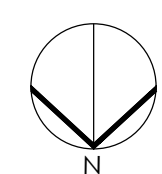

SEAL:

HAYAN V. NUBIAH, P.E.
PHILADELPHIA LICENSE NO. PE 088847

MEP Engineer

NORR

An Ingenium International Company
One Penn Center
1817 JFK Boulevard, Suite 1600
Philadelphia, PA 19103 U.S.A.
norrc.com

ADDENDUM #03
SEPTEMBER 18, 2019

NO.	DATE	REVISION
10		
9		
8		
7		
6		
5		
4		
3		
2	09/18/19	ADDENDUM #03
1	08/15/19	ADDENDUM #02

SCHOOL & LOCATION
CAMELOT ACADEMY
1435 N. 26TH STREET
PHILADELPHIA, PA 19121

PROJECT TITLE
GENERATOR REPLACEMENT

DRAWING TITLE
FIRST FLOOR NEW WORK PLAN

LOCATION NO.	FILE NO.
2310	
DRAWN BY	CHECKED BY
AD	NVP
8-036C	OF 2018 / 19
	OF

DRAWING NO.
E - 101.0
SHEET 5 OF 7

GENERAL NOTES:

- A. ALL CONDUIT SHALL BE THREADED GALVANIZED RIGID METAL (STEEL) CONDUIT ONLY.
- B. CONTRACTORS SHALL COORDINATE INSTALLATION WITH SDP ENVIRONMENTAL TEAM.

NEW WORK KEY NOTES

1. PROVIDE NEW DIESEL GENERATOR WITH LEVEL 1 SOUND ATTENUATING WEATHERPROOF ENCLOSURE. GENERATOR SHALL BE RATED FOR 15KW, 120/240V, 1PH, WITH 80A/2P MCB AT GENERATOR CONTROL PANEL. PROVIDE GENERATOR WITH 48-HOUR DOUBLE-WALLED 3KD-BASED DIESEL FUEL TANK WITH OVERFLOW AND SECONDARY VENTILATION MOUNTED UNDER GENERATOR. GENERATOR SHALL BE FUELED TO 100% AT STARTUP.
2. PROVIDE NEW 6" CONCRETE HOUSEKEEPING PAD, 3000 PSI CONCRETE SLAB FOR NEW GENERATOR. PAD SHALL EXTEND AT MINIMUM 6" BEYOND FOOTPRINT OF GENERATOR ENCLOSURE ON ALL SIDES. COORDINATE EXACT DIMENSIONS OF PAD WITH SELECTED GENERATOR EQUIPMENT. SEE DWG E501 FOR GENERATOR PAD DETAIL.
3. PROVIDE CHAIN LINK FENCE ON ALL THREE SIDES OF THE GENERATOR. SEE DWG E501 FOR FENCING DETAILS. COORDINATE BEYOND CURB OF DUMPSTER WITH SDP FOR INSTALLATION OF NEW GENERATOR AND FENCE.
4. PROVIDE (1) 2" CONDUIT FOR GENSET INCOMING POWER WIRING, (1) 1" CONDUIT FOR CONTROL WIRING TO ATS, (1) 1" FOR GENERATOR EM, STOP AND REMOTE ANNUNCIATOR PANEL, (1) 1-1/2" FOR GENSET ACCESSORIES BRANCH CIRCUITS. CONDUITS SHALL BE ROUTED ON GRADE FROM GENERATOR TO EXTERIOR WALL OF ANNEX BUILDING. CONTRACTOR SHALL GET APPROVAL FROM SCHOOL DISTRICT OF PHILADELPHIA CONSTRUCTION MANAGER PRIOR TO ROUTING CONDUITS. SEE DWG E501 FOR DETAIL OF CONDUIT PENETRATION OF EXTERIOR WALL.
5. PROVIDE POWER FOR GENSET ACCESSORIES WITH CONDENSATE HEATER, BLOCK HEATER, CONDENSATE RECEPTACLE, AND BATTERY CHARGER. UTILIZE DEDICATED 120V, 20AMP CIRCUITS FOR EACH ACCESSORY: ANTI-CONDENSATE HEATER - EM25, BLOCK HEATER - EM26, BATTERY CHARGER - EM23, CONV. RECEPTACLE - EM24. PROVIDE (2) #12 - (1) #12 GND FOR EACH CIRCUIT. PROVIDE #14-2 CONDUIT TO COORDINATE COOPERATOR. BREAKERS UTILIZED FOR GENERATOR ACCESSORIES SHALL PROVIDED WITH LOCKING TABS.
6. PROVIDE BOLLARDS AROUND FENCE FOR PROTECTION AGAINST VEHICULAR TRAFFIC. SEE DWG E501 FOR BOLLARD DETAIL (TYP. QTY. OF 3).
7. PROVIDE NEW 100A, 2 POLE, 240V, 3-WIRE ATS, ASCO 300 SERIES OR APPROVED EQUAL. ATS CONTROLLER SHALL BE PROVIDED WITH AUTOMATIC ENGINE EXERCISER FUNCTION. RECONNECT EXISTING NORMAL POWER FEEDER TO NEW ATS.
8. GENERATOR IS NOT A SEPARATELY DERIVED SYSTEM. GROUNDED NEUTRAL CONDUCTOR SHALL BE SOLIDLY INTERCONNECTED TO SUPPLY FEEDER CONDUCTORS NEUTRAL AT AUTOMATIC TRANSFER SWITCH. NEUTRAL CONDUCTORS SHALL NOT BE SWITCHED.
9. EXISTING STORM WATER GRATE.
10. ROUTE CONDUITS ALONG EXTERIOR WALL OF ANNEX AND CONNECTOR BUILDING. CONDUIT SHALL BE ROUTED BELOW ANNEX BUILDING WINDOWS AND ABOVE CONNECTOR BUILDING EGRESS DOORS. CONTRACTOR SHALL GET APPROVAL FROM SCHOOL DISTRICT OF PHILADELPHIA CONSTRUCTION MANAGER PRIOR TO ROUTING CONDUITS.
11. NEW EMERGENCY PANEL BOARD. SEE DRAWINGS E501 FOR MORE DETAILS.
12. ROUTE CONDUIT THROUGH EXTERIOR WALL. PROVIDE A WEATHERPROOF PULL BOX AT LOCATION OF WALL PENETRATION. CONTRACTOR SHALL FIELD COORDINATE EXACT LOCATION OF PENETRATION THROUGH WALL. PROVIDE CONDUIT LINK SEALS AT WALL PENETRATION. SEE DWG E501 FOR DETAIL OF CONDUIT PENETRATION AT EXTERIOR WALL. CONTRACTOR SHALL GET APPROVAL FROM SCHOOL DISTRICT OF PHILADELPHIA CONSTRUCTION MANAGER PRIOR TO ROUTING CONDUITS.
13. ROUTE CONDUIT ALONG INTERIOR WALL AND TERMINATE AT ATS AND PANEL BOARD. CONTRACTOR SHALL GET APPROVAL FROM SCHOOL DISTRICT OF PHILADELPHIA CONSTRUCTION MANAGER PRIOR TO ROUTING CONDUITS.



PROJECT SITE PLAN 2
NOT TO SCALE

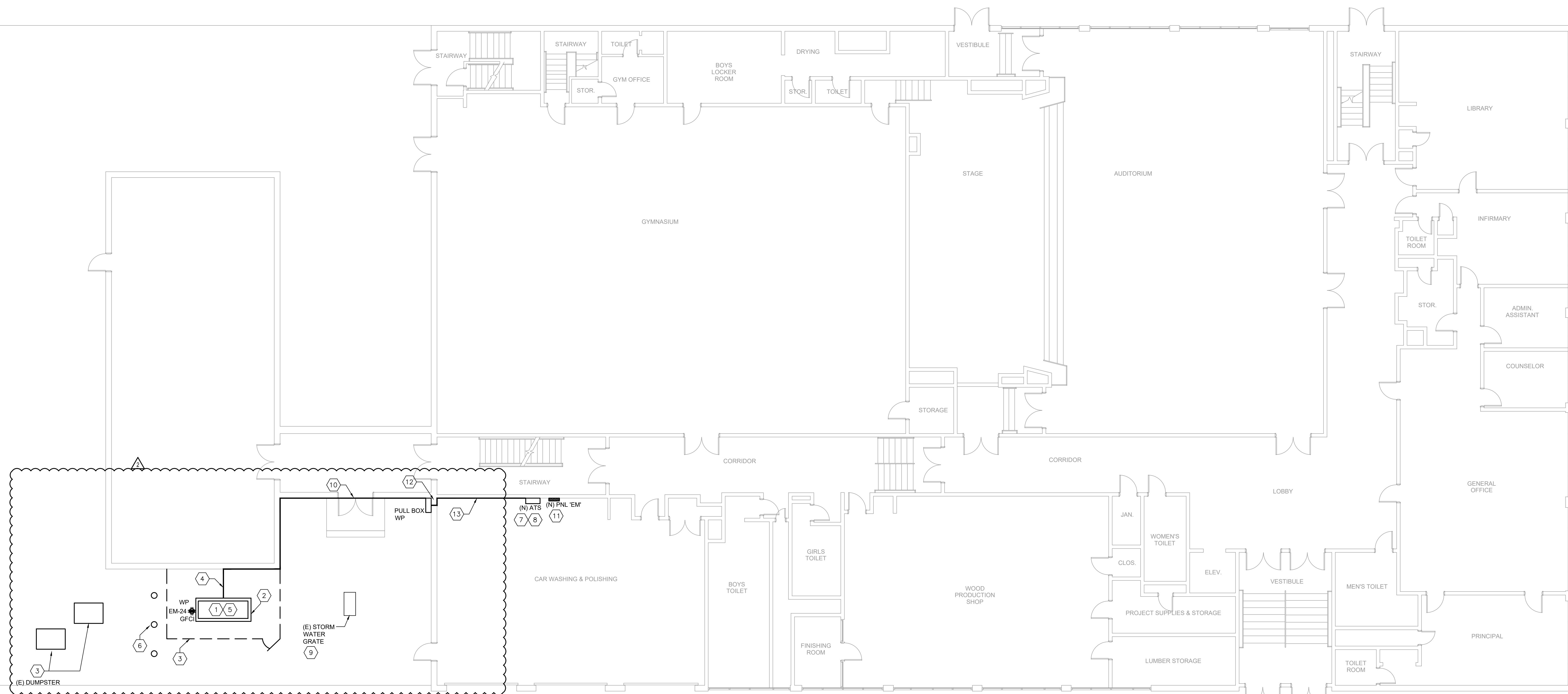

FIRST FLOOR NEW WORK PLAN 1
1/8" = 1'-0"

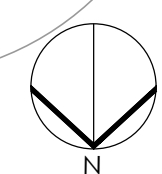

SEAL:

HAYAN V. RIBHAI PATEL, PE
PENNSYLVANIA LICENSE NO. PE 088847

MEP Engineer

NORR

An Ingenium International Company
One Penn Center
1817 JFK Boulevard, Suite 1600
Philadelphia, PA 19103 U.S.A.
norrc.com

ADDENDUM #03
SEPTEMBER 18, 2019

NO.	DATE	REVISION
10		
9		
8		
7		
6		
5		
4		
3		
2	09/18/19	ADDENDUM #03
1	08/15/19	ADDENDUM #02

SCHOOL & LOCATION
CAMELOT ACADEMY
1435 N. 26TH STREET
PHILADELPHIA, PA 19121

PROJECT TITLE
GENERATOR REPLACEMENT

DRAWING TITLE

DETAILS

DRAWING SCALE AS NOTED	
LOCATION NO. 2310	FILE NO.
DRAWN BY AD	CHECKED BY NVP
8-036C	OF 2018 / 19
OF	OF

DRAWING NO.
E-501.0
SHEET 6 OF 7

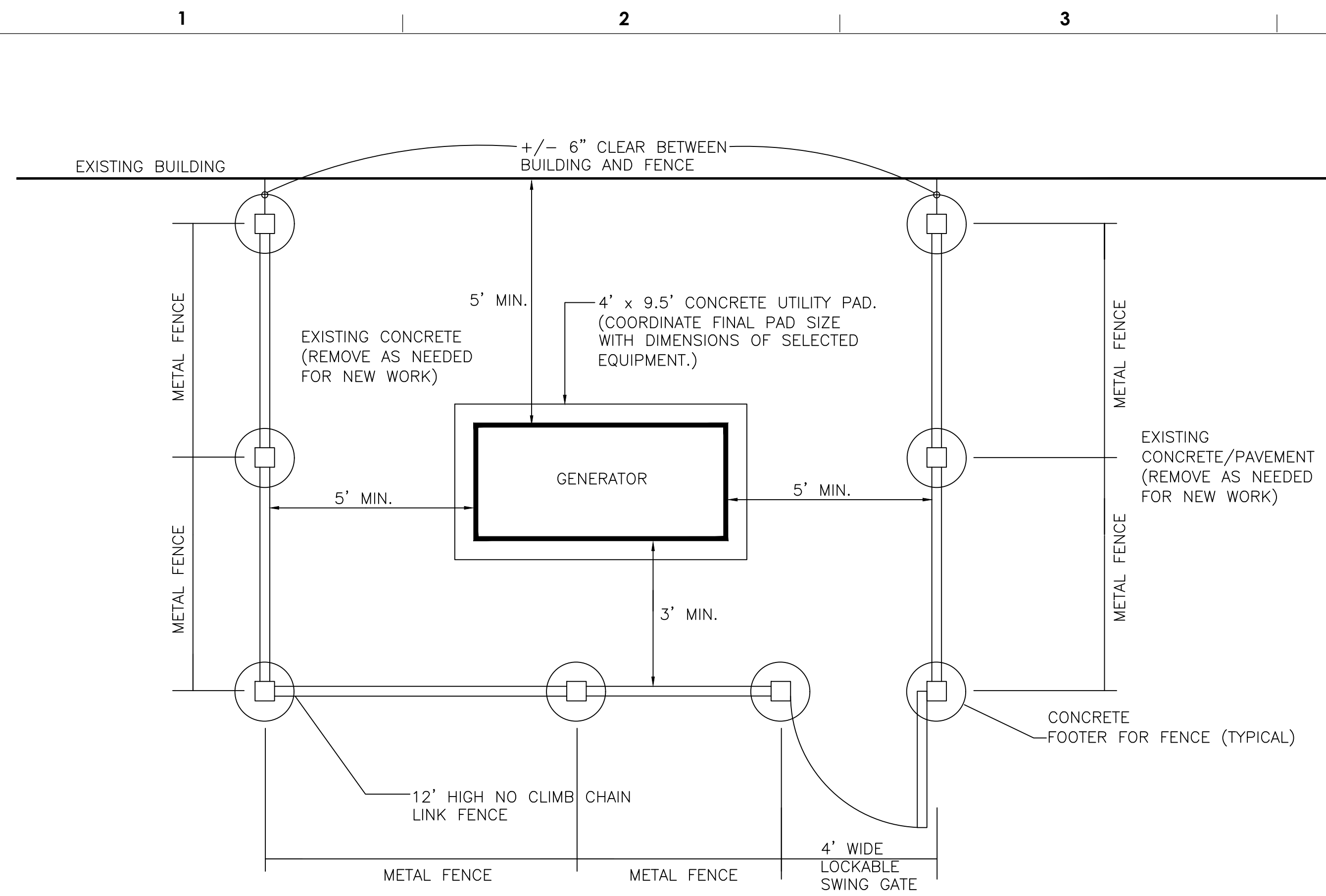

NOTES:
1. ALL DIMENSIONS TO BE VERIFIED WITH FIELD CONDITIONS.
2. METAL FENCE POST SHALL BE GROUNDED. SEE GROUNDING DETAIL.

GENERATOR FENCE PLAN 1
NOT TO SCALE

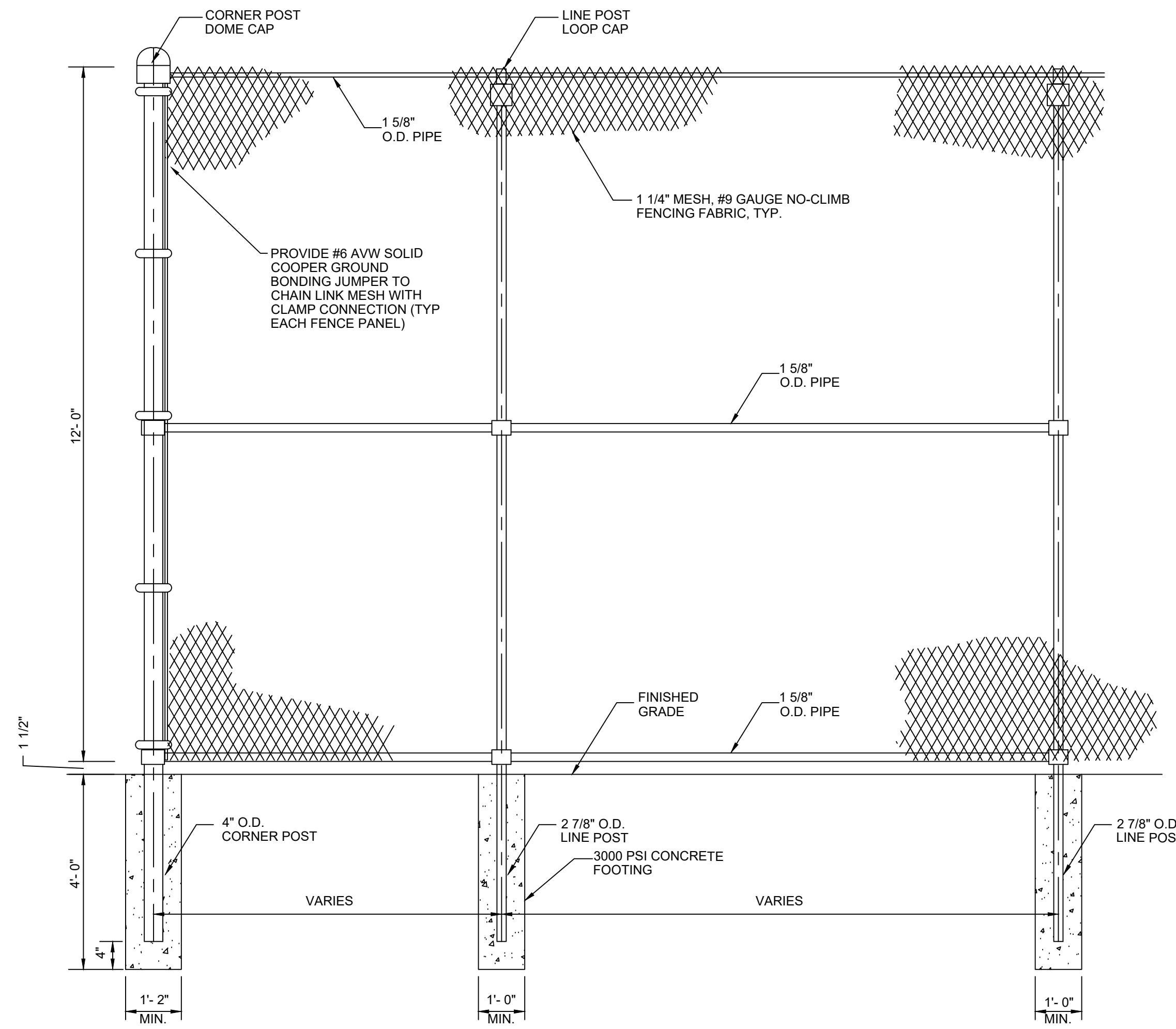

CHAIN LINK FENCE DETAIL 2
NOT TO SCALE

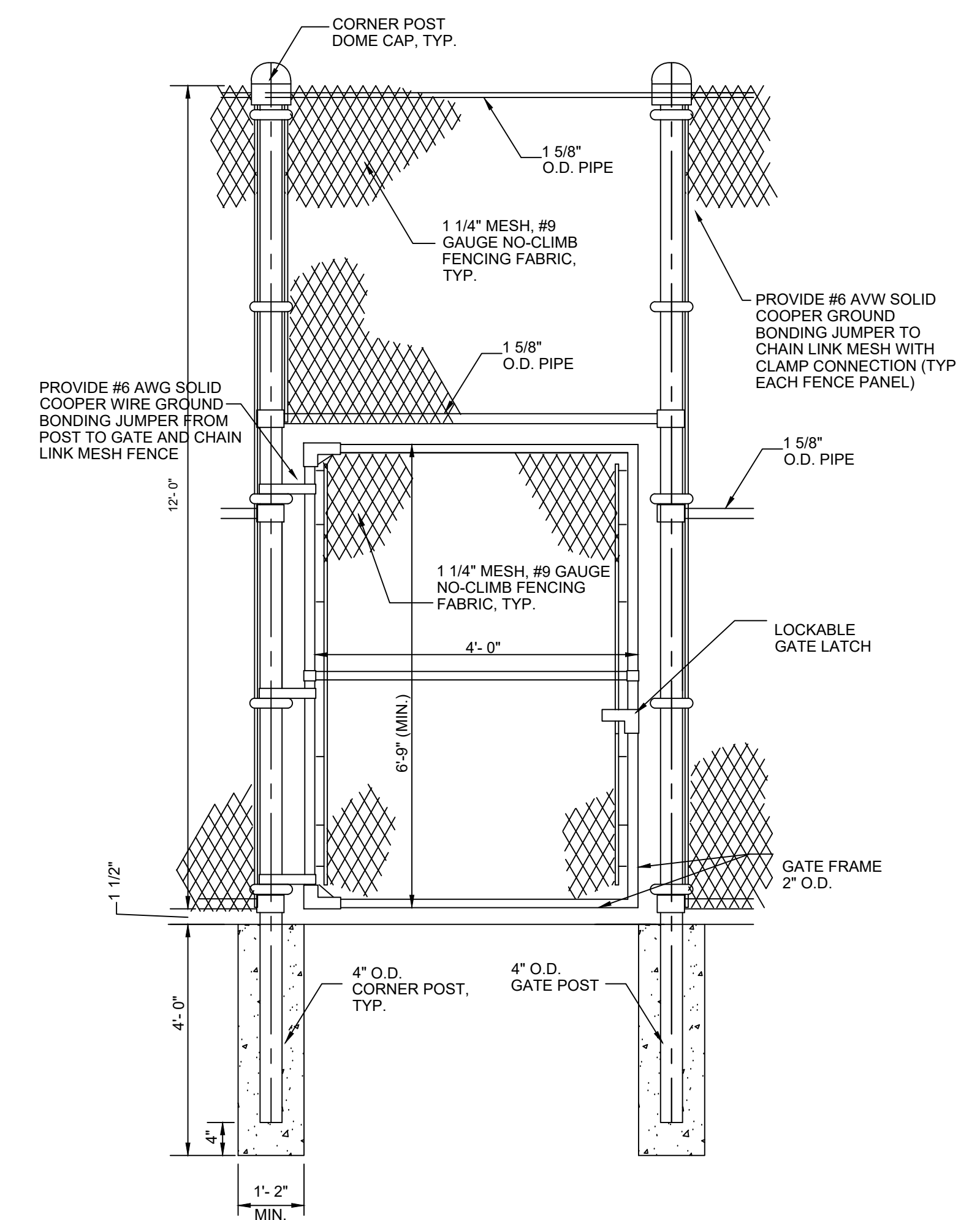

CHAIN LINK FENCE GATE DETAIL 3
NOT TO SCALE

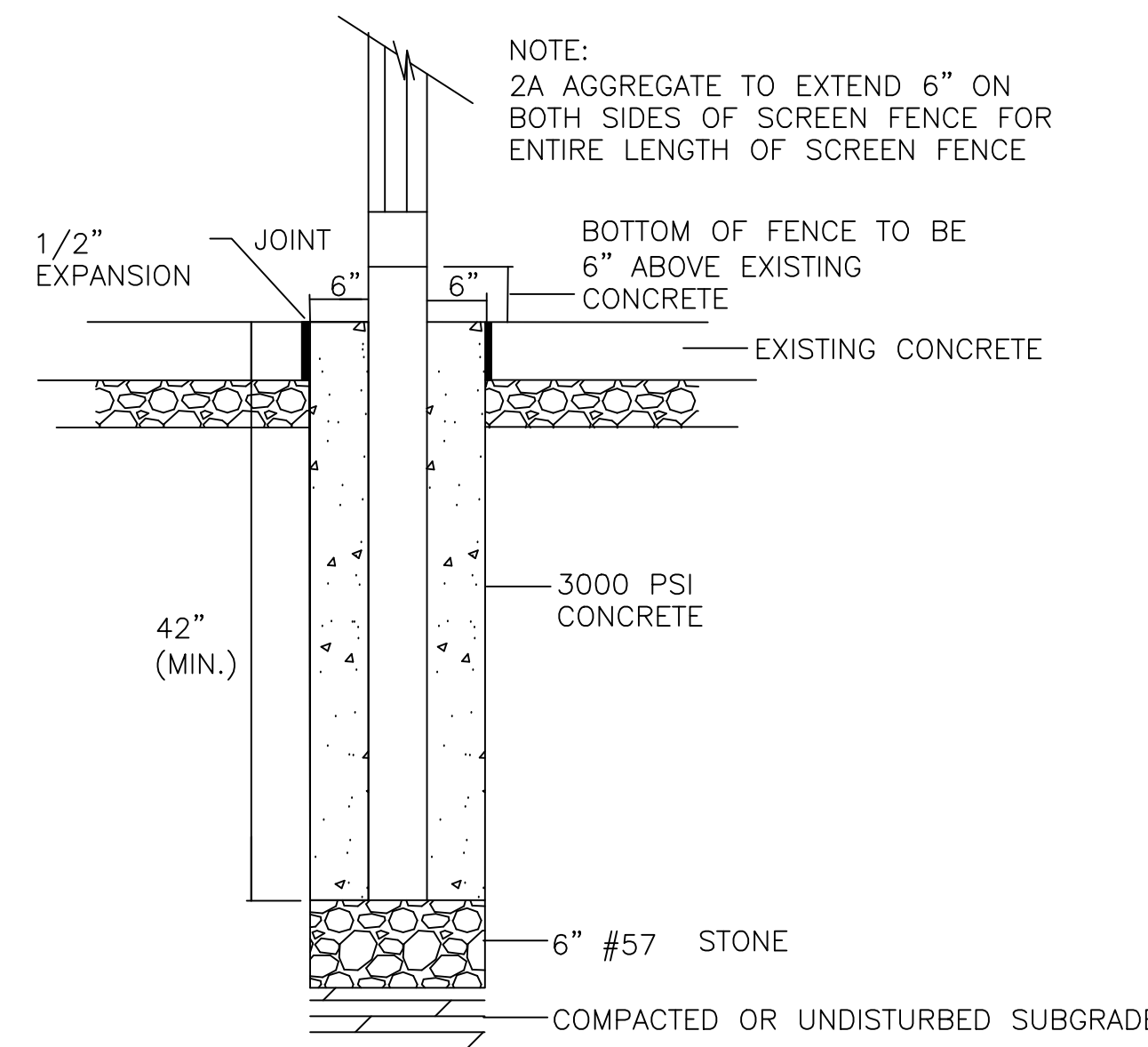

SCREEN FENCE POST FOOTER DETAIL 4
NOT TO SCALE

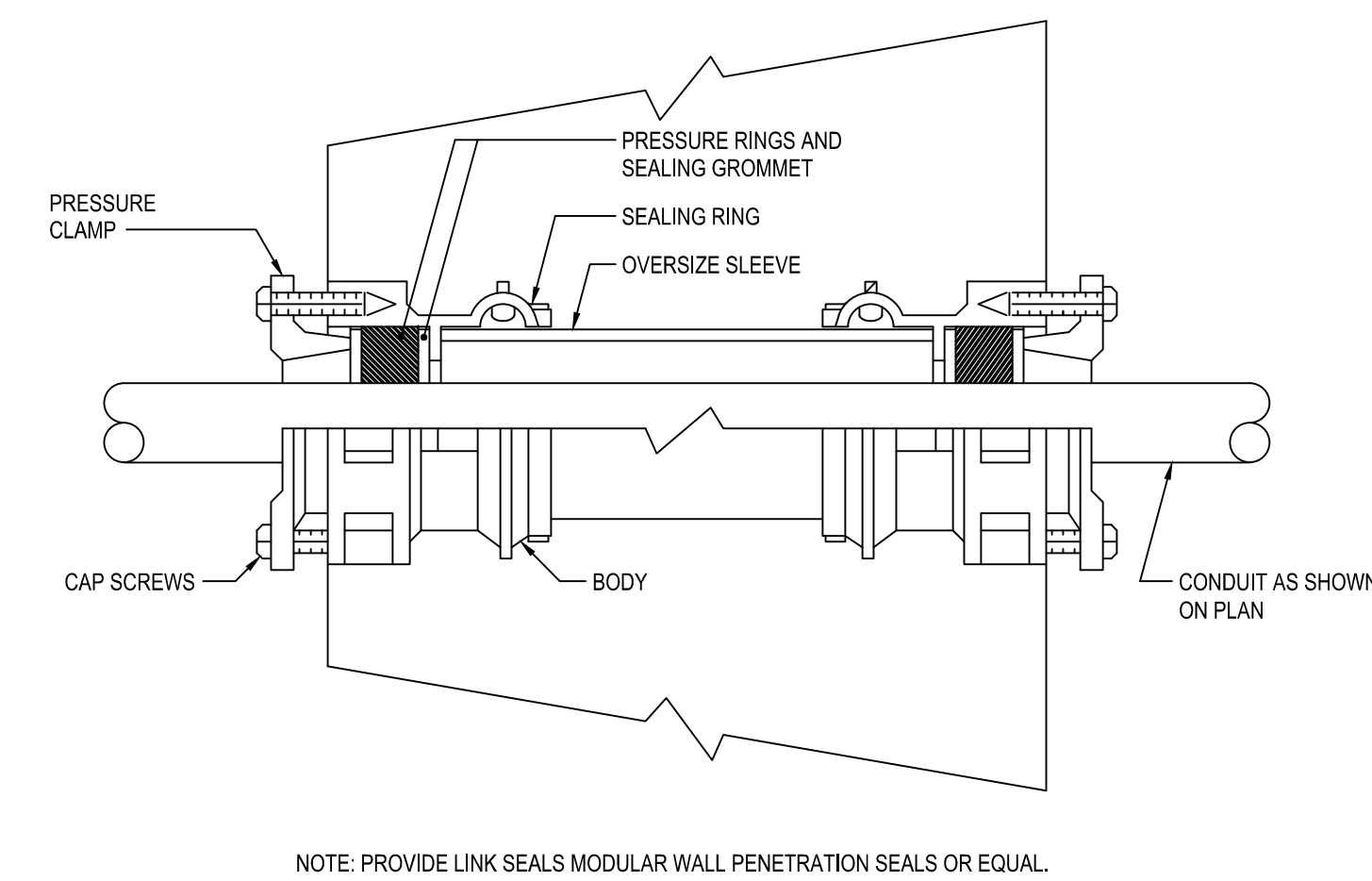

EXTERIOR WALL CONDUIT PENETRATION DETAIL 5
NOT TO SCALE

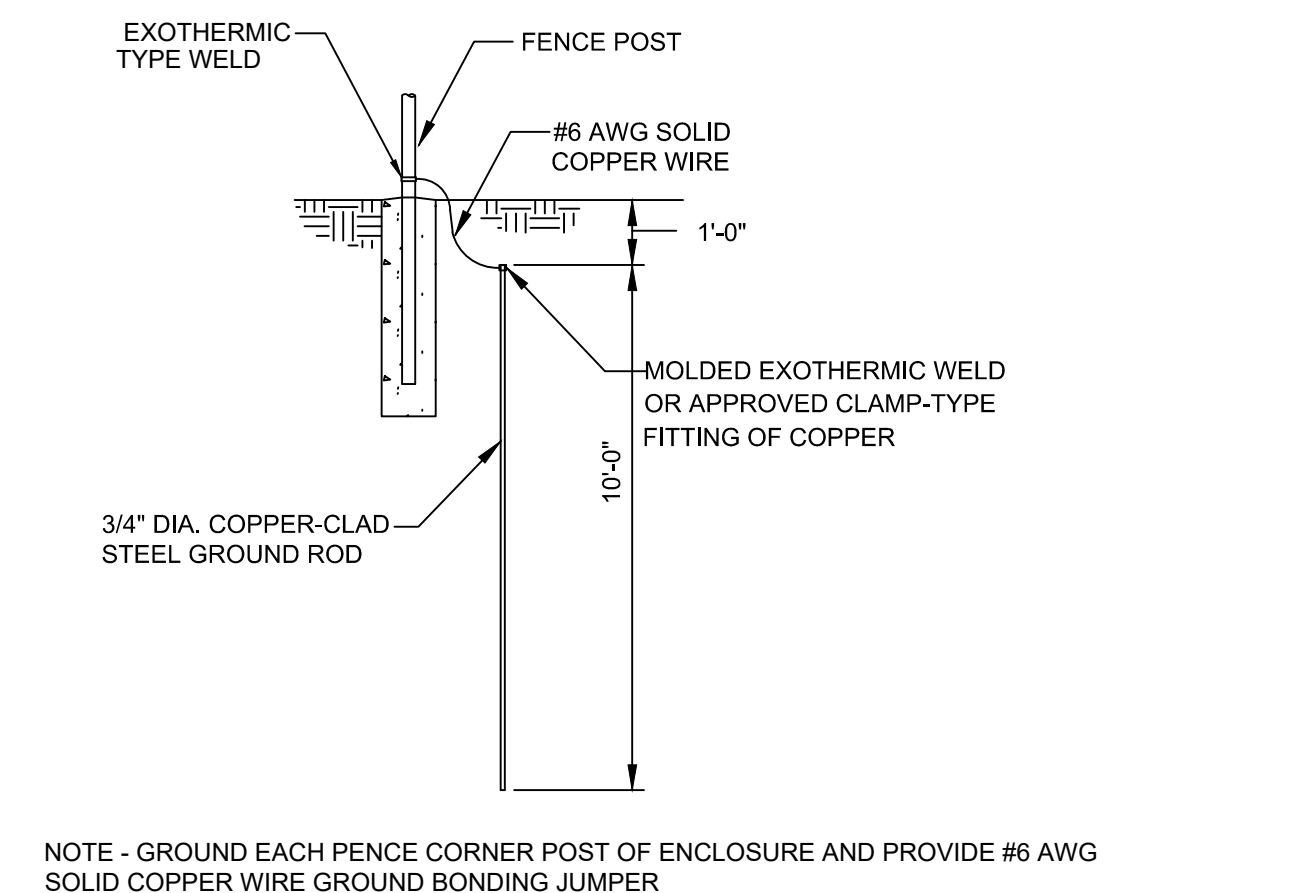

FENCE GROUNDING DETAIL 6
NOT TO SCALE

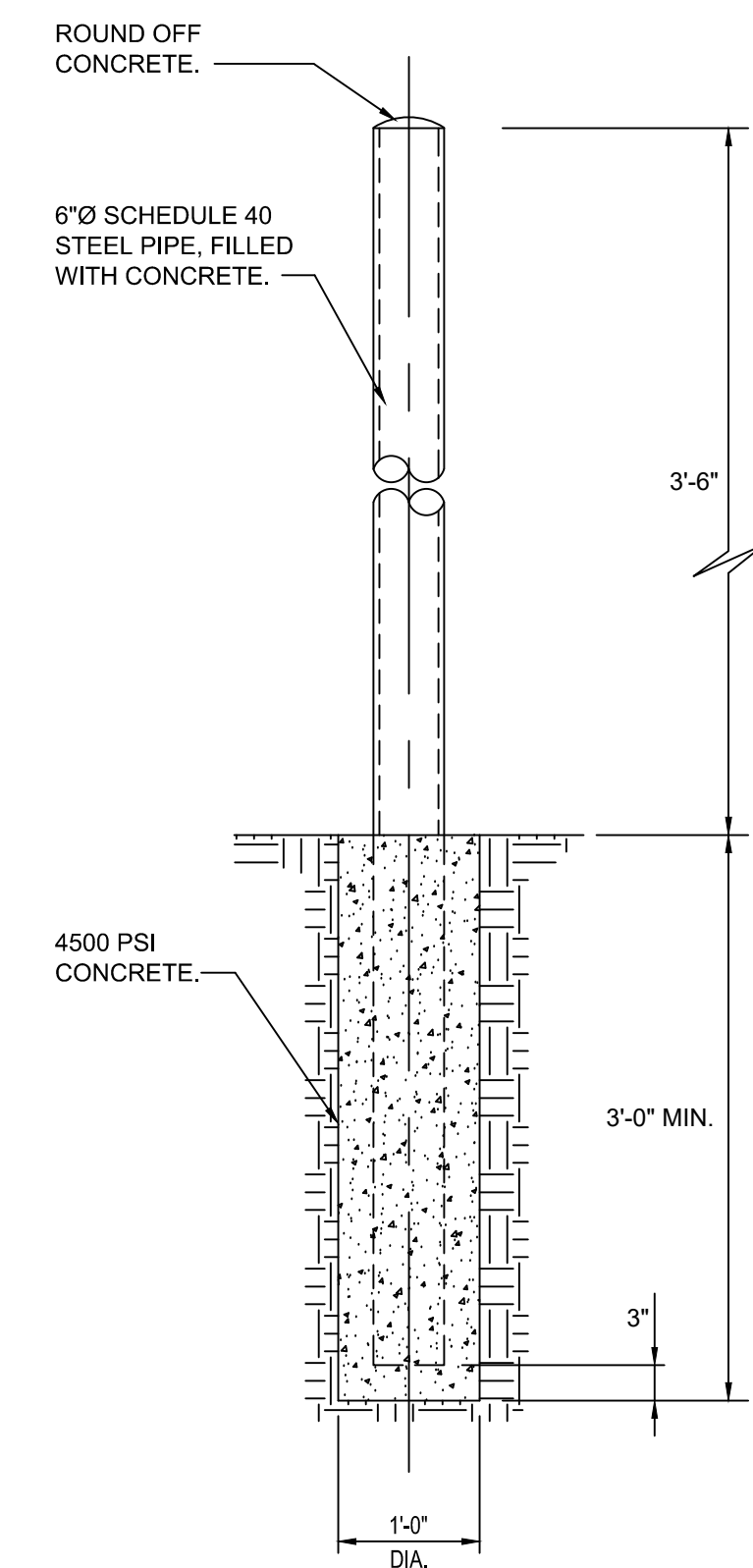

TYPICAL BOLLARD DETAIL 7
NOT TO SCALE

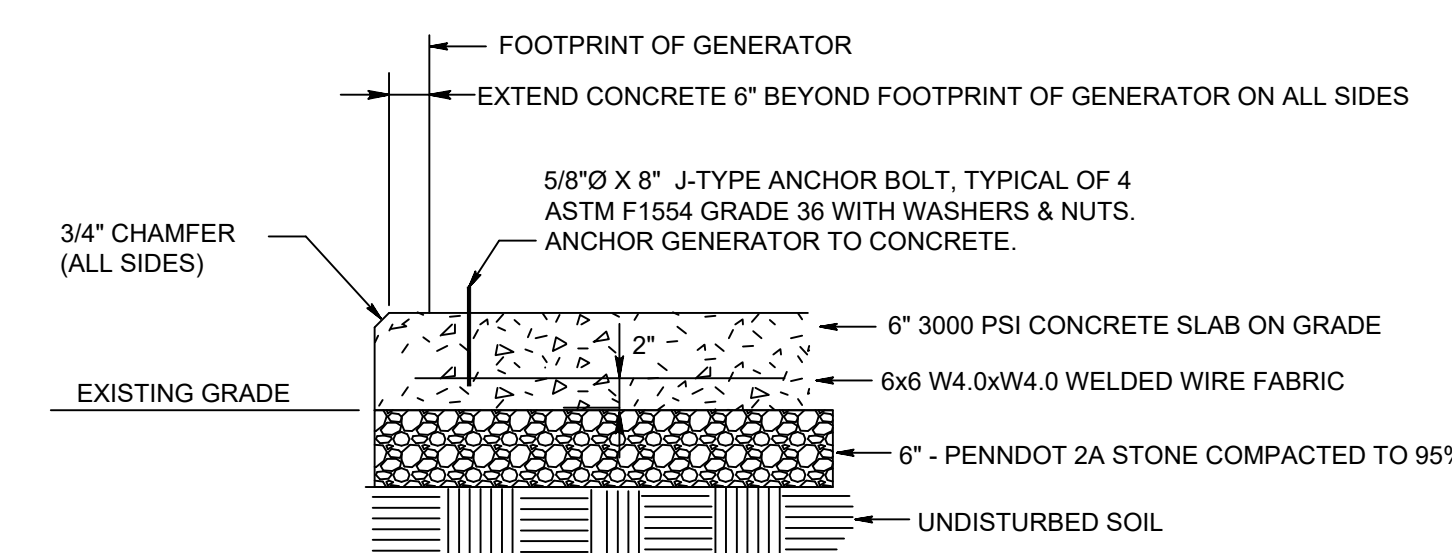

GENERATOR HOUSEKEEPING PAD DETAIL 8
NOT TO SCALE



SEAL:

HAYAN V. RIBHAI PATEL, PE
PENNSYLVANIA LICENSE NO. PE 088847

MEP Engineer

NORR

An Ingenium International Company
One Penn Center
1617 JFK Boulevard, Suite 1600
Philadelphia, PA 19103 U.S.A.
norri.com

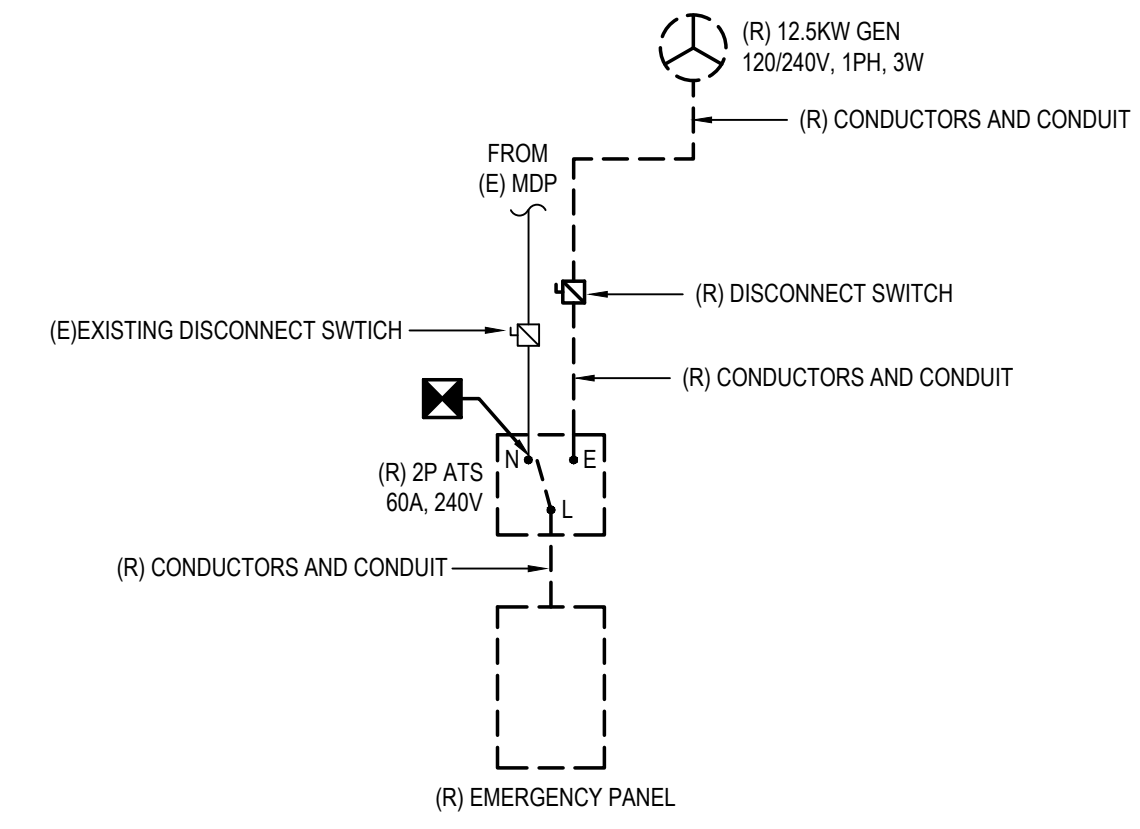

DEMOLITION SINGLE LINE DIAGRAM 3
NOT TO SCALE

NEW WORK KEY NOTES	
1	PROVIDE NEW 100A, 2 POLE, 240V, 3-WIRE ATS, ASCO 300 SERIES OR APPROVED EQUAL. ATS CONTROLLER SHALL BE PROVIDED WITH AUTOMATIC ENGINE EXERCISER FUNCTION. RECONNECT EXISTING NORMAL POWER FEEDER TO NEW ATS.
2	GENERATOR IS NOT A SEPARATELY DERIVED SYSTEM. GROUNDED NEUTRAL CONDUCTOR SHALL BE SOLIDLY INTERCONNECTED TO SUPPLY FEEDER CONDUCTORS NEUTRAL AT AUTOMATIC TRANSFER SWITCH. NEUTRAL CONDUCTOR SHALL NOT BE SWITCHED.
3	PROVIDE NEW PANEL "EM". SEE SINGLE LINE DIAGRAM AND DWG E601 FOR MORE DETAILS. RECONNECT ALL EXISTING (QTY 20) BRANCH CIRCUITS TO NEW PANEL BOARD. PROVIDE NAME PLATE PLACARDS FOR EACH BRANCH CIRCUIT. PANEL BOARD SHALL BE PROVIDED WITH (1) MCB FOR NORMAL EMERGENCY FEEDER TO PANEL BOARD. PROVIDE PLACARD LABEL FOR MAIN BREAKER. PROVIDE A TVSS FOR NEW PANEL BOARD.
4	CONTRACTOR IS RESPONSIBLE FOR FUELING OF GENERATOR TO 100%, START-UP, TESTING, COMMISSION, AND ALL MANUFACTURERS WARRANTY REQUIREMENTS.

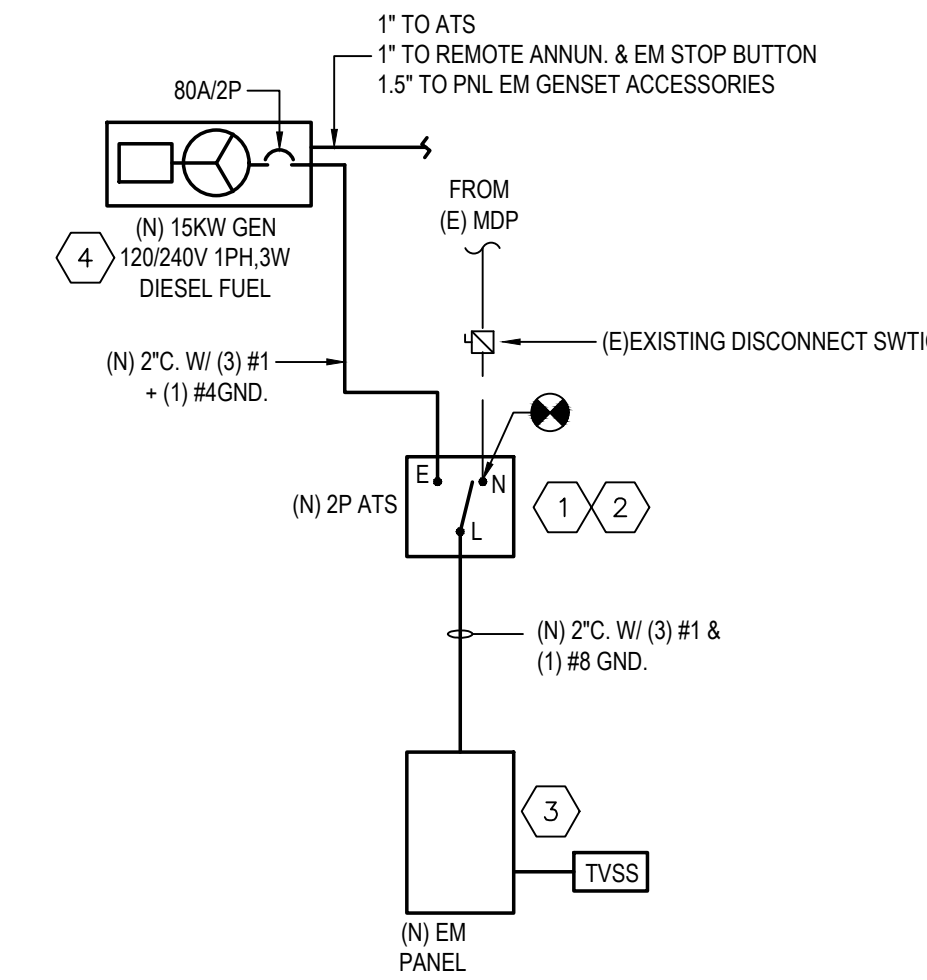

NOTE - ALL CONDUIT SHALL BE THREADED GALVANIZED RIGID METAL (STEEL) CONDUIT ONLY.

NEW WORK SINGLE LINE DIAGRAM 4
NOT TO SCALE

PANEL: EM (NEW)		VOLTAGE: 120/240V 1 PHASE 3 WIRE		BUSES: 100A AMPS 10000 AIC				
LOCATION:		MOUNTING SURFACE: FLUSH		LUGS ONLY				
FED FROM:		DENOTES ARC FAULT INTERRUPTER C.B.		MCB 80A AMPS				
		DENOTES GFI C.B. RESID		COPPER BUS ONLY				
CIR #	EQUIPMENT SERVED	FEEDER SIZE Wire GND I.G.	Breaker Amps Poles	LOAD KVA L1 L2	Breaker Amps Poles	FEEDER SIZE Wire GND I.G.	EQUIPMENT SERVED	CIR #
1	(E) EXIT LIGHTS	12 12 - 20 1	1.0	A 1.0	20 1	12 12 -	(E) EXIT LIGHTS	2
3	(E) EXTERIOR LIGHTS	12 12 - 20 1	1.0	B 1.0	20 1	12 12 -	(E) EXTERIOR LIGHTS	4
5	(E) LIBRARY LIGHTS	12 12 - 20 1	1.0	A 1.0	20 1	12 12 -	(E) LIBRARY LIGHTS	6
7	(E) BOILER RM LIGHTS	12 12 - 20 1	1.0	B 1.0	20 1	12 12 -	(E) BOILER RM LIGHTS	8
9	(E) ELECTRICAL RM LIGHTS	12 12 - 20 1	1.0	A 1.0	20 1	12 12 -	(E) SPARE	10
11	(E) SPARE	12 12 - 20 1	1.0	B 1.0	20 1	12 12 -	(E) STAIR #1 LIGHTS	12
13	(E) ALLOTORIAN LIGHTS	12 12 - 20 1	1.0	A 1.0	20 1	12 12 -	(E) STAIR #2 LIGHTS	14
15	(E) GYMNASIUM LIGHTS	12 12 - 20 1	1.0	B 1.0	20 1	12 12 -	(E) STAIR #3 LIGHTS	16
17	(E) CAFETERIA LIGHTS	10 10 - 30 2	1.0	A 1.0	20 1	12 12 -	(E) SPARE	18
19	EXISTING LOAD	- - - 20 1	1.0	B 1.0	20 1	12 12 -	(E) SPARE	20
21	(E) SPARE	12 12 - 20 1	1.0	A 1.0	20 1	12 12 -	SPARE	22
23	(N) BATTERY CHARGER	12 12 - 20 1	1.5	B 1.5	20 1	12 12 -	(N) CONV. RECEPT.	24
25	(N) ANTI-CONDENSATE HTR.	12 12 - 20 1	1.5	A 1.5	20 1	12 12 -	(N) BLOCK HEATER	26
27	(N) TVSS	10 10 - 30 2	2	A 2	20 1	12 12 -	SPARE	28
29	SPARE	- - - 20 1	1	B 1	20 1	12 12 -	SPARE	30
31	SPARE	- - - 20 1	1	A 1	20 1	12 12 -	SPARE	32
33	SPARE	- - - 20 1	1	B 1	20 1	12 12 -	SPARE	34
35	SPARE	- - - 20 1	1	A 1	20 1	12 12 -	SPARE	36
37	SPARE	- - - 20 1	1	B 1	20 1	12 12 -	SPARE	38
39	SPARE	- - - 20 1	1	A 1	20 1	12 12 -	SPARE	40
41	SPARE	- - - 20 1	1	B 1	20 1	12 12 -	SPARE	42
Remarks:		LINE TOTAL		85 85	43 5.5	PANEL SHALL BE EQUIPPED WITH BUSES FOR ALL		
		TOTAL CONN. KVA		23.0		BUSES AND SPACES SHOWN		
		TOTAL CONN. AMPS		95.6		<input type="checkbox"/> 200% NEUTRAL BUS <input type="checkbox"/> FEED THRU LUGS <input type="checkbox"/> ISOLATED GROUND BUS <input checked="" type="checkbox"/> GROUND BUS		

ADDENDUM #03
SEPTEMBER 18, 2019

NO.	DATE	REVISION
10		
9		
8		
7		
6		
5		
4		
3		
2	09/18/19	ADDENDUM #03
1	08/15/19	ADDENDUM #02

SCHOOL & LOCATION
CAMELOT ACADEMY
1435 N. 26TH STREET
PHILADELPHIA, PA 19121

PROJECT TITLE

GENERATOR REPLACEMENT

DRAWING TITLE

SCHEDULES AND DIAGRAMS

DRAWING SCALE AS NOTED	
LOCATION NO. 2310	FILE NO.
DRAWN BY AD	CHECKED BY NVP
8-036C	OF 2018 / 19 OF

DRAWING NO.

E - 601.0

SHEET 7 OF 7