

THE SCHOOL DISTRICT OF PHILADELPHIA
SCHOOL REFORM COMMISSION
Office of Capital Programs
440 North Broad Street, 3rd Floor – Suite 371
Philadelphia, PA 19130

TELEPHONE: (215) 400-4730

Addendum No. 002

**Subject: Rhawnhurst Elementary School- Additions and Renovations
SDP Contracts No. B-070 (R), B-071 (R), B-072 (R) and B-073 (R) of 2019/20**

**Location: Rhanwhurst Elementary School
7809 Castor Avenue
Philadelphia, Pennsylvania 19152**

This Addendum, dated December 16, 2021, shall modify and become part of the Contract Documents for the work of this project. Any items not mentioned herein, or affected by, shall be performed strictly in accordance with the original documents, unless modified by prior addenda.

DIVISION 01 GENERAL SPECIFICATIONS

SECTION 01 1000 – SUMMARY OF WORK

1. **ADD** the following sentence to 1.4.C.1.a.24 as follows: Removal of UST shall include removal and disposal of an estimated 400 tons of contaminated soil, to be paid on a unit price basis for actual quantities removed, in conjunction with the requirements of Section 01 1145 Soil Management and Section 01 1155 Underground Storage Tank Removal.

SECTION 01 1155 UNDERGROUND STORAGE TANK REMOVAL

1. **ADD** under Scope of Services: In addition to removal of Underground Storage Tank, contractor shall be responsible for removal and disposal of an estimated 400 tons of contaminated soil, to be paid on a unit price basis for actual quantities removed. The excess soil and/or fill material shall be disposed of in accordance with the PADEP Management of Fill Policy and Section 01 1145 SOIL MANAGEMENT.

ARCHITECTURAL SPECIFICATIONS

SECTION 087100 – DOOR HARDWARE

1. **REPLACE** Specification Section 087100 – DOOR HARDWARE in its entirety.

MECHANICAL SPECIFICATIONS

SECTION 230835 – HVAC Equipment

1. **Revise** 2.3.J.1 to be the following: Unit shall have a 35KAIC SCCR.
2. **Revise** 2.3.J.2 to be the following: Unit shall be provided with factory installed and factory wired, fused disconnect switch.
3. **Revise** 2.8.L.1 to be the following: Unit shall have a 35KAIC SCCR.

4. **Revise** 2.8.L.2 to be the following: Unit shall be provided with factory installed and factory wired, fused disconnect switch.

ARCHITECTURAL DRAWINGS

D1.3 FIRST FLOOR DEMOLITION PLANS UNITS “A” & “B”

1. **ADD** Demolition note “3A” to all existing doors in room areas B101, B110, and B111.

A1.8 SECOND FLOOR PLAN UNIT “C”

1. **REVISE** Room number C219 to C216.

A6.4 DOOR SCHEDULE

1. **REVISE** Door Hardware Sets for all doors in areas room areas B101, B110, and B111.

A6.5 DOOR SCHEDULE

1. **REVISE** Door Hardware Sets for doors C105 and C113A.
2. **REVISE** Door C219 to Door C216.

BIDDER QUESTIONS SUBMITTED TO DATE & RESPONSES ARE AS FOLLOWS:

1. Please confirm the mechanical contractor is to furnish the fused disconnect switch on the roof for MUA-1. This equipment is not listed in the table in spec 260180-1.8B.

Answer: The MC is responsible to furnish MUA-1 with a disconnect switch per section 230835.

2. Please confirm the mechanical contractor is to furnish the fused disconnect switch on the roof for exhaust fan EF-7 per 260180-1.8B.

Answer: The MC is responsible to furnish EF-7 with a disconnect switch per section 230860.

3. Please confirm the mechanical contractor is to furnish the fused disconnect switch on the roof for kitchen exhaust fan KEF-1 per 260180-1.8B.

Answer: The MC is responsible to furnish EF-7 with a disconnect switch per section 230860.

4. Please clarify whether the general contractor or the electrical contractor is to furnish the fused disconnect switches on the roof for the walk in refrigerator and walk in freezer.

Answer: The EC is responsible to provide disconnect switches for walk-in refrigerator/freezer rooftop condensing units.

5. Please clarify whether the general contractor or the electrical contractor is to furnish the fused disconnect switch for the dishwasher shown on E4.3.

Answer: The EC is responsible to provide disconnect switches for dishwashing equipment.

6. Quantity of workstations are not shown in Reception B101 on drawing I4.11. Please clarify how many type S1 fixtures are required in this room (per keynote 5 on E2.2).

Answer: Provide two (2) type S1 fixtures for Reception B101.

7. Within the "ELECTRICAL SCOPE (CONTINUED)" notes at the end of spec section 015214 Modular Classroom Building, there is a note that states for the EC to provide MC cable feeders and connections from MDP to classroom and common area panelboards. This is unclear. Based on E8.2, the modular classroom building panel "MOD" is fed from the utility. Please clarify this note.

Answer: Section 015214 was deleted from the project in Addendum 1. The School District of Philadelphia (SDP) will be providing the modular classrooms and all systems within. Provide electrical utility connections, distribution equipment and raceways as indicated on Drawings E0.2 and E8.2.

8. Within the "ELECTRICAL SCOPE (CONTINUED)" notes at the end of spec section 015214 Modular Classroom Building, please clarify what the common area refers to. Is this a space within the modular classroom building, or within the main building?

Answer: Section 015214 was deleted from the project in Addendum 1. The School District of Philadelphia (SDP) will be providing the modular classrooms and all systems within. Provide electrical utility connections, distribution equipment and raceways as indicated on Drawings E0.2 and E8.2.

9. Within the "ELECTRICAL SCOPE (CONTINUED)" notes at the end of spec section 015214 Modular Classroom Building, there is a note that states to provide a complete fire alarm system. This is impossible to bid. Please provide fire alarm device layout and/or quantities/types of devices for the modular classroom building so that the EC can bid it.

Answer: Section 015214 was deleted from the project in Addendum 1. The School District of Philadelphia (SDP) will be providing the modular classrooms and all systems within. Provide electrical utility connections, distribution equipment and raceways as indicated on Drawings E0.2 and E8.2.

10. Regarding the "ELECTRICAL SCOPE (CONTINUED)" notes at the end of spec section 015214 Modular Classroom Building, please clarify how the EC is to connect the mod classroom building's fire alarm system back to the main building's fire alarm system, as an overall fire alarm riser has not been provided. Or should the mod classroom have a standalone fire alarm system? If standalone, clarify location of telephone service connection for the mod classroom building.

Answer: Section 015214 was deleted from the project in Addendum 1. The School District of Philadelphia (SDP) will be providing the modular classrooms and all

systems within. Provide electrical utility connections, distribution equipment and raceways as indicated on Drawings E0.2 and E8.2.

11. Regarding the "ELECTRICAL SCOPE (CONTINUED)" notes at the end of spec section 015214 Modular Classroom Building, please confirm the GC is responsible for fire alarm cabling/pathways within the mod classroom building (similar to the GENERAL NOTE).

Answer: Section 015214 was deleted from the project in Addendum 1. The School District of Philadelphia (SDP) will be providing the modular classrooms and all systems within. Provide electrical utility connections, distribution equipment and raceways as indicated on Drawings E0.2 and E8.2.

12. Within the "ELECTRICAL SCOPE (CONTINUED)" notes at the end of spec section 015214 Modular Classroom Building, it states for the EC to provide associated CAT6 cabling for devices (data outlets, WAP enclosures, speakers, cameras) within the mod classroom building. However, in the GENERAL NOTE section, it states that the EC is to just provide IT to one location for the modular classroom building, and then it's the GC's responsibility from that point to make connections as needed throughout the mod classroom building. These statements are conflicting. Please clarify scope.

Answer: Section 015214 was deleted from the project in Addendum 1. The School District of Philadelphia (SDP) will be providing the modular classrooms and all systems within. Provide electrical utility connections, distribution equipment and raceways as indicated on Drawings E0.2 and E8.2.

13. Regarding the question above, if the EC is to provide CAT6 cabling for the devices within the mod classroom building, some of these devices are located over 300' from the main building's telecom rooms. CAT6 cannot be run over 300'. Please provide fiber design for the modular classroom building.

Answer: Section 015214 was deleted from the project in Addendum 1. The School District of Philadelphia (SDP) will be providing the modular classrooms and all systems within. Provide electrical utility connections, distribution equipment and raceways as indicated on Drawings E0.2 and E8.2.

14. Within the "ELECTRICAL SCOPE (CONTINUED)" notes at the end of spec section 015214 Modular Classroom Building, it states for the EC to provide cameras per SDP standards. This is impossible to bid. Please provide camera layout and/or quantities/types of devices for the modular classroom building so that the EC can bid it.

Answer: Section 015214 was deleted from the project in Addendum 1. The School District of Philadelphia (SDP) will be providing the modular classrooms and all systems within. Provide electrical utility connections, distribution equipment and raceways as indicated on Drawings E0.2 and E8.2.

ATTACHMENT

This Addendum includes the following attachments:

Architectural Drawings:

Section 087100 – DOOR HARDWARE

Architectural Drawings:

DRAWING D1.3	FIRST FLOOR DEMOLITION PLAN UNITS “A” & “B”
DRAWING A6.4	DOOR SCHEDULE
DRAWING A6.5	DOOR SCHEDULE

END OF ADDENDUM #002

SECTION 08 71 00 – DOOR HARDWARE

PART 1 - GENERAL

1.01 SUMMARY

A. Section includes:

1. Mechanical and electrified door hardware for:
 - a. Swinging doors.
 - b. Sliding doors.
2. Electronic access control system components
3. Field verification, preparation and modification of existing doors and frames to receive new door hardware.

B. Section excludes:

1. Windows
2. Cabinets (casework), including locks in cabinets
3. Signage
4. Toilet accessories
5. Overhead doors

C. Related Sections:

1. Division 01 Section "Alternates" for alternates affecting this section.
2. Division 06 Section "Rough Carpentry"
3. Division 06 Section "Finish Carpentry"
4. Division 07 Section "Joint Sealants" for sealant requirements applicable to threshold installation specified in this section.
5. Division 08 Sections:
 - a. "Metal Doors and Frames"
 - b. "Flush Wood Doors"
 - c. "Stile and Rail Wood Doors"
 - d. "Interior Aluminum Doors and Frames"
 - e. "Aluminum-Framed Entrances and Storefronts"
 - f. "Stainless Steel Doors and Frames"
 - g. "Special Function Doors"
 - h. "Entrances"
6. Division 09 sections for touchup, finishing or refinishing of existing openings modified by this section.
7. Division 26 "Electrical" sections for connections to electrical power system and for low-voltage wiring.
8. Division 28 "Electronic Safety and Security" sections for coordination with other components of electronic access control system and fire alarm system.

1.02 REFERENCES

A. UL - Underwriters Laboratories

1. UL 10B - Fire Test of Door Assemblies
2. UL 10C - Positive Pressure Test of Fire Door Assemblies
3. UL 1784 - Air Leakage Tests of Door Assemblies
4. UL 305 - Panic Hardware

B. DHI - Door and Hardware Institute

1. Sequence and Format for the Hardware Schedule
2. Recommended Locations for Builders Hardware
3. Key Systems and Nomenclature

C. NFPA – National Fire Protection Association

1. NFPA 70 – National Electric Code
2. NFPA 80 – 2016 Edition – Standard for Fire Doors and Other Opening Protectives
3. NFPA 101 – Life Safety Code
4. NFPA 105 – Smoke and Draft Control Door Assemblies
5. NFPA 252 – Fire Tests of Door Assemblies

D. ANSI - American National Standards Institute

1. ANSI/BHMA A156.1 - A156.29, and ANSI/BHMA A156.31 - Standards for Hardware and Specialties
2. ANSI/BHMA A156.28 - Recommended Practices for Keying Systems

1.03 SUBMITTALS

A. General:

1. Submit in accordance with Conditions of Contract and Division 01 Submittal Procedures.
2. Prior to forwarding submittal:
 - a. Comply with procedures for verifying existing door and frame compatibility for new hardware, as specified in PART 3, "EXAMINATION" article, herein.
 - b. Review drawings and Sections from related trades to verify compatibility with specified hardware.
 - c. Highlight, encircle, or otherwise specifically identify on submittals: deviations from Contract Documents, issues of incompatibility or other issues which may detrimentally affect the Work.

B. Action Submittals:

1. Product Data: Submit technical product data for each item of door hardware, installation instructions, maintenance of operating parts and finish, and other information necessary to show compliance with requirements.
2. Riser and Wiring Diagrams: After final approval of hardware schedule, submit details of electrified door hardware, indicating:
 - a. Wiring Diagrams: For power, signal, and control wiring and including:

- 1) Details of interface of electrified door hardware and building safety and security systems.
 - 2) Schematic diagram of systems that interface with electrified door hardware.
 - 3) Point-to-point wiring.
 - 4) Risers.
3. Samples for Verification: If requested by Architect, submit production sample of requested door hardware unit in finish indicated and tagged with full description for coordination with schedule.
- a. Samples will be returned to supplier. Units that are acceptable to Architect may, after final check of operations, be incorporated into Work, within limitations of key coordination requirements.
4. Door Hardware Schedule:
- a. Submit concurrent with submissions of Product Data, Samples, and Shop Drawings. Coordinate submission of door hardware schedule with scheduling requirements of other work to facilitate fabrication of other work critical in Project construction schedule.
 - b. Submit under direct supervision of a Door Hardware Institute (DHI) certified Architectural Hardware Consultant (AHC) or Door Hardware Consultant (DHC) with hardware sets in vertical format as illustrated by Sequence of Format for the Hardware Schedule published by DHI.
 - c. Indicate complete designations of each item required for each opening, include:
 - 1) Door Index: door number, heading number, and Architect's hardware set number.
 - 2) Quantity, type, style, function, size, and finish of each hardware item.
 - 3) Name and manufacturer of each item.
 - 4) Fastenings and other pertinent information.
 - 5) Location of each hardware set cross-referenced to indications on Drawings.
 - 6) Explanation of all abbreviations, symbols, and codes contained in schedule.
 - 7) Mounting locations for hardware.
 - 8) Door and frame sizes and materials.
 - 9) Degree of door swing and handing.
 - 10) Operational Description of openings with electrified hardware covering egress, ingress (access), and fire/smoke alarm connections.
5. Key Schedule:
- a. After Keying Conference, provide keying schedule that includes levels of keying, explanations of key system's function, key symbols used, and door numbers controlled.
 - b. Use ANSI/BHMA A156.28 "Recommended Practices for Keying Systems" as guideline for nomenclature, definitions, and approach for selecting optimal keying system.
 - c. Provide 3 copies of keying schedule for review prepared and detailed in accordance with referenced DHI publication. Include schematic keying diagram and index each key to unique door designations.
 - d. Index keying schedule by door number, keyset, hardware heading number, cross keying instructions, and special key stamping instructions.
 - e. Provide one complete bitting list of key cuts and one key system schematic illustrating system usage and expansion. Forward bitting list, key cuts and key system schematic directly to Owner, by means as directed by Owner.

- f. Prepare key schedule by or under supervision of supplier, detailing Owner's final keying instructions for locks.
6. Templates: After final approval of hardware schedule, provide templates for doors, frames and other work specified to be factory or shop prepared for door hardware installation.
- C. Informational Submittals:
1. Provide Qualification Data for Supplier, Installer and Architectural Hardware Consultant.
 2. Provide Product Data:
 - a. Certify that door hardware approved for use on types and sizes of labeled fire-rated doors complies with listed fire-rated door assemblies.
 - b. Include warranties for specified door hardware.
- D. Closeout Submittals:
1. Operations and Maintenance Data: Provide in accordance with Division 01 and include:
 - a. Complete information on care, maintenance, and adjustment; data on repair and replacement parts, and information on preservation of finishes.
 - b. Catalog pages for each product.
 - c. Factory order acknowledgement numbers (for warranty and service)
 - d. Name, address, and phone number of local representative for each manufacturer.
 - e. Parts list for each product.
 - f. Final approved hardware schedule edited to reflect conditions as-installed.
 - g. Final keying schedule
 - h. Copies of floor plans with keying nomenclature
 - i. Copy of warranties including appropriate reference numbers for manufacturers to identify project.
 - j. As-installed wiring diagrams for each opening connected to power, both low voltage and 110 volts.

1.04 QUALITY ASSURANCE

- A. Qualifications and Responsibilities:
1. Supplier: Recognized architectural hardware supplier with record of successful in-service performance for supplying door hardware similar in quantity, type, and quality to that indicated for this Project and that provides certified Architectural Hardware Consultant (AHC) or Door Hardware Consultant (DHC) available to Owner, Architect, and Contractor, at reasonable times during the Work for consultation.
 - a. Warehousing Facilities: In Project's vicinity.
 - b. Scheduling Responsibility: Preparation of door hardware and keying schedules.
 - c. Engineering Responsibility: Preparation of data for electrified door hardware, including Shop Drawings, based on testing and engineering analysis of manufacturer's standard units in assemblies similar to those indicated for this Project.
 - d. Coordination Responsibility: Assist in coordinating installation of electronic security hardware with Architect and electrical engineers and provide installation and technical data to Architect and other related subcontractors.
 - 1) Upon completion of electronic security hardware installation, inspect and verify that all components are working properly.

2. Installer: Qualified tradesperson skilled in the application of commercial grade hardware with experience installing door hardware similar in quantity, type, and quality as indicated for this Project.
 3. Architectural Hardware Consultant: Person who is experienced in providing consulting services for door hardware installations that are comparable in material, design, and extent to that indicated for this Project and meets these requirements:
 - a. For door hardware: DHI certified AHC or DHC.
 - b. Can provide installation and technical data to Architect and other related subcontractors.
 - c. Can inspect and verify components are in working order upon completion of installation.
 - d. Capable of producing wiring diagram and coordinating installation of electrified hardware with Architect and electrical engineers.
 4. Single Source Responsibility: Obtain each type of door hardware from single manufacturer.
- B. Certifications:
1. Fire-Rated Door Openings:
 - a. Provide door hardware for fire-rated openings that complies with NFPA 80 and requirements of authorities having jurisdiction.
 - b. Provide only items of door hardware that are listed products tested by Underwriters Laboratories, Intertek Testing Services, or other testing and inspecting organizations acceptable to authorities having jurisdiction for use on types and sizes of doors indicated, based on testing at positive pressure and according to NFPA 252 or UL 10C and in compliance with requirements of fire-rated door and door frame labels.
 2. Smoke and Draft Control Door Assemblies:
 - a. Provide door hardware that meets requirements of assemblies tested according to UL 1784 and installed in compliance with NFPA 105
 - b. Comply with the maximum air leakage of 0.3 cfm/sq. ft. (3 cu. m per minute/sq. m) at tested pressure differential of 0.3-inch wg (75 Pa) of water.
 3. Electrified Door Hardware
 - a. Listed and labeled as defined in NFPA 70, Article 100, by testing agency acceptable to authorities having jurisdiction.
 4. Accessibility Requirements:
 - a. Comply with governing accessibility regulations cited in "REFERENCES" article, herein for door hardware on doors in an accessible route.
- C. Pre-Installation Meetings
1. Keying Conference
 - a. Incorporate keying conference decisions into final keying schedule after reviewing door hardware keying system including:
 - 1) Function of building, flow of traffic, purpose of each area, degree of security required, and plans for future expansion.

- 2) Preliminary key system schematic diagram.
- 3) Requirements for key control system.
- 4) Requirements for access control.
- 5) Address for delivery of keys.

2. Pre-installation Conference

- a. Review and finalize construction schedule and verify availability of materials, Installer's personnel, equipment, and facilities needed to make progress and avoid delays.
- b. Inspect and discuss preparatory work performed by other trades.
- c. Inspect and discuss electrical roughing-in for electrified door hardware.
- d. Review sequence of operation for each type of electrified door hardware.
- e. Review required testing, inspecting, and certifying procedures.
- f. Review questions or concerns related to proper installation and adjustment of door hardware.

3. Electrified Hardware Coordination Conference:

- a. Prior to ordering electrified hardware, schedule and hold meeting to coordinate door hardware with security, electrical, doors and frames, and other related suppliers.

1.05 DELIVERY, STORAGE, AND HANDLING

- A. Inventory door hardware on receipt and provide secure lock-up for hardware delivered to Project site. Promptly replace products damaged during shipping.
- B. Tag each item or package separately with identification coordinated with final door hardware schedule, and include installation instructions, templates, and necessary fasteners with each item or package. Deliver each article of hardware in manufacturer's original packaging.
- C. Maintain manufacturer-recommended environmental conditions throughout storage and installation periods.
- D. Provide secure lock-up for door hardware delivered to Project. Control handling and installation of hardware items so that completion of Work will not be delayed by hardware losses both before and after installation.
- E. Handle hardware in manner to avoid damage, marring, or scratching. Correct, replace or repair products damaged during Work. Protect products against malfunction due to paint, solvent, cleanser, or any chemical agent.
- F. Deliver keys to manufacturer of key control system for subsequent delivery to Owner.

1.06 COORDINATION

- A. Coordinate layout and installation of floor-recessed door hardware with floor construction. Cast anchoring inserts into concrete.
- B. Installation Templates: Distribute for doors, frames, and other work specified to be factory or shop prepared. Check Shop Drawings of other work to confirm that adequate provisions are made for locating and installing door hardware to comply with indicated requirements.

- C. Security: Coordinate installation of door hardware, keying, and access control with Owner's security consultant.
- D. Electrical System Roughing-In: Coordinate layout and installation of electrified door hardware with connections to power supplies and building safety and security systems.
- E. Existing Openings: Where existing doors, frames and/or hardware are to remain, field verify existing functions, conditions and preparations and coordinate to suit opening conditions and to provide proper door operation.

1.07 WARRANTY

- A. Manufacturer's standard form in which manufacturer agrees to repair or replace components of door hardware that fail in materials or workmanship within published warranty period.
 - 1. Warranty does not cover damage or faulty operation due to improper installation, improper use or abuse.
 - 2. Warranty Period: Beginning from date of Substantial Completion, for durations indicated in manufacturer's published listings.
 - a. Schlage
 - 1) Key Blanks: Lifetime
 - 2) ND Series: 10 year mechanical
 - 3) Electrified Lock: 1 year electrical
 - b. Von Duprin
 - 1) Exit Device: 3 year mechanical
 - 2) Electrified Exit Device: 1 year electrical
 - c. LCN
 - 1) 4000 Series: 30 year mechanical
 - d. Ives
 - 1) Continuous Hinges: Lifetime

1.08 MAINTENANCE

- A. Furnish complete set of special tools required for maintenance and adjustment of hardware, including changing of cylinders.
- B. Turn over unused materials to Owner for maintenance purposes.

PART 2 - PRODUCTS

2.01 MANUFACTURERS

- A. The Owner requires use of certain products for their unique characteristics and project suitability to insure continuity of existing and future performance and maintenance standards. After investigating available product offerings, the Awarding Authority has elected to prepare proprietary specifications. These products are specified with the notation: "No Substitute."

1. Where "No Substitute" is noted, submittals and substitution requests for other products will not be considered.
- B. Approval of manufacturers and/or products other than those listed as "Scheduled Manufacturer" or "Acceptable Manufacturers" in the individual article for the product category shall be in accordance with QUALITY ASSURANCE article, herein.
- C. Approval of products from manufacturers indicated in "Acceptable Manufacturers" is contingent upon those products providing all functions and features and meeting all requirements of scheduled manufacturer's product.
- D. Where specified hardware is not adaptable to finished shape or size of members requiring hardware, furnish suitable types having same operation and quality as type specified, subject to Architect's approval.

2.02 MATERIALS

A. Fasteners

1. Provide hardware manufactured to conform to published templates, generally prepared for machine screw installation.
2. Furnish screws for installation with each hardware item. Finish exposed (exposed under any condition) screws to match hardware finish, or, if exposed in surfaces of other work, to match finish of this other work including prepared for paint surfaces to receive painted finish.
3. Provide concealed fasteners for hardware units exposed when door is closed except when no standard units of type specified are available with concealed fasteners. Do not use thru-bolts for installation where bolt head or nut on opposite face is exposed in other work unless thru-bolts are required to fasten hardware securely. Review door specification and advise Architect if thru-bolts are required.
4. Install hardware with fasteners provided by hardware manufacturer.

B. Modification and Preparation of Existing Doors: Where existing door hardware is indicated to be removed and reinstalled.

1. Provide necessary fillers, Dutchmen, reinforcements, and fasteners, compatible with existing materials, as required for mounting new opening hardware and to cover existing door and frame preparations.
2. Use materials which match materials of adjacent modified areas.
3. When modifying existing fire-rated openings, provide materials permitted by NFPA 80 as required to maintain fire-rating.

C. Provide screws, bolts, expansion shields, drop plates and other devices necessary for hardware installation.

1. Where fasteners are exposed to view: Finish to match adjacent door hardware material.

D. Cable and Connectors: Hardwired Electronic Access Control Lockset and Exit Device Trim:

1. Data: 24AWG, 4 conductor shielded, Belden 9843, 9841 or comparable.
2. DC Power: 18 AWG, 2 conductor, Belden 8760 or comparable.
3. Provide type of data and DC power cabling required by access control device manufacturer for this installation.

4. Where scheduled in the hardware sets, provide each item of electrified hardware and wire harnesses with sufficient number and wire gauge with standardized Molex plug connectors to accommodate electric function of specified hardware. Provide Molex connectors that plug directly into connectors from harnesses, electric locking and power transfer devices. Provide through-door wire harness for each electrified locking device installed in a door and wire harness for each electrified hinge, electrified continuous hinge, electrified pivot, and electric power transfer for connection to power supplies.

2.03 HINGES

A. Manufacturers and Products:

1. Scheduled Manufacturer and Product: Ives 5BB series.
2. Acceptable Manufacturers and Products: Hager BB series, McKinney TAT4A series, Stanley FBB Series.

B. Requirements:

1. Provide hinges conforming to ANSI/BHMA A156.1.
2. 1-3/4 inch (44 mm) thick doors, up to and including 36 inches (914 mm) wide:
 - a. Exterior: Standard weight, bronze or stainless steel, 4-1/2 inches (114 mm) high
 - b. Interior: Standard weight, steel, 4-1/2 inches (114 mm) high
3. 1-3/4 inch (44 mm) thick doors over 36 inches (914 mm) wide:
 - a. Exterior: Heavy weight, bronze/stainless steel, 5 inches (127 mm) high
 - b. Interior: Heavy weight, steel, 5 inches (127 mm) high
4. 2 inches or thicker doors:
 - a. Exterior: Heavy weight, bronze or stainless steel, 5 inches (127 mm) high
 - b. Interior: Heavy weight, steel, 5 inches (127 mm) high
5. Provide three hinges per door leaf for doors 90 inches (2286 mm) or less in height, and one additional hinge for each 30 inches (762 mm) of additional door height.
6. Where new hinges are specified for existing doors or existing frames, provide new hinges of identical size to hinge preparation present in existing door or existing frame.
7. Hinge Pins: Except as otherwise indicated, provide hinge pins as follows:
 - a. Steel Hinges: Steel pins
 - b. Non-Ferrous Hinges: Stainless steel pins
 - c. Out-Swinging Exterior Doors: Non-removable pins
 - d. Out-Swinging Interior Lockable Doors: Non-removable pins
 - e. Interior Non-lockable Doors: Non-rising pins
8. Width of hinges: 4-1/2 inches (114 mm) at 1-3/4 inch (44 mm) thick doors, and 5 inches (127 mm) at 2 inches (51 mm) or thicker doors. Adjust hinge width as required for door, frame, and wall conditions to allow proper degree of opening.
9. Provide hinges with electrified options as scheduled in the hardware sets. Provide with sufficient number and wire gauge to accommodate electric function of specified hardware. Locate electric hinge at second hinge from bottom or nearest to electrified locking component.
10. Provide mortar guard for each electrified hinge specified.

11. Provide spring hinges where specified. Provide two spring hinges and one bearing hinge per door leaf for doors 90 inches (2286 mm) or less in height. Provide one additional bearing hinge for each 30 inches (762 mm) of additional door height.

2.04 CONTINUOUS HINGES

A. Aluminum Geared

1. Manufacturers:

- a. Scheduled Manufacturer: Ives.
- b. Acceptable Manufacturers: Select, Stanley.

2. Requirements:

- a. Provide aluminum geared continuous hinges conforming to ANSI/BHMA A156.26, Grade 1.
- b. Provide aluminum geared continuous hinges, where specified in the hardware sets, fabricated from 6063-T6 aluminum.
- c. Provide split nylon bearings at each hinge knuckle for quiet, smooth, self-lubricating operation.
- d. Provide hinges capable of supporting door weights up to 450 pounds, and successfully tested for 1,500,000 cycles.
- e. On fire-rated doors, provide aluminum geared continuous hinges that are classified for use on rated doors by testing agency acceptable to authority having jurisdiction.
- f. Provide aluminum geared continuous hinges with electrified option scheduled in the hardware sets. Provide with sufficient number and wire gage to accommodate electric function of specified hardware.
- g. Install hinges with fasteners supplied by manufacturer.
- h. Provide hinges 1 inch (25 mm) shorter in length than nominal height of door, unless otherwise noted or door details require shorter length and with symmetrical hole pattern.

2.05 ELECTRIC POWER TRANSFER

A. Manufacturers:

- a. Scheduled Manufacturer: Von Duprin EPT-10.
- b. Acceptable Manufacturers: ABH PT1000, Securitron CEPT-10.

B. Provide power transfer with electrified options as scheduled in the hardware sets. Provide with number and gage of wires sufficient to accommodate electric function of specified hardware.

C. Locate electric power transfer per manufacturer's template and UL requirements, unless interference with operation of door or other hardware items.

2.06 FLUSH BOLTS

A. Manufacturers:

1. Scheduled Manufacturer: Ives.

2. Acceptable Manufacturers: Burns, Rockwood.

B. Requirements:

1. Provide automatic, constant latching, and manual flush bolts with forged bronze or stainless-steel face plates, extruded brass levers, and with wrought brass guides and strikes. Provide 12 inch (305 mm) steel or brass rods at doors up to 90 inches (2286 mm) in height. For doors over 90 inches (2286 mm) in height increase top rods by 6 inches (152 mm) for each additional 6 inches (152 mm) of door height. Provide dust-proof strikes at each bottom flush bolt.

2.07 COORDINATORS

A. Manufacturers:

1. Scheduled Manufacturer: Ives.
2. Acceptable Manufacturers: Burns, Rockwood.

B. Requirements:

1. Where pairs of doors are equipped with automatic flush bolts, an astragal, or other hardware that requires synchronized closing of the doors, provide bar-type coordinating device, surface applied to underside of stop at frame head.
2. Provide filler bar of correct length for unit to span entire width of opening, and appropriate brackets for parallel arm door closers, surface vertical rod exit device strikes or other stop mounted hardware. Factory-prepared coordinators for vertical rod devices as specified.

2.08 CYLINDRICAL LOCKS – GRADE 1

A. Manufacturers and Products:

1. Scheduled Manufacturer and Product: Schlage ND series.
2. Acceptable Manufacturers and Products: Corbin-Russwin CL3100 series.

B. Requirements:

1. Provide cylindrical locks conforming to ANSI/BHMA A156.2 Series 4000, Grade 1, and UL Listed for 3 hour fire doors.
2. Cylinders: Refer to "KEYING" article, herein.
3. Provide locks with standard 2-3/4 inches (70 mm) backset, unless noted otherwise, with 1/2 inch latch throw. Provide proper latch throw for UL listing at pairs.
4. Provide locksets with separate anti-rotation thru-bolts, and no exposed screws.
5. Provide independently operating levers with two external return spring cassettes mounted under roses to prevent lever sag.
6. Provide standard ASA strikes unless extended lip strikes are necessary to protect trim.
7. Provide electrified options as scheduled in the hardware sets.
8. Lever Trim: Solid cast levers without plastic inserts and wrought roses on both sides.
 - a. Lever Design: Schlage Sparta

2.09 DEADBOLTS:

A. Manufacturers and Products:

1. Scheduled Manufacturer and Product: Schlage B600 Series.
2. Acceptable Manufacturers and Products:
 - a. Best T Series
 - b. Corbin-Russwin DL3000 Series
 - c. Sargent 480 Series

B. Requirements:

1. Provide deadbolt series conforming to ANSI/BHMA A156.
2. Cylinders: Refer to "KEYING" article, herein.
3. Provide deadbolts with standard 2-3/4 inches (70 mm) backset. Provide 2-3/8 inches (60 mm) where noted or if door or frame detail requires. Provide deadbolt with full 1-inch (25 mm) throw, constructed of steel alloy.
4. Provide manufacturer's standard strike.

2.10 EXIT DEVICES

A. Manufacturers and Products:

1. Scheduled Manufacturer and Product: Von Duprin 35A / 98 series.
2. Acceptable Manufacturers and Products: Detex Advantex series, Precision APEX 2000 series, Sargent 80 series.

B. Requirements:

1. Provide exit devices tested to ANSI/BHMA A156.3 Grade 1 and UL listed for Panic Exit or Fire Exit Hardware.
2. Cylinders: Refer to "KEYING" article, herein.
3. Provide touchpad type exit devices, fabricated of brass, bronze, stainless steel, or aluminum, plated to standard architectural finishes to match balance of door hardware.
4. Touchpad must extend a minimum of one half of door width. No plastic inserts are allowed in touchpads.
5. Provide exit devices with deadlatching feature for security and for future addition of alarm kits and/or other electrified requirements.
6. Provide flush end caps for exit devices.
7. Provide exit devices with manufacturer's approved strikes.
8. Provide exit devices cut to door width and height. Install exit devices at height recommended by exit device manufacturer, allowable by governing building codes, and approved by Architect.
9. Mount mechanism case flush on face of doors, or provide spacers to fill gaps behind devices. Where glass trim or molding projects off face of door, provide glass bead kits.
10. Provide cylinder or hex-key dogging as specified at non fire-rated openings.
11. Provide dogging indicators (CDSI/HDSI) for visible indication of dogging status.
12. Removable Mullions: 2 inches (51 mm) x 3 inches (76 mm) steel tube. Where scheduled as keyed removable mullion, provide type that can be removed by use of a keyed cylinder, which is self-locking when re-installed.
13. Provide factory drilled weep holes for exit devices used in full exterior application, highly corrosive areas, and where noted in hardware sets.
14. Provide electrified options as scheduled.

15. Concealed Vertical Cable Exit Devices: provide cable-actuated concealed vertical latch system in two-point for non-rated or fire rated wood doors up to a 90 minute rating and less bottom latch (LBL) configuration for non-rated or fire rated wood doors up to 20 minute rating. Vertical rods not permitted.
 - a. Cable: Stainless steel with abrasive resistant coating. Conduit and core wire ends snap into latch and center slides without use of tools.
 - b. Wood Door Prep: Maximum 1 inch x 1.1875 inch x 3.875 inches top latch pocket and 1 inch x 1.1875 inch x 5 inches bottom latch pocket which does not require the use of a metal wrap or edge for non-rated or fire rated wood doors up to a 45 minute rating.
 - c. Latchbolts and Blocking Cams: Manufactured from sintered metal low carbon copper-infiltrated steel, with molybdenum disulfide low friction coating.
 - d. Top Latchbolt: Minimum 0.38 inch (10 mm) and greater than 90 degree engagement with strike to prevent door and frame separation under high static load.
 - e. Bottom Latchbolt: Minimum of 0.44 inch (11 mm) engagement with strike.
 - f. Product Cycle Life: 1,000,000 cycles.
 - g. Latch Operation: Top and bottom latch operate independently of each other. Top latch fully engages top strike even when bottom latch is compromised. Separate trigger mechanisms not permitted.
 - h. Latch release does not require separate trigger mechanism.
 - i. Cable and latching system characteristics:
 - 1) Installed independently of exit device installation, and capable of functioning on door prior to device and trim installation.
 - 2) Connected to exit device at single point in steel and aluminum doors, and two points for top and bottom latches in wood doors.
 - 3) Bottom latch height adjusted, from single point for steel and aluminum doors and two points for wood doors, after system is installed and connected to exit device, while door is hanging
 - 4) Bottom latch position altered up and down minimum of 2 inches (51 mm) in steel and aluminum doors without additional adjustment. Bottom latch deadlocks in every adjustment position in wood doors.
 - 5) Top and bottom latches in steel and aluminum doors and top latch in wood doors may be removed while door is hanging.
16. Top latch mounting: double or single tab mount for steel doors, face mount for aluminum doors eliminating requirement of tabs, and double tab mount for wood doors.
17. Provide exit devices with optional trim designs to match other lever and pull designs used on the project.

2.11 ELECTRIC STRIKES

A. Manufacturers and Products:

1. Scheduled Manufacturer and Product: Von Duprin 6000 Series.
2. Acceptable Manufacturers and Products: Folger Adam 300 Series, HES 1006 Series.

B. Requirements:

1. Provide electric strikes designed for use with type of locks shown at each opening.
2. Provide electric strikes UL Listed as burglary-resistant.
3. Where required, provide electric strikes UL Listed for fire doors and frames.
4. Provide transformers and rectifiers for each strike as required. Verify voltage with electrical contractor.

2.12 MAGNETIC LOCKS

A. Manufacturers and Products:

1. Scheduled Manufacturer and Product: Schlage M450 series.
2. Acceptable Manufacturers and Products: Dynalock 2000 series, Securitron M62BD Series

B. Requirements:

1. Provide magnetic locks certified to meet ANSI/BHMA A156.23 classification criteria including minimum holding force of 1,000lbs. Provide magnetic locks equipped with SPDT Magnetic Bond Sensing device, where specified, to monitor whether enough magnetic holding force exists to ensure adequate locking and SPDT Door Status Monitor device, where specified, to monitor whether door is open or closed. Provide bond sensors fully concealed within electromagnet to resist tampering or damage.
2. Provide magnetic locks certified to meet UL10C, and UL1034 for burglary-resistant electronic locking mechanisms.
3. Provide fasteners, mounting brackets, and spacer bars required for mounting and details.
4. Provide power supply recommended and approved by manufacturer of magnetic locks.
5. Where magnetic locks are scheduled, provide complete assemblies of controls, switches, power supplies, relays, and parts/material recommended and approved by manufacturer of magnetic locks for each individual leaf. Switches control both doors simultaneously at pairs. Locate controls as directed by Architect.

2.13 POWER SUPPLIES

A. Manufacturers and Products:

1. Scheduled Manufacturer and Product: Schlage/Von Duprin PS900 series.
2. Acceptable Manufacturers and Products: Precision ELR series, Sargent 3500 series,

B. Requirements:

1. Provide power supplies approved by manufacturer of supplied electrified hardware.
2. Provide appropriate quantity of power supplies necessary for proper operation of electrified locking components as recommended by manufacturer of electrified locking components with consideration for each electrified component using power supply, location of power supply, and approved wiring diagrams. Locate power supplies as directed by Architect.
3. Provide regulated and filtered 24 VDC power supply, and UL class 2 listed.
4. Provide power supplies with the following features:
 - a. 12/24 VDC Output, field selectable.
 - b. Class 2 Rated power limited output.
 - c. Universal 120-240 VAC input.
 - d. Low voltage DC, regulated and filtered.
 - e. Polarized connector for distribution boards.
 - f. Fused primary input.
 - g. AC input and DC output monitoring circuit w/LED indicators.
 - h. Cover mounted AC Input indication.
 - i. Tested and certified to meet UL294.
 - j. NEMA 1 enclosure.
 - k. Hinged cover w/lock down screws.

- I. High voltage protective cover.

2.14 CYLINDERS

A. Manufacturers and Products:

1. Scheduled Manufacturer and Product: Schlage Classic C – No Substitution

B. Requirements:

1. Provide cylinders/cores, compliant with ANSI/BHMA A156.5; latest revision; cylinder face finished to match lockset, manufacturer's series as indicated. Refer to "KEYING" article, herein.
2. Provide cylinders in the below-listed configuration(s), distributed throughout the Project as indicated.
 - a. Conventional Patented Open: cylinder with interchangeable core with open keyway.
3. Nickel silver bottom pins.

C. Construction Keying:

1. Replaceable Construction Cores.
 - a. Provide temporary construction cores replaceable by permanent cores, furnished in accordance with the following requirements.
 - 1) 3 construction control keys
 - 2) 12 construction change (day) keys.
 - b. Owner or Owner's Representative will replace temporary construction cores with permanent cores.

2.15 KEYING

- ### A. Provide a factory registered keying system, complying with guidelines in ANSI/BHMA A156.28, incorporating decisions made at keying conference.

B. Requirements:

1. Provide permanent cylinders/cores keyed by the manufacturer according to the following key system.
 - a. Master Keying system as directed by the Owner.
2. Forward bitting list and keys separately from cylinders, by means as directed by Owner. Failure to comply with forwarding requirements will be cause for replacement of cylinders/cores involved at no additional cost to Owner.
3. Provide keys with the following features:
 - a. Material: Nickel silver; minimum thickness of .107-inch (2.3mm)
4. Identification:

- a. Mark permanent cylinders/cores and keys with applicable blind code per DHI publication "Keying Systems and Nomenclature" for identification. Do not provide blind code marks with actual key cuts.
 - b. Identification stamping provisions must be approved by the Architect and Owner.
 - c. Stamp cylinders/cores and keys with Owner's unique key system facility code as established by the manufacturer; key symbol and embossed or stamped with "DO NOT DUPLICATE" along with the "PATENTED" or patent number to enforce the patent protection.
 - d. Failure to comply with stamping requirements will be cause for replacement of keys involved at no additional cost to Owner.
 - e. Forward permanent cylinders/cores to Owner, separately from keys, by means as directed by Owner.
5. Quantity: Furnish in the following quantities.
- a. Change (Day) Keys: 3 per cylinder/core.
 - b. Permanent Control Keys: 3.
 - c. Master Keys: 6.

2.16 KEY CONTROL SYSTEM

A. Manufacturers:

1. Scheduled Manufacturer: Telkee.
2. Acceptable Manufacturers: HPC, Lund.

B. Requirements:

1. Provide key control system, including envelopes, labels, tags with self-locking key clips, receipt forms, 3-way visible card index, temporary markers, permanent markers, and standard metal cabinet, all as recommended by system manufacturer, with capacity for 150% of number of locks required for Project.
 - a. Provide complete cross index system set up by hardware supplier, and place keys on markers and hooks in cabinet as determined by final key schedule.
 - b. Provide hinged-panel type cabinet for wall mounting.

2.17 KEY LOCK BOX

A. Manufacturers:

1. Scheduled Manufacturer: Knox Company
2. Acceptable Manufacturers:

B. Requirements

1. Provide Knox Box 3200 Series recessed key lock box, or equal.
2. Provide lock box meeting the requirements of UL 1037, UL 1610, UL 1332, and UL 437.
3. Provide lock box capable of storing a maximum of 10 keys.
4. Provide lock box with hinged door and weather-resistant door gasket.
5. Provide recessed mounting kit for new concrete or masonry construction.

2.18 DOOR CLOSERS

A. Manufacturers and Products:

1. Scheduled Manufacturer and Product: LCN 4010/4110/4020 series.
2. Acceptable Manufacturers and Products: Corbin-Russwin DC8000 series, Sargent 281 series.

B. Requirements:

1. Provide door closers conforming to ANSI/BHMA A156.4 Grade 1 requirements by BHMA certified independent testing laboratory. Certify surface mounted mechanical closers to meet fifteen million (15,000,000) full load cycles. ISO 9000 certify closers. Stamp units with date of manufacture code.
2. Provide door closers with fully hydraulic, full rack and pinion action with high strength cast iron cylinder, and full complement bearings at shaft.
3. Cylinder Body: 1-1/2 inch (38 mm) diameter with 11/16 inch (17 mm) diameter double heat-treated pinion journal.
4. Hydraulic Fluid: Fireproof, passing requirements of UL10C, and requiring no seasonal closer adjustment for temperatures ranging from 120 degrees F to -30 degrees F.
5. Spring Power: Continuously adjustable over full range of closer sizes, and providing reduced opening force as required by accessibility codes and standards.
6. Hydraulic Regulation: By tamper-proof, non-critical valves, with separate adjustment for latch speed, general speed, and backcheck.
7. Provide closers with solid forged steel main arms and factory assembled heavy-duty forged forearms for parallel arm closers. When closers are parallel arm mounted, provide closers which mount within 6-inch (152 mm) top rail without use of mounting plate so that closer is not visible through vision panel from pull side.
8. Pressure Relief Valve (PRV) Technology: Not permitted.
9. Finish for Closer Cylinders, Arms, Adapter Plates, and Metal Covers: Powder coating finish which has been certified to exceed 100 hours salt spray testing as described in ANSI/BHMA Standard A156.4 and ASTM B117, or has special rust inhibitor (SRI).
10. Provide special templates, drop plates, mounting brackets, or adapters for arms as required for details, overhead stops, and other door hardware items interfering with closer mounting.

2.19 DOOR TRIM

A. Manufacturers:

1. Scheduled Manufacturer: Ives.
2. Acceptable Manufacturers: Burns, Rockwood.

B. Requirements:

1. Provide push plates, push bars, pull plates, and pulls with diameter and length as scheduled.

2.20 PROTECTION PLATES

A. Manufacturers:

1. Scheduled Manufacturer: Ives.

2. Acceptable Manufacturers: Burns, Rockwood.

B. Requirements:

1. Provide protection plates with a minimum of 0.050 inch (1 mm) thick, beveled four edges as scheduled. Furnish with sheet metal or wood screws, finished to match plates.
2. Size plates 2 inches (51 mm) less width of door on single doors, pairs of doors with a mullion, and doors with edge guards. Size plates 1 inch (25 mm) less width of door on pairs without a mullion or edge guards.
3. At fire rated doors, provide protection plates over 16 inches high with UL label.

2.21 OVERHEAD STOPS AND OVERHEAD STOP/HOLDERS

A. Manufacturers:

1. Scheduled Manufacturers: Glynn-Johnson.
2. Acceptable Manufacturers: Rixson, Sargent.

B. Requirements:

1. Provide overhead stop at any door where conditions do not allow for a wall stop or floor stop presents tripping hazard.
2. Provide friction type at doors without closer and positive type at doors with closer.

2.22 DOOR STOPS AND HOLDERS

A. Manufacturers:

1. Scheduled Manufacturer: Ives.
2. Acceptable Manufacturers: Burns, Rockwood.

B. Provide door stops at each door leaf:

1. Provide wall stops wherever possible. Provide concave type where lockset has a push button or thumbturn.
2. Where a wall stop cannot be used, provide universal floor stops.
3. Where wall or floor stop cannot be used, provide overhead stop.
4. Provide roller bumper where doors open into each other and overhead stop cannot be used.

2.23 THRESHOLDS, SEALS, DOOR SWEEPS, AUTOMATIC DOOR BOTTOMS, AND GASKETING

A. Manufacturers:

1. Scheduled Manufacturer: Zero International.
2. Acceptable Manufacturers: National Guard, Reese.

B. Requirements:

1. Provide thresholds, weather-stripping, and gasketing systems as specified and per architectural details. Match finish of other items.

2. Smoke- and Draft-Control Door Assemblies: Where smoke- and draft-control door assemblies are required, provide door hardware that meets requirements of assemblies tested according to UL 1784 and installed in compliance with NFPA 105.
3. Provide door sweeps, seals, astragals, and auto door bottoms only of type where resilient or flexible seal strip is easily replaceable and readily available.
4. Size thresholds 1/2 inch (13 mm) high by 5 inches (127 mm) wide by door width unless otherwise specified in the hardware sets or detailed in the drawings.

2.24 SILENCERS

A. Manufacturers:

1. Scheduled Manufacturer: Ives.
2. Acceptable Manufacturers: Burns, Rockwood.

B. Requirements:

1. Provide "push-in" type silencers for hollow metal or wood frames.
2. Provide one silencer per 30 inches (762 mm) of height on each single frame, and two for each pair frame.
3. Omit where gasketing is specified.

2.25 MAGNETIC HOLDERS

A. Manufacturers:

1. Scheduled Manufacturer: LCN.
2. Acceptable Manufacturers: Rixson, Sargent.

B. Requirements:

1. Provide wall or floor mounted electromagnetic door release as specified with minimum of 25 pounds of holding force. Coordinate projection of holder and armature with other hardware and wall conditions to ensure that door sits parallel to wall when fully open. Connect magnetic holders on fire-rated doors into the fire control panel for fail-safe operation.

2.26 DOOR POSITION SWITCHES

A. Manufacturers:

1. Scheduled Manufacturer: Schlage.
2. Acceptable Manufacturers: GE-Interlogix, Sargent.

B. Requirements:

1. Provide recessed or surface mounted type door position switches as specified.
2. Coordinate door and frame preparations with door and frame suppliers. If switches are being used with magnetic locking device, provide minimum of 4 inches (102 mm) between switch and magnetic locking device.

2.27 BI-FOLD DOOR HARDWARE

- A. Manufacturer:
 - 1. Scheduled Manufacturer: Johnson Hardware
 - 2. Acceptable Manufacturers: Hager, Stanley, KN Crowder.
- B. Requirements:
 - 1. Provide complete sets of bi-fold door hardware as recommended by manufacturer for door type and weight.
 - a. Include track, hangers, fasteners, guides, and other hardware as required for complete installation.

2.28 FINISHES

- A. Finish: BHMA 613/643E/695 (US10B) except:
 - 1. Door Pulls (exterior doors): BHMA 630 (US32D)
 - 2. Door Closers: Powder Coat to Match (695)
 - 3. Thresholds: Mill Finish Aluminum

PART 3 - EXECUTION

3.01 EXAMINATION

- A. Prior to installation of hardware, examine doors and frames, with Installer present, for compliance with requirements for installation tolerances, labeled fire-rated door assembly construction, wall and floor construction, and other conditions affecting performance. Verify doors, frames, and walls have been properly reinforced for hardware installation.
- B. Field verify existing doors and frames receiving new hardware and existing conditions receiving new openings. Verify that new hardware is compatible with existing door and frame preparation and existing conditions.
- C. Examine roughing-in for electrical power systems to verify actual locations of wiring connections before electrified door hardware installation.
- D. Submit a list of deficiencies in writing and proceed with installation only after unsatisfactory conditions have been corrected.

3.02 PREPARATION

- A. Where on-site modification of doors and frames is required:
 - 1. Carefully remove existing door hardware and components being reused. Clean, protect, tag, and store in accordance with storage and handling requirements specified herein.
 - 2. Field modify and prepare existing doors and frames for new hardware being installed.
 - 3. When modifications are exposed to view, use concealed fasteners, when possible.

4. Prepare hardware locations and reinstall in accordance with installation requirements for new door hardware and with:
 - a. Steel Doors and Frames: For surface applied door hardware, drill and tap doors and frames according to ANSI/SDI A250.6.
 - b. Wood Doors: DHI WDHS.5 "Recommended Hardware Reinforcement Locations for Mineral Core Wood Flush Doors."
 - c. Doors in rated assemblies: NFPA 80 for restrictions on on-site door hardware preparation.

3.03 INSTALLATION

- A. Mount door hardware units at heights to comply with the following, unless otherwise indicated or required to comply with governing regulations.
 1. Standard Steel Doors and Frames: ANSI/SDI A250.8.
 2. Custom Steel Doors and Frames: HMMA 831.
 3. Wood Doors: DHI WDHS.3, "Recommended Locations for Architectural Hardware for Wood Flush Doors."
- B. Install each hardware item in compliance with manufacturer's instructions and recommendations, using only fasteners provided by manufacturer.
- C. Do not install surface mounted items until finishes have been completed on substrate. Protect all installed hardware during painting.
- D. Set units level, plumb and true to line and location. Adjust and reinforce attachment substrate as necessary for proper installation and operation.
- E. Drill and countersink units that are not factory prepared for anchorage fasteners. Space fasteners and anchors according to industry standards.
- F. Install operating parts so they move freely and smoothly without binding, sticking, or excessive clearance.
- G. Hinges: Install types and in quantities indicated in door hardware schedule but not fewer than quantity recommended by manufacturer for application indicated.
- H. Lock Cylinders:
 1. Install construction cores to secure building and areas during construction period.
 2. Replace construction cores with permanent cores as indicated in keying section.
- I. Wiring: Coordinate with Division 26, ELECTRICAL sections for:
 1. Conduit, junction boxes and wire pulls.
 2. Connections to and from power supplies to electrified hardware.
 3. Connections to fire/smoke alarm system and smoke evacuation system.
 4. Connection of wire to door position switches and wire runs to central room or area, as directed by Architect.
 5. Testing and labeling wires with Architect's opening number.

- J. Key Control System: Tag keys and place them on markers and hooks in key control system cabinet, as determined by final keying schedule.
- K. Door Closers: Mount closers on room side of corridor doors, inside of exterior doors, and stair side of stairway doors from corridors. Mount closers so they are not visible in corridors, lobbies and other public spaces unless approved by Architect.
- L. Closer/holders: Mount closer/holders on room side of corridor doors, inside of exterior doors, and stair side of stairway doors.
- M. Power Supplies: Locate power supplies as indicated or, if not indicated, above accessible ceilings or in equipment room, or alternate location as directed by Architect.
- N. Thresholds: Set thresholds in full bed of sealant complying with requirements specified in Division 07 Section "Joint Sealants."
- O. Stops: Provide floor stops for doors unless wall or other type stops are indicated in door hardware schedule. Do not mount floor stops where they may impede traffic or present tripping hazard.
- P. Perimeter Gasketing: Apply to head and jamb, forming seal between door and frame.
- Q. Meeting Stile Gasketing: Fasten to meeting stiles, forming seal when doors are closed.
- R. Door Bottoms and Sweeps: Apply to bottom of door, forming seal with threshold when door is closed.

3.04 FIELD QUALITY CONTROL

- A. Engage qualified, independent, Door Hardware Institute (DHI) Certified, Fire Door Assembly Inspector (CFDAI) or Architectural Hardware Consultant (AHC) to perform inspections, prepare inspection reports, and issue inspection reports.
 - 1. Representative will inspect door hardware and state in each report whether installed work complies with or deviates from requirements, including whether door hardware is properly installed and adjusted.
 - 2. Representative will inspect fire rated doors and state in report whether installed work complies with NFPA 80.

3.05 ADJUSTING

- A. Initial Adjustment: Adjust and check each operating item of door hardware and each door to ensure proper operation or function of every unit. Replace units that cannot be adjusted to operate as intended. Adjust door control devices to compensate for final operation of heating and ventilating equipment and to comply with referenced accessibility requirements.
 - 1. Electric Strikes: Adjust horizontal and vertical alignment of keeper to properly engage lock bolt.
 - 2. Door Closers: Adjust sweep period to comply with accessibility requirements and requirements of authorities having jurisdiction.

- B. Occupancy Adjustment: Approximately three to six months after date of Substantial Completion, Installer's Architectural Hardware Consultant must examine and readjust each item of door hardware, including adjusting operating forces, as necessary to ensure function of doors and door hardware.

3.06 CLEANING AND PROTECTION

- A. Clean adjacent surfaces soiled by door hardware installation.
- B. Clean operating items per manufacturer's instructions to restore proper function and finish.
- C. Provide final protection and maintain conditions that ensure door hardware is without damage or deterioration at time of Substantial Completion.

3.07 DOOR HARDWARE SCHEDULE

- A. The intent of the hardware specification is to specify the hardware for interior and exterior doors, and to establish a type, continuity, and standard of quality. However, it is the door hardware supplier's responsibility to thoroughly review existing conditions, schedules, specifications, drawings, and other Contract Documents to verify the suitability of the hardware specified.
- B. Discrepancies, conflicting hardware, and missing items are to be brought to the attention of the architect with corrections made prior to the bidding process. Omitted items not included in a hardware set should be scheduled with the appropriate additional hardware required for proper application.
- C. Hardware items are referenced in the following hardware schedule. Refer to the above-specifications for special features, options, cylinders/keying, and other requirements.
- D. Hardware Sets:

HARDWARE SET NO. 01A

For use on Door #(s):

A108B B104B B121 B122 C101A

Provide each PR door(s) with the following:

QTY		DESCRIPTION	CATALOG NUMBER	FINISH	MFR
2	EA	CONT. HINGE	112HD	313AN	IVE
1	EA	REMOVABLE MULLION	KR4954 STAB	695	VON
2	EA	PANIC HARDWARE	CDSI-98-EO	643E	VON
1	EA	RIM CYLINDER	20-057	643e	SCH
1	EA	MORTISE CYLINDER	20-061 ICX X K510-730 36-083 36-082-037	643e	SCH
2	EA	MORTISE CYLINDER	20-061 ICX X K510-730 XQ11-948 36-083 36-082-037	643e	SCH
4	EA	FSIC CORE	23-030	622	SCH
1	EA	DOOR PULL	VR910 DT	630	IVE
1	EA	DOOR PULL	VR910 NL	630	IVE
2	EA	OH STOP	90S	695	GLY
2	EA	SURFACE CLOSER	4111 EDA ST-2730	695	LCN
2	EA	KICK PLATE	8400 10" X 2" LDW B-CS	695	IVE
1	EA	RAIN DRIP	142D	D	ZER
1	EA	GASKETING	188SBK PSA	BK	ZER
1	EA	MULLION SEAL	8780NBK PSA	BK	ZER
1	EA	MEETING STILE	155D	D	ZER
1	EA	MEETING STILE	55D	D	ZER
1	EA	THRESHOLD	566A-223	A	ZER

NOTE:

EXISTING FRAME TO REMAIN

VERIFY EXISTING DOOR AND FRAME PREPS FOR COMPATIBILITY OF SPECIFIED HARDWARE

VERIFY EXISTING LOCK STRIKE PREP AND FURNISH REQUIRED STRIKE TO FIT.

PRIOR TO ORDERING NOTIFY ARCHITECT OF ANY REQUIRED CHANGES

HARDWARE SET NO. 01B

For use on Door #(s):

C128B

Provide each PR door(s) with the following:

QTY		DESCRIPTION	CATALOG NUMBER	FINISH	MFR
2	EA	CUSH SHOE SUPPORT	4110-30	695	LCN
2	EA	BLADE STOP SPACER	4110-61	695	LCN
2	EA	CONT. HINGE	112HD	313AN	IVE
2	EA	DUMMY PUSH BAR	350	643E	VON
2	EA	DOOR PULL	VR910 DT	630	IVE
2	EA	OH STOP	100S	695	GLY
2	EA	SURFACE CLOSER	4111 EDA	695	LCN
2	EA	KICK PLATE	8400 10" X 1" LDW B-CS	695	IVE

HARDWARE SET NO. 01C

For use on Door #(s):

B122C

Provide each SGL door(s) with the following:

QTY		DESCRIPTION	CATALOG NUMBER	FINISH	MFR
1	EA	CONT. HINGE	112HD	313AN	IVE
1	EA	PANIC HARDWARE	LD-98-EO W/CYL HOLE-990	643E	VON
1	EA	RIM CYLINDER	20-057	643e	SCH
1	EA	FSIC CORE	23-030	622	SCH
1	EA	DOOR PULL	VR910 NL	630	IVE
1	EA	SURFACE CLOSER	4111 SCUSH	695	LCN
1	EA	KICK PLATE	8400 10" X 2" LDW B-CS	695	IVE
1	EA	RAIN DRIP	142D	D	ZER
1	EA	GASKETING	188SBK PSA	BK	ZER
1	EA	THRESHOLD	566A-223	A	ZER

HARDWARE SET NO. 01D

For use on Door #(s):

C105 C108A

Provide each PR door(s) with the following:

QTY		DESCRIPTION	CATALOG NUMBER	FINISH	MFR
2	EA	CUSH SHOE SUPPORT	4110-30	695	LCN
2	EA	BLADE STOP SPACER	4110-61	695	LCN
1	EA	CONT. HINGE	112HD	313AN	IVE
1	EA	CONT. HINGE	112HD EPT	313AN	IVE
1	EA	POWER TRANSFER	EPT10 CON	695	VON
1	EA	REMOVABLE MULLION	KR4954 STAB	695	VON
1	EA	PANIC HARDWARE	CDSI-98-EO	643E	VON
1	EA	ELEC PANIC HARDWARE	RX-QEL-98-NL-OP-110MD 24 VDC	643E	VON
1	EA	RIM CYLINDER	20-057	643e	SCH
1	EA	MORTISE CYLINDER	20-061 ICX X K510-730 36-083 36-082-037	643e	SCH
2	EA	MORTISE CYLINDER	20-061 ICX X K510-730 XQ11-948 36-083 36-082-037	643e	SCH
4	EA	FSIC CORE	23-030	622	SCH
1	EA	DOOR PULL	VR910 NL	630	IVE
2	EA	OH STOP	100S	695	GLY
2	EA	SURFACE CLOSER	4111 EDA	695	LCN
2	EA	KICK PLATE	8400 10" X 2" LDW B-CS	695	IVE
1	EA	MULLION SEAL	8780NBK PSA	BK	ZER
1	EA	THRESHOLD	566A-223	A	ZER
2	EA	DOOR CONTACT	679-05HM	BLK	SCE
1	EA	POWER SUPPLY	PS902 900-2RS 120/240 VAC	LGR	SCE
1	EA	CARD READER	FURNISHED BY OTHERS		

DOOR OPERATION:

DOOR NORMALLY CLOSED AND LOCKED

ENTRY BY VALID CARD CREDENTIAL OR KEY OVERRIDE

FREE EGRESS FROM INSIDE AT ALL TIMES

DOOR CONTACT AND REQUEST TO EXIT MONITORED BY DIVISION 28

HARDWARE SET NO. 01E

For use on Door #(s):

C129A

Provide each SGL door(s) with the following:

QTY		DESCRIPTION	CATALOG NUMBER	FINISH	MFR
1	EA	CUSH SHOE SUPPORT	4110-30	695	LCN
1	EA	BLADE STOP SPACER	4110-61	695	LCN
1	EA	CONT. HINGE	112HD EPT	313AN	IVE
1	EA	POWER TRANSFER	EPT10 CON	695	VON
1	EA	ELEC PANIC HARDWARE	RX-QEL-98-EO 24 VDC	643E	VON
1	EA	RIM CYLINDER	20-057	643e	SCH
1	EA	FSIC CORE	23-030	622	SCH
1	EA	DOOR PULL	VR910 NL	630	IVE
1	EA	OH STOP	100S	695	GLY
1	EA	SURFACE CLOSER	4111 EDA	695	LCN
1	EA	THRESHOLD	566A-223	A	ZER
1	EA	DOOR CONTACT	679-05HM	BLK	SCE
1	EA	POWER SUPPLY	PS902 900-2RS 120/240 VAC	LGR	SCE
1	EA	CARD READER	FURNISHED BY OTHERS		

DOOR OPERATION:

DOOR NORMALLY CLOSED AND LOCKED

ENTRY BY VALID CARD CREDENTIAL OR KEY OVERRIDE

FREE EGRESS FROM INSIDE AT ALL TIMES

DOOR CONTACT AND REQUEST TO EXIT MONITORED BY DIVISION 28

HARDWARE SET NO. 01F

For use on Door #(s):

B100A

Provide each SGL door(s) with the following:

QTY		DESCRIPTION	CATALOG NUMBER	FINISH	MFR
1	EA	MOUNTING PLATE	4110-18	695	LCN
1	EA	CUSH SHOE SUPPORT	4110-30	695	LCN
1	EA	BLADE STOP SPACER	4110-61	695	LCN
1	EA	CONT. HINGE	112HD EPT	313AN	IVE
1	EA	POWER TRANSFER	EPT10 CON	695	VON
1	EA	ELEC PANIC HARDWARE	RX-QEL-98-EO 24 VDC	643E	VON
1	EA	RIM CYLINDER	20-057	643e	SCH
1	EA	FSIC CORE	23-030	622	SCH
1	EA	DOOR PULL	VR910 NL	630	IVE
1	EA	SURFACE CLOSER	4111 EDA	695	LCN
1	EA	WALL STOP	WS406/407CCV	643E/7 16	IVE
1	EA	THRESHOLD	566A-223	A	ZER
1	EA	DOOR CONTACT	679-05HM	BLK	SCE
1	EA	POWER SUPPLY	PS902 900-2RS 120/240 VAC	LGR	SCE
1	EA	CARD READER	FURNISHED BY OTHERS		

DOOR OPERATION:

DOOR NORMALLY CLOSED AND LOCKED

ENTRY BY VALID CARD CREDENTIAL, REMOTE RELEASE, OR KEY OVERRIDE

FREE EGRESS FROM INSIDE AT ALL TIMES

DOOR CONTACT AND REQUEST TO EXIT MONITORED BY DIVISION 28

HARDWARE SET NO. 01G

For use on Door #(s):

B100B

Provide each PR door(s) with the following:

QTY		DESCRIPTION	CATALOG NUMBER	FINISH	MFR
2	EA	MOUNTING PLATE	4110-18	695	LCN
2	EA	CUSH SHOE SUPPORT	4110-30	695	LCN
2	EA	BLADE STOP SPACER	4110-61	695	LCN
2	EA	CONT. HINGE	112HD	313AN	IVE
2	EA	PANIC HARDWARE	CDSI-9847-EO-LBR	643E	VON
2	EA	MORTISE CYLINDER	20-061 ICX X K510-730 XQ11-948 36-083 36-082-037	643e	SCH
2	EA	FSIC CORE	23-030	622	SCH
2	EA	DOOR PULL	VR910 DT	630	IVE
2	EA	SURFACE CLOSER	4111 EDA	695	LCN
2	EA	WALL STOP	WS406/407CCV	643E/7 16	IVE
1	EA	THRESHOLD	566A-223	A	ZER

HARDWARE SET NO. 01H

For use on Door #(s):

B100C

Provide each SGL door(s) with the following:

QTY		DESCRIPTION	CATALOG NUMBER	FINISH	MFR
1	EA	MOUNTING PLATE	4110-18	695	LCN
1	EA	CUSH SHOE SUPPORT	4110-30	695	LCN
1	EA	BLADE STOP SPACER	4110-61	695	LCN
1	EA	CONT. HINGE	112HD	313AN	IVE
1	EA	PANIC HARDWARE	CDSI-98-EO	643E	VON
1	EA	MORTISE CYLINDER	20-061 ICX X K510-730 XQ11-948 36-083 36-082-037	643e	SCH
1	EA	FSIC CORE	23-030	622	SCH
1	EA	DOOR PULL	VR910 DT	630	IVE
1	EA	SURFACE CLOSER	4111 EDA	695	LCN
1	EA	WALL STOP	WS406/407CCV	643E/7 16	IVE
1	EA	THRESHOLD	566A-223	A	ZER

HARDWARE SET NO. 01J

For use on Door #(s):

B113

C113B

Provide each SGL door(s) with the following:

QTY		DESCRIPTION	CATALOG NUMBER	FINISH	MFR
1	EA	CUSH SHOE SUPPORT	4110-30	695	LCN
1	EA	BLADE STOP SPACER	4110-61	695	LCN
1	EA	CONT. HINGE	112HD EPT	313AN	IVE
1	EA	POWER TRANSFER	EPT10 CON	695	VON
1	EA	ELEC PANIC HARDWARE	RX-QEL-98-EO 24 VDC	643E	VON
1	EA	RIM CYLINDER	20-057	643e	SCH
1	EA	FSIC CORE	23-030	622	SCH
1	EA	DOOR PULL	VR910 NL	630	IVE
1	EA	OH STOP	100S	695	GLY
1	EA	SURFACE CLOSER	4111 EDA	695	LCN
1	EA	THRESHOLD	566A-223	A	ZER
1	EA	DOOR CONTACT	679-05HM	BLK	SCE
1	EA	POWER SUPPLY	PS902 900-2RS 120/240 VAC	LGR	SCE

DOOR OPERATION:

DOOR NORMALLY CLOSED AND LOCKED

ENTRY BY VALID CARD CREDENTIAL OR KEY OVERRIDE

FREE EGRESS FROM INSIDE AT ALL TIMES

DOOR CONTACT AND REQUEST TO EXIT MONITORED BY DIVISION 28

HARDWARE SET NO. 01K

For use on Door #(s):

C106D

Provide each PR door(s) with the following:

QTY		DESCRIPTION	CATALOG NUMBER	FINISH	MFR
2	EA	CONT. HINGE	112HD	313AN	IVE
2	EA	PANIC HARDWARE	CDSI-9849-EO	643E	VON
1	EA	RIM CYLINDER	20-057	643e	SCH
1	EA	MORTISE CYLINDER	20-061 ICX X K510-730 XQ11-948 36-083 36-082-037	643e	SCH
1	EA	DOOR PULL	VR910 NL	630	IVE
2	EA	OH STOP & HOLDER	90H	695	GLY
2	EA	SURFACE CLOSER	4111 EDA ST-2730	695	LCN
2	EA	KICK PLATE	8400 10" X 1" LDW B-CS	695	IVE
1	EA	RAIN DRIP	142D	D	ZER
1	EA	GASKETING	188SBK PSA	BK	ZER
1	EA	MEETING STILE	155D	D	ZER
1	EA	MEETING STILE	55D	D	ZER
1	EA	THRESHOLD	566A-223	A	ZER

HARDWARE SET NO. 01L

For use on Door #(s):

C100B

C129B

Provide each PR door(s) with the following:

QTY		DESCRIPTION	CATALOG NUMBER	FINISH	MFR
2	EA	CUSH SHOE SUPPORT	4110-30	695	LCN
2	EA	BLADE STOP SPACER	4110-61	695	LCN
2	EA	CONT. HINGE	112HD	313AN	IVE
1	EA	REMOVABLE MULLION	KR4954 STAB	695	VON
2	EA	PANIC HARDWARE	CDSI-98-EO	643E	VON
1	EA	RIM CYLINDER	20-057	643e	SCH
1	EA	MORTISE CYLINDER	20-061 ICX X K510-730 36-083 36- 082-037	643e	SCH
2	EA	MORTISE CYLINDER	20-061 ICX X K510-730 XQ11-948 36-083 36-082-037	643e	SCH
4	EA	FSIC CORE	23-030	622	SCH
1	EA	DOOR PULL	VR910 DT	630	IVE
1	EA	DOOR PULL	VR910 NL	630	IVE
2	EA	OH STOP	100S	695	GLY
2	EA	SURFACE CLOSER	4111 EDA	695	LCN
1	EA	THRESHOLD	566A-223	A	ZER

HARDWARE SET NO. 01M

For use on Door #(s):

C128A

Provide each SGL door(s) with the following:

QTY		DESCRIPTION	CATALOG NUMBER	FINISH	MFR
1	EA	CUSH SHOE SUPPORT	4110-30	695	LCN
1	EA	BLADE STOP SPACER	4110-61	695	LCN
1	EA	CONT. HINGE	112HD	313AN	IVE
1	EA	DUMMY PUSH BAR	350	643E	VON
1	EA	DOOR PULL	VR910 DT	630	IVE
1	EA	OH STOP	100S	695	GLY
1	EA	SURFACE CLOSER	4111 EDA	695	LCN

HARDWARE SET NO. 01N

For use on Door #(s):

C108B

Provide each PR door(s) with the following:

QTY		DESCRIPTION	CATALOG NUMBER	FINISH	MFR
2	EA	CONTINUOUS HINGE	FURNISHED BY DOOR MANUFACTURER		B/O
2	EA	FIRE EXIT HARDWARE	3549A-L-BE-F-17-LBL	643E	VON
2	EA	SURFACE CLOSER	4111 SCUSH	695	LCN
	EA	BALANCE OF HARDWARE	BY DOOR MANUFACTURER		

HARDWARE SET NO. 01P

For use on Door #(s):

A108A

Provide each PR door(s) with the following:

QTY		DESCRIPTION	CATALOG NUMBER	FINISH	MFR
2	EA	CONT. HINGE	157XY	313AN	IVE
2	EA	DUMMY PUSH BAR	350	643E	VON
2	EA	DOOR PULL	VR910 DT	630	IVE
2	EA	SURFACE CLOSER	4111 CUSH	695	LCN
2	EA	KICK PLATE	8400 8" X 1" LDW B-CS	695	IVE
2	EA	SILENCER	SR64	GRY	IVE

NOTE:

EXISTING DOOR AND FRAME TO REMAIN

VERIFY EXISTING DOOR AND FRAME PREPS FOR COMPATIBILITY OF SPECIFIED HARDWARE

VERIFY EXISTING LOCK STRIKE PREP AND FURNISH REQUIRED STRIKE TO FIT.

PRIOR TO ORDERING NOTIFY ARCHITECT OF ANY REQUIRED CHANGES

For use on Door #(s):

B122B

Provide each SGL door(s) with the following:

QTY		DESCRIPTION	CATALOG NUMBER	FINISH	MFR
1	EA	CONT. HINGE	112HD	313AN	IVE
1	EA	VANDL STOREROOM LOCK	ND96TD SPA	643e	SCH
1	EA	FSIC CORE	23-030	622	SCH
1	EA	SURFACE CLOSER	4111 SCUSH	695	LCN
1	EA	KICK PLATE	8400 8" X 2" LDW B-CS	695	IVE
1	EA	RAIN DRIP	142D	D	ZER
1	EA	GASKETING	188SBK PSA	BK	ZER
1	EA	THRESHOLD	566A-223	A	ZER

NOTE:

EXISTING FRAME TO REMAIN

VERIFY EXISTING DOOR AND FRAME PREPS FOR COMPATIBILITY OF SPECIFIED HARDWARE

PRIOR TO ORDERING NOTIFY ARCHITECT OF ANY REQUIRED CHANGES

NOTE:

EXISTING FRAME TO REMAIN

VERIFY EXISTING DOOR AND FRAME PREPS FOR COMPATIBILITY OF SPECIFIED HARDWARE

PRIOR TO ORDERING NOTIFY ARCHITECT OF ANY REQUIRED CHANGES

HARDWARE SET NO. 01R

For use on Door #(s):

R1

Provide each SGL door(s) with the following:

QTY		DESCRIPTION	CATALOG NUMBER	FINISH	MFR
1	EA	CONT. HINGE	112HD	313AN	IVE
1	EA	VANDL STOREROOM LOCK	ND96TD SPA	643e	SCH
1	EA	FSIC CORE	23-030	622	SCH
1	EA	SURFACE CLOSER	4111 SCUSH	695	LCN
1	EA	KICK PLATE	8400 10" X 2" LDW B-CS	695	IVE
1	EA	RAIN DRIP	142D	D	ZER
1	EA	GASKETING	188SBK PSA	BK	ZER
1	EA	THRESHOLD	566A-223	A	ZER

HARDWARE SET NO. 01S

For use on Door #(s):

B106A

Provide each SGL door(s) with the following:

QTY		DESCRIPTION	CATALOG NUMBER	FINISH	MFR
1	EA	CUSH SHOE SUPPORT	4110-30	695	LCN
1	EA	BLADE STOP SPACER	4110-61	695	LCN
6	EA	HINGE	5BB1 4.5 X 4.5 NRP	B643E/ 716	IVE
1	EA	DOOR CORD	788-12 LESS WIRES	626	SCE
1	EA	PANIC HARDWARE	CDSI-9827-EO-LBR	643E	VON
1	EA	ELEC PANIC HARDWARE	RX-QEL-9827-NL-OP-LBR-110MD 24 VDC	643E	VON
1	EA	RIM CYLINDER	20-057	643e	SCH
1	EA	MORTISE CYLINDER	20-061 ICX X K510-730 XQ11-948 36-083 36-082-037	643e	SCH
2	EA	FSIC CORE	23-030	622	SCH
1	EA	DOOR PULL	VR910 DT	630	IVE
1	EA	DOOR PULL	VR910 NL	630	IVE
1	EA	SURFACE CLOSER	4111 EDA	695	LCN
1	EA	KICK PLATE	8400 8" X 1" LDW B-CS	695	IVE
1	EA	WALL STOP	WS406/407CCV	643E/7 16	IVE
1	EA	DOOR CONTACT	679-05HM	BLK	SCE
1	EA	POWER SUPPLY	PS902 900-2RS 120/240 VAC	LGR	SCE
1	EA	CARD READER	FURNISHED BY OTHERS		

NOTE:

EXISTING DOOR AND FRAME TO REMAIN
 VERIFY EXISTING DOOR AND FRAME PREPS FOR COMPATIBILITY OF SPECIFIED HARDWARE
 VERIFY EXISTING HINGES, LOCK STRIKE PREP AND FURNISH REQUIRED STRIKE TO FIT.
 PRIOR TO ORDERING NOTIFY ARCHITECT OF ANY REQUIRED CHANGES

DOOR OPERATION:

DOOR NORMALLY CLOSED AND LOCKED
 ENTRY BY VALID CARD CREDENTIAL, REMOTE RELEASE, OR KEY OVERRIDE
 FREE EGRESS FROM INSIDE AT ALL TIMES
 DOOR CONTACT AND REQUEST TO EXIT MONITORED BY DIVISION 28

HARDWARE SET NO. 01T

For use on Door #(s):

B106B

Provide each SGL door(s) with the following:

QTY		DESCRIPTION	CATALOG NUMBER	FINISH	MFR
1	EA	CUSH SHOE SUPPORT	4110-30	695	LCN
1	EA	BLADE STOP SPACER	4110-61	695	LCN
6	EA	HINGE	5BB1 4.5 X 4.5 NRP	B643E/ 716	IVE
2	EA	PANIC HARDWARE	CDSI-9827-EO-LBR	643E	VON
2	EA	MORTISE CYLINDER	20-061 ICX X K510-730 XQ11-948 36-083 36-082-037	643e	SCH
2	EA	FSIC CORE	23-030	622	SCH
2	EA	DOOR PULL	VR910 DT	630	IVE
1	EA	SURFACE CLOSER	4111 EDA	695	LCN
1	EA	KICK PLATE	8400 8" X 1" LDW B-CS	695	IVE
1	EA	WALL STOP	WS406/407CCV	643E/7 16	IVE

NOTE:

EXISTING DOOR AND FRAME TO REMAIN
 VERIFY EXISTING DOOR AND FRAME PREPS FOR COMPATIBILITY OF SPECIFIED HARDWARE
 VERIFY EXISTING HINGES, LOCK STRIKE PREP AND FURNISH REQUIRED STRIKE TO FIT.
 PRIOR TO ORDERING NOTIFY ARCHITECT OF ANY REQUIRED CHANGES

HARDWARE SET NO. 02B

For use on Door #(s):

A100 B123 C112A C112B

Provide each PR door(s) with the following:

QTY		DESCRIPTION	CATALOG NUMBER	FINISH	MFR
2	EA			695	LCN
2	EA	CONT. HINGE	112HD	313AN	IVE
1	EA	PANIC HARDWARE	9827-EO-LBR	643E	VON
1	EA	PANIC HARDWARE	9827-L-NL-LBR-17	643E	VON
1	EA	RIM CYLINDER	20-057	643e	SCH
1	EA	FSIC CORE	23-030	622	SCH
2	EA	SURFACE CLOSER	4111 EDA	695	LCN
2	EA	KICK PLATE	8400 10" X 1" LDW B-CS	695	IVE
2	EA	SILENCER	SR64	GRY	IVE

DOOR OPERATION:

DOOR NORMALLY HELD OPEN ON WALL MAGNETS CONNECTED TO BUILDING LOCKDOWN.
 LEVER TRIM ON ACTIVE LEAF ALWAYS ION LOCKED POSITION.
 AUATHORIZED ENTRY WHEN DOOR ARE CLOSED BY KEY OVERRIDE.

HARDWARE SET NO. 02C

For use on Door #(s):

C100A

Provide each PR door(s) with the following:

QTY		DESCRIPTION	CATALOG NUMBER	FINISH	MFR
2	EA	CONT. HINGE	112HD	313AN	IVE
2	EA	DUMMY PUSH BAR	350	643E	VON
2	EA	90 DEG OFFSET PULL	8190EZHD 12" O	695	IVE
2	EA	SURFACE CLOSER	4111 CUSH	695	LCN
2	EA	KICK PLATE	8400 8" X 1" LDW B-CS	695	IVE
2	EA	SILENCER	SR64	GRY	IVE

HARDWARE SET NO. 02D

For use on Door #(s):

B114 B200

Provide each PR door(s) with the following:

QTY		DESCRIPTION	CATALOG NUMBER	FINISH	MFR
2	EA			695	LCN
2	EA	CONT. HINGE	112HD	313AN	IVE
1	EA	FIRE EXIT HARDWARE	9849-EO-F-LBL	643E	VON
1	EA	FIRE EXIT HARDWARE	9849-L-BE-F-17-LBLAFL	643E	VON
2	EA	SURFACE CLOSER	4111 EDA	695	LCN
2	EA	KICK PLATE	8400 10" X 1" LDW B-CS	695	IVE
1	EA	GASKETING	488SBK PSA	BK	ZER
1	EA	WEATHERSTRIPPING	8217SBK PSA	BK	ZER

DOOR OPERATION:

DOORS HELD OPEN BY ELECTRONIC WALL MAGNETS CONNECTED TO FIRE ALARM SYSTEM.

HARDWARE SET NO. 02E

For use on Door #(s):

C113A C215

Provide each PR door(s) with the following:

QTY		DESCRIPTION	CATALOG NUMBER	FINISH	MFR
2	EA			695	LCN
2	EA	CONT. HINGE	112HD	313AN	IVE
1	EA	FIRE EXIT HARDWARE	9827-EO-F-LBR-499F	643E	VON
1	EA	FIRE EXIT HARDWARE	9827-L-BE-F-LBRAFL-17-499F	643E	VON
2	EA	SURFACE CLOSER	4111 EDA	695	LCN
2	EA	KICK PLATE	8400 10" X 1" LDW B-CS	695	IVE
1	EA	GASKETING	488SBK PSA	BK	ZER
1	EA	WEATHERSTRIPPING	8217SBK PSA	BK	ZER

DOOR OPERATION:

DOORS HELD OPEN ON WALL MAGNETS CONNECTED TO FIRE ALARM SYSTEM.

HARDWARE SET NO. 02F

For use on Door #(s):

B104A B124A B124B B201 B207

Provide each PR door(s) with the following:

QTY		DESCRIPTION	CATALOG NUMBER	FINISH	MFR
2	EA	CONT. HINGE	157XY	313AN	IVE
1	EA	FIRE RATED REMOVABLE MULLION	KR9954 STAB	695	VON
2	EA	FIRE EXIT HARDWARE	22-L-BE-F-17-SNB	695	VON
1	EA	MORTISE CYLINDER	20-061 ICX X K510-730 36-083 36-082-037	643e	SCH
1	EA	FSIC CORE	23-030	622	SCH
2	EA	SURFACE CLOSER	4111 EDA	695	LCN
1	EA	GASKETING	488SBK PSA	BK	ZER
1	EA	WEATHERSTRIPPING	8217SBK PSA	BK	ZER
1	EA	MULLION SEAL	8780NBK PSA	BK	ZER

NOTE:

EXISTING DOOR AND FRAME TO REMAIN

VERIFY EXISTING DOOR AND FRAME PREPS FOR COMPATIBILITY OF SPECIFIED HARDWARE PRIOR TO ORDERING NOTIFY ARCHITECT OF ANY REQUIRED CHANGES

HARDWARE SET NO. 03A

For use on Door #(s):

A101 C121 C207

Provide each SGL door(s) with the following:

QTY		DESCRIPTION	CATALOG NUMBER	FINISH	MFR
3	EA	HINGE	5BB1 4.5 X 4.5 NRP	B643E/ 716	IVE
1	EA	VANDL ENTRANCE LOCK	ND92TD SPA	643e	SCH
1	EA	FSIC CORE	23-030	622	SCH
1	EA	SURFACE CLOSER	4111 EDA	695	LCN
1	EA	KICK PLATE	8400 8" X 2" LDW B-CS	695	IVE
1	EA	WALL STOP	WS406/407CCV	643E/7 16	IVE
1	EA	GASKETING	488SBK PSA	BK	ZER

HARDWARE SET NO. 03B

For use on Door #(s):

C106C

Provide each SGL door(s) with the following:

QTY		DESCRIPTION	CATALOG NUMBER	FINISH	MFR
3	EA	HINGE	5BB1 4.5 X 4.5	B643E/ 716	IVE
1	EA	VANDL ENTRANCE LOCK	ND92TD SPA	643e	SCH
1	EA	FSIC CORE	23-030	622	SCH
1	EA	KICK PLATE	8400 8" X 2" LDW B-CS	695	IVE
1	EA	WALL STOP	WS406/407CCV	643E/7 16	IVE
3	EA	SILENCER	SR64	GRY	IVE

HARDWARE SET NO. 03C

For use on Door #(s):

C103

Provide each SGL door(s) with the following:

QTY		DESCRIPTION	CATALOG NUMBER	FINISH	MFR
3	EA	HINGE	5BB1 4.5 X 4.5	B643E/ 716	IVE
1	EA	VANDL ENTRANCE LOCK	ND92TD SPA	643e	SCH
1	EA	FSIC CORE	23-030	622	SCH
1	EA	SURFACE CLOSER	4011 WMS	695	LCN
1	EA	KICK PLATE	8400 8" X 2" LDW B-CS	695	IVE
1	EA	WALL STOP	WS406/407CCV	643E/7 16	IVE
1	EA	GASKETING	488SBK PSA	BK	ZER

HARDWARE SET NO. 03D

For use on Door #(s):

C107

Provide each SGL door(s) with the following:

QTY		DESCRIPTION	CATALOG NUMBER	FINISH	MFR
3	EA	HINGE	5BB1 4.5 X 4.5	B643E/ 716	IVE
1	EA	VANDL ENTRANCE LOCK	ND92TD SPA	643e	SCH
1	EA	FSIC CORE	23-030	622	SCH
1	EA	WALL STOP	WS406/407CCV	643E/7 16	IVE
1	EA	GASKETING	488SBK PSA	BK	ZER

HARDWARE SET NO. 03E

For use on Door #(s):

B112

Provide each SGL door(s) with the following:

QTY		DESCRIPTION	CATALOG NUMBER	FINISH	MFR
3	EA	HINGE	5BB1 4.5 X 4.5	B643E/ 716	IVE
1	EA	VANDL ENTRANCE LOCK	ND92TD SPA	643e	SCH
1	EA	FSIC CORE	23-030	622	SCH
1	EA	OH STOP	450S J	695	GLY
1	EA	GASKETING	488SBK PSA	BK	ZER

HARDWARE SET NO. 03F

For use on Door #(s):

B203

B208

Provide each SGL door(s) with the following:

QTY		DESCRIPTION	CATALOG NUMBER	FINISH	MFR
3	EA	HINGE	5BB1 4.5 X 4.5	B643E/ 716	IVE
1	EA	VANDL ENTRANCE LOCK	ND92TD SPA 10-013 1 1/8" LIP	643e	SCH
1	EA	FSIC CORE	23-030	622	SCH
1	EA	WALL STOP	WS406/407CCV	643E/7 16	IVE
1	EA	GASKETING	488SBK PSA	BK	ZER

HARDWARE SET NO. 03G

For use on Door #(s):

B206A

Provide each SGL door(s) with the following:

QTY		DESCRIPTION	CATALOG NUMBER	FINISH	MFR
3	EA	HINGE	5BB1 4.5 X 4.5	B643E/ 716	IVE
1	EA	VANDL ENTRANCE LOCK	ND92TD SPA 10-013 1 1/8" LIP	643e	SCH
1	EA	FSIC CORE	23-030	622	SCH
1	EA	OH STOP	450S	695	GLY
1	EA	GASKETING	488SBK PSA	BK	ZER

HARDWARE SET NO. 03H

For use on Door #(s):

B101 B101C

Provide each SGL door(s) with the following:

QTY		DESCRIPTION	CATALOG NUMBER	FINISH	MFR
1	EA	MOUNTING PLATE	4110-18	695	LCN
3	EA	HINGE	5BB1 4.5 X 4.5 NRP	B643E/ 716	IVE
1	EA	VANDL ENTRANCE LOCK	ND92TD SPA 10-013 1 1/8" LIP	643e	SCH
1	EA	FSIC CORE	23-030	622	SCH
1	EA	SURFACE CLOSER	4111 HCUSH	695	LCN
1	EA	KICK PLATE	8400 8" X 2" LDW B-CS	695	IVE
1	EA	WALL STOP	WS406/407CCV	643E/7 16	IVE
3	EA	SILENCER	SR64	GRY	IVE

NOTE:

EXISTING DOOR AND FRAME TO REMAIN
 VERIFY EXISTING DOOR AND FRAME PREPS FOR COMPATIBILITY OF SPECIFIED HARDWARE
 VERIFY EXISTING HINGES, LOCK STRIKE PREP AND FURNISH REQUIRED STRIKE TO FIT.
 PRIOR TO ORDERING NOTIFY ARCHITECT OF ANY REQUIRED CHANGES

HARDWARE SET NO. 03J

For use on Door #(s):

B111A

Provide each SGL door(s) with the following:

QTY		DESCRIPTION	CATALOG NUMBER	FINISH	MFR
3	EA	HALF SURFACE HINGE	BB1173 4.5	643e	HAG
1	EA	VANDL ENTRANCE LOCK	ND92TD SPA 10-013 1 1/8" LIP	643e	SCH
1	EA	FSIC CORE	23-030	622	SCH
1	EA	WALL STOP	WS406/407CCV	643E/7 16	IVE
1	EA	GASKETING	488SBK PSA	BK	ZER

NOTE:

EXISTING DOOR AND FRAME TO REMAIN
 VERIFY EXISTING DOOR AND FRAME PREPS FOR COMPATIBILITY OF SPECIFIED HARDWARE
 VERIFY EXISTING HINGES, LOCK STRIKE PREP AND FURNISH REQUIRED STRIKE TO FIT.
 PRIOR TO ORDERING NOTIFY ARCHITECT OF ANY REQUIRED CHANGES

HARDWARE SET NO. 03K

For use on Door #(s):

B101E B101G-A B101G-B B111D

Provide each SGL door(s) with the following:

QTY		DESCRIPTION	CATALOG NUMBER	FINISH	MFR
3	EA	HINGE	5BB1 4.5 X 4.5	B643E/ 716	IVE
1	EA	VANDL ENTRANCE LOCK	ND92TD SPA 10-013 1 1/8" LIP	643e	SCH
1	EA	FSIC CORE	23-030	622	SCH
1	EA	WALL STOP	WS406/407CCV	643E/7 16	IVE

NOTE:

EXISTING DOOR AND FRAME TO REMAIN
 VERIFY EXISTING DOOR AND FRAME PREPS FOR COMPATIBILITY OF SPECIFIED HARDWARE
 VERIFY EXISTING HINGES, LOCK STRIKE PREP AND FURNISH REQUIRED STRIKE TO FIT.
 PRIOR TO ORDERING NOTIFY ARCHITECT OF ANY REQUIRED CHANGES

HARDWARE SET NO. 04A

For use on Door #(s):

A102A A103A A104A A105A A106A A200A
 A201A B110 B115A B116A B117A B117F
 B118A B120 B209A B212A

Provide each SGL door(s) with the following:

QTY		DESCRIPTION	CATALOG NUMBER	FINISH	MFR
3	EA	HINGE	5BB1 4.5 X 4.5 NRP	B643E/ 716	IVE
1	EA	VANDL CLASSROOM SEC	ND95TD SPA 10-013 1 1/8" LIP	643e	SCH
2	EA	FSIC CORE	23-030	622	SCH
1	EA	SURFACE CLOSER	4111 EDA	695	LCN
1	EA	KICK PLATE	8400 8" X 2" LDW B-CS	695	IVE
1	EA	WALL STOP	WS406/407CCV	643E/7 16	IVE
1	EA	GASKETING	488SBK PSA	BK	ZER

NOTE:

EXISTING DOOR AND FRAME TO REMAIN
 VERIFY EXISTING DOOR AND FRAME PREPS FOR COMPATIBILITY OF SPECIFIED HARDWARE
 PRIOR TO ORDERING NOTIFY ARCHITECT OF ANY REQUIRED CHANGES

HARDWARE SET NO. 04B

For use on Door #(s):

C110	C111	C114	C115	C116	C117
C118	C120	C122	C206	C208D	C208E
C209	C210	C211	C212	C213	C214
C216					

Provide each SGL door(s) with the following:

QTY		DESCRIPTION	CATALOG NUMBER	FINISH	MFR
3	EA	HINGE	5BB1HW 4.5 X 4.5 NRP	B643E/ 716	IVE
1	EA	VANDL CLASSROOM SEC	ND95TD SPA	643e	SCH
1	EA	FSIC CORE	23-030	622	SCH
1	EA	SURFACE CLOSER	4111 EDA	695	LCN
1	EA	KICK PLATE	8400 8" X 2" LDW B-CS	695	IVE
1	EA	WALL STOP	WS406/407CCV	643E/7 16	IVE
1	EA	GASKETING	488SBK PSA	BK	ZER

HARDWARE SET NO. 04C

For use on Door #(s):

A110A

Provide each SGL door(s) with the following:

QTY		DESCRIPTION	CATALOG NUMBER	FINISH	MFR
3	EA	HINGE	5BB1 4.5 X 4.5 NRP	B643E/ 716	IVE
1	EA	VANDL CLASSROOM SEC	ND95TD SPA 10-013 1 1/8" LIP	643e	SCH
2	EA	FSIC CORE	23-030	622	SCH
1	EA	MOUNTING BRACKET	MB	BLK	IVE
1	EA	SURFACE CLOSER	4111 EDA	695	LCN
1	EA	KICK PLATE	8400 8" X 2" LDW B-CS	695	IVE
1	EA	WALL STOP	WS406/407CCV	643E/7 16	IVE
1	SET	GASKETING	870D-S	D	ZER
1	EA	DOOR BOTTOM	364AA	AA	ZER

NOTE:

EXISTING DOOR AND FRAME TO REMAIN

VERIFY EXISTING DOOR AND FRAME PREPS FOR COMPATIBILITY OF SPECIFIED HARDWARE
PRIOR TO ORDERING NOTIFY ARCHITECT OF ANY REQUIRED CHANGES

HARDWARE SET NO. 04E

For use on Door #(s):

C106B

Provide each SGL door(s) with the following:

QTY		DESCRIPTION	CATALOG NUMBER	FINISH	MFR
3	EA	HINGE	5BB1 4.5 X 4.5	B643E/ 716	IVE
1	EA	VANDL CLASSROOM LOCK	ND94TD SPA	643e	SCH
1	EA	FSIC CORE	23-030	622	SCH
1	EA	OH STOP	90S	695	GLY
1	EA	ARMOR PLATE	8400 X 2" LDW B-CS	695	IVE
3	EA	SILENCER	SR64	GRY	IVE

HARDWARE SET NO. 04F

For use on Door #(s):

C107C

Provide each PR door(s) with the following:

QTY		DESCRIPTION	CATALOG NUMBER	FINISH	MFR
2	EA	CONT. HINGE	112HD	313AN	IVE
1	EA	REMOVABLE MULLION	KR4954 STAB	695	VON
1	EA	PANIC HARDWARE	CDSI-98-DT	643E	VON
1	EA	PANIC HARDWARE	CDSI-98-NL	643E	VON
1	EA	RIM CYLINDER	20-057	643e	SCH
1	EA	MORTISE CYLINDER	20-061 ICX X K510-730 36-083 36- 082-037	643e	SCH
2	EA	MORTISE CYLINDER	20-061 ICX X K510-730 XQ11-948 36-083 36-082-037	643e	SCH
3	EA	FSIC CORE	23-030	622	SCH
2	EA	OH STOP & HOLDER	90H	695	GLY
2	EA	SURFACE CLOSER	4111 EDA ST-2730	695	LCN
2	EA	KICK PLATE	8400 8" X 2" LDW B-CS	695	IVE
1	EA	MULLION SEAL	8780NBK PSA	BK	ZER
2	EA	SILENCER	SR64	GRY	IVE

HARDWARE SET NO. 04K

For use on Door #(s):

B107A B107B B107C B107D

Provide each SGL door(s) with the following:

QTY		DESCRIPTION	CATALOG NUMBER	FINISH	MFR
3	EA	HINGE	5BB1 4.5 X 4.5 NRP	B643E/ 716	IVE
1	EA	PANIC HARDWARE	CDSI-98-DT	643E	VON
1	EA	MORTISE CYLINDER	20-061 ICX X K510-730 XQ11-948 36-083 36-082-037	643e	SCH
1	EA	FSIC CORE	23-030	622	SCH
1	EA	SURFACE CLOSER	4111 HCUSH	695	LCN
1	EA	KICK PLATE	8400 8" X 2" LDW B-CS	695	IVE
1	EA	GASKETING	488SBK PSA	BK	ZER

NOTE:

EXISTING DOOR AND FRAME TO REMAIN

VERIFY EXISTING DOOR AND FRAME PREPS FOR COMPATIBILITY OF SPECIFIED HARDWARE
PRIOR TO ORDERING NOTIFY ARCHITECT OF ANY REQUIRED CHANGES

HARDWARE SET NO. 04L

For use on Door #(s):

B107E B107H

Provide each SGL door(s) with the following:

QTY		DESCRIPTION	CATALOG NUMBER	FINISH	MFR
3	EA	HINGE	5BB1 4.5 X 4.5 NRP	B643E/ 716	IVE
1	EA	PANIC HARDWARE	CDSI-98-EO	643E	VON
1	EA	RIM CYLINDER	20-057	643e	SCH
1	EA	MORTISE CYLINDER	20-061 ICX X K510-730 XQ11-948 36-083 36-082-037	643e	SCH
2	EA	FSIC CORE	23-030	622	SCH
1	EA	DOOR PULL	VR910 NL	630	IVE
1	EA	SURFACE CLOSER	4111 HCUSH	695	LCN
1	EA	KICK PLATE	8400 8" X 2" LDW B-CS	695	IVE
1	EA	GASKETING	488SBK PSA	BK	ZER

NOTE:

EXISTING DOOR AND FRAME TO REMAIN

VERIFY EXISTING DOOR AND FRAME PREPS FOR COMPATIBILITY OF SPECIFIED HARDWARE
PRIOR TO ORDERING NOTIFY ARCHITECT OF ANY REQUIRED CHANGES

HARDWARE SET NO. 04M

For use on Door #(s):

B107F B107G

Provide each PR door(s) with the following:

QTY		DESCRIPTION	CATALOG NUMBER	FINISH	MFR
6	EA	HINGE	5BB1 4.5 X 4.5 NRP	B643E/ 716	IVE
1	EA	PANIC HARDWARE	CDSI-9827-DT-LBR	643E	VON
1	EA	PANIC HARDWARE	CDSI-9827-NL-LBR	643E	VON
1	EA	RIM CYLINDER	20-057	643e	SCH
1	EA	FSIC CORE	23-030	622	SCH
2	EA	SURFACE CLOSER	4111 CUSH	695	LCN
2	EA	KICK PLATE	8400 8" X 1" LDW B-CS	695	IVE
1	EA	GASKETING	488SBK PSA	BK	ZER
1	EA	MEETING STILE	155D	D	ZER
1	EA	MEETING STILE	55D	D	ZER

HARDWARE SET NO. 04N

For use on Door #(s):

B206C

Provide each SGL door(s) with the following:

QTY		DESCRIPTION	CATALOG NUMBER	FINISH	MFR
3	EA	HINGE	5BB1 4.5 X 4.5 NRP	B643E/ 716	IVE
1	EA	PANIC HARDWARE	CDSI-98-EO	643E	VON
1	EA	RIM CYLINDER	20-057	643e	SCH
1	EA	MORTISE CYLINDER	20-061 ICX X K510-730 XQ11-948 36-083 36-082-037	643e	SCH
2	EA	FSIC CORE	23-030	622	SCH
1	EA	DOOR PULL	VR910 NL	630	IVE
1	EA	SURFACE CLOSER	4111 EDA	695	LCN
1	EA	KICK PLATE	8400 8" X 2" LDW B-CS	695	IVE
1	EA	WALL STOP	WS406/407CCV	643E/7 16	IVE
1	EA	GASKETING	488SBK PSA	BK	ZER

NOTE:

EXISTING DOOR AND FRAME TO REMAIN

VERIFY EXISTING DOOR AND FRAME PREPS FOR COMPATIBILITY OF SPECIFIED HARDWARE
PRIOR TO ORDERING NOTIFY ARCHITECT OF ANY REQUIRED CHANGES

HARDWARE SET NO. 04P

For use on Door #(s):

B206B

Provide each SGL door(s) with the following:

QTY		DESCRIPTION	CATALOG NUMBER	FINISH	MFR
3	EA	HINGE	5BB1 4.5 X 4.5 NRP	B643E/ 716	IVE
1	EA	PANIC HARDWARE	CDSI-98-DT	643E	VON
1	EA	MORTISE CYLINDER	20-061 ICX X K510-730 XQ11-948 36-083 36-082-037	643e	SCH
1	EA	FSIC CORE	23-030	622	SCH
1	EA	SURFACE CLOSER	4111 EDA	695	LCN
1	EA	KICK PLATE	8400 8" X 2" LDW B-CS	695	IVE
1	EA	WALL STOP	WS406/407CCV	643E/7 16	IVE
1	EA	GASKETING	488SBK PSA	BK	ZER

NOTE:

EXISTING DOOR AND FRAME TO REMAIN

VERIFY EXISTING DOOR AND FRAME PREPS FOR COMPATIBILITY OF SPECIFIED HARDWARE
PRIOR TO ORDERING NOTIFY ARCHITECT OF ANY REQUIRED CHANGES

HARDWARE SET NO. 04Q

For use on Door #(s):

B119

Provide each SGL door(s) with the following:

QTY		DESCRIPTION	CATALOG NUMBER	FINISH	MFR
3	EA	HINGE	5BB1 4.5 X 4.5 NRP	B643E/ 716	IVE
1	EA	VANDL CLASSROOM SEC	ND95TD SPA 10-013 1 1/8" LIP	643e	SCH
2	EA	FSIC CORE	23-030	622	SCH
1	EA	SURFACE CLOSER	4111 HCUSH	695	LCN
1	EA	KICK PLATE	8400 8" X 2" LDW B-CS	695	IVE

NOTE:

EXISTING DOOR AND FRAME TO REMAIN

VERIFY EXISTING DOOR AND FRAME PREPS FOR COMPATIBILITY OF SPECIFIED HARDWARE
PRIOR TO ORDERING NOTIFY ARCHITECT OF ANY REQUIRED CHANGES

HARDWARE SET NO. 04R

For use on Door #(s):

C107A C107B

Provide each SGL door(s) with the following:

QTY		DESCRIPTION	CATALOG NUMBER	FINISH	MFR
1	EA	CONT. HINGE	112HD	313AN	IVE
1	EA	PANIC HARDWARE	CDSI-98-EO	643E	VON
1	EA	RIM CYLINDER	20-057	643e	SCH
1	EA	MORTISE CYLINDER	20-061 ICX X K510-730 XQ11-948 36-083 36-082-037	643e	SCH
2	EA	FSIC CORE	23-030	622	SCH
1	EA	DOOR PULL	VR910 NL	630	IVE
1	EA	OH STOP & HOLDER	90H	695	GLY
1	EA	SURFACE CLOSER	4111 EDA ST-2730	695	LCN
1	EA	KICK PLATE	8400 8" X 2" LDW B-CS	695	IVE
3	EA	SILENCER	SR64	GRY	IVE

HARDWARE SET NO. 04S

For use on Door #(s):

C107D

Provide each PR door(s) with the following:

QTY		DESCRIPTION	CATALOG NUMBER	FINISH	MFR
2	EA	CUSH SHOE SUPPORT	4110-30	695	LCN
2	EA	BLADE STOP SPACER	4110-61	695	LCN
2	EA	CONT. HINGE	112HD	313AN	IVE
1	EA	REMOVABLE MULLION	KR4954 STAB	695	VON
1	EA	PANIC HARDWARE	CDSI-98-DT	643E	VON
1	EA	PANIC HARDWARE	CDSI-98-NL	643E	VON
1	EA	RIM CYLINDER	20-057	643e	SCH
1	EA	MORTISE CYLINDER	20-061 ICX X K510-730 36-083 36- 082-037	643e	SCH
2	EA	MORTISE CYLINDER	20-061 ICX X K510-730 XQ11-948 36-083 36-082-037	643e	SCH
3	EA	FSIC CORE	23-030	622	SCH
2	EA	OH STOP & HOLDER	100H	695	GLY
2	EA	SURFACE CLOSER	4111 EDA	695	LCN
2	EA	KICK PLATE	8400 8" X 2" LDW B-CS	695	IVE
1	EA	MULLION SEAL	8780NBK PSA	BK	ZER
2	EA	SILENCER	SR64	GRY	IVE

HARDWARE SET NO. 04T

For use on Door #(s):

B101B B101F B101H B101K B101L B110A

Provide each SGL door(s) with the following:

QTY		DESCRIPTION	CATALOG NUMBER	FINISH	MFR
3	EA	HINGE	5BB1 4.5 X 4.5 NRP	B643E/ 716	IVE
1	EA	VANDL CLASSROOM LOCK	ND94TD SPA 10-013 1 1/8" LIP	643e	SCH
1	EA	FSIC CORE	23-030	622	SCH
1	EA	OH STOP	450S	695	GLY

NOTE:

EXISTING DOOR AND FRAME TO REMAIN

VERIFY EXISTING DOOR AND FRAME PREPS FOR COMPATIBILITY OF SPECIFIED HARDWARE

VERIFY EXISTING HINGES, LOCK STRIKE PREP AND FURNISH REQUIRED STRIKE TO FIT.

PRIOR TO ORDERING NOTIFY ARCHITECT OF ANY REQUIRED CHANGES

HARDWARE SET NO. 04U

For use on Door #(s):

B111B

Provide each SGL door(s) with the following:

QTY		DESCRIPTION	CATALOG NUMBER	FINISH	MFR
3	EA	HINGE	5BB1 4.5 X 4.5 NRP	B643E/ 716	IVE
1	EA	VANDL CLASSROOM LOCK	ND94TD SPA 10-013 1 1/8" LIP	643e	SCH
1	EA	FSIC CORE	23-030	622	SCH
1	EA	ROLLER BUMPER	RB472	613	IVE

NOTE:

EXISTING DOOR AND FRAME TO REMAIN

VERIFY EXISTING DOOR AND FRAME PREPS FOR COMPATIBILITY OF SPECIFIED HARDWARE

VERIFY EXISTING HINGES, LOCK STRIKE PREP AND FURNISH REQUIRED STRIKE TO FIT.

PRIOR TO ORDERING NOTIFY ARCHITECT OF ANY REQUIRED CHANGES

HARDWARE SET NO. 04V

For use on Door #(s):

B111F

Provide each SGL door(s) with the following:

QTY		DESCRIPTION	CATALOG NUMBER	FINISH	MFR
3	EA	HINGE	5BB1 4.5 X 4.5	B643E/ 716	IVE
1	EA	VANDL CLASSROOM LOCK	ND94TD SPA	643e	SCH
1	EA	FSIC CORE	23-030	622	SCH
1	EA	WALL STOP	WS406/407CCV	643E/7 16	IVE
3	EA	SILENCER	SR64	GRY	IVE

HARDWARE SET NO. 04W

For use on Door #(s):

B111C

Provide each SGL door(s) with the following:

QTY		DESCRIPTION	CATALOG NUMBER	FINISH	MFR
3	EA	HINGE	5BB1 4.5 X 4.5 NRP	B643E/ 716	IVE
1	EA	VANDL CLASSROOM LOCK	ND94TD SPA 10-013 1 1/8" LIP	643e	SCH
1	EA	FSIC CORE	23-030	622	SCH

NOTE:

EXISTING DOOR AND FRAME TO REMAIN

VERIFY EXISTING DOOR AND FRAME PREPS FOR COMPATIBILITY OF SPECIFIED HARDWARE

VERIFY EXISTING HINGES, LOCK STRIKE PREP AND FURNISH REQUIRED STRIKE TO FIT.

PRIOR TO ORDERING NOTIFY ARCHITECT OF ANY REQUIRED CHANGES

HARDWARE SET NO. 05A

For use on Door #(s):

A102B	A102C	A103B	A103C	A104B	A104C
A105B	A105C	A106B	A106C	A110B	A110C
A200B	A200C	A201B	A201C	B115D	B115E
B116D	B116E	B117D	B117E	B118D	B118E
B119B	B119C	B120A	B209B	B209C	B212B
B212C					

Provide each SGL door(s) with the following:

QTY		DESCRIPTION	CATALOG NUMBER	FINISH	MFR
3	EA	HINGE	5BB1 4.5 X 4.5 NRP	B643E/ 716	IVE
1	EA	VANDL STOREROOM LOCK	ND96TD SPA	643e	SCH
1	EA	FSIC CORE	23-030	622	SCH
1	EA	OH STOP	450S	695	GLY
3	EA	SILENCER	SR64	GRY	IVE

NOTE:

EXISTING DOOR AND FRAME TO REMAIN

VERIFY EXISTING DOOR AND FRAME PREPS FOR COMPATIBILITY OF SPECIFIED HARDWARE

PRIOR TO ORDERING NOTIFY ARCHITECT OF ANY REQUIRED CHANGES

HARDWARE SET NO. 05B

For use on Door #(s):

B102 B205A B205B

Provide each SGL door(s) with the following:

QTY		DESCRIPTION	CATALOG NUMBER	FINISH	MFR
3	EA	HINGE	5BB1 4.5 X 4.5 NRP	B643E/ 716	IVE
1	EA	VANDL STOREROOM LOCK	ND96TD SPA 10-013 1 1/8" LIP	643e	SCH
1	EA	FSIC CORE	23-030	622	SCH
1	EA	SURFACE CLOSER	4111 CUSH	695	LCN
1	EA	KICK PLATE	8400 8" X 2" LDW B-CS	695	IVE
3	EA	SILENCER	SR64	GRY	IVE

NOTE:

EXISTING DOOR AND FRAME TO REMAIN

VERIFY EXISTING DOOR AND FRAME PREPS FOR COMPATIBILITY OF SPECIFIED HARDWARE
PRIOR TO ORDERING NOTIFY ARCHITECT OF ANY REQUIRED CHANGES

HARDWARE SET NO. 05C

For use on Door #(s):

C127 C201

Provide each SGL door(s) with the following:

QTY		DESCRIPTION	CATALOG NUMBER	FINISH	MFR
3	EA	HINGE	5BB1 4.5 X 4.5 NRP	B643E/ 716	IVE
1	EA	VANDL STOREROOM LOCK	ND96TD SPA	643e	SCH
1	EA	FSIC CORE	23-030	622	SCH
1	EA	SURFACE CLOSER	4111 HCUSH	695	LCN
1	EA	KICK PLATE	8400 8" X 2" LDW B-CS	695	IVE
3	EA	SILENCER	SR64	GRY	IVE

HARDWARE SET NO. 05D

For use on Door #(s):

A109 B108 B204

Provide each SGL door(s) with the following:

QTY		DESCRIPTION	CATALOG NUMBER	FINISH	MFR
3	EA	HINGE	5BB1 4.5 X 4.5 NRP	B643E/ 716	IVE
1	EA	VANDL STOREROOM LOCK	ND96TD SPA 10-013 1 1/8" LIP	643e	SCH
1	EA	FSIC CORE	23-030	622	SCH
1	EA	SURFACE CLOSER	4111 HCUSH	695	LCN
1	EA	KICK PLATE	8400 8" X 2" LDW B-CS	695	IVE
3	EA	SILENCER	SR64	GRY	IVE

NOTE:

EXISTING DOOR AND FRAME TO REMAIN

VERIFY EXISTING DOOR AND FRAME PREPS FOR COMPATIBILITY OF SPECIFIED HARDWARE
PRIOR TO ORDERING NOTIFY ARCHITECT OF ANY REQUIRED CHANGES

HARDWARE SET NO. 05E

For use on Door #(s):

C105A C119 C131 C219

Provide each SGL door(s) with the following:

QTY		DESCRIPTION	CATALOG NUMBER	FINISH	MFR
3	EA	HINGE	5BB1 4.5 X 4.5	B643E/ 716	IVE
1	EA	VANDL STOREROOM LOCK	ND96TD SPA	643e	SCH
1	EA	FSIC CORE	23-030	622	SCH
1	EA	SURFACE CLOSER	4011 WMS	695	LCN
1	EA	KICK PLATE	8400 8" X 2" LDW B-CS	695	IVE
1	EA	WALL STOP/HOLDER	FS495	613	IVE
3	EA	SILENCER	SR64	GRY	IVE

HARDWARE SET NO. 05F

For use on Door #(s):

C104

Provide each PR door(s) with the following:

QTY		DESCRIPTION	CATALOG NUMBER	FINISH	MFR
6	EA	HINGE	5BB1 4.5 X 4.5 NRP	B643E/ 716	IVE
2	EA	MANUAL FLUSH BOLT	FB458 12"	643E/7 16	IVE
1	EA	DUST PROOF STRIKE	DP2	643E/7 16	IVE
1	EA	VANDL STOREROOM LOCK	ND96TD SPA	643e	SCH
1	EA	FSIC CORE	23-030	622	SCH
2	EA	OH STOP	90S	695	GLY
2	EA	SILENCER	SR64	GRY	IVE

HARDWARE SET NO. 05G

For use on Door #(s):

C123 C206A C210A

Provide each SGL door(s) with the following:

QTY		DESCRIPTION	CATALOG NUMBER	FINISH	MFR
3	EA	HINGE	5BB1 4.5 X 4.5	B643E/ 716	IVE
1	EA	VANDL STOREROOM LOCK	ND96TD SPA	643e	SCH
1	EA	FSIC CORE	23-030	622	SCH
1	EA	SURFACE CLOSER	4011 WMS	695	LCN
1	EA	KICK PLATE	8400 8" X 2" LDW B-CS	695	IVE
1	EA	WALL STOP	WS406/407CCV	643E/7 16	IVE
3	EA	SILENCER	SR64	GRY	IVE

HARDWARE SET NO. 05H

For use on Door #(s):

C208B C208C

Provide each SGL door(s) with the following:

QTY		DESCRIPTION	CATALOG NUMBER	FINISH	MFR
3	EA	HINGE	5BB1 4.5 X 4.5	B643E/ 716	IVE
1	EA	VANDL STOREROOM LOCK	ND96TD SPA	643e	SCH
1	EA	FSIC CORE	23-030	622	SCH
1	EA	WALL STOP	WS406/407CCV	643E/7 16	IVE
3	EA	SILENCER	SR64	GRY	IVE

HARDWARE SET NO. 05J

For use on Door #(s):

B206D

Provide each SGL door(s) with the following:

QTY		DESCRIPTION	CATALOG NUMBER	FINISH	MFR
3	EA	HINGE	5BB1 4.5 X 4.5 NRP	B643E/ 716	IVE
1	EA	VANDL STOREROOM LOCK	ND96TD SPA 10-013 1 1/8" LIP	643e	SCH
1	EA	FSIC CORE	23-030	622	SCH
1	EA	OH STOP	450S	695	GLY
3	EA	SILENCER	SR64	GRY	IVE

NOTE:

EXISTING DOOR AND FRAME TO REMAIN

VERIFY EXISTING DOOR AND FRAME PREPS FOR COMPATIBILITY OF SPECIFIED HARDWARE
PRIOR TO ORDERING NOTIFY ARCHITECT OF ANY REQUIRED CHANGES

HARDWARE SET NO. 05K

For use on Door #(s):

C208A

Provide each SGL door(s) with the following:

QTY		DESCRIPTION	CATALOG NUMBER	FINISH	MFR
3	EA	HINGE	5BB1 4.5 X 4.5	B643E/ 716	IVE
1	EA	VANDL CLASSROOM LOCK	ND94TD SPA	643e	SCH
1	EA	FSIC CORE	23-030	622	SCH
1	EA	SURFACE CLOSER	4011 DEL WMS	695	LCN
1	EA	KICK PLATE	8400 8" X 2" LDW B-CS	695	IVE
1	EA	WALL STOP	WS406/407CCV	643E/7 16	IVE
3	EA	SILENCER	SR64	GRY	IVE

HARDWARE SET NO. 05L

For use on Door #(s):

B002GA B002GB

Provide each SGL door(s) with the following:

QTY		DESCRIPTION	CATALOG NUMBER	FINISH	MFR
3	EA	HINGE	5BB1 4.5 X 4.5 NRP	B643E/ 716	IVE
1	EA	FIRE EXIT HARDWARE	98-L-NL-F-17	643E	VON
1	EA	RIM CYLINDER	20-057	643e	SCH
1	EA	FSIC CORE	23-030	622	SCH
1	EA	SURFACE CLOSER	4111 EDA	695	LCN
1	EA	KICK PLATE	8400 8" X 2" LDW B-CS	695	IVE
1	EA	WALL STOP	WS406/407CCV	643E/7 16	IVE
3	EA	SILENCER	SR64	GRY	IVE

HARDWARE SET NO. 05M

For use on Door #(s):

B114A

Provide each SGL door(s) with the following:

QTY		DESCRIPTION	CATALOG NUMBER	FINISH	MFR
3	EA	HINGE	5BB1 4.5 X 4.5	B643E/ 716	IVE
1	EA	VANDL STOREROOM LOCK	ND96TD SPA	643e	SCH
1	EA	FSIC CORE	23-030	622	SCH
1	EA	SURFACE CLOSER	4011 WMS	695	LCN
1	EA	KICK PLATE	8400 8" X 2" LDW B-CS	695	IVE
1	EA	WALL STOP	WS406/407CCV	643E/7 16	IVE
1	EA	GASKETING	188SBK PSA	BK	ZER
3	EA	SILENCER	SR64	GRY	IVE

HARDWARE SET NO. 05N

For use on Door #(s):

B122A

Provide each SGL door(s) with the following:

QTY		DESCRIPTION	CATALOG NUMBER	FINISH	MFR
1	EA	PANIC HARDWARE	LD-98-EO W/CYL HOLE-990	643E	VON
1	EA	RIM CYLINDER	20-057	643e	SCH
1	EA	FSIC CORE	23-030	622	SCH
1	EA	DOOR PULL	VR910 NL	630	IVE
1	EA	SURFACE CLOSER	4111 CUSH	695	LCN
1	EA	KICK PLATE	8400 8" X 2" LDW B-CS	695	IVE
3	EA	SILENCER	SR64	GRY	IVE
	EA	RE-USE EXISTING	HALF SURFACE HINGES		

NOTE:

EXISTING DOOR AND FRAME TO REMAIN

VERIFY EXISTING DOOR AND FRAME PREPS FOR COMPATIBILITY OF SPECIFIED HARDWARE

PRIOR TO ORDERING NOTIFY ARCHITECT OF ANY REQUIRED CHANGES

HARDWARE SET NO. 05P

For use on Door #(s):

B101D

Provide each SGL door(s) with the following:

QTY		DESCRIPTION	CATALOG NUMBER	FINISH	MFR
3	EA	HINGE	5BB1 4.5 X 4.5	B643E/ 716	IVE
1	EA	VANDL STOREROOM LOCK	ND96TD SPA 10-013 1 1/8" LIP	643e	SCH
1	EA	FSIC CORE	23-030	622	SCH
1	EA	WALL STOP	WS406/407CCV	643E/7 16	IVE
3	EA	SILENCER	SR64	GRY	IVE

NOTE:

EXISTING DOOR AND FRAME TO REMAIN

VERIFY EXISTING DOOR AND FRAME PREPS FOR COMPATIBILITY OF SPECIFIED HARDWARE

VERIFY EXISTING HINGES, LOCK STRIKE PREP AND FURNISH REQUIRED STRIKE TO FIT.

PRIOR TO ORDERING NOTIFY ARCHITECT OF ANY REQUIRED CHANGES

HARDWARE SET NO. 06A

For use on Door #(s):

B101M B109 C101 C102 C210B

Provide each SGL door(s) with the following:

QTY		DESCRIPTION	CATALOG NUMBER	FINISH	MFR
3	EA	HINGE	5BB1 4.5 X 4.5	B643E/ 716	IVE
1	EA	PRIVACY LOCK	ND40S SPA 10-013 1 1/8" LIP	643e	SCH
1	EA	SURFACE CLOSER	4011 WMS	695	LCN
1	EA	KICK PLATE	8400 8" X 2" LDW B-CS	695	IVE
1	EA	WALL STOP	WS406/407CCV	643E/7 16	IVE
1	EA	GASKETING	488SBK PSA	BK	ZER

NOTE:

EXISTING DOOR AND FRAME TO REMAIN

VERIFY EXISTING DOOR AND FRAME PREPS FOR COMPATIBILITY OF SPECIFIED HARDWARE
PRIOR TO ORDERING NOTIFY ARCHITECT OF ANY REQUIRED CHANGES

HARDWARE SET NO. 06B

For use on Door #(s):

C106A-A C119A

Provide each SGL door(s) with the following:

QTY		DESCRIPTION	CATALOG NUMBER	FINISH	MFR
3	EA	HINGE	5BB1 4.5 X 4.5	B643E/ 716	IVE
1	EA	PRIVACY LOCK	ND40S SPA	643e	SCH
1	EA	SURFACE CLOSER	4011 WMS	695	LCN
1	EA	KICK PLATE	8400 8" X 2" LDW B-CS	695	IVE
1	EA	WALL STOP	WS406/407CCV	643E/7 16	IVE
1	EA	GASKETING	488SBK PSA	BK	ZER

HARDWARE SET NO. 06C

For use on Door #(s):

B111E C106A

Provide each SGL door(s) with the following:

QTY		DESCRIPTION	CATALOG NUMBER	FINISH	MFR
3	EA	HINGE	5BB1 4.5 X 4.5	B643E/ 716	IVE
1	EA	PRIVACY LOCK	ND40S SPA	643e	SCH
1	EA	SURFACE CLOSER	4111 CUSH	695	LCN
1	EA	KICK PLATE	8400 8" X 2" LDW B-CS	695	IVE
1	EA	GASKETING	488SBK PSA	BK	ZER

HARDWARE SET NO. 06E

For use on Door #(s):

B110E

Provide each SGL door(s) with the following:

QTY		DESCRIPTION	CATALOG NUMBER	FINISH	MFR
3	EA	HINGE	5BB1 4.5 X 4.5	B643E/ 716	IVE
1	EA	PRIVACY LOCK	ND40S SPA 10-013 1 1/8" LIP	643e	SCH
1	EA	WALL STOP	WS406/407CCV	643E/7 16	IVE
1	EA	GASKETING	488SBK PSA	BK	ZER

NOTE:

EXISTING DOOR AND FRAME TO REMAIN

VERIFY EXISTING DOOR AND FRAME PREPS FOR COMPATIBILITY OF SPECIFIED HARDWARE PRIOR TO ORDERING NOTIFY ARCHITECT OF ANY REQUIRED CHANGES

HARDWARE SET NO. 07A

For use on Door #(s):

B115B B115C B116B B116C B117B B117C
B118B B118C

Provide each SGL door(s) with the following:

QTY		DESCRIPTION	CATALOG NUMBER	FINISH	MFR
3	EA	HINGE	5BB1 4.5 X 4.5	B643E/ 716	IVE
1	EA	PASSAGE SET	ND10S SPA	643e	SCH
1	EA	WALL STOP	WS406/407CCV	643E/7 16	IVE
3	EA	SILENCER	SR64	GRY	IVE

NOTE:

EXISTING DOOR AND FRAME TO REMAIN

VERIFY EXISTING DOOR AND FRAME PREPS FOR COMPATIBILITY OF SPECIFIED HARDWARE PRIOR TO ORDERING NOTIFY ARCHITECT OF ANY REQUIRED CHANGES

REMOVE EXISTING DOOR CLOSER.

HARDWARE SET NO. 07B

For use on Door #(s):

B119A

Provide each SGL door(s) with the following:

QTY		DESCRIPTION	CATALOG NUMBER	FINISH	MFR
3	EA	HINGE	5BB1 4.5 X 4.5	B643E/ 716	IVE
1	EA	PASSAGE SET	ND10S SPA	643e	SCH
1	EA	OH STOP	450S	695	GLY
3	EA	SILENCER	SR64	GRY	IVE

HARDWARE SET NO. 08A

For use on Door #(s):

A107 B103 B202 B210

Provide each SGL door(s) with the following:

QTY		DESCRIPTION	CATALOG NUMBER	FINISH	MFR
3	EA	HINGE	5BB1 4.5 X 4.5	B643E/ 716	IVE
1	EA	CLASSROOM DEADBOLT	B663T 12-631	643E	SCH
1	EA	PUSH PLATE	8200 4" X 16" CFC	695	IVE
1	EA	PULL PLATE	8302 10" 4" X 16" CFC	695	IVE
1	EA	SURFACE CLOSER	4011 WMS	695	LCN
1	EA	KICK PLATE	8400 8" X 2" LDW B-CS	695	IVE
1	EA	WALL STOP	WS406/407CCV	643E/7 16	IVE
3	EA	SILENCER	SR64	GRY	IVE

NOTE:

EXISTING DOOR AND FRAME TO REMAIN
 VERIFY EXISTING DOOR AND FRAME PREPS FOR COMPATIBILITY OF SPECIFIED HARDWARE
 PRIOR TO ORDERING NOTIFY ARCHITECT OF ANY REQUIRED CHANGES
 PATCH EXISTING CYLINDRICAL LOCK PREP AND ROUND STRIKE HOLE IN FRAME.

HARDWARE SET NO. 08B

For use on Door #(s):

C106E C106F C106G C106H

Provide each SGL door(s) with the following:

QTY		DESCRIPTION	CATALOG NUMBER	FINISH	MFR
3	EA	HINGE	5BB1HW 4.5 X 4.5 NRP	B643E/ 716	IVE
1	EA	CYL X TURN DEAD LOCK	L460T 09-544	643E	SCH
1	EA	CLASSROOM DEADBOLT	B663T 12-631	643E	SCH
1	EA	FSIC CORE	23-030	622	SCH
1	EA	PUSH PLATE	8200 4" X 16" CFC	695	IVE
1	EA	PULL PLATE	8302 10" 4" X 16" CFC	695	IVE
1	EA	SURFACE CLOSER	4111 HCUSH	695	LCN
1	EA	KICK PLATE	8400 8" X 2" LDW B-CS	695	IVE
3	EA	SILENCER	SR64	GRY	IVE

HARDWARE SET NO. 09A

For use on Door #(s):

C112C C112D C200 C217

Provide each SL door(s) with the following:

QTY		DESCRIPTION	CATALOG NUMBER	FINISH	MFR
	EA	ALL HARDWARE	BY OTHERS		

HARDWARE SET NO. 10A

For use on Door #(s):

B105

Provide each SGL door(s) with the following:

QTY		DESCRIPTION	CATALOG NUMBER	FINISH	MFR
3	EA	HINGE	5BB1 4.5 X 4.5 NRP	B643E/ 716	IVE
1	EA	VANDL STOREROOM LOCK	ND96TD SPA	643e	SCH
1	EA	FSIC CORE	23-030	622	SCH
1	EA	MAGNETIC LOCK	M450P ATS/LED	628	SCE
1	EA	SURFACE CLOSER	4111 CUSH	695	LCN
1	EA	KICK PLATE	8400 8" X 2" LDW B-CS	695	IVE
3	EA	SILENCER	SR64	GRY	IVE
1	EA	PUSH BUTTON	621ALEX DA 12/24 VDC	630	SCE
1	EA	MOTION SENSOR	SCANII 12/24 VDC	BLK	SCE
1	EA	POWER SUPPLY	PS902 900-2RS FA900 120/240 VAC	LGR	SCE

NOTE:

EXISTING DOOR AND FRAME TO REMAIN
 VERIFY EXISTING DOOR AND FRAME PREPS FOR COMPATIBILITY OF SPECIFIED HARDWARE
 PRIOR TO ORDERING NOTIFY ARCHITECT OF ANY REQUIRED CHANGES

DOOR OPERATION:

DOOR NORMALLY CLOSED AND LOCKED
 ENTRY BY VALID CARD CREDENTIAL
 FREE EGRESS FROM INSIDE AT ALL TIMES
 APPROACHING DOOR FROM PUSH SIDE WILL RELEASE MAGNET
 EMERGENCY DELAYED ACTION PUSH BUTTON ON WALL WILL RELEASE MAGNET FOR
 MINIMUM OF 30 SECONDS.
 MAGNET CONNECTED TO FIRE ALARM FOR IMMEDIATE EMERGENCY RELEASE.
 DOOR CONTACT AND REQUEST TO EXIT MONITORED BY DIVISION 28

HARDWARE SET NO. 10E

For use on Door #(s):

C205

Provide each SGL door(s) with the following:

QTY		DESCRIPTION	CATALOG NUMBER	FINISH	MFR
3	EA	HINGE	5BB1 4.5 X 4.5	B643E/ 716	IVE
1	EA	VANDL STOREROOM LOCK	ND96TD SPA	643e	SCH
1	EA	FSIC CORE	23-030	622	SCH
1	EA	ELECTRIC STRIKE	6400 FSE 12/24 VAC/VDC	630	VON
1	EA	SURFACE CLOSER	4011 WMS	695	LCN
1	EA	KICK PLATE	8400 8" X 2" LDW B-CS	695	IVE
1	EA	WALL STOP	WS406/407CCV	643E/7 16	IVE
3	EA	SILENCER	SR64	GRY	IVE
1	EA	DOOR CONTACT	679-05HM	BLK	SCE
1	EA	POWER SUPPLY	PS902 900-2RS 120/240 VAC	LGR	SCE
1	EA	CARD READER	FURNISHED BY OTHERS		

DOOR OPERATION:

DOOR NORMALLY CLOSED AND LOCKED

ENTRY BY VALID CARD CREDENTIAL OR KEY OVERRIDE

FREE EGRESS FROM INSIDE AT ALL TIMES

DOOR CONTACT AND REQUEST TO EXIT MONITORED BY DIVISION 28

HARDWARE SET NO. 11A

For use on Door #(s):

B107I

Provide each SGL door(s) with the following:

QTY		DESCRIPTION	CATALOG NUMBER	FINISH	MFR
3	EA	HINGE	5BB1 4.5 X 4.5 NRP	B643E/ 716	IVE
1	EA	DBL CYL STORE LOCK	ND66TD SPA 10-013 1 1/8" LIP	643e	SCH
2	EA	FSIC CORE	23-030	622	SCH
1	EA	MOUNTING BRACKET	MB	BLK	IVE
1	EA	SURFACE CLOSER	4111 HCUSH	695	LCN
1	EA	KICK PLATE	8400 8" X 2" LDW B-CS	695	IVE
1	SET	GASKETING	870D-S	D	ZER
1	EA	DOOR BOTTOM	364AA	AA	ZER



ARCHITECT

CRABTREE, ROHRBAUGH & ASSOCIATES
401 E. Winding Hill Road
Mechanicstown, PA 17055
Phone: 717-458-0272

Email: jstraub@cro-architects.com
emikkelsen@cro-architects.com
Attn: R. Jeffrey Straub, AIA
Elysa Mikkelsen, AIA

CIVIL ENGINEERS

KS Engineers P.C.
33 S. 3rd Street
Philadelphia, PA 19106
Phone: 215-925-0425

Email: sgavula@kseng.com
Attn: Steve Gavula

MECHANICAL ENGINEER

Moore Engineering Company
3637 Columbia Ave
Lancaster, PA 17603
Phone: 717-285-3141

Email: mikh@mooreengineering.com
Attn: Michael Hunt, PE

ELECTRICAL ENGINEER

Moore Engineering Company
3637 Columbia Ave
Lancaster, PA 17603
Phone: 717-285-3141

Email: andrewn@mooreengineering.com
Attn: Andrew Nolt, PE

STRUCTURAL ENGINEERS

ONYX Design and Consulting, LLC
115 South Howard Street
York, PA 17401
Phone: 717-852-1261

Email: bpavelko@onyxstructural.com
Attn: Brittany Paveiko, PE

FOOD SERVICE

McFarland, Kistler
1130 Perry Highway, Suite 115
Pittsburgh, PA 15237
Phone: 412-999-7659

Email: kistler-mka@comcast.net
Attn: Ken Kistler

11/19/2021

10		
9		
8		
7		
6		
5		
4		
3		
2	12/14/2021	ADDENDUM #2
1	12/10/2021	ADDENDUM #1
NO.	DATE	REVISION

**SCHOOL & LOCATION
RHAWNURST ELEMENTARY
SCHOOL**

7809 Castor Ave, Philadelphia, PA 19152

PROJECT TITLE

**ADDITIONS &
RENOVATIONS**

DRAWING TITLE

**FIRST FLOOR DEMOLITION
PLAN UNITS "A" & "B"**

LOCATION NO.	FILE NO.
DRAWN BY	CHECKED BY
B-070 (R)	OF 2019 / 20
B-071 (R)	OF 2019 / 20
B-072 (R)	OF 2019 / 20
B-073 (R)	OF 2019 / 20

DRAWING NO.

D1.3

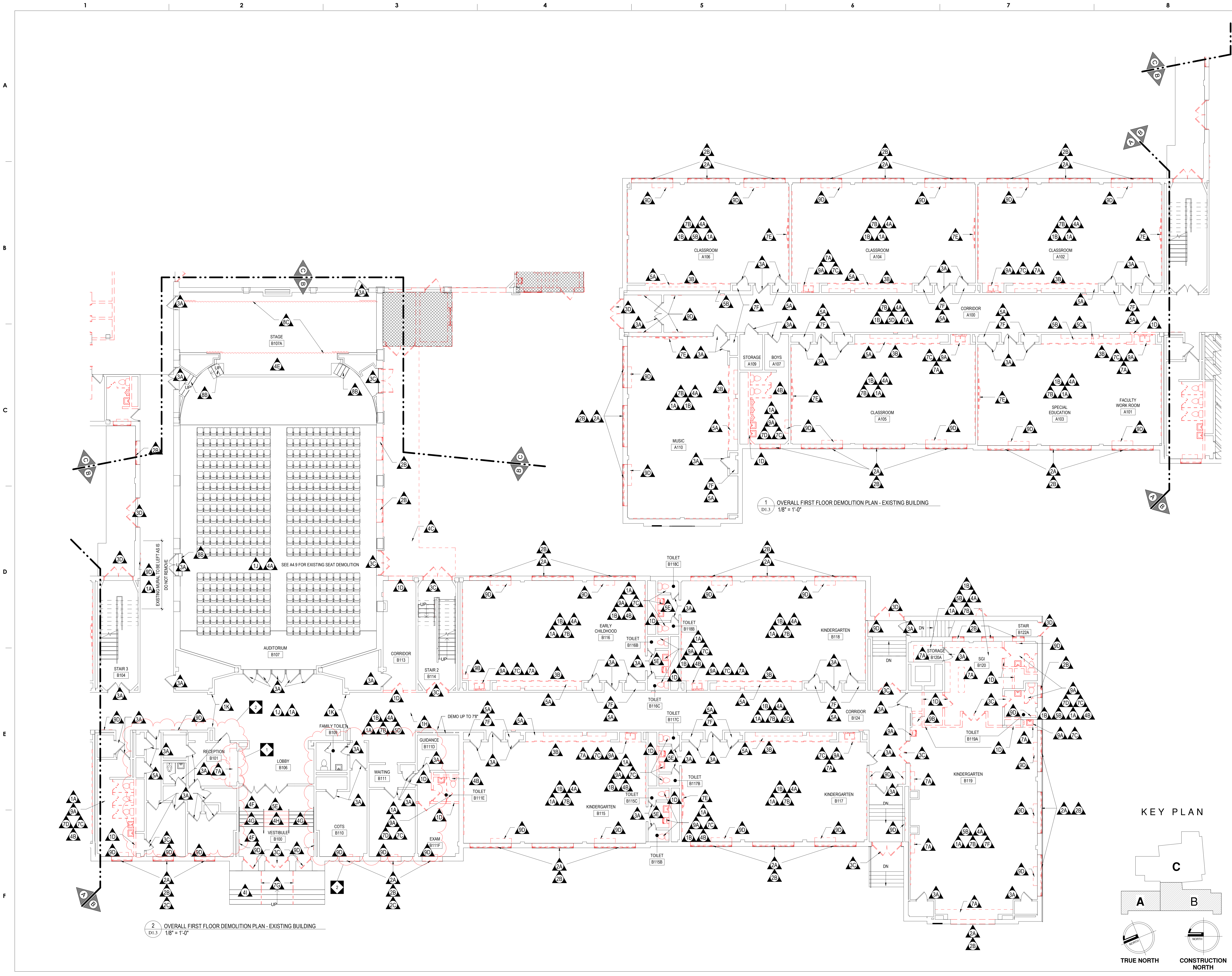

1 OVERALL FIRST FLOOR DEMOLITION PLAN - EXISTING BUILDING
D1.3 1/8" = 1'-0"

2 OVERALL FIRST FLOOR DEMOLITION PLAN - EXISTING BUILDING
D1.3 1/8" = 1'-0"

KEY PLAN

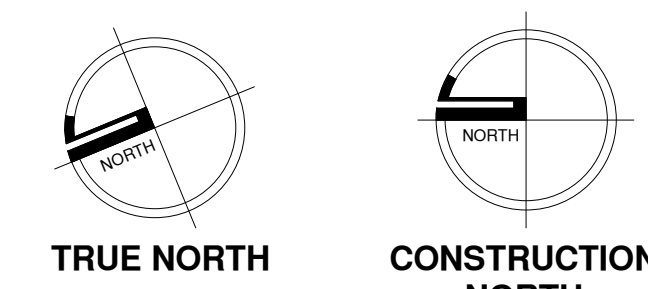
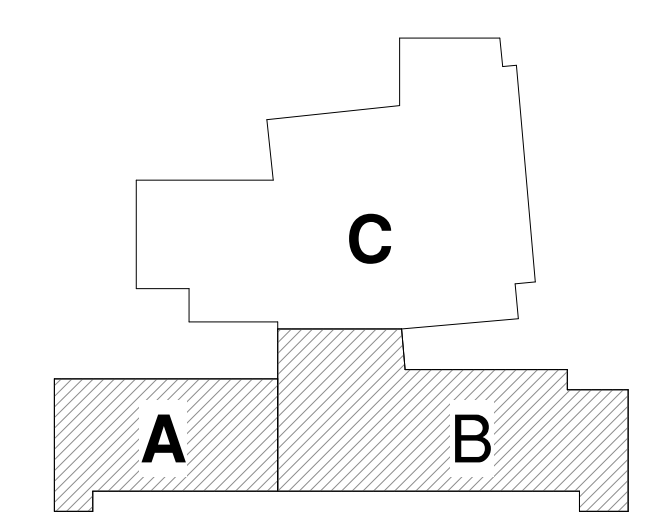

OPENING NUMBER	DOOR & FRAME U.L. RATING	DOOR SCHEDULE - FIRST FLOOR (UNITS A & B)													GLAZING TYPE	HARDWARE SET	SPECIAL DETAIL	REMARKS
		DOOR			DIMENSIONS			FRAME			DETAILS							
		DOOR TYPE	EXISTING / NEW	DOOR MATERIAL	DOOR SCHEDULED FINISH	LEAF 1 WIDTH	LEAF 2 WIDTH	HEIGHT	THICK NESS	FRAME TYPE	FRAME MATERIAL	FRAME SCHEDULED FINISH	HEAD	JAMB				
A100	N	NEW	WD	STN	4'-0"	4'-0"	8'-0"	1 3/4"	H1	HM	PNT	7/A6.6	8/A6.6	--	TEMP	02B		
A101	G	NEW	WD	STN	3'-0"	--	6'-10"	1 3/4"	H4	HM	PNT	7/A6.6	8/A6.6	--	TEMP	03A		C
A102A	G1	ETR	WD	STN	2'-10"	--	6'-10"	1 3/4"	ETR	HM	PNT	--	--	--	TEMP	04A		
A102B	F1	ETR	WD	STN	2'-6"	--	6'-10"	1 3/4"	ETR	HM	PNT	--	--	--	TEMP	05A		
A102C	F1	ETR	WD	STN	2'-6"	--	6'-10"	1 3/4"	ETR	HM	PNT	--	--	--	TEMP	05A		
A103A	G1	ETR	WD	STN	2'-10"	--	6'-10"	1 3/4"	ETR	HM	PNT	--	--	--	TEMP	04A		
A103B	F1	ETR	WD	STN	2'-6"	--	6'-10"	1 3/4"	ETR	HM	PNT	--	--	--	TEMP	05A		
A103C	F1	ETR	WD	STN	2'-6"	--	6'-10"	1 3/4"	ETR	HM	PNT	--	--	--	TEMP	05A		
A104A	G1	ETR	WD	STN	2'-10"	--	6'-10"	1 3/4"	ETR	HM	PNT	--	--	--	TEMP	04A		
A104B	F1	ETR	WD	STN	2'-6"	--	6'-10"	1 3/4"	ETR	HM	PNT	--	--	--	TEMP	05A		
A104C	F1	ETR	WD	STN	2'-6"	--	6'-10"	1 3/4"	ETR	HM	PNT	--	--	--	TEMP	05A		
A105A	G1	ETR	WD	STN	2'-10"	--	6'-10"	1 3/4"	ETR	HM	PNT	--	--	--	TEMP	04A		
A105B	F1	ETR	WD	STN	2'-6"	--	6'-10"	1 3/4"	ETR	HM	PNT	--	--	--	TEMP	05A		
A105C	F1	ETR	WD	STN	2'-6"	--	6'-10"	1 3/4"	ETR	HM	PNT	--	--	--	TEMP	05A		
A106A	G1	ETR	WD	STN	2'-10"	--	6'-10"	1 3/4"	ETR	HM	PNT	--	--	--	TEMP	04A		
A106B	F1	ETR	WD	STN	2'-6"	--	6'-10"	1 3/4"	ETR	HM	PNT	--	--	--	TEMP	05A		
A106C	F1	ETR	WD	STN	2'-6"	--	6'-10"	1 3/4"	ETR	HM	PNT	--	--	--	TEMP	05A		
A107	G2	ETR	WD	STN	2'-10"	--	6'-10"	1 3/4"	ETR	HM	PNT	--	--	--	TEMP, ACID ETCH	08A		
A108A	N	ETR	HM	PNT	2'-6"	2'-6"	6'-10"	1 3/4"	ETR	HM	PNT	--	--	--	TEMP	01P		
A108B	N	NEW	INSUL HM	PNT	3'-4 3/8"	3'-4 3/8"	7'-2"	2 1/2"	ETR	HM	PNT	--	--	--	TEMP, INSUL, LAM	01A		A
A109	F2	ETR	WD	STN	3'-0"	--	6'-10"	1 3/4"	ETR	HM	PNT	--	--	--	TEMP	05D		
A110A	G1	ETR	WD	STN	2'-10"	--	6'-10"	1 3/4"	ETR	HM	PNT	--	--	--	TEMP	04C		
A110B	F1	ETR	WD	STN	2'-6"	--	6'-10"	1 3/4"	ETR	HM	PNT	--	--	--	TEMP	05A		
A110C	F1	ETR	WD	STN	2'-6"	--	6'-10"	1 3/4"	ETR	HM	PNT	--	--	--	TEMP	05A		
B100A	FG2	NEW	ALUM	PNT	3'-0"	7'-2"	2 1/2"	W20	ALUM	ALUM	--	12,13/A6.12	--	--	TEMP, INSUL, LAM	01F		E
B100B	FG2	NEW	ALUM	PNT	2'-6"	2'-6"	7'-2"	2 1/2"	W20	ALUM	ALUM	12/A6.12	--	--	TEMP, INSUL, LAM	01G		E
B100C	FG2	NEW	ALUM	PNT	3'-0"	7'-2"	2 1/2"	W20	ALUM	ALUM	--	12,13/A6.12	--	--	TEMP, INSUL, LAM	01H		E
B101	G	ETR	WD	STN	2'-8"	--	6'-10"	1 3/4"	ETR	HM	PNT	--	--	--	TEMP	03H		
B101B	F	ETR	WD	STN	2'-6"	--	6'-10"	1 3/4"	ETR	HM	PNT	--	--	--	TEMP	04T		
B101C	G	ETR	WD	STN	2'-6"	--	6'-10"	1 3/4"	ETR	HM	PNT	--	--	--	TEMP	03H		
B101D	F	ETR	WD	STN	2'-6"	--	6'-10"	1 3/4"	ETR	HM	PNT	--	--	--	TEMP	05P		
B101E	G	ETR	WD	STN	2'-6"	--	6'-10"	1 3/4"	ETR	HM	PNT	--	--	--	TEMP	03K		
B101F	F	ETR	WD	STN	2'-6"	--	6'-10"	1 3/4"	ETR	HM	PNT	--	--	--	TEMP	04T		
B101G-A	G	ETR	WD	STN	2'-6"	--	6'-10"	1 3/4"	ETR	HM	PNT	--	--	--	TEMP	03K		
B101G-B	G	ETR	WD	STN	2'-6"	--	6'-10"	1 3/4"	ETR	HM	PNT	--	--	--	TEMP	03K		
B101G-C	F	ETR	WD	STN	2'-6"	--	6'-10"	1 3/4"	ETR	HM	PNT	--	--	--	TEMP	03K		
B101H	G	ETR	WD	STN	2'-6"	--	6'-10"	1 3/4"	ETR	HM	PNT	--	--	--	TEMP	04T		
B101K	F	ETR	WD	STN	2'-6"	--	6'-10"	1 3/4"	ETR	HM	PNT	--	--	--	TEMP	04T		
B101L	F	ETR	WD	STN	2'-6"	--	6'-10"	1 3/4"	ETR	HM	PNT	--	--	--	TEMP	04T		
B101M	F	ETR	WD	STN	2'-4"	--	6'-10"	1 3/4"	ETR	HM	PNT	--	--	--	TEMP	04T		
B102	F2	ETR	WD	STN	3'-0"	--	6'-10"	1 3/4"	ETR	HM	PNT	--	--	--	TEMP	05B		
B103	G2	ETR	WD	STN	2'-10"	--	6'-10"	1 3/4"	ETR	HM	PNT	--	--	--	TEMP, ACID ETCH	08A		
B104A	N1	ETR	HM	PNT	2'-6"	2'-6"	6'-10"	1 3/4"	ETR	HM	PNT	--	--	--	TEMP	02F		
B104B	N	NEW	INSUL HM	PNT	3'-4 3/8"	3'-4 3/8"	7'-2"	2 1/2"	ETR	HM	PNT	--	--	--	TEMP, INSUL, LAM	01A		A
B105	F1	ETR	HM	PNT	3'-0"	--	6'-10"	1 3/4"	ETR	HM	PNT	--	--	--	TEMP	10A		
B106A	G	ETR	WD	STN	2'-6"	2'-6"	6'-10"	1 3/4"	ETR	HM	PNT	--	--	--	TEMP	01S		
B106B	G	ETR	WD	STN	2'-6"	2'-6"	6'-10"	1 3/4"	ETR	HM	PNT	--	--	--	TEMP	01T		HM FRAME WITH WD TRIM
B107A	G3	ETR	WD	STN	3'-0"	--	6'-10"	1 3/4"	ETR	HM	PNT	--	--	--	TEMP	04K		
B107B	G3	ETR	WD	STN	3'-0"	--	6'-10"	1 3/4"	ETR	HM	PNT	--	--	--	TEMP	04K		
B107C	G3	ETR	WD	STN	3'-0"	--	6'-10"	1 3/4"	ETR	HM	PNT	--	--	--	TEMP	04K		
B107D	G3	ETR	WD	STN	3'-0"	--	6'-10"	1 3/4"	ETR	HM	PNT	--	--	--	TEMP	04K		
B107E	G3	ETR	WD	STN	3'-0"	--	6'-10"	1 3/4"	ETR	HM	PNT	--	--	--	TEMP	04L		
B107F	G3	ETR	WD	STN	2'-6"	2'-6"	6'-10"	1 3/4"	ETR	HM	PNT	--	--	--	TEMP	04M		
B107G	G3	ETR	WD	STN	2'-6"	2'-6"	6'-10"	1 3/4"	ETR	HM	PNT	--	--	--	TEMP	04M		
B107H	F	ETR	WD	STN	3'-0"	--	6'-10"	1 3/4"	ETR	HM	PNT	--	--	--	TEMP	04L		
B107I	F	ETR	WD	STN	3'-0"	--	6'-10"	1 3/4"	ETR	HM	PNT	--	--	--	TEMP	11A		
B108	F1	ETR	WD	STN	3'-0"	--	6'-10"	1 3/4"	ETR	HM	PNT	--	--	--	TEMP	05D		
B109	F2	ETR	WD	STN	2'-4"	--	6'-10"	1 3/4"	ETR	HM	PNT	--	--	--	TEMP	06A		
B110	F	ETR	WD	STN	3'-0"	--	6'-11"	1 3/4"	ETR	HM	PNT	--	--	--	TEMP	04A		
B110A	F	ETR	WD	STN	2'-6"	--	6'-10"	1 3/4"	ETR	HM	PNT	--	--	--	TEMP	04T		
B111A	F	ETR	WD	STN	3'-0"	--	6'-11"	1 3/4"	ETR	HM	PNT	--	--	--	TEMP	03J		
B111B	F	ETR	WD	STN	2'-6"	--	6'-10"	1 3/4"	ETR	HM	PNT	--	--	--	TEMP	04U		
B111C	G	ETR	WD	STN	2'-6"	--	6'-10"	1 3/4"	ETR	HM	PNT	--	--	--	TEMP	04W		
B111D	G	ETR	WD	STN	2'-6"	--	6'-10"	1 3/4"	ETR	HM	PNT	--	--	--	TEMP	03K		
B111E	F	NEW	WD	STN	2'-10"	--	6'-10"	1 3/4"	H1	HM	PNT	--	--	--	TEMP	06C		
B111F	F	NEW	WD	STN	2'-10"	--	6'-10"	1 3/4"	H1	HM	PNT	--	--	--	TEMP	04V		
B113	FG2	NEW	ALUM	PNT	3'-0"	7'-2"	2 1/2"	A3	ALUM	ALUM	SEE ELEV	SEE ELEV	SEE ELEV	TEMP, INSUL, LAM	01J		D	
B114	N1	NEW	HM	PNT	3'-0"	2'-0"	6'-10"	1 3/4"	H1	HM	PNT	12/A6.6	13/A6.6	--	TEMP	02D		
B114A	F	NEW	WD	STN	3'-0"	--	6'-10"	1 3/4"	H1	HM	PNT	7/A6.6	8/A6.6	--	TEMP	05M		
B115A	G1	ETR	WD	STN	2'-10"	--	6'-10"	1 3/4"	ETR	HM	PNT	--	--	--	TEMP	04A		
B115B	G4	ETR	WD	STN	1'-8"	--	6'-2"	1 3/4"	ETR	HM	PNT	--	--	--	TEMP	07A		
B115C	G4	ETR	WD	STN	1'-8"	--	6'-2"	1 3/4"	ETR	HM	PNT	--	--	--	TEMP	07A		
B115D	F1	ETR	WD	STN	2'-6"	--	6'-10"	1 3/4"	ETR	HM	PNT	--	--	--	TEMP	05A		
B115E	F1	ETR	WD	STN	2'-6"	--	6'-10"	1 3/4"	ETR	HM	PNT	--	--	--	TEMP	05A		
B116A	G1	ETR	WD	STN	2'-10"	--	6'-10"	1 3/4"	ETR	HM	PNT	--	--	--	TEMP	04A		
B116B	G4	ETR	WD	STN	1'-8"	--	6'-2"	1 3/4"	ETR	HM	PNT	--	--	--	TEMP	07A		
B116C	G4	ETR	WD	STN	1'-8"	--	6'-2"	1 3/4"	ETR	HM	PNT	--	--	--	TEMP	07A		
B116D	F1	ETR	WD	STN	2'-6"	--	6'-10"	1 3/4"	ETR	HM	PNT	--	--	--	TEMP	05A		
B116E	F1	ETR	WD	STN	2'-6"	--	6'-10"	1 3/4"	ETR	HM	PNT	--	--	--	TEMP	05A		
B117A	G1	ETR	WD	STN	2'-10"	--	6'-10"	1 3/4"	ETR	HM	PNT	--	--	--	TEMP	04A		
B117B	G4	ETR	WD	STN	1'-8"	--	6'-2"	1 3/4"	ETR	HM	PNT	--	--	--	TEMP	07A		
B117C	G4	ETR	WD	STN	1'-8"	--	6'-2"	1 3/4"	ETR	HM	PNT	--	--	--	TEMP	07A		
B117D	F1	ETR	WD	STN	2'-6"	--	6'-10"	1 3/4"	ETR	HM	PNT	--	--	--	TEMP	05A		
B117E	F1	ETR	WD	STN	2'-6"	--	6'-10"	1 3/4"	ETR	HM	PNT	--	--	--	TEMP	05A		
B117F	G1	ETR	WD	STN	2'-10"	--	6'-10"	1 3/4"	ETR	HM	PNT	--	--	--	TEMP	04A		
B118A	G1	ETR	WD	STN	2'-10"	--	6'-10"	1 3/4"	ETR	HM	PNT	--	--	--	TEMP	04A		
B118B	G4	ETR	WD	STN	1'-8"	--	6'-2"	1 3/4"	ETR	HM	PNT	--	--	--	TEMP	07A		
B118C	G4	ETR	WD	STN	1'-8"	--	6'-2"	1 3/4"	ETR	HM	PNT	--	--	--	TEMP	07A		
B118D	F1	ETR	WD	STN	2'-6"	--	6'-10"	1 3/4"	ETR	HM	PNT	--	--	--	TEMP	05A		
B118E	F1	ETR	WD	STN	2'-6"	--	6'-10"	1 3/4"	ETR	HM	PNT	--	--	--	TEMP	05A		
B119	G	NEW	WD	STN	3'-0"	--	6'-10"	1 3/4"	H4A	HM	PNT	12/A6.6	13/A6.6	--	TEMP	04Q		
B119A	F	NEW	WD	STN	3'-0"	--	6'-10"	1 3/4"	H1	HM	PNT	14/A6.6	15/A6.6	--	TEMP	07B		
B119B	F1	ETR	WD	STN	2'-6"	--	6'-10"	1 3/4"	ETR	HM	PNT	--	--	--	TEMP	05A		
B119C	F1	ETR	WD	STN	2'-6"	--	6'-10"	1 3/4"	ETR	HM	PNT	--	--	--	TEMP	05A		
B120	F2</																	

OPENING NUMBER	DOOR & FRAME U.L. RATING	DOOR SCHEDULE - GROUND FLOOR											GLAZING TYPE	HARDWARE SET	SPECIAL DETAIL	REMARKS			
		DOOR				DIMENSIONS				FRAME							DETAILS		
		DOOR TYPE	EXISTING / NEW	DOOR MATERIAL	DOOR SCHEDULED FINISH	LEAF 1	LEAF 2	HEIGHT	THICKNESS	FRAME TYPE	FRAME MATERIAL	FRAME SCHEDULED FINISH					HEAD	JAMB	SILL
B002GA	45 MIN	F	NEW	HM	PNT	3'-0"		7'-2"	1 3/4"	H1	HM	PNT	4/A6.6	5/A6.6	--	--	05L	B	
B002GB	45 MIN	F	NEW	HM	PNT	3'-6"		7'-2"	1 3/4"	H1	HM	PNT	4/A6.6	5/A6.6	--	--	05L	B	

GLAZING SCHEDULE

INSUL = INSULATING GLASS
 TEMP = FULLY TEMPERED GLASS
 F-60 = FIRE-RATED GLAZING (NUMBER SHOWN IS THE REQUIRED FIRE RATING, IN MINUTES)
 LAM = LAMINATED GLASS
 ACID ETCH = ACID ETCHED GLASS
 NOTE: ALL GLAZING PANELS THAT ARE AT LEAST PARTIALLY WITHIN 6'-6" AFF SHALL BE TEMPERED

LEGEND

ALUM HM ALUMINUM HOLLOW METAL
 INSUL HM INSULATED HOLLOW METAL
 ETR EXISTING TO REMAIN
 O.H. OVERHEAD
 SST STAINLESS STEEL
 STL STEEL
 WD WOOD
 PNT PAINT
 STN STAIN

SCHEDULE REMARKS

A. GC TO GRIND, PROVIDE METAL REPAIR AND FINISH FRAME AS SCHEDULED PRIOR TO DOOR INSTALLATION - AS REQUIRED.
 B. PANNING HARDWARE REQUIRED.
 C. PROVIDE HOLD OPEN.
 D. PROVIDE 180° HOLD OPEN.
 E. EXISTING WOOD TRIM TO BE REMOVED AS NECESSARY FOR INSTALLATION OF NEW DOOR AND/OR FRAME, AND SALVAGED AND REINSTALLED.
 F. 60 MINUTE RATED GLASS AND FRAME - MEET ASTM E119.
 G. SLIDING METAL FIRE DOOR - TIE INTO FIRE ALARM SYSTEM.
 H. SLIDING METAL DOOR.

THE SCHOOL DISTRICT OF PHILADELPHIA
 OFFICE OF CAPITAL PROGRAMS
 440 NORTH BROAD STREET
 PHILADELPHIA, PA 19130 - 4015
 (215) 400 - 4730 (215) 400 - 4731 (fax)
 www.philasd.org
 SEAL:

OPENING NUMBER	DOOR & FRAME U.L. RATING	DOOR SCHEDULE - FIRST FLOOR (UNIT C)											GLAZING TYPE	HARDWARE SET	SPECIAL DETAIL	REMARKS			
		DOOR				DIMENSIONS				FRAME							DETAILS		
		DOOR TYPE	EXISTING / NEW	DOOR MATERIAL	DOOR SCHEDULED FINISH	LEAF 1	LEAF 2	HEIGHT	THICKNESS	FRAME TYPE	FRAME MATERIAL	FRAME SCHEDULED FINISH					HEAD	JAMB	SILL
C100A		N	NEW	WD	STN	3'-0"	3'-0"	6'-10"	1 3/4"	H1	HM	PNT	12/A6.6	13/A6.6	--	TEMP	02C		
C100B		N	NEW	INSUL HM	PNT	3'-4 3/8"	3'-4 3/8"	7'-2"	1 3/4"	ETR	HM	PNT	--	--	--	TEMP, INSUL, LAM	01L	A	
C101		G3	ETR	WD	STN	2'-6"		6'-10"	1 3/4"	ETR	HM	PNT	--	--	--	TEMP, ACID ETCH	06A		
C101A		F	NEW	INSUL HM	PNT	3'-0"	3'-0"	7'-2"	2 1/2"	H1	HM	PNT	1/A6.6	2/A6.6	--		01A		
C102		F2	ETR	WD	STN	2'-4"		6'-10"	1 3/4"	ETR	HM	PNT	--	--	--		06A		
C103		G	NEW	WD	STN	3'-0"		7'-2"	1 3/4"	H9	HM	PNT	SEE ELEV	SEE ELEV	SEE ELEV		03C		
C104		F	NEW	WD	STN	2'-6"	2'-6"	7'-2"	1 3/4"	H1	HM	PNT	7/A6.6	8/A6.6	--		05F		
C105		FG2	NEW	ALUM	PNT	3'-4 3/8"	3'-4 3/8"	7'-2"	2 1/2"	W20	ALUM				TEMP, INSUL, LAM	01D			
C105A		F	NEW	WD	STN	3'-0"		7'-2"	1 3/4"	H1	HM	PNT	7/A6.6	8/A6.6	--		05E		
C106A		F	NEW	WD	STN	3'-0"		7'-2"	1 3/4"	H1	HM	PNT	7/A6.6	8/A6.6	--		06C		
C106A-A		F	NEW	WD	STN	3'-0"		7'-2"	1 3/4"	H1	HM	PNT	7/A6.6	8/A6.6	--		06B		
C106B		F	NEW	WD	STN	3'-0"		7'-2"	1 3/4"	H1	HM	PNT	7/A6.6	8/A6.6	--		04E		
C106C		F	NEW	WD	STN	3'-0"		7'-2"	1 3/4"	H1	HM	PNT	4/A6.6	5/A6.6	--		03B		
C106D		F	NEW	INSUL HM	PNT	3'-0"	3'-0"	7'-2"	2 1/2"	H1	HM	PNT	1/A6.6	2/A6.6	--		01K		
C106E		G	NEW	WD	STN	3'-0"		7'-2"	1 3/4"	H1	HM	PNT	7/A6.6	8/A6.6	--	TEMP	08B		
C106F		G	NEW	WD	STN	3'-0"		7'-2"	1 3/4"	H10	HM	PNT	SEE ELEV	SEE ELEV	SEE ELEV	TEMP	08B		
C106G		G	NEW	WD	STN	3'-0"		7'-2"	1 3/4"	H11	HM	PNT	SEE ELEV	SEE ELEV	SEE ELEV	TEMP	08B		
C106H		G	NEW	WD	STN	3'-7"		7'-2"	1 3/4"	H12	HM	PNT	SEE ELEV	SEE ELEV	SEE ELEV	TEMP	08B		
C107		G	NEW	WD	STN	3'-0"		7'-2"	1 3/4"	H3	HM	PNT	4/A6.6	5/A6.6	--	TEMP, LAM	03D		
C107A		G	NEW	WD	STN	3'-0"		6'-10"	1 3/4"	H4A	HM	PNT	12/A6.6	13/A6.6	--	TEMP, LAM	04R		
C107B		G	NEW	WD	STN	3'-0"		6'-10"	1 3/4"	H4	HM	PNT	12/A6.6	13/A6.6	--	TEMP, LAM	04R		
C107C		G	NEW	WD	STN	3'-4 3/8"	3'-4 3/8"	7'-2"	1 3/4"	ETR	HM	PNT	--	--	--	TEMP, LAM	04F	A	
C107D		FG2	NEW	ALUM		3'-0"	3'-0"	7'-2"	1 3/4"	A1	ALUM		SEE ELEV	SEE ELEV	SEE ELEV	TEMP, LAM	04S		
C108A		FG2	NEW	ALUM		3'-0"	3'-0"	7'-2"	2 1/2"	W12	ALUM		SEE ELEV	SEE ELEV	SEE ELEV	TEMP, INSUL, LAM	01D		
C108B		60 MIN	FG2	NEW	ALUM	3'-0"	3'-0"	7'-2"	2 1/2"	W13	ALUM		SEE ELEV	SEE ELEV	SEE ELEV	TEMP, F-60	01N	F	
C110		G	NEW	WD	STN	3'-0"		7'-2"	1 3/4"	H15	HM	PNT	4/A6.6	5/A6.6	--	TEMP	04B		
C111		G	NEW	WD	STN	3'-0"		7'-2"	1 3/4"	H14	HM	PNT	4/A6.6	5/A6.6	--	TEMP	04B		
C112A		N	NEW	WD	STN	3'-0"	3'-0"	8'-0"	1 3/4"	H1	HM	PNT	4/A6.6	5/A6.6	--	TEMP	02B		
C112B		N	NEW	WD	STN	3'-0"	3'-0"	8'-0"	1 3/4"	H1	HM	PNT	4/A6.6	5/A6.6	--	TEMP	02B		
C112D		V	NEW	STL		10'-8"		9'-4"	1'-2"	--	STL		--	--	--		09A	H	
C113		120 MIN	F	NEW	WD	STN	4'-0"	4'-0"	8'-0"	H1	HM	PNT	4/A6.6	5/A6.6	--		02E	C	
C113A		FG2	NEW	ALUM		3'-0"		7'-2"	2 1/2"	A5	ALUM		SEE ELEV	SEE ELEV	SEE ELEV	TEMP, INSUL, LAM	02E		
C113B		FG2	NEW	ALUM		3'-9 3/32"		7'-2"	2 1/2"	A6	ALUM		SEE ELEV	SEE ELEV	SEE ELEV	TEMP, INSUL, LAM	01J		
C115		G	NEW	WD	STN	3'-0"		7'-2"	1 3/4"	H14	HM	PNT	4/A6.6	5/A6.6	--	TEMP	04B		
C117		G	NEW	WD	STN	3'-0"		7'-2"	1 3/4"	H14	HM	PNT	4/A6.6	5/A6.6	--	TEMP	04B		
C118		G	NEW	WD	STN	3'-0"		7'-2"	1 3/4"	H15	HM	PNT	4/A6.6	5/A6.6	--	TEMP	04B		
C119		F	NEW	WD	STN	3'-0"		7'-2"	1 3/4"	H1	HM	PNT	4/A6.6	5/A6.6	--		05E		
C119A		F	NEW	WD	STN	3'-0"		7'-2"	1 3/4"	H1	HM	PNT	4/A6.6	5/A6.6	--		06B		
C120		G	NEW	WD	STN	3'-0"		7'-2"	1 3/4"	H14	HM	PNT	4/A6.6	5/A6.6	--	TEMP	04B		
C121		G	NEW	WD	STN	3'-0"		7'-2"	1 3/4"	H15	HM	PNT	4/A6.6	5/A6.6	--	TEMP	03A		
C122		G	NEW	WD	STN	3'-0"		7'-2"	1 3/4"	H14	HM	PNT	4/A6.6	5/A6.6	--	TEMP	04B		
C123		45 MIN	F	NEW	WD	STN	3'-0"	7'-2"	1 3/4"	H1	HM	PNT	4/A6.6	5/A6.6	--		05G		
C127		F	NEW	WD	STN	3'-0"		7'-2"	1 3/4"	H1	HM	PNT	4/A6.6	5/A6.6	--		05C		
C128A		FG2	NEW	ALUM		3'-0"		7'-2"	1 3/4"	W15	ALUM		SEE ELEV	SEE ELEV	SEE ELEV	TEMP	01M		
C128B		FG2	NEW	ALUM		3'-0"	3'-0"	7'-2"	1 3/4"	W15	ALUM		SEE ELEV	SEE ELEV	SEE ELEV	TEMP	01B		
C129A		FG2	NEW	ALUM		3'-0"		7'-2"	2 1/2"	W14	ALUM		SEE ELEV	SEE ELEV	SEE ELEV	TEMP, INSUL, LAM	01E		
C129B		FG2	NEW	ALUM		3'-0"	3'-0"	7'-2"	2 1/2"	W14	ALUM		SEE ELEV	SEE ELEV	SEE ELEV	TEMP, INSUL, LAM	01L		
C131		F	NEW	WD	STN	3'-0"		7'-2"	1 3/4"	H1	HM	PNT	4/A6.6	5/A6.6	--		05E		

OPENING NUMBER	DOOR & FRAME U.L. RATING	DOOR SCHEDULE - SECOND FLOOR											GLAZING TYPE	HARDWARE SET	SPECIAL DETAIL	REMARKS			
		DOOR				DIMENSIONS				FRAME							DETAILS		
		DOOR TYPE	EXISTING / NEW	DOOR MATERIAL	DOOR SCHEDULED FINISH	LEAF 1	LEAF 2	HEIGHT	THICKNESS	FRAME TYPE	FRAME MATERIAL	FRAME SCHEDULED FINISH					HEAD	JAMB	SILL
A200A		G1	ETR	WD	STN	2'-10"		6'-10"	1 3/4"	ETR	HM	PNT	--	--	--	TEMP	04A		
A200B		F1	ETR	WD	STN	2'-6"		6'-10"	1 3/4"	ETR	HM	PNT	--	--	--		05A		
A200C		F1	ETR	WD	STN	2'-6"		6'-10"	1 3/4"	ETR	HM	PNT	--	--	--		05A		
A201A		G1	ETR	WD	STN	2'-10"		6'-10"	1 3/4"	ETR	HM	PNT	--	--	--	TEMP	04A		
A201B		F1	ETR	WD	STN	2'-6"		6'-10"	1 3/4"	ETR	HM	PNT	--	--	--		05A		
A201C		F1	ETR	WD	STN	2'-6"		6'-10"	1 3/4"	ETR	HM	PNT	--	--	--		05A		
B200		F	NEW	WD	STN	3'-4"	3'-4"	7'-10"	1 3/4"	H1	HM	PNT	7/A6.6	8/A6.6	--		02D		
B201		N1	ETR	HM	PNT	2'-6"	2'-6"	6'-10"	1 3/4"	ETR	HM	PNT	--	--	--	TEMP	02F		
B202		G2	ETR	WD	STN	2'-10"		6'-10"	1 3/4"	ETR	HM	PNT	--	--	--	TEMP, ACID ETCH	08A		
B203		F1	ETR	WD	STN	2'-10"		6'-10"	1 3/4"	ETR	HM	PNT	--	--	--		03F		
B204		F1	ETR	WD	STN	3'-0"		6'-10"	1 3/4"	ETR	HM	PNT	--	--	--		05D		
B205A		F1	ETR	WD	STN	3'-0"		6'-10"	1 3/4"	ETR	HM	PNT	--	--	--		05B		
B205B		F1	ETR	WD	STN	3'-0"		6'-10"	1 3/4"	ETR	HM	PNT	--	--	--		05B		
B206A		G	NEW	WD	STN	2'-10"		6'-10"	1 3/4"	ETR	HM	PNT	--	--	--	TEMP	03G		
B206B		G	NEW	WD	STN	3'-0"		6'-10"	1 3/4"	H7	HM	PNT	SEE ELEV	SEE ELEV	SEE ELEV	TEMP	04P		
B206C		G	NEW	WD	STN	3'-0"		6'-10"	1 3/4"	H7	HM	PNT	SEE ELEV	SEE ELEV	SEE ELEV	TEMP	04N		
B206D		F1	ETR	WD	STN	2'-6"		6'-10"	1 3/4"	ETR	HM	PNT	--	--	--		05J		
B207		N1	ETR	HM	PNT	2'-6"	2'-6"	6'-10"	1 3/4"	ETR	HM	PNT	--	--	--	TEMP	02F		
B208		F1	ETR	WD	STN	2'-10"		6'-10"	1 3/4"	ETR	HM	PNT	--	--	--		03F		