

THE SCHOOL DISTRICT OF PHILADELPHIA  
BOARD OF EDUCATION  
Office of Capital Programs  
440 North Broad Street, 3<sup>rd</sup> Floor – Suite 371  
Philadelphia, PA 19130

TELEPHONE: (215) 400-4730

**Addendum No. 001**

**Subject: Schoolyard Improvement at Joseph Pennell School  
SDP Contracts No. B-066C of 2020/21**

**Location: Joseph Pennell Elementary School  
1800 Nedro Avenue  
Philadelphia, Pennsylvania 19141**

---

**This Addendum, dated May 2, 2022, shall modify and become part of the Contract Documents for the work of this project. Any items not mentioned herein, or affected by, shall be performed strictly in accordance with the original documents.**

---

**Questions and Clarifications : Responses 04/27/2022**

1. Notes 7 and 8 on Plan L-104 indicate that portions of the work will be performed by the Mural Arts contractor and are not included in the bid. Please provide a more detailed description of the work to be performed by Mural Arts in the Little Library Area. For example, is Mural Arts furnishing the benches and ottoman?

- a. RESPONSE: 'Little Free Library' is labeled on drawing 1, sheet L-104. It is located adjacent to plant bed, south of the Pre-School Building. This is the only element that Mural Arts will be furnishing. See attached image below for example of 'Little Free Library' for reference. All other elements -- except 'Little Free Library' --labeled on plan should be furnished and installed by Contractor.



*Photo: Example of 'Little Free Library' site element, to be provided by Mural Arts.*

2. Please provide a manufacturer for the 48" Eye Hook Steel Stake shown in Detail 3 on Plan L-502.
  - a. RESPONSE: There is no specific manufacturer required. Contractor to select product/material and provide Owner and Landscape Architect submittal during construction for review and approval. Product may be what is shown on detail, or Contractor may propose a substitute for review and approval.
3. Please provide a specification and color for the concrete unit pavers per Detail 2 L-401.
  - a. RESPONSE: Pavers to be 'Victorien 60mm Permeable', manufactured by Techo-Bloc. Color to be 'Chestnut Brown'.
4. Please confirm the installation orientation of the pavers, Detail 5 L-501 shows the pavers in different orientations.
  - a. RESPONSE: Revised version of Detail 5 is attached. Install in linear pattern in a north-south orientation perpendicular to edge of trench. See response to Question #3 for manufacturer information and paver specification.
5. Detail 3 L-503 shows anchors for wood ottoman(s) to be a 12" embedment in existing Concrete paving which is shown elsewhere to be 4" thick. Please confirm if foundations are needed at the wood structure supports, the anchor diameter, and if a footing is needed, please provide a detail.
  - a. RESPONSE: Depth of existing concrete is unknown. Wood anchors to be surface mounted to new or existing concrete pavement. Desired embedment is 12" deep, per detail, to secure ottoman. Contractor to submit shop drawings for anchor attachments for review and approval.
6. Detail 3 L-503 indicates in the structure plan that Joists are (2) 2 x 8 Cedar Joist. The section indicates that the joists are (2) 2 x 14 cedar Joists, please confirm.
  - a. RESPONSE: Cedar joists to be cut to fit diameter of ottomans as shown on plans – there are two different sizes (6' diameter and 12' diameter) of ottomans.

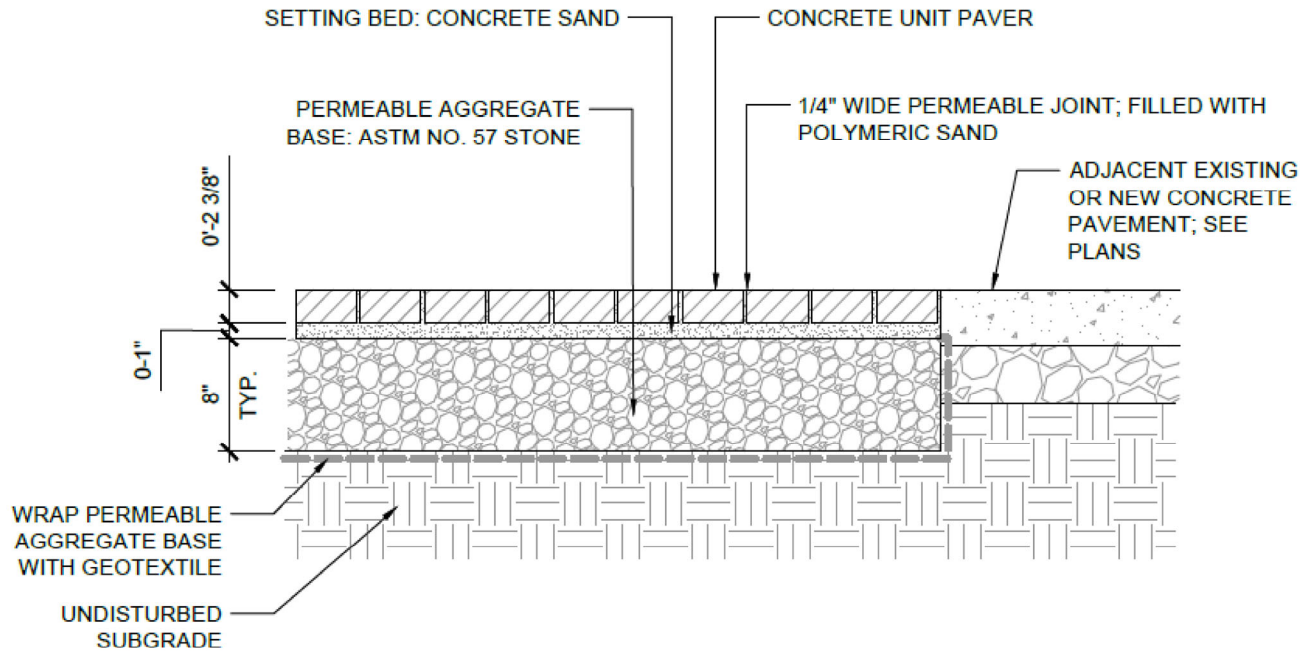

**NOTES:**

1. CONCRETE UNIT PAVERS SHALL BE 'VICTORIEN 60 mm PERMEABLE' IN 'CHESTNUT BROWN', MANUFACTURED BY TECHO-BLOC.
2. PROVIDE FULL SIZE SAMPLES OF PAVERS FOR APPROVAL BY LANDSCAPE ARCHITECT.
3. PROVIDE 6'-0" x 6'-0" MOCK UP OF PAVING LAYOUT FOR APPROVAL BY LANDSCAPE ARCHITECT PRIOR TO INSTALLATION.
4. INSTALL CONCRETE UNIT PAVERS IN ACCORDANCE WITH MANUFACTURERS SPECIFICATIONS.
5. INSTALL PAVERS FLUSH WITH ADJACENT CONCRETE PAVEMENT.
6. SEE CIVIL ENGINEERING DRAWINGS FOR FINISH GRADES OF UNIT PAVERS.
7. COORDINATE UNIT PAVER INSTALLATION WITH OTHER SITE PAVEMENTS AND SITE FURNISHINGS.