

Addendum No. 1

Subject: Samuel Powel School – Parking Lot Renovations
SDP Contract No. 2022-080-G

Location: Samuel Powel School
3501-15 Powelton Avenue
Philadelphia, PA 19104

This Addendum, dated 16th of May, 2022, shall modify and become part of the Contract Documents for the work of this project. Any items not mentioned herein, or affected by, shall be performed strictly in accordance with the original documents.

CHANGES TO DRAWINGS:

DRAWING C-200 – DEMOLITION PLAN

1. Removed from plan the eradication of existing pavement markings. Added a note indicating that the pavement markings would be removed with the application of the seal coat shown on the Proposed Site Plan.

DRAWING C-300 – PROPOSED SITE PLAN

1. Added proposed seal coat on existing bituminous pavement parking area to remain.
2. Revised Landscape Planting Layout and added a planting schedule.

DRAWING C-701 – LANDSCAPE DETAILS

1. New plan created and added to the contract documents with details for the landscaping on the project.

BIDDER'S QUESTIONS SUBMITTED TO DATE AND RESPONSES ARE AS FOLLOWS:

1. Specifications Section 321236 Asphalt Seal Coat – I don't see any limits on the plans for the seal coating work. Are you looking for all the existing asphalt to be seal coated before the new line striping is installed? Please define the seal coating limits.
Answer: The Proposed Site Plan (C-300) has been updated to show the limits of the seal coat. The Demolition Plan (C-200) has been updated to exclude the specific eradication of the existing pavement markings; the seal coat will eradicate the existing markings. Seal coating shall be installed in advance of the proposed line striping.
2. Will you be supplying a plant list for the project?
Answer: The Proposed Site Plan (C-300) has been updated with proposed planting layout and plant schedule. The Landscape Details (C-701) has been added to the Contract Documents for the proposed landscaping.

ATTACHMENTS:

DRAWINGS

DRAWING C-200 – DEMOLITION PLAN
DRAWING C-300 – PROPOSED SITE PLAN
DRAWING C-701 – LANDSCAPE DETAILS

End of Addendum No. 1

[illegible]

SCHOOL & LOCATION
Samuel Powel School
3501-15 POWELTON AVENUE,
PHILADELPHIA PA

PROJECT TITLE

PARKING LOT RENOVATIONS

DRAWING TITLE

LOCATION NO.	FILE NO.
DRAWN BY KSE	CHECKED BY KSE
SDP Contract No. 2022-080-G	
DRAWING NO. C-200	

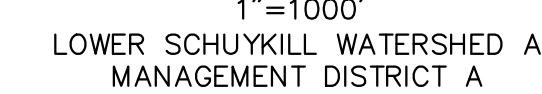

GENERAL NOTES:

1. RIGHT-OF-WAY LINES ARE PLOTTED FROM CITY PLAN INFORMATION. EXISTING SITE CONDITIONS INCLUDING BUILDINGS, CURBS, LOT LINES AND CONTOURS ARE PLOTTED FROM GIS DATA AND ALL OTHER INFORMATION PLOTTED FROM AERIAL PHOTOGRAPHY.
2. MERIDIANS AND BEARINGS ARE REFERENCED TO CITY PLAN NO. 44. LOT BEARINGS AND DISTANCES ARE SHOWN IN PHILADELPHIA DISTRICT STANDARD. ALL OTHER DIMENSIONS ARE SHOWN IN U.S. SURVEY FEET.
3. SUBJECT TO ALL RESTRICTIONS, EASEMENTS AND/OR COVENANTS OF RECORD EITHER WRITTEN OR IMPLIED THAT MAY NOT APPEAR ON THIS PLAN.
4. UNDERGROUND UTILITIES AS SHOWN ARE TAKEN FROM FIELD EVIDENCE AND PLANS AS PROVIDED BY THE VARIOUS UTILITY AUTHORITIES (PA ONE CALL SERIAL NO. 2023281820). THE ACCURACY REGARDING UTILITY LOCATION AND/OR DEPTH CANNOT BE GUARANTEED AND ADDITIONAL UNDERGROUND UTILITIES NOT DEPICTED ON THE PLAN MAY EXIST. BEFORE EXCAVATIONS ARE BEGUN, THE PENNSYLVANIA ONE CALL SYSTEM AT 1-800-242-1776 SHALL BE CONTACTED AT LEAST 5-10 DAYS PRIOR TO COMMENCEMENT OF ANY DEMOLITION OR EXCAVATION ACTIVITIES IN ACCORDANCE WITH ALL APPLICABLE LAWS, RULES AND REGULATIONS.
5. INFORMATION PERTAINING TO LOTS OTHER THAN THE SUBJECT PARCEL IS SHOWN FOR INFORMATIONAL PURPOSES ONLY.
6. SITE LIES WITHIN THE MAPPED LIMITS OF FLOOD ZONE X, AS SHOWN ON THE FEMA FLOOD INSURANCE RATE PAY COMMUNITY-PANEL NO. 4207507179G, DATED 01/17/2007 FOR THE CITY OF PHILADELPHIA.
7. PROJECT SITE IS NOT LOCATED IN A SPECIAL FLOOD HAZARD ZONE AND THERE ARE NOT WETLANDS ON SITE. THERE ARE NO WATER COURSES OR BODIES OF WATER LOCATED WITHIN 100 FEET OF THE PROPERTY.

SITE LOCATION:
3501-15 POWELTON AVENUE
PHILADELPHIA, PA 19104

PROPERTY OWNER:
SCHOOL DISTRICT
OF PHILADELPHIA
440 N BROAD STREET
PHILADELPHIA PA 19130

PROTECT YOURSELF

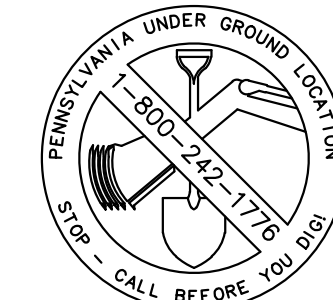

WHAT YOU DON'T KNOW CAN HURT YOU.

CALL BEFORE YOU DIG!
PENNSYLVANIA LAW REQUIRES 3 WORKING DAYS NOTICE FOR
CONSTRUCTION PHASE & 10 WORKING DAYS IN DESIGN STAGE

Pennsylvania One Call System, Inc.
1-800-242-1776

ACT 187

IT IS THE CONTRACTOR'S RESPONSIBILITY TO COMPLY
WITH THE PENNSYLVANIA ACT 187 AND TO CONTACT THE
"ONE CALL SYSTEM" THREE (3) WORKING DAYS (UNLESS OTHERWISE NOTED) PRIOR
TO START OF CONSTRUCTION

PENNSYLVANIA ONE CALL: 1-800-242-1776

<u>PHILADELPHIA WATER DEPARTMENT</u>	<u>VERIZON</u>
1101 MARKET STREET, 2nd FLOOR	900 RACE STREET
PHILADELPHIA, PENNSYLVANIA	PHILADELPHIA, PENNSYLVANIA
(215) 685-6270	(215) 351-8947
<u>PHILADELPHIA GAS WORKS</u>	<u>COMCAST</u>
800 W. MONTGOMERY AVENUE, 3RD FLOOR	1351 N. LUMUMBUS BOULEVARD
PHILADELPHIA, PENNSYLVANIA 19102	PHILADELPHIA, PENNSYLVANIA
(215) 684-6796	(215) 952-4935
<u>PECO-CONSTRUCTION DEPARTMENT</u>	
2301 MARKET STREET	
PHILADELPHIA, PENNSYLVANIA 19103	
(215) 731-3264	

[illegible]

SCHOOL & LOCATION
Samuel Powel School
3501-15 POWELTON AVENUE,
PHILADELPHIA PA

PROJECT TITLE

PARKING LOT RENOVATIONS

DRAWING TITLE

PROPOSED SITE PLAN

LOCATION NO.	FILE NO.
DRAWN BY KSE	CHECKED BY KSE
SDP Contract No. 2022-080-G	
DRAWING NO. C-300	



VICINITY MAP
1"=1000'
LOWER SCHUYLKILL WATERSHED A
MANAGEMENT DISTRICT A

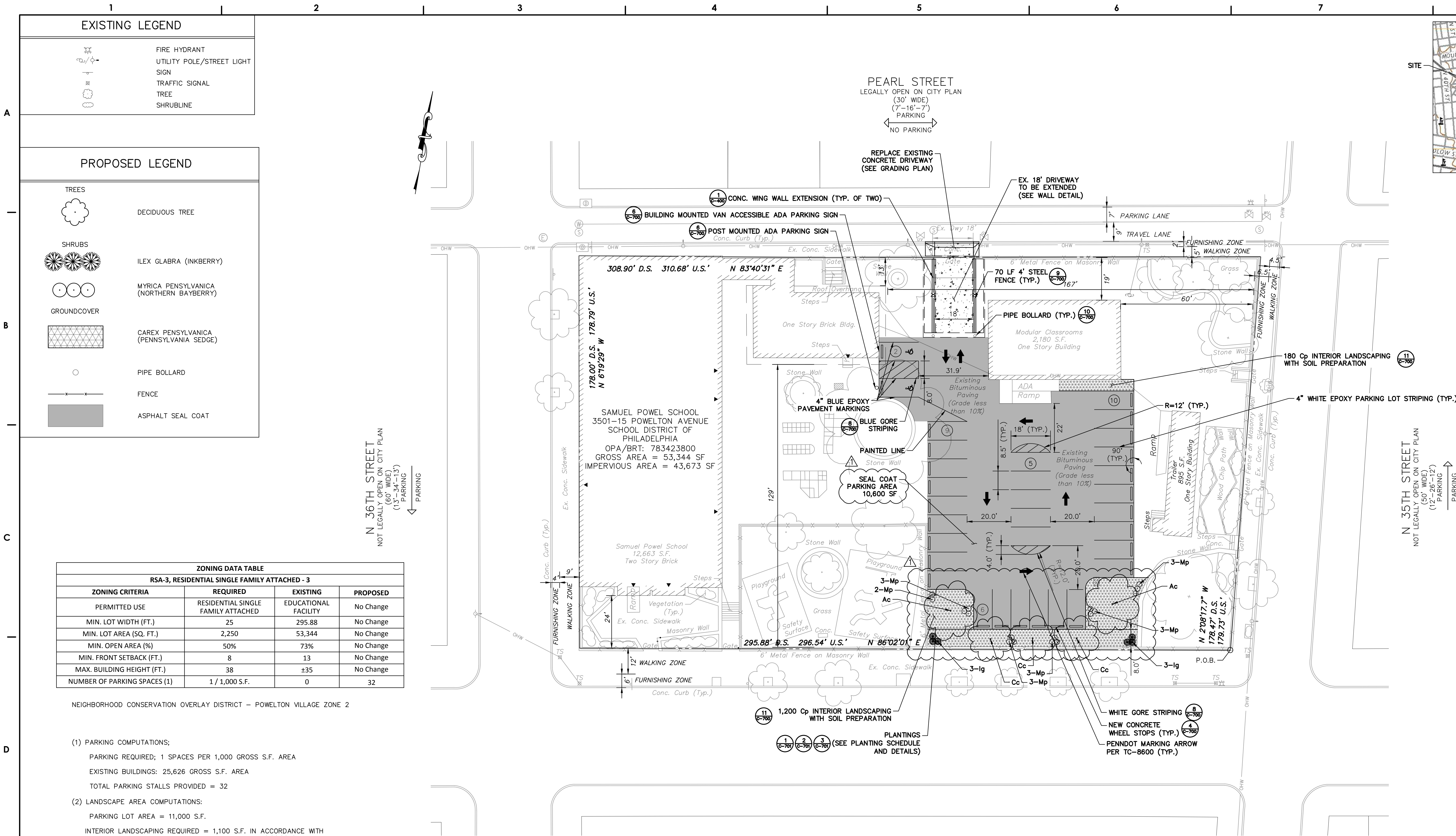

POWELTON AVENUE

LEGALLY OPEN ON CITY PLAN
(80' WIDE)
(18'-44'-18')
PARKING
PARKING

PLANTING SCHEDULE

PLANTING SCHEDULE						
QUANTITY	ID	BOTANICAL NAME	COMMON NAME	SIZE	SPACING	NOTES
2	Ac	AMELANCHIER CANADENSIS	SHADBLow SERVICE-BERRY	8'-10' HT., B&B	AS SHOWN	SPECIMEN QUALITY
3	Cc	CARPINUS CORDATA	HORNBEAM	2"-2½" CAL., B&B	AS SHOWN	SPECIMEN QUALITY
6	Ig	ILEX GLABRA	INKBERRY	24"-30", B&B	AS SHOWN	SPECIMEN QUALITY
17	Mp	MYRICA PENNSYLVANICA	NORTHERN BAYBERRY	24"-30", B&B	AS SHOWN	SPECIMEN QUALITY
1,380 SF	Cp	CAREX PENNSYLVANICA	PENNSYLVANIA SEDGE	2-YEAR	12" O.C.	PLUGS OR PEAT POTS LIFT FOLIAGE ABOVE MULCH

SITE LOCATION:

3501-15 POWELTON AVENUE
PHILADELPHIA, PA 19104

PROPERTY OWNER:

SCHOOL DISTRICT
OF PHILADELPHIA
440 N BROAD STREET
PHILADELPHIA PA 19130

PROTECT YOURSELF

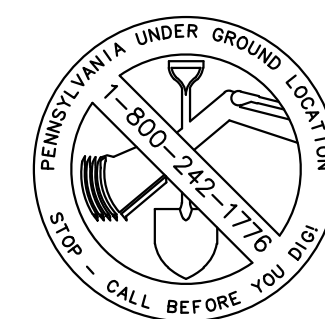

WHAT YOU DON'T KNOW CAN HURT YOU.

CALL BEFORE YOU DIG!
PENNSYLVANIA LAW REQUIRES 3 WORKING DAYS NOTICE FOR
CONSTRUCTION PHASE & 10 WORKING DAYS IN DESIGN STAGE

Pennsylvania One Call System, Inc.
1-800-242-1776

ACT 187

IT IS THE CONTRACTOR'S RESPONSIBILITY TO COMPLY WITH THE PENNSYLVANIA ACT 187 AND TO CONTACT THE "ONE CALL SYSTEM" THREE (3) WORKING DAYS (UNLESS OTHERWISE NOTED) PRIOR TO START OF CONSTRUCTION.

PENNSYLVANIA ONE CALL: 1-800-242-1776	
<u>PHILADELPHIA WATER DEPARTMENT</u> 1101 MARKET STREET, 2nd FLOOR PHILADELPHIA, PENNSYLVANIA (215) 685-6270	<u>VERIZON</u> 900 RACE STREET PHILADELPHIA, PENNSYLVANIA 19107 (215) 351-8947

PHILADELPHIA GAS WORKS	COMCAST
800 W. MONTGOMERY AVENUE, 3RD FLOOR	1351 S. COLUMBUS BOULEVARD
PHILADELPHIA, PENNSYLVANIA 19122	PHILADELPHIA, PENNSYLVANIA 19147
(215) 684-6796	(215) 952-4935

PECO-CONSTRUCTION DEPARTMENT
2301 MARKET STREET
PHILADELPHIA, PENNSYLVANIA 19103
(215) 731-3264

GENERAL NOTES:

1. RIGHT-OF-WAY LINES ARE PLOTTED FROM CITY PLAN INFORMATION. EXISTING SITE CONDITIONS INCLUDING BUILDINGS, CURBS, LOT LINES AND CONTOURS ARE PLOTTED FROM GIS DATA AND ALL OTHER INFORMATION PLOTTED FROM AERIAL PHOTOGRAPHY.
2. MERIDIANS AND BEARINGS ARE REFERENCED TO CITY PLAN NO. 44. LOT BEARINGS AND DISTANCES ARE SHOWN IN PHILADELPHIA DISTRICT STANDARD. ALL OTHER DIMENSIONS ARE SHOWN IN U.S. SURVEY FEET.
3. SUBJECT TO ALL RESTRICTIONS, EASEMENTS AND/OR COVENANTS OF RECORD EITHER WRITTEN OR IMPLIED THAT MAY NOT APPEAR ON THIS PLAN.
4. UNDERGROUND UTILITIES AS SHOWN ARE TAKEN FROM FIELD EVIDENCE AND PLANS AS PROVIDED BY THE VARIOUS UTILITY AUTHORITIES (PA ONE CALL SERIAL NO. 20212381820). THE ACCURACY REGARDING UTILITY LOCATION AND/OR DEPTH CANNOT BE GUARANTEED AND ADDITIONAL UNDERGROUND UTILITIES NOT DEPICTED ON THE PLAN MAY EXIST. BEFORE EXCAVATIONS ARE BEGUN, THE PENNSYLVANIA GAS CALL SYSTEM AT 1-800-242-1778 SHALL BE CONTACTED AT LEAST 3-10 DAYS PRIOR TO COMMENCEMENT OF ANY DEMOLITION OR EXCAVATION ACTIVITIES IN ACCORDANCE WITH ALL APPLICABLE LAWS, RULES AND REGULATIONS.
5. INFORMATION PERTAINING TO LOTS OTHER THAN THE SUBJECT PARCEL IS SHOWN FOR INFORMATIONAL PURPOSES ONLY.
6. SITE LIES WITHIN THE MAPPED LIMITS OF FLOOD ZONE X, AS SHOWN ON THE FEMA FLOOD INSURANCE RATE PAY COMMUNITY-PANEL NO 4207570179G, DATED 01/17/2007 FOR THE CITY OF PHILADELPHIA.
7. PROJECT SITE IS NOT LOCATED IN A SPECIAL FLOOD HAZARD ZONE AND THERE ARE NOT WETLANDS ON SITE. THERE ARE NO WATER COURSES OR BODIES OF WATER LOCATED WITHIN 100 FEET OF THE PROPERTY.

SEAL:

NAME (LICENSED PROFESSIONAL): FRANK ANTHONY FREGA
DATE: 03/28/2022
STATE AND LICENSE NO: PE041605R

CIVIL

KS ENGINEERS, P.C.
530 Walnut St, Suite 460
Philadelphia, PA 19106
Phone: (215) 925-0425
Fax: (215) 925-0430

Key Plan:

03/28/22

[illegible]

SCHOOL & LOCATION

Samuel Powel School
3501-15 POWELTON AVENUE
PHILADELPHIA PA

PROJECT TITLE

PARKING LOT RENOVATIONS

DRAWING TITLE

LANDSCAPE DETAILS

LOCATION NO.	FILE NO.
DRAWN BY KSE	CHECKED BY KSE
SDP Contract No. 2022-080-G	
DRAWING NO. C-701	