



Summary of Paint & Plaster Stabilization Activities



***Field
Services***

At:

**#7390 – Andrew Morrison Elementary School
5100 N. 3rd Street, Philadelphia, PA 19120**

For:

**Mr. Eddie Escobio
Operations Manager
School District of Philadelphia
Office of Environmental Mgmt. & Services
440 North Broad Street, 3rd Floor – Portal C
Philadelphia, PA 19130**



***Lab
Services***

Prepared By:

**Mr. Ananth K. Vinjamuri
Project Manager**

Report Date:

September 25, 2020

Project Number:

193131

Dates of Project:

December 23, 2019 – May 13, 2020



***Training
Services***

Summary of Paint and Plaster Stabilization Activities
School Name: Andrew Morrison Elementary School
Address: 5100 N. 3rd Street,
Philadelphia, PA 19120
UCLS #: 7390

TABLE OF CONTENTS

- I. Introduction**
- II. Methods Executive Summary**
 - A. Preliminary Steps**
 - i. Parent and Staff Notifications**
 - ii. Decluttering**
 - iii. Wall Hangings**
 - iv. Swing Space**
 - v. Facilities Building Cleaning Staff Training**
 - B. Pre-Cleaning**
 - C. Paint & Plaster Stabilization Procedures**
 - i. Work Practices**
 - ii. Oversight**
 - D. Cleanup & Completion**
 - i. Cleanup**
 - ii. Testing**
- III. Oversight**
 - A. Scope of Work**
 - B. EPA Checklist**
 - C. Oversight**
 - D. Sample Results**

Appendix A. Scope of Work Table

Appendix B. EPA Checklist Table

Appendix C. Oversight Table

Appendix D. Sample Results Table

Appendix E. Photographs (included in the report)

Appendix F. Environmental Firm Certification Documentation of Training

Appendix G. Paint Contractor Certifications or Documentation of Training

I. INTRODUCTION

Criterion Laboratories, Inc. (Criterion), was requested by the School District of Philadelphia's Office of Environmental Management Services (OEMS) to perform oversight and clearance testing during a paint and plaster stabilization project being performed by Buttonwood Company, Inc. at Andrew Morrison Elementary School located at 5100 N. 3rd Street, in Philadelphia, PA (the "School"). The purpose of the oversight was to document that all parts of the US Environmental Protection Agency (EPA) Lead Renovation, Repair and Painting rules were being followed and documented.

II. METHODS EXECUTIVE SUMMARY

A. Preliminary Steps

i. Parent and Staff Notifications

Parents and staff were notified of the paint and plaster project by mail several weeks prior to the commencement of the project. Additionally, prior to the start of the project, parent and staff meetings were held by OEMS, Maintenance, and Operations to explain the process of the paint and plaster projects and to field any questions or concerns.

ii. Decluttering

Classrooms, closets and other storage areas were decluttered prior to the commencement of stabilization work. Coordination of the decluttering activities was made between teachers and facilities staff to ensure that outdated and unneeded academic materials were discarded, and that resources were provided to assist in the decluttering tasks such as support staff for heavy lifting and/or moving large furniture and additional recycling dumpsters.

iii. Wall Hangings

Posters, bulletin boards, framed art and other wall hangings were removed prior to the commencement of the paint stabilization project. This was coordinated with teachers by the Operations Division at the kick-off meeting, and during the phasing of the project, with the help of the Principal.

iv. Swing Space

Swing space was identified prior to the commencement of stabilization work to ensure that classrooms were available during the school year. A plan was created on a school-by-school basis to relocate students and teachers from classrooms during the course of this work. All work areas were scheduled for cleaning by facilities staff after the paint stabilization work was completed by Maintenance Painting Staff.

v. Facilities Building Cleaning Staff Training

Facilities Building Cleaning Staff were provided with information about this project and expectations for post-cleaning, including use of wet-wipes and HEPA vacuums.

B. Pre-Cleaning

On an as-needed basis, for areas such as cluttered storage closets, that required extensive movement of materials, HEPA vacuuming and wet-wiping prior to paint and plaster stabilization, the Maintenance Environmental staff performed a pre-cleaning in advance of stabilization work. The intent of this task was to provide a clean work area prior to decluttering and stabilization.

Additionally, post-cleaning was conducted by facilities staff after paint and plaster stabilization was completed. This included the HEPA vacuuming and wet-wiping of all horizontal surfaces and polishing floors.

C. Paint & Plaster Stabilization Procedures

Paint and plaster stabilization work complied with the EPA's Lead RRP rule. All staff conducting this work were trained and/or certified as Lead RRP workers.

The following procedures were followed:

i. Work Practices

- Isolate work areas to restrict dust from impacting adjacent areas.
- Post signs/notifications as per EPA Lead RRP.
- Place “walk-off” pads at all access points into/out of work area.
- Seal all openings [windows, doors, and HVAC system registers/grilles] inside work areas as per direction from on-site environmental monitors and consistent with the EPA Lead RRP rules & guidelines.
- Workers are to wear disposable clothing and foot coverings while inside work areas and will not leave work areas wearing disposable clothing.
- Move/cover all remaining objects in work area to protect them. Including all open bins, shelves and boxes in the classroom.
- Employ/Erect “portable” dust containment barrier systems to limit the size of work areas requiring post-cleaning and limit testing and exposure.
- Place plastic floor coverings to extend at least 6 feet out from vertical surfaces being stabilized unless utilizing vertical barriers/containment systems.
- Perform all paint stabilization work in compliance with the EPA Lead RRP rules & guidelines and as per the directions of on-site environmental monitors to minimize dust contamination.
- Take all steps necessary to ensure that no dust or debris leaves the work area while the work is being performed.
- Use precautions to ensure that all employees, tools, and other items, including the exteriors of waste containers, are free of dust and debris before leaving the work area.

- Collect all paint chips & debris, fold up plastic floor coverings and any other plastic sheeting used on horizontal surfaces, without dispersing dust or debris and dispose of the material in heavy duty plastic waste bags.
- Do not use power tools.
- Do not use dry sweeping with brooms.
- Do use water/misting during stabilization to minimize dust.
- Do use HEPA vacuums and wet wiping/cleaning techniques.

ii. Oversight

The environmental technician will oversee paint and plaster stabilization work to ensure compliance with lead safe work practices. An oversight report will be completed at the end of every shift to record the work areas that were stabilized. The following tasks will be verified and recorded:

- Pre-cleaning
- Contents moved
- Work area prepped
- Surfaces stabilized
- Contents back in place
- Final inspection approval and photos

D. Cleanup & Completion

The following clean-up and completion procedures were performed for each work area following the completion of stabilization work:

i. Cleanup

- There should be no signs of loose, peeling, flaking, bubbling or crumbling paint or plaster visible on walls or ceilings or on any other painted surfaces.
- There should be no visible signs of paint chips, debris or dust of any kind on surfaces within “contained” and isolated work areas NOR outside of the contained and isolated work areas.
- Window sills, floors, baseboards, shelving units, tops of cabinets, desks, chairs, tables and all other horizontal surfaces must be free of any visible signs of paint and plaster dust and/or debris.
- There must be absolutely no visible signs of paint chips, and/or paint/plaster dust or debris on academic/educational materials, including books, bins, toys, desks, chairs, carpets, papers, etc., after each work shift and to allow for re-occupancy the next day,
- Any remaining paint and plaster must be tightly adhered to wall and ceiling surfaces such that it cannot be further damaged, pried off or disturbed by “simple fingernail pressure” otherwise work will not be considered to be successfully completed.
- Newly painted surfaces should match the aesthetics of the area in total and should cover the entirety of the wall or ceiling area that was addressed through this work. No visible “patches” of paint should be observed.

ii. Testing

The District and the PFT's Environmental Consultant worked closely to develop an agreed upon approach to verify that stabilization work was performed in accordance with lead safe work practices, and that classrooms would be safe for re-occupancy by children and staff. This approach exceeds the EPA Lead RRP rule requirements in terms of the types of, and amounts of, testing performed. Testing will take place in work areas. The areas will be cleaned by general cleaners after the stabilization work is completed and the clearance testing is performed.

Qualitative testing methods, i.e., EPA RRP verification wipe testing and colorimetric wipe testing, will be compared with the quantitative testing method of Atomic Absorption Spectrophotometry (AAS) as indicated in the testing protocol below. If the comparison testing is consistently correlated, only qualitative testing will continue for the duration of the project.

a. Testing Protocol

Step 1 -- EPA RRP Verification Wipes and Colorimetric Wipes

The environmental consultant and painter foreman will coordinate the EPA RRP Verification Test Wipe in rooms/areas that have been stabilized and cleaned, and where plastic work area coverings have been removed and visual inspection conducted. After EPA RRP verification wipes pass the cleanliness standard for any surface and/or a 40 square feet (SF) section, the colorimetric testing will be conducted by the environmental consultant.

The colorimetric wipe tests will occur in "child-occupied areas" on approximately 10% of surfaces considered "clean" following the use of the verification wipes. These surfaces may include floors, window sills, or the tops of any other immovable objects that were covered and cleaned in each work area (e.g. CUVs, immovable bookshelves). Additional colorimetric wipes may be collected on surfaces that had been moved and covered and placed outside of the work area. These surfaces may include desks, chairs, bookshelves, etc.

"Child-occupied areas" will include: classrooms, restrooms, cafeterias, gymnasiums, and auditoriums that are routinely used by children in PK-1st grade classrooms. Common areas that children in PK-1st grade classrooms only pass through, such as hallways, stairways, and garages are not included. "Child-occupied areas" will be identified by the Principal of each school.

Step 2 -- Response to Failed Tests

If colorimetric testing "fails," then the 40 SF area will be re-wiped by EPA RRP Wipes. The process will continue until both testing methods confirm a "pass."

Step 3 -- Flame Atomic Absorption Spectrophotometry (FAAS)

Flame Atomic Absorption Spectrophotometry (FAAS) will be used to verify and confirm the results of the colorimetric testing. FAAS will be used as a quality assurance/quality control for the colorimetric samples. Approximately 10% of the colorimetric samples should be submitted for FAAS analysis.

Step 4 -- Release Spaces Back to School/Operations

If EPA RRP wipes and colorimetric wipes are both acceptable, as determined on site, and if work was completed in accordance with this procedure, the room will be turned over to the District's Operations team for "deep cleaning" and for re-occupancy.

Step 5 — Ongoing Review

All sampling and testing data, information and results will be readily available and accessible for review by school staff, parents and members of the Oversight Advisory Committee and will be reviewed on a regular basis. Any suggested modifications, changes or other revisions will be considered by the School District of Philadelphia.

The three testing methods were conducted as follows:

Type of Clearance Tests	Building Component	Number of Sample Locations within Work Area	Type of Testing	Testing Specifications/Limitations
EPA RRP Cleaning Verification Wipe	Floors, Countertops, Desks, Tables, Window Sills	One (1) wipe every 40 square feet (ft ²) or entire surface of component if surface area is less than 40ft ² One (1) wipe for every window sill	Qualitative	<ul style="list-style-type: none">• Qualitative testing based on cleanliness (white glove test)• According to RRP, the areas pass after the 3rd cleaning, regardless of verification

Colorimetric Wipe SKC, Inc. Full Disclosure® Instant Wipes	Floors, Countertops, Desks, Tables, Window Sills, Etc.	10% of surfaces considered “clean” following the use of EPA RRP Cleaning Verification Wipes	Qualitative	<ul style="list-style-type: none"> • Qualitative testing based on colorimetric visual comparison • Lower Limit of Visual Detection is 18µg of lead • False positive and false negative interferences from silver, cadmium, barium, mercury, and titanium (percentages unknown) • Involves field preparation of sampling media using reagents
Flame Atomic Absorption Spectrophotometry (AAS)	Analyze Colorimetric Wipes from locations listed above	A minimum of one and a maximum of 10% of colorimetric wipes will also be subjected to laboratory analysis by FAAS for verification. This testing method will be used on a periodic basis to validate the accuracy of qualitative methods above.	Quantitative	<ul style="list-style-type: none"> • Interior Floors and Desks: < 10 µg/ft² This is based upon a District and PFT agreement. This is half the current HUD and EPA standard. This is tied to the detection level for the colorimetric wipe which is 18µg per wipe. • Window Sills: < 100 µg/ft² per HUD

III. OVERSIGHT

A. Scope of Work

A scope of work was developed for Andrew Morrison Elementary School following a room-by-room inspection of the school. During the inspection, the location and quantity of damaged paint and plaster, along with any associated debris and whether the damage was the result of an on-going moisture intrusion, were noted. The Assessment Scope of Work was limited to the Interior, below the suspended ceiling/enclosed ceiling, and Student/Teacher occupied areas only. This information was entered into a scope of work spreadsheet, which was provided to the School District Painting Department in order to create a schedule for the work to be completed.

The scope of work for Andrew Morrison Elementary School is included in the Appendix A of this report.

B. EPA Checklist

Throughout the paint and plaster stabilization project, Criterion's on-site inspector observed, documented, and signed-off on tasks required by the EPA RRP. Additional notes were added to the EPA Checklist to document different oversight tasks that took place. These included documenting that warning signs were posted at the entrance to the work area, that the work area had been contained to prevent the spread of dust and debris, that all objects in the work area had been removed or covered, that all HVAC ducts in the work area were closed and covered, that windows in the work area were closed, that doors in the work area were closed and sealed, that doors that must be used in the work area were covered to allow passage but prevent the spread of dust, that floors in the work area were covered with taped-down plastic, that waste was being contained while on-site and while being transported, that the work site was properly cleaned after the renovations, that all paint chips and debris were picked up and that the protective sheeting was misted, folded dirty-side inward, and taped for removal, that the work area surfaces and objects were cleaned using HEPA vacuums and/or wet-wiping or mopping, that a certified renovator performed the post-renovation cleaning verification, a description of the post-renovation cleaning verification, including the number of wet and dry cloths used, and if the dust clearance testing was performed.

The EPA Checklist for Andrew Morrison Elementary School is included in the Appendix B of this report.

C. Oversight

Throughout the paint and plaster stabilization project, Criterion's on-site inspector documented the day-to-day tasks performed for each work area. These tasks included

the dates of pre-cleaning, the moving of the contents of the room, the prepping of the work area, the stabilization of the painted surfaces, and the final inspection.

The Oversight Table for Andrew Morrison Elementary School is included in the Appendix C of this report.

D. Sample Results

Throughout the paint and plaster stabilization project, Criterion's on-site inspector documented all sampling results for each work area location. This included all RRP verification wipes, colorimetric wipes, and wipes to be submitted for Flame AAS analysis.

The Sample Results Table for Andrew Morrison Elementary School is included in the Appendix D of this report.

Appendix A. Scope of Work Table

Andrew Morrison ES
Scope of Work

<i>Task ID</i>	<i>ULCS#</i>	<i>E l e m e n t</i>	<i>F l o o r</i>	<i>Space # (on Floor Plan)</i>	<i>Space Type</i>	<i>On Site Room Name</i>	<i>Student/ Teacher Occupied</i>	<i>Primary Component</i>	<i>Description of Paint and Plaster Damage - Primary Component</i>	<i>Primary Component Damage Quantity (sf)</i>	<i>Primary Component XRF (positive/ negative)</i>	<i>Additional Component (see terms)</i>	<i>Description of Paint and Plaster Damage - Additional Component</i>	<i>Additoinal Component Damage Quantity (sf)</i>	<i>Additional Component XRF (positive/ negative)</i>	<i>Comments</i>
1	7390	1	1	101B	Student Restrooms - Female (4-12)	Girl's Restroom next to Classroom 102	yes	Ceiling	Cracking	1	Positive	N/A	N/A	N/A	N/A	
2	7390	1	1	102	Primary	Classroom 102	yes	W1	Damaged Plaster	1	Positive	N/A	N/A	N/A	N/A	Exposed due to removal of the dispenser from the wall
3	7390	1	1	102	Primary	Classroom 102	yes	W2	Cracking	5	Positive	N/A	N/A	N/A	N/A	
4	7390	1	1	102	Primary	Classroom 102	yes	W4	N/A	N/A	N/A	Columns	Cracking	3	Positive	Ceiling Tile
5	7390	1	1	102A	Storage	Classroom 102 Storage	yes	W2	Cracking	2	Positive	N/A	N/A	N/A	N/A	
6	7390	1	1	102A	Storage	Classroom 102 Storage	yes	W4	Cracking	2	Positive	N/A	N/A	N/A	N/A	
7	7390	1	1	103	Primary	Classroom 103	yes	W1	Cracking	6	Positive	N/A	N/A	N/A	N/A	
8	7390	1	1	103	Primary	Classroom 103	yes	W3	Cracking	2	Positive	N/A	N/A	N/A	N/A	
9	7390	1	1	103	Primary	Classroom 103	yes	W3	N/A	N/A	N/A	Columns	Cracking	3	Positive	
10	7390	1	1	103	Primary	Classroom 103	yes	Ceiling	Flaking	1	Positive	N/A	N/A	N/A	N/A	At window
11	7390	1	1	103AA	Storage	Classroom 103 Storage Foyer	yes	W3	Cracking	3	Positive	N/A	N/A	N/A	N/A	Behind movable cabinet
12	7390	1	1	104	Primary	Classroom 104	yes	W1	Cracking, Flaking	10	Positive	N/A	N/A	N/A	N/A	
13	7390	1	1	104	Primary	Classroom 104	yes	W2	Cracking, Flaking	25	Positive	N/A	N/A	N/A	N/A	
14	7390	1	1	104	Primary	Classroom 104	yes	W3	Cracking, Flaking	4	Positive	N/A	N/A	N/A	N/A	
15	7390	1	1	104	Primary	Classroom 104	yes	W3	N/A	N/A	N/A	Columns	Flaking	4	Positive	
16	7390	1	1	104	Primary	Classroom 104	yes	Ceiling	Flaking	1	Positive	N/A	N/A	N/A	N/A	At window
17	7390	1	1	104A	Storage	Classroom 104 Storage	yes	W3	Partially Inaccessible/Cracking	2	Positive	N/A	N/A	N/A	N/A	Partially Inaccessible
18	7390	1	1	105	General Administrative	Main Office	yes	W1	Chipping	1	Positive	N/A	N/A	N/A	N/A	
19	7390	1	1	105	General Administrative	Main Office	yes	W4	Flaking	6	Positive	N/A	N/A	N/A	N/A	Near the door
20	7390	1	1	105	General Administrative	Main Office	yes	Ceiling	Efflorescence, Flaking	4	Positive	N/A	N/A	N/A	N/A	At the window
21	7390	1	1	105A	Principal/Directors Office	Principal's Office	yes	W1	Cracking	4	Positive	N/A	N/A	N/A	N/A	
22	7390	1	1	105A	Principal/Directors Office	Principal's Office	yes	W3	Cracking	1	Positive	N/A	N/A	N/A	N/A	
23	7390	1	1	105C	Storage	Stationery Closet in Main Office	yes	W1	Cracking/Damaged Plaster	6	Positive	N/A	N/A	N/A	N/A	
24	7390	1	1	106/106A	Teacher Lounge/Dining	Teacher's Lounge	yes	W2	Cracking	2	Positive	N/A	N/A	N/A	N/A	Near the refrigerator
25	7390	1	1	106/106A	Teacher Lounge/Dining	Teacher's Lounge	yes	W3	N/A	N/A	N/A	Columns	Cracking	5	Positive	
26	7390	1	1	106/106A	Teacher Lounge/Dining	Teacher's Lounge	yes	W3	N/A	N/A	N/A	Radiator	Chipping	6	Positive	
27	7390	1	1	107	Primary	Classroom 107	yes	W1	Flaking	3	Positive	N/A	N/A	N/A	N/A	
28	7390	1	1	107	Primary	Classroom 107	yes	W2	Cracking	3	Positive	N/A	N/A	N/A	N/A	
29	7390	1	1	107	Primary	Classroom 107 Coat Room	yes	W2	N/A	N/A	N/A	Columns	Flaking	3	Positive	
30	7390	1	1	107	Primary	Classroom 107	yes	W3	Flaking	32	Positive	N/A	N/A	N/A	N/A	
31	7390	1	1	107	Primary	Classroom 107	yes	W4	flaking	10	Positive	N/A	N/A	N/A	N/A	
32	7390	1	1	107	Primary	Classroom 107	yes	Ceiling	Cracking, Efflorescence	20	Positive	N/A	N/A	N/A	N/A	At the windows
33	7390	1	1	107B	Storage	Classroom 107 Coat Room	yes	W1	Cracking, Damaged Plaster	2	Positive	N/A	N/A	N/A	N/A	
34	7390	1	1	107B	Storage	Classroom 107 Coat Room	yes	W2	Cracking	8	Positive	N/A	N/A	N/A	N/A	

Andrew Morrison ES
Scope of Work

<i>Task ID</i>	<i>ULCS#</i>	<i>E l e m e n t</i>	<i>F l o o r</i>	<i>Space # (on Floor Plan)</i>	<i>Space Type</i>	<i>On Site Room Name</i>	<i>Student/ Teacher Occupied</i>	<i>Primary Component</i>	<i>Description of Paint and Plaster Damage - Primary Component</i>	<i>Primary Component Damage Quantity (sf)</i>	<i>Primary Component XRF (positive/ negative)</i>	<i>Additional Component (see terms)</i>	<i>Description of Paint and Plaster Damage - Additional Component</i>	<i>Additoinal Component Damage Quantity (sf)</i>	<i>Additional Component XRF (positive/ negative)</i>	<i>Comments</i>
35	7390	1	1	107A	Student Restrooms - Male (4-12)	Boy's Restroom next to Classroom 107	yes	Ceiling	Flaking	4	Positive	N/A	N/A	N/A	N/A	
36	7390	1	1	108	Primary	Classroom 108	yes	W1	Flaking	3	Positive	N/A	N/A	N/A	N/A	By the door
37	7390	1	1	108	Primary	Classroom 108	yes	W2	Flaking	2	Positive	N/A	N/A	N/A	N/A	By the door
38	7390	1	1	108	Primary	Classroom 108	yes	W3	Cracking	20	Positive	N/A	N/A	N/A	N/A	Below the windows
39	7390	1	1	108A	Storage	Classroom 108 Storage	yes	W3	Efflorescence	20	Positive	N/A	N/A	N/A	N/A	2 SF is visible near the left corner at the ceiling, the remaining damage is concealed with a curtain set up. All the items are stored in front of the curtain and thus avoiding impact from the damage on the wall. All the items should be checked before removing from the
40	7390	1	1	109A	Auditorium	Auditorium	yes	W1	Cracking, flaking	20	Positive	N/A	N/A	N/A	N/A	
41	7390	1	1	109A	Auditorium	Auditorium	yes	W3	Crack in Plaster	4	Positive	N/A	N/A	N/A	N/A	
42	7390	1	1	109A	Auditorium	Auditorium	yes	W4	Cracking	25	Positive	N/A	N/A	N/A	N/A	Spread out
43	7390	1	1	109A	Auditorium	Auditorium	yes	Ceiling	Flaking, Cracking	10	Positive	N/A	N/A	N/A	N/A	Too high to be able to test
44	7390	1	1	109S	Stage	Stage	yes	W2	Crack in Plaster, Hole in Plaster	4	Positive	N/A	N/A	N/A	N/A	
45	7390	1	1	109S	Stage	Stage	yes	W2	N/A	N/A	N/A	Radiator	Chipping	3	Positive	
46	7390	1	1	109S	Stage	Stage	yes	W3	Cracking	20	Positive	N/A	N/A	N/A	N/A	
47	7390	1	1	109S	Stage	Stage	yes	W4	N/A	N/A	N/A	Radiator	Chipping	5	Positive	
48	7390	1	1	110	Storage	Storage to the right of Stage	yes	W1	Flaking	5	Positive	N/A	N/A	N/A	N/A	
49	7390	1	1	110	Storage	Storage to the right of Stage	yes	W2	Flaking	4	Positive	N/A	N/A	N/A	N/A	
50	7390	1	1	110	Storage	Storage to the right of Stage	yes	W3	Flaking	2	Positive	N/A	N/A	N/A	N/A	
51	7390	1	1	111	Administrative Office	Philadelphia Police Office	yes	W3	N/A	N/A	N/A	Radiator	Chipping	12	Positive	
52	7390	1	1	112	Circulation (Hallway)	Walkway behind Stage leading to Philadelphia Police Office	yes	W2	Cracking	3	Positive	N/A	N/A	N/A	N/A	
53	7390	1	1	112	Circulation (Hallway)	Walkway behind Stage leading to Philadelphia Police Office	yes	W4	Cracking	5	Positive	N/A	N/A	N/A	N/A	
54	7390	1	1	112	Circulation (Hallway)	Walkway behind Stage leading to Philadelphia Police Office	yes	W4	N/A	N/A	N/A	Radiator	Chipping	10	Positive	
55	7390	1	1	114A	Storage	Left side Electrical Equipment/Storage in the Main Hallway across from Main Office	no	W1	Cracking	1	Positive	N/A	N/A	N/A	N/A	
56	7390	1	1	114A	Storage	Left side Electrical Equipment/Storage in the Main Hallway across from Main Office	no	W2	Flaking	3	Positive	N/A	N/A	N/A	N/A	
57	7390	1	1	114B	Storage	Right side Electrical Equipment/Storage in the Main Hallway across from Main Office	no	W1	Cracking	2	Positive	N/A	N/A	N/A	N/A	
58	7390	1	1	114B	Storage	Right side Electrical Equipment/Storage in the Main Hallway across from Main Office	no	W3	Crack in Plaster	3	Positive	N/A	N/A	N/A	N/A	
59	7390	1	1	114B	Storage	Right side Electrical Equipment/Storage in the Main Hallway across from Main Office	no	W4	Holes in Plaster	3	Positive	N/A	N/A	N/A	N/A	
60	7390	1	1	115	Storage	Storage in the Main Hallway across from Classroom 104	yes	W3	Partially Inaccessible/Cracking	6	Positive	N/A	N/A	N/A	N/A	Partially Inaccessible
61	7390	1	1	115	Storage	Storage in the Main Hallway across from Classroom 104	yes	W4	Flaking	3	Positive	N/A	N/A	N/A	N/A	
62	7390	1	1	115A	Storage	Stationery Closet next to Stairwell across from Classroom 103	yes	W4	Damaged Plaster	3	Positive	N/A	N/A	N/A	N/A	
63	7390	1	1	H11	Circulation (Hallway)	Main Hallway at Classrooms 102 to 107	yes	W1	Flaking	7	Positive	N/A	N/A	N/A	N/A	Spread out
64	7390	1	1	H11	Circulation (Hallway)	Main Hallway at Classrooms 102 to 107	yes	W1	Flaking	4	Positive	N/A	N/A	N/A	N/A	At the Archway above sink
65	7390	1	1	H11	Circulation (Hallway)	Main Hallway at Classrooms 102 to 107	yes	W2	Flaking	2	Positive	N/A	N/A	N/A	N/A	Outside Girls Restroom

Andrew Morrison ES
Scope of Work

<i>Task ID</i>	<i>ULCS#</i>	<i>E l e m e n t</i>	<i>F l o o r</i>	<i>Space # (on Floor Plan)</i>	<i>Space Type</i>	<i>On Site Room Name</i>	<i>Student/ Teacher Occupied</i>	<i>Primary Component</i>	<i>Description of Paint and Plaster Damage - Primary Component</i>	<i>Primary Component Damage Quantity (sf)</i>	<i>Primary Component XRF (positive/ negative)</i>	<i>Additional Component (see terms)</i>	<i>Description of Paint and Plaster Damage - Additional Component</i>	<i>Additoinal Component Damage Quantity (sf)</i>	<i>Additional Component XRF (positive/ negative)</i>	<i>Comments</i>
66	7390	1	1	H11	Circulation (Hallway)	Main Hallway at Classrooms 102 to 107	yes	W3	N/A	N/A	N/A	Columns	Flaking, Damaged Plaster	3	Positive	
67	7390	1	1	H11	Circulation (Hallway)	Main Hallway at Classrooms 102 to 107	yes	Ceiling	Flaking	4	Positive	N/A	N/A	N/A	N/A	At the Archway above sink
68	7390	1	1	H12	Circulation (Hallway)	Hallway in front of Classroom 108	yes	W2	Chipping	1	Positive	N/A	N/A	N/A	N/A	Left side of Stairwell B Doors
69	7390	1	1	H13	Circulation (Hallway)	Hallway in front of Nurse's Office	yes	W4	Cracking	5	Positive	N/A	N/A	N/A	N/A	
70	7390	1	1	S11	Stairs	Stairwell on Girls Restroom side	yes	W1	Scratched	3	Positive	N/A	N/A	N/A	N/A	
71	7390	1	1	S11	Stairs	Stairwell on Girls Restroom side	yes	Floor	N/A	N/A	N/A	Stair riser	Chipping, Contact	4	Positive	At middle landing
72	7390	1	1	S11	Stairs	Stairwell on Girls Restroom side	yes	Floor	N/A	N/A	N/A	Newel posts	Chipping, Contact	4	Positive	At middle landing
73	7390	1	1	S11-EF	Circulation (Hallway)	Exit Foyer in Middle Landing at Stairwell on Girls Restroom side	yes	W2	N/A	N/A	N/A	Baseboard	Chipping	3	Positive	At middle landing
74	7390	1	1	S11-EF	Circulation (Hallway)	Exit Foyer in Middle Landing at Stairwell on Girls Restroom side	yes	W4	Cracking	2	Positive	N/A	N/A	N/A	N/A	
75	7390	1	1	S11-EF	Circulation (Hallway)	Exit Foyer in Middle Landing at Stairwell on Girls Restroom side	yes	W4	Cracking	2	Positive	N/A	N/A	N/A	N/A	
76	7390	1	1	S12	Stairs	Stairwell across from Classroom 108	yes	W1	Chipping	3	Positive	N/A	N/A	N/A	N/A	
77	7390	1	1	S12	Stairs	Stairwell across from Classroom 108	yes	Floor	N/A	N/A	N/A	Stair riser	Chipping, Contact	3	Positive	At middle landing
78	7390	1	1	S12	Stairs	Stairwell across from Classroom 108	yes	Floor	N/A	N/A	N/A	Newel posts	Chipping, Contact	3	Positive	At middle landing
79	7390	1	1	S12-EF	Circulation (Hallway)	Exit Foyer in Middle Landing at Stairwell across from Classroom 108	yes	W2	N/A	N/A	N/A	Baseboard	Chipping	3	Positive	At middle landing
80	7390	1	1	S12-EF	Circulation (Hallway)	Exit Foyer in Middle Landing at Stairwell across from Classroom 108	yes	W4	N/A	N/A	N/A	Baseboard	Chipping	5	Positive	At middle landing
81	7390	1	1	S3	Stairs	Fire Tower near Classroom 108 at Element #2	yes	W1	Cracking, Efflorescence	20	Positive	N/A	N/A	N/A	N/A	
82	7390	1	1	S3	Stairs	Fire Tower near Classroom 108 at Element #2	yes	W2	Cracking	10	Positive	N/A	N/A	N/A	N/A	
83	7390	1	1	S3	Stairs	Fire Tower near Classroom 108 at Element #2	yes	W3	Cracking, Efflorescence	40	Positive	N/A	N/A	N/A	N/A	
84	7390	1	1	S3	Stairs	Fire Tower near Classroom 108 at Element #2	yes	W3	N/A	N/A	N/A	Pipe	Flaking	12	Positive	
85	7390	1	1	S3	Stairs	Fire Tower near Classroom 108 at Element #2	yes	W4	Cracking, Efflorescence	20	Positive	N/A	N/A	N/A	N/A	
86	7390	1	2	201	Primary	Classroom 201	yes	W1	Cracking	7	Positive	N/A	N/A	N/A	N/A	
87	7390	1	2	201	Primary	Classroom 201	yes	W2	Flaking, Damaged Plaster	8	Positive	N/A	N/A	N/A	N/A	
88	7390	1	2	201	Primary	Classroom 201	yes	W3	Cracking	2	Positive	N/A	N/A	N/A	N/A	
89	7390	1	2	201	Primary	Classroom 201	yes	W3	N/A	N/A	N/A	Columns	Chipping	2	Positive	
90	7390	1	2	201	Primary	Classroom 201	yes	W4	Cracking	3	Positive	N/A	N/A	N/A	N/A	
91	7390	1	2	201A	Administrative Office	Office 201A next to Classroom 201	yes	W2	Cracking	8	Positive	N/A	N/A	N/A	N/A	Spread out
92	7390	1	2	201A	Administrative Office	Office 201A next to Classroom 201	yes	W3	Cracking	3	Positive	N/A	N/A	N/A	N/A	
93	7390	1	2	201A	Administrative Office	Office 201A next to Classroom 201	yes	W4	Cracking	2	Positive	N/A	N/A	N/A	N/A	
94	7390	1	2	201A	Administrative Office	Office 201A next to Classroom 201	yes	Ceiling	Efflorescence, Flaking	4	Positive	N/A	N/A	N/A	N/A	At the window
95	7390	1	2	202	Primary	Classroom 202	yes	W1	Cracking, Damaged Plaster	12	Positive	N/A	N/A	N/A	N/A	
96	7390	1	2	202	Primary	Classroom 202	yes	W2	Cracking	10	Positive	N/A	N/A	N/A	N/A	
97	7390	1	2	202	Primary	Classroom 202	yes	W3	Cracking	4	Positive	N/A	N/A	N/A	N/A	
98	7390	1	2	202	Primary	Classroom 202	yes	W4	Cracking	3	Positive	N/A	N/A	N/A	N/A	
99	7390	1	2	202	Primary	Classroom 202	yes	Ceiling	Flaking	2	Positive	N/A	N/A	N/A	N/A	At the window

Andrew Morrison ES
Scope of Work

<i>Task ID</i>	<i>ULCS#</i>	<i>E l e m e n t</i>	<i>F l o o r</i>	<i>Space # (on Floor Plan)</i>	<i>Space Type</i>	<i>On Site Room Name</i>	<i>Student/ Teacher Occupied</i>	<i>Primary Component</i>	<i>Description of Paint and Plaster Damage - Primary Component</i>	<i>Primary Component Damage Quantity (sf)</i>	<i>Primary Component XRF (positive/ negative)</i>	<i>Additional Component (see terms)</i>	<i>Description of Paint and Plaster Damage - Additional Component</i>	<i>Additoinal Component Damage Quantity (sf)</i>	<i>Additional Component XRF (positive/ negative)</i>	<i>Comments</i>
100	7390	1	2	203	Primary	Classroom 203	yes	W1	Cracking	1	Positive	N/A	N/A	N/A	N/A	
101	7390	1	2	203	Primary	Classroom 203	yes	W2	Cracking	1	Positive	N/A	N/A	N/A	N/A	
102	7390	1	2	203	Primary	Classroom 203	yes	W3	Cracking	4	Positive	N/A	N/A	N/A	N/A	
103	7390	1	2	203	Primary	Classroom 203	yes	W3	N/A	N/A	N/A	Columns	Cracking, Damaged Plaster	10	Positive	
104	7390	1	2	203	Primary	Classroom 203	yes	Ceiling	Efflorescence	1	Positive	N/A	N/A	N/A	N/A	
105	7390	1	2	204	Primary	Classroom 204	yes	W1	Cracking	10	Positive	N/A	N/A	N/A	N/A	
106	7390	1	2	204	Primary	Classroom 204	yes	W2	Cracking, Damaged Plaster	5	Positive	N/A	N/A	N/A	N/A	
107	7390	1	2	204	Primary	Classroom 204	yes	W3	N/A	N/A	N/A	Columns	Chipping, Cracking	4	Positive	
108	7390	1	2	204	Primary	Classroom 204	yes	W4	Cracking	3	Positive	N/A	N/A	N/A	N/A	
109	7390	1	2	204	Primary	Classroom 204	yes	Ceiling	Flaking	1	Positive	N/A	N/A	N/A	N/A	There is a PFI near this damage
110	7390	1	2	204A	Administrative Office	Office 204A	yes	W1	Cracking	3	Positive	N/A	N/A	N/A	N/A	
111	7390	1	2	204A	Administrative Office	Office 204A	yes	W2	Cracking	2	Positive	N/A	N/A	N/A	N/A	
112	7390	1	2	204A	Administrative Office	Office 204A	yes	W3	Cracking	2	Positive	N/A	N/A	N/A	N/A	
113	7390	1	2	204A	Administrative Office	Office 204A	yes	W4	Cracking	2	Positive	N/A	N/A	N/A	N/A	
114	7390	1	2	204B	Staff Restroom	Restroom in Office 204A	yes	W2	N/A	N/A	N/A	Baseboard	Cracking	4	Positive	
115	7390	1	2	204B	Staff Restroom	Restroom in Office 204A	yes	W3	Cracking	2	Positive	N/A	N/A	N/A	N/A	
116	7390	1	2	205	Primary	Classroom 205	yes	W1	Cracking, Chipping, Damaged Plaster	12	Positive	N/A	N/A	N/A	N/A	
117	7390	1	2	205	Primary	Classroom 205	yes	W2	Cracking	3	Positive	N/A	N/A	N/A	N/A	
118	7390	1	2	205	Primary	Classroom 205	yes	W3	Cracking	2	Positive	N/A	N/A	N/A	N/A	
119	7390	1	2	205	Primary	Classroom 205	yes	W4	Cracking	4	Positive	N/A	N/A	N/A	N/A	
120	7390	1	2	205A	Storage	Classroom 205 Storage	yes	W1	Partially Inaccessible/Cra cking	2	Positive	N/A	N/A	N/A	N/A	Partially Inaccessible
121	7390	1	2	205A	Storage	Classroom 205 Storage	yes	W3	Partially Inaccessible/Cra cking	3	Positive	N/A	N/A	N/A	N/A	Partially Inaccessible
122	7390	1	2	205A	Storage	Classroom 205 Storage	yes	W4	Partially Inaccessible/Effl orescence	3	Positive	N/A	N/A	N/A	N/A	Partially Inaccessible
123	7390	1	2	206	Primary	Classroom 206	yes	W1	Flaking, Damaged Plaster	5	Positive	N/A	N/A	N/A	N/A	
124	7390	1	2	206	Primary	Classroom 206	yes	W3	Flaking	3	Positive	N/A	N/A	N/A	N/A	
125	7390	1	2	206	Primary	Classroom 206	yes	Ceiling	Flaking	20	Positive	N/A	N/A	N/A	N/A	At the windows
126	7390	1	2	207	Primary	Classroom 207	yes	W1	Cracking	4	Positive	N/A	N/A	N/A	N/A	
127	7390	1	2	207	Primary	Classroom 207	yes	W1	N/A	N/A	N/A	Columns	Damaged Plaster	1	Positive	
128	7390	1	2	207	Primary	Classroom 207	yes	W2	Spalling, Cracking	15	Positive	N/A	N/A	N/A	N/A	
129	7390	1	2	207	Primary	Classroom 207	yes	W2	N/A	N/A	N/A	Columns	Efflorescence	2	Positive	
130	7390	1	2	207	Primary	Classroom 207	yes	W3	Cracking	2	Positive	N/A	N/A	N/A	N/A	

Andrew Morrison ES
Scope of Work

<i>Task ID</i>	<i>ULCS#</i>	<i>E l e m e n t</i>	<i>F l o o r</i>	<i>Space # (on Floor Plan)</i>	<i>Space Type</i>	<i>On Site Room Name</i>	<i>Student/ Teacher Occupied</i>	<i>Primary Component</i>	<i>Description of Paint and Plaster Damage - Primary Component</i>	<i>Primary Component Damage Quantity (sf)</i>	<i>Primary Component XRF (positive/ negative)</i>	<i>Additional Component (see terms)</i>	<i>Description of Paint and Plaster Damage - Additional Component</i>	<i>Additoinal Component Damage Quantity (sf)</i>	<i>Additional Component XRF (positive/ negative)</i>	<i>Comments</i>
131	7390	1	2	207	Primary	Classroom 207	yes	W4	Cracking	2	Positive	N/A	N/A	N/A	N/A	
132	7390	1	2	207	Primary	Classroom 207	yes	Ceiling	Efflorescence, Flaking	16	Positive	N/A	N/A	N/A	N/A	At the windows
133	7390	1	2	207A	Student Restrooms - Male (4-12)	Boy's Restroom next to Room 207	yes	W3	Flaking	6	Positive	N/A	N/A	N/A	N/A	
134	7390	1	2	207A	Student Restrooms - Male (4-12)	Boy's Restroom next to Room 207	yes	W4	Flaking	20	Positive	N/A	N/A	N/A	N/A	
135	7390	1	2	207B	Storage	Classroom 207 Storage	yes	W1	Damaged Plaster	2	Positive	N/A	N/A	N/A	N/A	Exposed due to missing coat hanger section
136	7390	1	2	208	Primary	Classroom 208	yes	W1	Cracking, Chipping	8	Positive	N/A	N/A	N/A	N/A	
137	7390	1	2	208	Primary	Classroom 208	yes	W2	Chipping	2	Positive	N/A	N/A	N/A	N/A	
138	7390	1	2	208	Primary	Classroom 208	yes	W3	Cracking	2	Positive	N/A	N/A	N/A	N/A	
139	7390	1	2	208	Primary	Classroom 208	yes	W3	N/A	N/A	N/A	Columns	Chipping, Cracking	10	Positive	
140	7390	1	2	208	Primary	Classroom 208	yes	W4	Cracking	4	Positive	N/A	N/A	N/A	N/A	
141	7390	1	2	208	Primary	Classroom 208	yes	Ceiling	Flaking	7	Positive	N/A	N/A	N/A	N/A	At the windows
142	7390	1	2	208A	Storage	Classroom 208 Storage	yes	W2	Cracking	4	Positive	N/A	N/A	N/A	N/A	
143	7390	1	2	208A	Storage	Classroom 208 Storage	yes	W3	Spalling, Cracking	8	Positive	N/A	N/A	N/A	N/A	
144	7390	1	2	208A	Storage	Classroom 208 Storage	yes	W4	Damaged Plaster	4	Positive	N/A	N/A	N/A	N/A	Along coat hanger
145	7390	1	2	211	Circulation (Hallway)	Walkway to Office 212	yes	W2	Cracking, Flaking, Damaged Plaster	25	Positive	N/A	N/A	N/A	N/A	
146	7390	1	2	211	Circulation (Hallway)	Walkway to Office 212	yes	W3	Cracking	3	Positive	N/A	N/A	N/A	N/A	
147	7390	1	2	211	Circulation (Hallway)	Walkway to Office 212	yes	W4	Cracking, Flaking, Damaged Plaster	45	Positive	N/A	N/A	N/A	N/A	
148	7390	1	2	212	Administrative Office	Office 212	yes	W1	Cracking	3	Positive	N/A	N/A	N/A	N/A	
149	7390	1	2	212	Administrative Office	Office 212	yes	W3	Cracking	1	Positive	N/A	N/A	N/A	N/A	
150	7390	1	2	212	Administrative Office	Office 212	yes	W4	Cracking	2	Positive	N/A	N/A	N/A	N/A	
151	7390	1	2	H21	Circulation (Hallway)	Main Hallway at Classrooms 202 to 207	yes	W3	N/A	N/A	N/A	Columns	Damaged Plaster	6	Positive	
152	7390	1	2	H21	Circulation (Hallway)	Main Hallway at Classrooms 202 to 207	yes	Ceiling	Flaking	6	Positive	N/A	N/A	N/A	N/A	Arch above the sink
153	7390	1	2	H23	Circulation (Hallway)	Hallway in front of Classroom 201	yes	W4	N/A	N/A	N/A	Column	Damaged Plaster	2	Positive	At Stairwell near Classroom 201
154	7390	1	2	S21	Stairs	Stairwell across from Classroom 201	yes	W1	Cracking	1	Positive	N/A	N/A	N/A	N/A	
155	7390	1	2	S21	Stairs	Stairwell across from Classroom 201	yes	W3	Cracking, contact	6	Positive	N/A	N/A	N/A	N/A	
156	7390	1	2	S3	Stairs	Fire Tower near Classroom 208 at Element #2	yes	W1	Cracking, Efflorescence	25	Positive	N/A	N/A	N/A	N/A	
157	7390	1	2	S3	Stairs	Fire Tower near Classroom 208 at Element #2	yes	W2	Cracking	10	Positive	N/A	N/A	N/A	N/A	
158	7390	1	2	S3	Stairs	Fire Tower near Classroom 208 at Element #2	yes	W3	Cracking, Efflorescence	80	Positive	N/A	N/A	N/A	N/A	
159	7390	1	2	S3	Stairs	Fire Tower near Classroom 208 at Element #2	yes	W4	Cracking, Efflorescence	50	Positive	N/A	N/A	N/A	N/A	
160	7390	1	3	301	Primary	Classroom 301	yes	W1	Cracking	2	Positive	N/A	N/A	N/A	N/A	
161	7390	1	3	301	Primary	Classroom 301	yes	W3	Flaking	8	Positive	N/A	N/A	N/A	N/A	
162	7390	1	3	301	Primary	Classroom 301	yes	W3	N/A	N/A	N/A	Columns	Cracking	6	Positive	
163	7390	1	3	301	Primary	Classroom 301	yes	W3	N/A	N/A	N/A	Radiator	Chipping	4	Positive	

Andrew Morrison ES
Scope of Work

Task ID	ULCS#	Element	Floor	Space # (on Floor Plan)	Space Type	On Site Room Name	Student/Teacher Occupied	Primary Component	Description of Paint and Plaster Damage - Primary Component	Primary Component Damage Quantity (sf)	Primary Component XRF (positive/negative)	Additional Component (see terms)	Description of Paint and Plaster Damage - Additional Component	Additoinal Component Damage Quantity (sf)	Additional Component XRF (positive/negative)	Comments
164	7390	1	3	301	Primary	Classroom 301	yes	W4	Cracking	7	Positive	N/A	N/A	N/A	N/A	
165	7390	1	3	301	Primary	Classroom 301	yes	Ceiling	Flaking	4	Positive	N/A	N/A	N/A	N/A	At the middle window.
166	7390	1	3	301A	Administrative Office	Office 301A	yes	W2	Cracking	6	Positive	N/A	N/A	N/A	N/A	
167	7390	1	3	301A	Administrative Office	Office 301A	yes	W3	Cracking	4	Positive	N/A	N/A	N/A	N/A	
168	7390	1	3	301A	Administrative Office	Office 301A	yes	W4	Cracking	10	Positive	N/A	N/A	N/A	N/A	
169	7390	1	3	301C	Student Restrooms - Female (4-12)	Girl's Restroom next to Classroom 301	yes	W2	Cracking	2	Positive	N/A	N/A	N/A	N/A	
170	7390	1	3	301C	Student Restrooms - Female (4-12)	Girl's Restroom next to Classroom 301	yes	W3	Cracking, Spalling	4	Positive	N/A	N/A	N/A	N/A	
171	7390	1	3	301D	Storage	Storage 301D	yes	W4	Cracking	2	Positive	N/A	N/A	N/A	N/A	
172	7390	1	3	302	Primary	Classroom 302	yes	W1	Flaking, Crack in plaster	4	Positive	N/A	N/A	N/A	N/A	
173	7390	1	3	302	Primary	Classroom 302	yes	W4	Cracking	3	Positive	N/A	N/A	N/A	N/A	
174	7390	1	3	303	Primary	Classroom 303	yes	W1	Cracking, Chipping	4	Positive	N/A	N/A	N/A	N/A	
175	7390	1	3	303	Primary	Classroom 303	yes	W2	Cracking, Chipping	5	Positive	N/A	N/A	N/A	N/A	
176	7390	1	3	303	Primary	Classroom 303	yes	W3	Cracking, Chipping	10	Positive	N/A	N/A	N/A	N/A	
177	7390	1	3	303	Primary	Classroom 303	yes	W3	N/A	N/A	N/A	Columns	Flaking, Cracking, Chipping	10	Positive	
178	7390	1	3	303	Primary	Classroom 303	yes	W3	N/A	N/A	N/A	Radiator	Chipping	10	Positive	
179	7390	1	3	307	Primary	Classroom 307	yes	W1	Cracking	6	Positive	N/A	N/A	N/A	N/A	
180	7390	1	3	307	Primary	Classroom 307	yes	W2	Cracking, Efflorescence	7	Positive	N/A	N/A	N/A	N/A	
181	7390	1	3	307	Primary	Classroom 307	yes	W2	N/A	N/A	N/A	Columns	Chipping	8	Positive	
182	7390	1	3	307	Primary	Classroom 307	yes	W2	N/A	N/A	N/A	Radiator	Chipping	8	Positive	
183	7390	1	3	307	Primary	Classroom 307	yes	W3	Chipping	2	Positive	N/A	N/A	N/A	N/A	
184	7390	1	3	307	Primary	Classroom 307	yes	W4	N/A	N/A	N/A	Columns	Chipping	1	Positive	Near the door
185	7390	1	3	307A	Student Restrooms - Male (4-12)	Boy's Restroom next to Classroom 307	yes	Ceiling	Efflorescence, Spalling, Damaged Plaster	20	Positive	N/A	N/A	N/A	N/A	Appears to have been repaired but the damage has reoccured
186	7390	1	3	307B	Storage	Classroom 307 Storage	yes	W1	Efflorescence	2	Positive	N/A	N/A	N/A	N/A	
187	7390	1	3	307B	Storage	Classroom 307 Storage	yes	W2	Spalling, Cracking	12	Positive	N/A	N/A	N/A	N/A	
188	7390	1	3	307B	Storage	Classroom 307 Storage	yes	Ceiling	Cracking, Damaged Plaster	4	Positive	N/A	N/A	N/A	N/A	
189	7390	1	3	308/308A	Primary	Classroom 308	yes	W1	Cracking, Chipping	7	Positive	N/A	N/A	N/A	N/A	
190	7390	1	3	308/308A	Primary	Classroom 308	yes	W2	Cracking	5	Positive	N/A	N/A	N/A	N/A	Near the door and radiator
191	7390	1	3	308/308A	Primary	Classroom 308	yes	W2	N/A	N/A	N/A	Radiator	Chipping	5	Positive	
192	7390	1	3	308/308A	Primary	Classroom 308	yes	W3	Cracking, Chipping	10	Positive	N/A	N/A	N/A	N/A	
193	7390	1	3	308/308A	Primary	Classroom 308	yes	W3	N/A	N/A	N/A	Radiator	Chipping	6	Positive	
194	7390	1	3	308/308A	Primary	Classroom 308	yes	W3	N/A	N/A	N/A	Pipe	Chipping	4	Positive	
195	7390	1	3	308/308A	Primary	Classroom 308	yes	W3	N/A	N/A	N/A	Columns	Chipping, Damaged	8	Positive	
196	7390	1	3	308/308A	Primary	Classroom 308	yes	W4	Cracking	2	Positive	N/A	N/A	N/A	N/A	

Andrew Morrison ES
Scope of Work

<i>Task ID</i>	<i>ULCS#</i>	<i>E l e m e n t</i>	<i>F l o o r</i>	<i>Space # (on Floor Plan)</i>	<i>Space Type</i>	<i>On Site Room Name</i>	<i>Student/ Teacher Occupied</i>	<i>Primary Component</i>	<i>Description of Paint and Plaster Damage - Primary Component</i>	<i>Primary Component Damage Quantity (sf)</i>	<i>Primary Component XRF (positive/ negative)</i>	<i>Additional Component (see terms)</i>	<i>Description of Paint and Plaster Damage - Additional Component</i>	<i>Additoinal Component Damage Quantity (sf)</i>	<i>Additional Component XRF (positive/ negative)</i>	<i>Comments</i>
197	7390	1	3	308/308A	Primary	Classroom 308	yes	Ceiling	Flaking, Efflorescence, Damaged	10	Positive	N/A	N/A	N/A	N/A	
198	7390	1	3	H31	Circulation (Hallway)	Main Hallway at Classrooms 302 to 307	yes	W1	Flaking	1	Positive	N/A	N/A	N/A	N/A	Above the sink
199	7390	1	3	H31	Circulation (Hallway)	Main Hallway at Classrooms 302 to 307	yes	W1	Flaking	6	Positive	N/A	N/A	N/A	N/A	
200	7390	1	3	H31	Circulation (Hallway)	Main Hallway at Classrooms 302 to 307	yes	W3	Friction	2	Positive	N/A	N/A	N/A	N/A	
201	7390	1	3	H31	Circulation (Hallway)	Main Hallway at Classrooms 302 to 307	yes	W4	Damaged plaster	3	Positive	N/A	N/A	N/A	N/A	
202	7390	1	3	H31	Circulation (Hallway)	Main Hallway at Classrooms 302 to 307	yes	W4	Flaking	1	Positive	N/A	N/A	N/A	N/A	Near Girls Restroom
203	7390	1	3	H31	Circulation (Hallway)	Main Hallway at Classrooms 302 to 307	yes	Ceiling	Cracking, Flaking, Efflorescence	20	Positive	N/A	N/A	N/A	N/A	At the windows
204	7390	1	3	H32	Circulation (Hallway)	Hallway in front of Classroom 308	yes	W2	Cracking	6	Positive	N/A	N/A	N/A	N/A	
205	7390	1	3	H32	Circulation (Hallway)	Hallway in front of Classroom 308	yes	W4	Cracking	2	Positive	N/A	N/A	N/A	N/A	
206	7390	1	3	H32	Circulation (Hallway)	Hallway in front of Classroom 308	yes	Ceiling	Cracking, Flaking, Efflorescence	4	Positive	N/A	N/A	N/A	N/A	
207	7390	1	3	S31	Stairs	Stairwell across from Classroom 301	yes	Ceiling	Efflorescence, Spalling, Flaking	25	Positive	N/A	N/A	N/A	N/A	
208	7390	1	3	S33	Stairs	Fire Tower near Classroom 308 at Element #2	yes	W1	Cracking	15	Positive	N/A	N/A	N/A	N/A	
209	7390	1	3	S33	Stairs	Fire Tower near Classroom 308 at Element #2	yes	W2	Cracking	15	Positive	N/A	N/A	N/A	N/A	
210	7390	1	3	S33	Stairs	Fire Tower near Classroom 308 at Element #2	yes	W3	Cracking, Efflorescence, Flaking	25	Positive	N/A	N/A	N/A	N/A	
211	7390	1	3	S33	Stairs	Fire Tower near Classroom 308 at Element #2	yes	W4	Cracking, Efflorescence	80	Positive	N/A	N/A	N/A	N/A	
212	7390	1	B	1	Cafeteria (Dining Area)	Cafeteria	yes	W1	Efflorescence, Flaking	10	Positive	N/A	N/A	N/A	N/A	
213	7390	1	B	1	Cafeteria (Dining Area)	Cafeteria	yes	W2	Craacking	3	Positive	N/A	N/A	N/A	N/A	
214	7390	1	B	1	Cafeteria (Dining Area)	Cafeteria	yes	W3	Efflorescence	4	Positive	N/A	N/A	N/A	N/A	
215	7390	1	B	1	Cafeteria (Dining Area)	Cafeteria	yes	W4	Efflorescence	4	Positive	N/A	N/A	N/A	N/A	
216	7390	1	B	2	Kitchen	Kitchen	yes	W1	Cracking	5	Positive	N/A	N/A	N/A	N/A	
217	7390	1	B	2	Kitchen	Kitchen	yes	W1	Cracking	4	Positive	N/A	N/A	N/A	N/A	
218	7390	1	B	2	Kitchen	Kitchen	yes	W2	Cracking	2	Positive	N/A	N/A	N/A	N/A	
219	7390	1	B	2	Kitchen	Kitchen	yes	Ceiling	Cracking	100	Positive	N/A	N/A	N/A	N/A	
220	7390	1	B	3	Primary	Classroom 003	yes	W1	Chipping	1	Positive	N/A	N/A	N/A	N/A	
221	7390	1	B	3	Primary	Classroom 003	yes	W1	N/A	N/A	N/A	Drain Pipe	Cracking	2	Positive	
222	7390	1	B	3A	Primary	Classroom 003A in Classroom 003	yes	W3	Cracking, Flaking	6	Positive	N/A	N/A	N/A	N/A	
223	7390	1	B	3B	Primary	Classroom 003B in Classroom 003	yes	W3	Cracking, Flaking	10	Positive	N/A	N/A	N/A	N/A	
224	7390	1	B	4	Storage	Music Storage	yes	Ceiling	Flaking	5	Positive	N/A	N/A	N/A	N/A	
225	7390	1	B	5	Storage	Storage across from Student Restrooms	yes	Ceiling	Flaking	4	Positive	N/A	N/A	N/A	N/A	
226	7390	1	B	5	Storage	Storage across from Student Restrooms	yes	Ceiling	N/A	N/A	N/A	Ductwork	Flaking	20	Positive	Floor Tile
227	7390	1	B	6	Student Restrooms - Male (4-12)	Boy's Restroom	yes	W3	Flaking, Efflorescence	6	Positive	N/A	N/A	N/A	N/A	
228	7390	1	B	7	Student Restrooms - Female (4-12)	Girl's Restroom next to Classroom B1	yes	W2	Cracking	4	Positive	N/A	N/A	N/A	N/A	
229	7390	1	B	7	Student Restrooms - Female (4-12)	Girl's Restroom next to Classroom B1	yes	W3	Cracking, Flaking	30	Positive	N/A	N/A	N/A	N/A	

Andrew Morrison ES Scope of Work																
Task ID	ULCS#	Element	Floor	Space # (on Floor Plan)	Space Type	On Site Room Name	Student/Teacher Occupied	Primary Component	Description of Paint and Plaster Damage - Primary Component	Primary Component Damage Quantity (sf)	Primary Component XRF (positive/negative)	Additional Component (see terms)	Description of Paint and Plaster Damage - Additional Component	Additoinal Component Damage Quantity (sf)	Additional Component XRF (positive/negative)	Comments
230	7390	1	B	B1	Primary	Classroom B1	yes	W4	N/A	N/A	N/A	Pipe Jacket	Cracking	1	Positive	
231	7390	1	B	B1	Primary	Classroom B1	yes	Ceiling	Flaking	6	Positive	N/A	N/A	N/A	N/A	At window
232	7390	1	B	9	Mechanical Room	Fan Room	no	W1	Flaking, Cracking	70	Positive	N/A	N/A	N/A	N/A	
233	7390	1	B	9	Mechanical Room	Fan Room	no	W1	Flaking, Cracking	40	Positive	N/A	N/A	N/A	N/A	
234	7390	1	B	9	Mechanical Room	Fan Room	no	W1	N/A	N/A	N/A	Columns	Flaking	30	Positive	
235	7390	1	B	9	Mechanical Room	Fan Room	no	W1	N/A	N/A	N/A	Columns	Flaking	7	Positive	
236	7390	1	B	9	Mechanical Room	Fan Room	no	W1	N/A	N/A	N/A	Columns	Chipping	5	Positive	
237	7390	1	B	9	Mechanical Room	Fan Room	no	W2	Flaking, Cracking	50	Positive	N/A	N/A	N/A	N/A	
238	7390	1	B	9	Mechanical Room	Fan Room	no	W2	Flaking, Cracking	20	Positive	N/A	N/A	N/A	N/A	
239	7390	1	B	9	Mechanical Room	Fan Room	no	W2	N/A	N/A	N/A	Columns	Flaking	30	Positive	
240	7390	1	B	9	Mechanical Room	Fan Room	no	W2	N/A	N/A	N/A	Columns	Flaking	20	Positive	
241	7390	1	B	9	Mechanical Room	Fan Room	no	W3	Flaking, Cracking	15	Positive	N/A	N/A	N/A	N/A	
242	7390	1	B	9	Mechanical Room	Fan Room	no	W3	Flaking, Cracking	15	Positive	N/A	N/A	N/A	N/A	
243	7390	1	B	9	Mechanical Room	Fan Room	no	W3	N/A	N/A	N/A	Columns	Flaking	10	Positive	
244	7390	1	B	9	Mechanical Room	Fan Room	no	W3	N/A	N/A	N/A	Columns	Flaking	5	Positive	
245	7390	1	B	9	Mechanical Room	Fan Room	no	W4	Flaking, Cracking	80	Positive	N/A	N/A	N/A	N/A	
246	7390	1	B	9	Mechanical Room	Fan Room	no	W4	Flaking, Cracking	60	Positive	N/A	N/A	N/A	N/A	
247	7390	1	B	9	Mechanical Room	Fan Room	no	W4	N/A	N/A	N/A	Columns	Flaking	80	Positive	
248	7390	1	B	9	Mechanical Room	Fan Room	no	W4	N/A	N/A	N/A	Columns	Flaking	20	Positive	
249	7390	1	B	9	Mechanical Room	Fan Room	no	W4	N/A	N/A	N/A	Pipe	Flaking	25	Positive	
250	7390	1	B	9	Mechanical Room	Fan Room	no	W4	N/A	N/A	N/A	Pipe	Flaking	10	Positive	
251	7390	1	B	9	Mechanical Room	Fan Room	no	Ceiling	Flaking	200	Positive	N/A	N/A	N/A	N/A	
252	7390	1	B	9	Mechanical Room	Fan Room	no	Ceiling	N/A	N/A	N/A	Ductwork	Flaking	50	Positive	
253	7390	1	B	9	Mechanical Room	Fan Room	no	Ceiling	N/A	N/A	N/A	Ductwork	Flaking	30	Positive	
254	7390	1	B	9	Mechanical Room	Fan Room	no	Floor	Chipping	40	Positive	N/A	N/A	N/A	N/A	
255	7390	1	B	9	Mechanical Room	Fan Room	no	Floor	N/A	N/A	N/A	AHU	Flaking	120	Positive	
256	7390	1	B	9	Mechanical Room	Fan Room	no	Floor	N/A	N/A	N/A	Hand rails	Cracking	20	Positive	At AHUs
257	7390	1	B	9	Mechanical Room	Fan Room	no	Floor	N/A	N/A	N/A	Stair tread	Cracking	5	Positive	Stairs on the Restrooms side
258	7390	1	B	9	Mechanical Room	Fan Room	no	Floor	N/A	N/A	N/A	Stair riser	Cracking	5	Positive	Stairs on the Restrooms side
259	7390	1	B	9	Mechanical Room	Fan Room	no	Floor	N/A	N/A	N/A	Stair tread	Cracking	5	Positive	Stairs on the Boiler Room side
260	7390	1	B	9	Mechanical Room	Fan Room	no	Floor	N/A	N/A	N/A	Stair riser	Cracking	5	Positive	Stairs on the Boiler Room side
261	7390	1	B	9	Mechanical Room	Fan Room	no	Floor	N/A	N/A	N/A	Hand rails	Chipping	10	Positive	Stairs on the Boiler Room side
262	7390	1	B	10	Storage	Fan Room Storage	no	W3	N/A	N/A	N/A	Window Frame	Chipping	8	Positive	
263	7390	1	B	10	Storage	Fan Room Storage	no	W3	N/A	N/A	N/A	Window Mullion	Chipping	4	Positive	
264	7390	1	B	11	Boiler Room	Boiler Room	no	W1	Flaking, Cracking	15	Positive	N/A	N/A	N/A	N/A	

Andrew Morrison ES
Scope of Work

<i>Task ID</i>	<i>ULCS#</i>	<i>E l e m e n t</i>	<i>F l o o r</i>	<i>Space # (on Floor Plan)</i>	<i>Space Type</i>	<i>On Site Room Name</i>	<i>Student/ Teacher Occupied</i>	<i>Primary Component</i>	<i>Description of Paint and Plaster Damage - Primary Component</i>	<i>Primary Component Damage Quantity (sf)</i>	<i>Primary Component XRF (positive/ negative)</i>	<i>Additional Component (see terms)</i>	<i>Description of Paint and Plaster Damage - Additional Component</i>	<i>Additoinal Component Damage Quantity (sf)</i>	<i>Additional Component XRF (positive/ negative)</i>	<i>Comments</i>
265	7390	1	B	11	Boiler Room	Boiler Room	no	W2	Flaking, Cracking	35	Positive	N/A	N/A	N/A	N/A	
266	7390	1	B	11	Boiler Room	Boiler Room	no	W3	Flaking, Cracking	70	Positive	N/A	N/A	N/A	N/A	
267	7390	1	B	11	Boiler Room	Boiler Room	no	W3	N/A	N/A	N/A	Columns	Flaking	30	Positive	
268	7390	1	B	11	Boiler Room	Boiler Room	no	W3	N/A	N/A	N/A	Pipe	Flaking	20	Positive	
269	7390	1	B	11	Boiler Room	Boiler Room	no	W3	N/A	N/A	N/A	Pipe	Flaking	5	Positive	
270	7390	1	B	11	Boiler Room	Boiler Room	no	W4	Flaking, Cracking	120	Positive	N/A	N/A	N/A	N/A	
271	7390	1	B	11	Boiler Room	Boiler Room	no	W4	Flaking, Cracking	80	Positive	N/A	N/A	N/A	N/A	
272	7390	1	B	11	Boiler Room	Boiler Room	no	W4	N/A	N/A	N/A	Columns	Flaking	40	Positive	
273	7390	1	B	11	Boiler Room	Boiler Room	no	W4	N/A	N/A	N/A	Columns	Flaking	10	Positive	
274	7390	1	B	11	Boiler Room	Boiler Room	no	Ceiling	N/A	N/A	N/A	Ductwork	Flaking	100	Positive	
275	7390	1	B	12	Mechanical Room	Water Main Room	no	W1	Flaking	5	Positive	N/A	N/A	N/A	N/A	
276	7390	1	B	12	Mechanical Room	Water Main Room	no	W1	N/A	N/A	N/A	Columns	Flaking	3	Positive	
277	7390	1	B	12	Mechanical Room	Water Main Room	no	W1	N/A	N/A	N/A	Columns	Cracking	20	Positive	
278	7390	1	B	12	Mechanical Room	Water Main Room	no	W2	Flaking	3	Positive	N/A	N/A	N/A	N/A	
279	7390	1	B	12	Mechanical Room	Water Main Room	no	W2	Flaking	10	Positive	N/A	N/A	N/A	N/A	
280	7390	1	B	12	Mechanical Room	Water Main Room	no	W3	Flaking	10	Positive	N/A	N/A	N/A	N/A	
281	7390	1	B	12	Mechanical Room	Water Main Room	no	W4	Flaking	12	Positive	N/A	N/A	N/A	N/A	
282	7390	1	B	14	Primary	Music Room	Yes	W3	Friction	4	Positive	N/A	N/A	N/A	N/A	
283	7390	1	B	16	Storage	Storage room outside Boiler Room	no	W1	Cracking	15	Positive	N/A	N/A	N/A	N/A	
284	7390	1	B	16	Storage	Storage room outside Boiler Room	no	W2	Cracking	12	Positive	N/A	N/A	N/A	N/A	
285	7390	1	B	16	Storage	Storage room outside Boiler Room	no	W3	Cracking	8	Positive	N/A	N/A	N/A	N/A	
286	7390	1	B	16	Storage	Storage room outside Boiler Room	no	W4	Cracking	8	Positive	N/A	N/A	N/A	N/A	
287	7390	1	B	H02	Circulation (Hallway)	Hallway at Music Room 14	yes	W2	Flaking, Cracking	40	Positive	N/A	N/A	N/A	N/A	
288	7390	1	B	H02	Circulation (Hallway)	Hallway at Music Room 14	yes	W3	Cracking	12	Positive	N/A	N/A	N/A	N/A	
289	7390	1	B	H02	Circulation (Hallway)	Hallway at Music Room 14	yes	W4	Flaking, Cracking	40	Positive	N/A	N/A	N/A	N/A	Includes stair ceiling
290	7390	1	B	H02	Circulation (Hallway)	Hallway at Music Room 14	yes	Ceiling	Flaking, Cracking Flaking, Damaged Plaster	20	Positive	N/A	N/A	N/A	N/A	
291	7390	1	B	H02	Circulation (Hallway)	Hallway at Music Room 14	yes	Ceiling	N/A	N/A	N/A	Ductwork	Flaking	30	Positive	
292	7390	1	B	H02	Circulation (Hallway)	Hallway at Music Room 14	yes	Floor	N/A	N/A	N/A	Trench Grate	Flaking, Chipping	6	Positive	
293	7390	1	B	H02	Circulation (Hallway)	Hallway at Music Room 14	yes	Floor	N/A	N/A	N/A	Stair tread	Cracking, Flaking	3	Positive	
294	7390	1	B	H02	Circulation (Hallway)	Hallway at Music Room 14	yes	Floor	N/A	N/A	N/A	Stair riser	Cracking, Flaking	2	Positive	
295	7390	1	B	H03	Circulation (Hallway)	Hallway at Student Restrooms	yes	W2	Cracking	10	Positive	N/A	N/A	N/A	N/A	
296	7390	1	B	H03	Circulation (Hallway)	Hallway at Student Restrooms	yes	W4	Cracking	15	Positive	N/A	N/A	N/A	N/A	
297	7390	1	B	H03	Circulation (Hallway)	Hallway at Student Restrooms	yes	Floor	N/A	N/A	N/A	Trench Grate	Flaking, Chipping	4	Positive	
298	7390	1	B	S01	Stairs	Stairwell on Student Restrooms side	yes	W3	Efflorescence	30	Positive	N/A	N/A	N/A	N/A	
299	7390	1	B	S01	Stairs	Stairwell on Student Restrooms side	yes	W3	Efflorescence	50	Positive	N/A	N/A	N/A	N/A	

Andrew Morrison ES

Scope of Work

[illegible]

Appendix B. EPA Checklist Table

Andrew Morrison ES
EPA Checklist

Task ID	E l e m e n t	F l o o r	Space # (on Floor Plan)	On Site Room Name	Primary Component	Description of Paint and Plaster Damage - Primary Component	Primary Component XRF (positive/ negative)	Additional Component	Description of Paint and Plaster Damage - Additional Component	Additional Component XRF (positive/ negative)	Name of Firm	Date of Renovation	Brief Description of Renovation	Name of Assigned Renovator	Name(s) of Trained Worker(s), if used	Name of Dust Sampling Technician, Inspector, or Risk Assessor, if used	Copies of renovator and dust sampling technician qualifications (training certificates, certifications) on file	If yes to the previous, identify the method used, type of test kit used (if applicable), laboratory used to conduct paint chip analysis, describe sampling location and results	Describe the results of post-renovation cleaning verification, including the number of wet and dry cloths used	If dust clearance testing was performed instead, attach a copy of the report	I certify under penalty of law that the previous information is true and complete (name and title)	Date signed
1	1	1	101B	Girl's Restroom next to Classroom 102	Ceiling	Cracking	Positive	N/A	N/A	N/A	Criterion	2/23/2020	RRP lead paint stabilization	Buttonwood	n/a	CJ Karoly	YES	colormetric/EPA flame	8 RRP wipes	<5 µg/ft2	CJ Karoly EPA lead inspector	2/23/2020
2	1	1	102	Classroom 102	W1	Damaged Plaster	Positive	N/A	N/A	N/A	Criterion	3/5/2020	RRP lead paint stabilization	Buttonwood	n/a	CJ Karoly	YES	colormetric/EPA flame	12 RRP wipes	<5 µg/ft2	CJ Karoly EPA lead inspector	3/5/2020
3	1	1	102	Classroom 102	W2	Cracking	Positive	N/A	N/A	N/A	Criterion	3/5/2020	RRP lead paint stabilization	Buttonwood	n/a	CJ Karoly	YES	colormetric/EPA flame	see above	see above	CJ Karoly EPA lead inspector	3/5/2020
4	1	1	102	Classroom 102	W4	N/A	N/A	Columns	Cracking	Positive	Criterion	3/5/2020	RRP lead paint stabilization	Buttonwood	n/a	CJ Karoly	YES	colormetric/EPA flame	see above	see above	CJ Karoly EPA lead inspector	3/5/2020
5	1	1	102A	Classroom 102 Storage	W2	Cracking	Positive	N/A	N/A	N/A	Criterion	3/5/2020	RRP lead paint stabilization	Buttonwood	n/a	CJ Karoly	YES	colormetric/EPA flame	12 RRP wipes	10.17 µg/ft2, <5 µg/ft2	CJ Karoly EPA lead inspector	3/5/2020
6	1	1	102A	Classroom 102 Storage	W4	Cracking	Positive	N/A	N/A	N/A	Criterion	3/5/2020	RRP lead paint stabilization	Buttonwood	n/a	CJ Karoly	YES	colormetric/EPA flame	see above	see above	CJ Karoly EPA lead inspector	3/5/2020
7	1	1	103	Classroom 103	W1	Cracking	Positive	N/A	N/A	N/A	Criterion	3/5/2020	RRP lead paint stabilization	Buttonwood	n/a	CJ Karoly	YES	colormetric/EPA flame	10 RRP wipes	<5 µg/ft2	CJ Karoly EPA lead inspector	3/5/20
8	1	1	103	Classroom 103	W3	Cracking	Positive	N/A	N/A	N/A	Criterion	3/5/2020	RRP lead paint stabilization	Buttonwood	n/a	CJ Karoly	YES	colormetric/EPA flame	see above	see above	CJ Karoly EPA lead inspector	3/5/20
9	1	1	103	Classroom 103	W3	N/A	N/A	Columns	Cracking	Positive	Criterion	3/5/2020	RRP lead paint stabilization	Buttonwood	n/a	CJ Karoly	YES	colormetric/EPA flame	see above	see above	CJ Karoly EPA lead inspector	3/5/20
10	1	1	103	Classroom 103	Ceiling	Flaking	Positive	N/A	N/A	N/A	Criterion	3/5/2020	RRP lead paint stabilization	Buttonwood	n/a	CJ Karoly	YES	colormetric/EPA flame	see above	see above	CJ Karoly EPA lead inspector	3/5/20
11	1	1	103AA	Classroom 103 Storage Foyer	W3	Cracking	Positive	N/A	N/A	N/A	Criterion	3/5/2020	RRP lead paint stabilization	Buttonwood	n/a	CJ Karoly	YES	colormetric/EPA flame	8 RRP wipes	<5 µg/ft2	CJ Karoly EPA lead inspector	3/5/20
12	1	1	104	Classroom 104	W1	Cracking, Flaking	Positive	N/A	N/A	N/A	Criterion	3/5/2020	RRP lead paint stabilization	Buttonwood	n/a	CJ Karoly	YES	colormetric/EPA flame	14 RRP wipes	<5 µg/ft2	CJ Karoly EPA lead inspector	3/5/20
13	1	1	104	Classroom 104	W2	Cracking, Flaking	Positive	N/A	N/A	N/A	Criterion	3/5/2020	RRP lead paint stabilization	Buttonwood	n/a	CJ Karoly	YES	colormetric/EPA flame	see above	see above	CJ Karoly EPA lead inspector	3/5/20
14	1	1	104	Classroom 104	W3	Cracking, Flaking	Positive	N/A	N/A	N/A	Criterion	3/5/2020	RRP lead paint stabilization	Buttonwood	n/a	CJ Karoly	YES	colormetric/EPA flame	see above	see above	CJ Karoly EPA lead inspector	3/5/20
15	1	1	104	Classroom 104	W3	N/A	N/A	Columns	Flaking	Positive	Criterion	3/5/2020	RRP lead paint stabilization	Buttonwood	n/a	CJ Karoly	YES	colormetric/EPA flame	see above	see above	CJ Karoly EPA lead inspector	3/5/20
16	1	1	104	Classroom 104	Ceiling	Flaking	Positive	N/A	N/A	N/A	Criterion	3/5/2020	RRP lead paint stabilization	Buttonwood	n/a	CJ Karoly	YES	colormetric/EPA flame	see above	see above	CJ Karoly EPA lead inspector	3/5/20
17	1	1	104A	Classroom 104 Storage	W3	Partially Inaccessible/Cracking	Positive	N/A	N/A	N/A	Criterion	3/5/2020	RRP lead paint stabilization	Buttonwood	n/a	CJ Karoly	YES	colormetric/EPA flame	8 RRP wipes	6.18 µg/ft2	CJ Karoly EPA lead inspector	3/5/20
18	1	1	105	Main Office	W1	Chipping	Positive	N/A	N/A	N/A	Criterion	5/1/2020	RRP lead paint stabilization	Buttonwood	n/a	CJ Karoly	YES	colormetric/EPA flame	20 RRP wipes	12.47 µg/ft2, 9.51 µg/ft2	CJ Karoly EPA lead inspector	4/20/20
19	1	1	105	Main Office	W4	Flaking	Positive	N/A	N/A	N/A	Criterion	5/1/2020	RRP lead paint stabilization	Buttonwood	n/a	CJ Karoly	YES	colormetric/EPA flame	see above	see above	CJ Karoly EPA lead inspector	4/20/20
20	1	1	105	Main Office	Ceiling	Efflorescence, Flaking	Positive	N/A	N/A	N/A	Criterion	5/1/2020	RRP lead paint stabilization	Buttonwood	n/a	CJ Karoly	YES	colormetric/EPA flame	see above	see above	CJ Karoly EPA lead inspector	4/20/20
21	1	1	105A	Principal's Office	W1	Cracking	Positive	N/A	N/A	N/A	Criterion	5/1/2020	RRP lead paint stabilization	Buttonwood	n/a	CJ Karoly	YES	colormetric/EPA flame	20 RRP wipes	25 µg/ft2, 67.45 µg/ft2, 11.39 µg/ft2, <5 µg/ft2	CJ Karoly EPA lead inspector	4/20/20
22	1	1	105A	Principal's Office	W3	Cracking	Positive	N/A	N/A	N/A	Criterion	5/1/2020	RRP lead paint stabilization	Buttonwood	n/a	CJ Karoly	YES	colormetric/EPA flame	see above	see above	CJ Karoly EPA lead inspector	4/20/20
23	1	1	105C	Stationery Closet in Main Office	W1	Cracking/Damaged Plaster	Positive	N/A	N/A	N/A	Criterion	5/1/2020	RRP lead paint stabilization	Buttonwood	n/a	CJ Karoly	YES	RRP	3 RRP wipes	N/A	CJ Karoly EPA lead inspector	4/20/20
24	1	1	106/106A	Teacher's Lounge	W2	Cracking	Positive	N/A	N/A	N/A	Criterion	4/13/2020	RRP lead paint stabilization	Buttonwood	n/a	CJ Karoly	YES	RRP	15 RRP wipes	N/A	CJ Karoly EPA lead inspector	4/20/20
25	1	1	106/106A	Teacher's Lounge	W3	N/A	N/A	Columns	Cracking	Positive	Criterion	4/13/2020	RRP lead paint stabilization	Buttonwood	n/a	CJ Karoly	YES	RRP	see above	N/A	CJ Karoly EPA lead inspector	4/20/20
26	1	1	106/106A	Teacher's Lounge	W3	N/A	N/A	Radiator	Chipping	Positive	Criterion	4/13/2020	RRP lead paint stabilization	Buttonwood	n/a	CJ Karoly	YES	RRP	see above	N/A	CJ Karoly EPA lead inspector	4/20/20
27	1	1	107	Classroom 107	W1	Flaking	Positive	N/A	N/A	N/A	Criterion	3/12/2020	RRP lead paint stabilization	Buttonwood	n/a	CJ Karoly	YES	colormetric/EPA flame	12 RRP wipes	6.19 µg/ft2	CJ Karoly EPA lead inspector	3/12/20
28	1	1	107	Classroom 107	W2	Cracking	Positive	N/A	N/A	N/A	Criterion	3/12/2020	RRP lead paint stabilization	Buttonwood	n/a	CJ Karoly	YES	colormetric/EPA flame	see above	see above	CJ Karoly EPA lead inspector	3/12/20
29	1	1	107	Classroom 107 Coat Room	W2	N/A	N/A	Columns	Flaking	Positive	Criterion	3/12/2020	RRP lead paint stabilization	Buttonwood	n/a	CJ Karoly	YES	colormetric/EPA flame	see above	see above	CJ Karoly EPA lead inspector	3/12/20
30	1	1	107	Classroom 107	W3	Flaking	Positive	N/A	N/A	N/A	Criterion	3/12/2020	RRP lead paint stabilization	Buttonwood	n/a	CJ Karoly	YES	colormetric/EPA flame	see above	see above	CJ Karoly EPA lead inspector	3/12/20
31	1	1	107	Classroom 107	W4	flaking	Positive	N/A	N/A	N/A	Criterion	3/12/2020	RRP lead paint stabilization	Buttonwood	n/a	CJ Karoly	YES	colormetric/EPA flame	see above	see above	CJ Karoly EPA lead inspector	3/12/20
32	1	1	107	Classroom 107	Ceiling	Cracking, Efflorescence	Positive	N/A	N/A	N/A	Criterion	3/12/2020	RRP lead paint stabilization	Buttonwood	n/a	CJ Karoly	YES	colormetric/EPA flame	see above	see above	CJ Karoly EPA lead inspector	3/12/20
33	1	1	107B	Classroom 107 Coat Room	W1	Cracking, Damaged Plaster	Positive	N/A	N/A	N/A	Criterion	3/12/2020	RRP lead paint stabilization	Buttonwood	n/a	CJ Karoly	YES	colormetric/EPA flame	12 RRP wipes	40.32 µg/ft2, 7.86 µg/ft2	CJ Karoly EPA lead inspector	3/12/20
34	1	1	107B	Classroom 107 Coat Room	W2	Cracking	Positive	N/A	N/A	N/A	Criterion	3/12/2020	RRP lead paint stabilization	Buttonwood	n/a	CJ Karoly	YES	colormetric/EPA flame	see above	see above	CJ Karoly EPA lead inspector	3/12/20
35	1	1	107A	Boy's Restroom next to Classroom 107	Ceiling	Flaking	Positive	N/A	N/A	N/A	Criterion	2/23/2020	RRP lead paint stabilization	Buttonwood	n/a	CJ Karoly	YES	colormetric/EPA flame	24 RRP wipes	21.68 µg/ft2, 18.46 µg/ft2, <5 µg/ft2	CJ Karoly EPA lead inspector	2/23/20
36	1	1	108	Classroom 108	W1	Flaking	Positive	N/A	N/A	N/A	Criterion	12/27	RRP lead paint stabilization	Buttonwood	n/a	NIKKI RALEIGH	YES	colormetric/EPA flame	10 RRP WIPES	14.09 µg/ft2	CJ Karoly EPA lead inspector	1/2/20
37	1	1	108	Classroom 108	W2	Flaking	Positive	N/A	N/A	N/A	Criterion	12/27	RRP lead paint stabilization	Buttonwood	n/a	SEE ABOVE	YES	colormetric/EPA flame	SEE ABOVE	SEE ABOVE	CJ Karoly EPA lead inspector	1/2/20
38	1	1	108	Classroom 108	W3	Cracking	Positive	N/A	N/A	N/A	Criterion	12/27	RRP lead paint stabilization	Buttonwood	n/a	SEE ABOVE	YES	colormetric/EPA flame	SEE ABOVE	SEE ABOVE	CJ Karoly EPA lead inspector	1/2/20
39	1	1	108A	Classroom 108 Storage	W3	Efflorescence	Positive	N/A	N/A	N/A	Criterion	12/27	RRP lead paint stabilization	Buttonwood	n/a	CJ Karoly	YES	colormetric/EPA flame	4 RRP wipes	<5 µg/ft2	CJ Karoly EPA lead inspector	5/3/20
40	1	1	109A	Auditorium	W1	Cracking, flaking	Positive	N/A	N/A	N/A	Criterion	3/30/2020	RRP lead paint stabilization	Buttonwood	n/a	CJ Karoly	YES	colormetric/EPA flame	50 RRP wipes	19.21 µg/ft2, 10.12 µg/ft2, 9.73 µg/ft2, 11.85 µg/ft2; 8.67 µg/ft2, 6.39 µg/ft2, 10.43 µg/ft2, 10.43 µg/ft2; 9.07 µg/ft2, <5 µg/ft2, 5.13 µg/ft2, 5.4µg/ft2	CJ Karoly EPA lead inspector	4/9/20
41	1	1	109A	Auditorium	W3	Crack in Plaster	Positive	N/A	N/A	N/A	Criterion	3/30/2020	RRP lead paint stabilization	Buttonwood	n/a	CJ Karoly	YES	colormetric/EPA flame	SEE ABOVE	SEE ABOVE	CJ Karoly EPA lead inspector	4/9/20
42	1	1	109A	Auditorium	W4	Cracking	Positive	N/A	N/A	N/A	Criterion	3/30/2020	RRP lead paint stabilization	Buttonwood	n/a	CJ Karoly	YES	colormetric/EPA flame	SEE ABOVE	SEE ABOVE	CJ Karoly EPA lead inspector	4/9/20
43	1	1	109A	Auditorium	Ceiling	Flaking, Cracking	Positive	N/A	N/A	N/A	Criterion	3/30/2020	RRP lead paint stabilization	Buttonwood	n/a	CJ Karoly	YES	colormetric/EPA flame	SEE ABOVE	SEE ABOVE	CJ Karoly EPA lead inspector	4/9/20
44	1	1	109S	Stage	W2	Crack in Plaster, Hole in Plaster	Positive	N/A	N/A	N/A	Criterion	3/30/2020	RRP lead paint stabilization	Buttonwood	n/a	CJ Karoly	YES	colormetric/EPA flame	20 RRP wipes	<5 µg/ft2, 8.96 µg/ft2	CJ Karoly EPA lead inspector	4/9/20
45	1	1	109S	Stage	W2	N/A	N/A	Radiator	Chipping	Positive	Criterion	3/30/2020	RRP lead paint stabilization	Buttonwood	n/a	CJ Karoly	YES	colormetric/EPA flame	SEE ABOVE	SEE ABOVE	CJ Karoly EPA lead inspector	4/9/20
46	1	1	109S	Stage	W3	Cracking	Positive	N/A	N/A	N/A	Criterion	3/30/2020	RRP lead paint stabilization	Buttonwood	n/a	CJ Karoly	YES	colormetric/EPA flame	SEE ABOVE	SEE ABOVE	CJ Karoly EPA lead inspector	4/9/20
47	1	1	109S	Stage	W4	N/A	N/A	Radiator	Chipping	Positive	Criterion	3/30/2020	RRP lead paint stabilization	Buttonwood	n/a	CJ Karoly	YES	colormetric/EPA flame	SEE ABOVE	SEE ABOVE	CJ Karoly EPA lead inspector	4/9/20
48	1	1	110	Storage to the right of Stage	W1	Flaking	Positive	N/A	N/A	N/A	Criterion	4/17/2020	RRP lead paint stabilization	Buttonwood	n/a	CJ Karoly	YES	RRP wipes	7 RRP wipes	N/A	CJ Karoly EPA lead inspector	4/23/2020
49	1	1	110	Storage to the right of Stage	W2	Flaking	Positive	N/A	N/A	N/A	Criterion	4/17/2020	RRP lead paint stabilization	Buttonwood	n/a	CJ Karoly	YES	RRP wipes	SEE ABOVE	N/A	CJ Karoly EPA lead inspector	4/23/2020
50	1	1	110	Storage to the right of Stage	W3	Flaking	Positive	N/A	N/A	N/A	Criterion	4/17/2020	RRP lead paint stabilization	Buttonwood	n/a	CJ Karoly	YES	RRP wipes	SEE ABOVE	N/A	CJ Karoly EPA lead inspector	4/23/2020
51	1	1	111	Philadelphia Police Office	W3	N/A	N/A	Radiator	Chipping	Positive	Criterion	4/17/2020	RRP lead paint stabilization	Buttonwood	n/a	CJ Karoly	YES	RRP wipes	8 RRP wipes	N/A	CJ Karoly EPA lead inspector	4/23/2020
52	1	1	112	Walkway behind Stage leading to Philadelphia Police Office	W2	Cracking	Positive	N/A	N/A	N/A	Criterion	4/17/2020	RRP lead paint stabilization	Buttonwood	n/a	CJ Karoly	YES	RRP wipes	15 RRP wipes	N/A	CJ Karoly EPA lead inspector	4/23/2020
53	1	1	112	Walkway behind Stage leading to Philadelphia Police Office	W4	Cracking	Positive	N/A	N/A	N/A	Criterion	4/17/2020	RRP lead paint stabilization	Buttonwood	n/a	CJ Karoly	YES	RRP wipes	SEE ABOVE	N/A	CJ Karoly EPA lead inspector	4/23/2020
54	1	1	112	Walkway behind Stage leading to Philadelphia Police Office	W4	N/A	N/A	Radiator	Chipping	Positive	Criterion	4/17/2020	RRP lead paint stabilization	Buttonwood	n/a	CJ Karoly	YES	RRP wipes	SEE ABOVE	N/A	CJ Karoly EPA lead inspector	4/23/2020

Andrew Morrison ES
EPA Checklist

Task ID	E l e m e n t	F l o o r	Space # (on Floor Plan)	On Site Room Name	Primary Component	Description of Paint and Plaster Damage - Primary Component	Primary Component XRF (positive/ negative)	Additional Component	Description of Paint and Plaster Damage - Additional Component	Additional Component XRF (positive/ negative)	Name of Firm	Date of Renovation	Brief Description of Renovation	Name of Assigned Renovator	Name(s) of Trained Worker(s), if used	Name of Dust Sampling Technician, Inspector, or Risk Assessor, if used	Copies of renovator and dust sampling technician qualifications (training certificates, certifications) on file	If yes to the previous, identify the method used, type of test kit used (if applicable), laboratory used to conduct paint chip analysis, describe sampling location and results	Describe the results of post-renovation cleaning verification, including the number of wet and dry cloths used	If dust clearance testing was performed instead, attach a copy of the report	I certify under penalty of law that the previous information is true and complete (name and title)	Date signed
55	1	1	114A	Left side Electrical Equipment/Storage in the Main Hallway across from Main Office	W1	Cracking	Positive	N/A	N/A	N/A	Criterion	4/6/2020	RRP lead paint stabilization	Buttonwood	n/a	CJ Karoly	YES	RRP wipes	3 RRP wipes	N/A	CJ Karoly EPA lead inspector	4/10/2020
56	1	1	114A	Left side Electrical Equipment/Storage in the Main Hallway across from Main Office	W2	Flaking	Positive	N/A	N/A	N/A	Criterion	4/6/2020	RRP lead paint stabilization	Buttonwood	n/a	CJ Karoly	YES	RRP wipes	SEE ABOVE	N/A	CJ Karoly EPA lead inspector	4/10/2020
57	1	1	114B	Right side Electrical Equipment/Storage in the Main Hallway across from Main Office	W1	Cracking	Positive	N/A	N/A	N/A	Criterion	4/6/2020	RRP lead paint stabilization	Buttonwood	n/a	CJ Karoly	YES	RRP wipes	3 RRP wipes	N/A	CJ Karoly EPA lead inspector	4/10/2020
58	1	1	114B	Right side Electrical Equipment/Storage in the Main Hallway across from Main Office	W3	Crack in Plaster	Positive	N/A	N/A	N/A	Criterion	4/6/2020	RRP lead paint stabilization	Buttonwood	n/a	CJ Karoly	YES	RRP wipes	SEE ABOVE	N/A	CJ Karoly EPA lead inspector	4/10/2020
59	1	1	114B	Right side Electrical Equipment/Storage in the Main Hallway across from Main Office	W4	Holes in Plaster	Positive	N/A	N/A	N/A	Criterion	4/6/2020	RRP lead paint stabilization	Buttonwood	n/a	CJ Karoly	YES	RRP wipes	SEE ABOVE	N/A	CJ Karoly EPA lead inspector	4/10/2020
60	1	1	115	Storage in the Main Hallway across from Classroom 104	W3	Partially Inaccessible/Cracking	Positive	N/A	N/A	N/A	Criterion	4/17/2020	RRP lead paint stabilization	Buttonwood	n/a	CJ Karoly	YES	RRP wipes	3 RRP wipes	N/A	CJ Karoly EPA lead inspector	4/20/20
61	1	1	115	Stationary Closet next to Stairwell across from Classroom 104	W4	Flaking	Positive	N/A	N/A	N/A	Criterion	4/17/2020	RRP lead paint stabilization	Buttonwood	n/a	CJ Karoly	YES	RRP wipes	SEE ABOVE	N/A	CJ Karoly EPA lead inspector	4/20/20
62	1	1	115A	RRP lead paint stabilization	W4	Damaged Plaster	Positive	N/A	N/A	N/A	Criterion	4/17/2020	RRP lead paint stabilization	Buttonwood	n/a	CJ Karoly	YES	RRP wipes	SEE ABOVE	N/A	CJ Karoly EPA lead inspector	4/20/20
63	1	1	H11	Main Hallway at Classrooms 102 to 107	W1	Flaking	Positive	N/A	N/A	N/A	Criterion	3/26/2020	RRP lead paint stabilization	Buttonwood	n/a	CJ Karoly	YES	RRP wipes	25 RRP wipes	N/A	CJ Karoly EPA lead inspector	4/2/2020
64	1	1	H11	Main Hallway at Classrooms 102 to 107	W1	Flaking	Positive	N/A	N/A	N/A	Criterion	3/26/2020	RRP lead paint stabilization	Buttonwood	n/a	CJ Karoly	YES	RRP wipes	SEE ABOVE	N/A	CJ Karoly EPA lead inspector	4/2/2020
65	1	1	H11	Main Hallway at Classrooms 102 to 107	W2	Flaking	Positive	N/A	N/A	N/A	Criterion	3/26/2020	RRP lead paint stabilization	Buttonwood	n/a	CJ Karoly	YES	RRP wipes	SEE ABOVE	N/A	CJ Karoly EPA lead inspector	4/2/2020
66	1	1	H11	Main Hallway at Classrooms 102 to 107	W3	N/A	N/A	Columns	Flaking, Damaged Plaster	Positive	Criterion	3/26/2020	RRP lead paint stabilization	Buttonwood	n/a	CJ Karoly	YES	RRP wipes	SEE ABOVE	N/A	CJ Karoly EPA lead inspector	4/2/2020
67	1	1	H11	Main Hallway at Classrooms 102 to 107	Ceiling	Flaking	Positive	N/A	N/A	N/A	Criterion	3/26/2020	RRP lead paint stabilization	Buttonwood	n/a	CJ Karoly	YES	RRP wipes		N/A	CJ Karoly EPA lead inspector	4/2/2020
68	1	1	H12	Hallway in front of Classroom 108	W2	Chipping	Positive	N/A	N/A	N/A	Criterion	4/1/2020	RRP lead paint stabilization	Buttonwood	n/a	CJ Karoly	YES	RRP wipes	20 RRP wipes	N/A	CJ Karoly EPA lead inspector	4/2/20
69	1	1	H13	Hallway in front of Nurse's Office	W4	Cracking	Positive	N/A	N/A	N/A	Criterion	3/11/2020	RRP lead paint stabilization	Buttonwood	n/a	CJ Karoly	YES	RRP wipes	5 RRP wipes	N/A	CJ Karoly EPA lead inspector	3/11/20
70	1	1	S11	Stairwell on Girls Restroom side	W1	Scratched	Positive	N/A	N/A	N/A	Criterion	3/4/2020	RRP lead paint stabilization	Buttonwood	n/a	CJ Karoly	YES	RRP wipes	20 RRP wipes	N/A	CJ Karoly EPA lead inspector	3/6/20
71	1	1	S11	Stairwell on Girls Restroom side	Floor	N/A	N/A	Stair riser	Chipping, Contact	Positive	Criterion	3/4/2020	RRP lead paint stabilization	Buttonwood	n/a	CJ Karoly	YES	RRP wipes	see above	N/A	CJ Karoly EPA lead inspector	3/6/20
72	1	1	S11	Stairwell on Girls Restroom side	Floor	N/A	N/A	Newel posts	Chipping, Contact	Positive	Criterion	3/4/2020	RRP lead paint stabilization	Buttonwood	n/a	CJ Karoly	YES	RRP wipes	see above	N/A	CJ Karoly EPA lead inspector	3/6/20
73	1	1	S11-EF	Exit Foyer in Middle Landing at Stairwell on Girls Restroom side	W2	N/A	N/A	Baseboard	Chipping	Positive	Criterion	3/11/2020	RRP lead paint stabilization	Buttonwood	n/a	CJ Karoly	YES	RRP wipes	3 RRP wipes	N/A	CJ Karoly EPA lead inspector	3/13/20
74	1	1	S11-EF	Exit Foyer in Middle Landing at Stairwell on Girls Restroom side	W4	Cracking	Positive	N/A	N/A	N/A	Criterion	3/11/2020	RRP lead paint stabilization	Buttonwood	n/a	CJ Karoly	YES	RRP wipes	see above	N/A	CJ Karoly EPA lead inspector	3/13/20
75	1	1	S11-EF	Exit Foyer in Middle Landing at Stairwell on Girls Restroom side	W4	Cracking	Positive	N/A	N/A	N/A	Criterion	3/11/2020	RRP lead paint stabilization	Buttonwood	n/a	CJ Karoly	YES	RRP wipes	see above	N/A	CJ Karoly EPA lead inspector	3/13/20
76	1	1	S12	Stairwell across from Classroom 108	W1	Chipping	Positive	N/A	N/A	N/A	Criterion	1/22/20	RRP lead paint stabilization	Buttonwood	n/a	CJ Karoly	YES	RRP wipes	22 RRP wipes	N/A	CJ Karoly EPA lead inspector	1/24/20
77	1	1	S12	Stairwell across from Classroom 108	Floor	N/A	N/A	Stair riser	Chipping, Contact	Positive	Criterion	1/22/20	RRP lead paint stabilization	Buttonwood	n/a	CJ Karoly	YES	RRP wipes	see above	N/A	CJ Karoly EPA lead inspector	1/24/20
78	1	1	S12	Stairwell across from Classroom 108	Floor	N/A	N/A	Newel posts	Chipping, Contact	Positive	Criterion	1/22/20	RRP lead paint stabilization	Buttonwood	n/a	CJ Karoly	YES	RRP wipes	see above	N/A	CJ Karoly EPA lead inspector	1/24/20
79	1	1	S12-EF	Exit Foyer in Middle Landing at Stairwell across from Classroom 108	W2	N/A	N/A	Baseboard	Chipping	Positive	Criterion	1/22/20	RRP lead paint stabilization	Buttonwood	n/a	CJ Karoly	YES	RRP wipes	4 RRP wipes	N/A	CJ Karoly EPA lead inspector	1/22/2020
80	1	1	S12-EF	Exit Foyer in Middle Landing at Stairwell across from Classroom 108	W4	N/A	N/A	Baseboard	Chipping	Positive	Criterion	1/22/20	RRP lead paint stabilization	Buttonwood	n/a	CJ Karoly	YES	RRP wipes	see above	N/A	CJ Karoly EPA lead inspector	1/22/2020
81	1	1	S3	Fire Tower near Classroom 108 at Element #2	W1	Cracking, Efflorescence	Positive	N/A	N/A	N/A	Criterion	1/22/2020	RRP lead paint stabilization	Buttonwood	n/a	CJ Karoly	YES	RRP wipes	20 RRP wipes	N/A	CJ Karoly EPA lead inspector	1/22/20
82	1	1	S3	Fire Tower near Classroom 108 at Element #2	W2	Cracking	Positive	N/A	N/A	N/A	Criterion	1/22/2020	RRP lead paint stabilization	Buttonwood	n/a	CJ Karoly	YES	RRP wipes	see above	N/A	CJ Karoly EPA lead inspector	1/22/20
83	1	1	S3	Fire Tower near Classroom 108 at Element #2	W3	Cracking, Efflorescence	Positive	N/A	N/A	N/A	Criterion	1/22/2020	RRP lead paint stabilization	Buttonwood	n/a	CJ Karoly	YES	RRP wipes	see above	N/A	CJ Karoly EPA lead inspector	1/22/20
84	1	1	S3	Fire Tower near Classroom 108 at Element #2	W3	N/A	N/A	Pipe	Flaking	Positive	Criterion	1/22/2020	RRP lead paint stabilization	Buttonwood	n/a	CJ Karoly	YES	RRP wipes	see above	N/A	CJ Karoly EPA lead inspector	1/22/20
85	1	1	S3	Fire Tower near Classroom 108 at Element #2	W4	Cracking, Efflorescence	Positive	N/A	N/A	N/A	Criterion	1/22/2020	RRP lead paint stabilization	Buttonwood	n/a	CJ Karoly	YES	RRP wipes	see above	N/A	CJ Karoly EPA lead inspector	1/22/20
86	1	2	201	Classroom 201	W1	Cracking	Positive	N/A	N/A	N/A	Criterion	2/3/2020	RRP lead paint stabilization	Buttonwood	n/a	CJ Karoly	YES	RRP wipes	20 RRP wipes	N/A	CJ Karoly EPA lead inspector	2/6/20
87	1	2	201	Classroom 201	W2	Flaking, Damaged Plaster	Positive	N/A	N/A	N/A	Criterion	2/3/2020	RRP lead paint stabilization	Buttonwood	n/a	CJ Karoly	YES	RRP wipes	see above	N/A	CJ Karoly EPA lead inspector	2/6/20
88	1	2	201	Classroom 201	W3	Cracking	Positive	N/A	N/A	N/A	Criterion	2/3/2020	RRP lead paint stabilization	Buttonwood	n/a	CJ Karoly	YES	RRP wipes	see above	N/A	CJ Karoly EPA lead inspector	2/6/20
89	1	2	201	Classroom 201	W3	N/A	N/A	Columns	Chipping	Positive	Criterion	2/3/2020	RRP lead paint stabilization	Buttonwood	n/a	CJ Karoly	YES	RRP wipes	see above	N/A	CJ Karoly EPA lead inspector	2/6/20
90	1	2	201	Classroom 201	W4	Cracking	Positive	N/A	N/A	N/A	Criterion	2/3/2020	RRP lead paint stabilization	Buttonwood	n/a	CJ Karoly	YES	RRP wipes	see above	N/A	CJ Karoly EPA lead inspector	2/6/20
91	1	2	201A	Office 201A next to Classroom 201	W2	Cracking	Positive	N/A	N/A	N/A	Criterion	2/5/2020	RRP lead paint stabilization	Buttonwood	n/a	CJ Karoly	YES	RRP wipes	10 RRP wipes	N/A	CJ Karoly EPA lead inspector	2/7/20
92	1	2	201A	Office 201A next to Classroom 201	W3	Cracking	Positive	N/A	N/A	N/A	Criterion	2/5/2020	RRP lead paint stabilization	Buttonwood	n/a	CJ Karoly	YES	RRP wipes	see above	N/A	CJ Karoly EPA lead inspector	2/7/20
93	1	2	201A	Office 201A next to Classroom 201	W4	Cracking	Positive	N/A	N/A	N/A	Criterion	2/5/2020	RRP lead paint stabilization	Buttonwood	n/a	CJ Karoly	YES	RRP wipes	see above	N/A	CJ Karoly EPA lead inspector	2/7/20
94	1	2	201A	Office 201A next to Classroom 201	Ceiling	Efflorescence, Flaking	Positive	N/A	N/A	N/A	Criterion	2/5/2020	RRP lead paint stabilization	Buttonwood	n/a	CJ Karoly	YES	RRP wipes	see above	N/A	CJ Karoly EPA lead inspector	2/7/20
95	1	2	202	Classroom 202	W1	Cracking, Damaged Plaster	Positive	N/A	N/A	N/A	Criterion	2/3/2020	RRP lead paint stabilization	Buttonwood	n/a	CJ Karoly	YES	RRP wipes	20 RRP wipes	N/A	CJ Karoly EPA lead inspector	2/6/2020
96	1	2	202	Classroom 202	W2	Cracking	Positive	N/A	N/A	N/A	Criterion	2/3/2020	RRP lead paint stabilization	Buttonwood	n/a	CJ Karoly	YES	RRP wipes	see above	N/A	CJ Karoly EPA lead inspector	2/6/2020
97	1	2	202	Classroom 202	W3	Cracking	Positive	N/A	N/A	N/A	Criterion	2/3/2020	RRP lead paint stabilization	Buttonwood	n/a	CJ Karoly	YES	RRP wipes	see above	N/A	CJ Karoly EPA lead inspector	2/6/2020
98	1	2	202	Classroom 202	W4	Cracking	Positive	N/A	N/A	N/A	Criterion	2/3/2020	RRP lead paint stabilization	Buttonwood	n/a	CJ Karoly	YES	RRP wipes	see above	N/A	CJ Karoly EPA lead inspector	2/6/2020
99	1	2	202	Classroom 202	Ceiling	Flaking	Positive	N/A	N/A	N/A	Criterion	2/3/2020	RRP lead paint stabilization	Buttonwood	n/a	CJ Karoly	YES	RRP wipes	see above	N/A	CJ Karoly EPA lead inspector	2/6/2020
100	1	2	203	Classroom 203	W1	Cracking	Positive	N/A	N/A	N/A	Criterion	2/3/2020	RRP lead paint stabilization	Buttonwood	n/a	CJ Karoly	YES	RRP wipes	24 RRP wipes	N/A	CJ Karoly EPA lead inspector	2/6/2020
101	1	2	203	Classroom 203	W2	Cracking	Positive	N/A	N/A	N/A	Criterion	2/3/2020	RRP lead paint stabilization	Buttonwood	n/a	CJ Karoly	YES	RRP wipes	see above	N/A	CJ Karoly EPA lead inspector	2/6/2020
102	1	2	203	Classroom 203	W3	Cracking	Positive	N/A	N/A	N/A	Criterion	2/3/2020	RRP lead paint stabilization	Buttonwood	n/a	CJ Karoly	YES	RRP wipes	see above	N/A	CJ Karoly EPA lead inspector	2/6/2020
103	1	2	203	Classroom 203	W3	N/A	N/A	Columns	Cracking, Damaged Plaster	Positive	Criterion	2/3/2020	RRP lead paint stabilization	Buttonwood	n/a	CJ Karoly	YES	RRP wipes	see above	N/A	CJ Karoly EPA lead inspector	2/6/2020
104	1	2	203	Classroom 203	Ceiling	Efflorescence	Positive	N/A	N/A	N/A	Criterion	2/3/2020	RRP lead paint stabilization	Buttonwood	n/a	CJ Karoly	YES	RRP wipes	see above	N/A	CJ Karoly EPA lead inspector	2/6/2020
105	1	2	204	Classroom 204	W1	Cracking	Positive	N/A	N/A	N/A	Criterion	2/12/2020	RRP lead paint stabilization	Buttonwood	n/a	CJ Karoly	YES	RRP wipes	20 RRP wipes	N/A	CJ Karoly EPA lead inspector	2/14/2020
106	1	2	204	Classroom 204	W2	Cracking, Damaged Plaster	Positive	N/A	N/A	N/A	Criterion	2/12/2020	RRP lead paint stabilization	Buttonwood	n/a	CJ Karoly	YES	RRP wipes	see above	N/A	CJ Karoly EPA lead inspector	2/14/2020
107	1	2	204	Classroom 204	W3	N/A	N/A	Columns	Chipping, Cracking	Positive	Criterion	2/12/2020	RRP lead paint stabilization	Buttonwood	n/a	CJ Karoly	YES	RRP wipes	see above	N/A	CJ Karoly EPA lead inspector	2/14/2020
108	1	2	204	Classroom 204	W4	Cracking	Positive	N/A	N/A	N/A	Criterion	2/12/2020	RRP lead paint stabilization	Buttonwood	n/a	CJ Karoly	YES	RRP wipes	see above	N/A	CJ Karoly EPA lead inspector	2/14/2020

Andrew Morrison ES
EPA Checklist

Task ID	Element	Fl oor	Space # (on Floor Plan)	On Site Room Name	Primary Component	Description of Paint and Plaster Damage - Primary Component	Primary Component XRF (positive/ negative)	Additional Component	Description of Paint and Plaster Damage - Additional Component	Additional Component XRF (positive/ negative)	Name of Firm	Date of Renovation	Brief Description of Renovation	Name of Assigned Renovator	Name(s) of Trained Worker(s), if used	Name of Dust Sampling Technician, Inspector, or Risk Assessor, if used	Copies of renovator and dust sampling technician qualifications (training certificates, certifications) on file	If yes to the previous, identify the method used, type of test kit used (if applicable), laboratory used to conduct paint chip analysis, describe sampling location and results	Describe the results of post-renovation cleaning verification, including the number of wet and dry cloths used	If dust clearance testing was performed instead, attach a copy of the report	I certify under penalty of law that the previous information is true and complete (name and title)	Date signed
109	1	2	204	Classroom 204	Ceiling	Flaking	Positive	N/A	N/A	N/A	Criterion	2/12/2020	RRP lead paint stabilization	Buttonwood	n/a	CJ Karoly	YES	RRP wipes	see above	N/A	CJ Karoly EPA lead inspector	2/14/2020
110	1	2	204A	Office 204A	W1	Cracking	Positive	N/A	N/A	N/A	Criterion	2/10/2020	RRP lead paint stabilization	Buttonwood	n/a	CJ Karoly	YES	RRP wipes	10 RRP wipes	N/A	CJ Karoly EPA lead inspector	2/14/2020
111	1	2	204A	Office 204A	W2	Cracking	Positive	N/A	N/A	N/A	Criterion	2/10/2020	RRP lead paint stabilization	Buttonwood	n/a	CJ Karoly	YES	RRP wipes	see above	N/A	CJ Karoly EPA lead inspector	2/14/2020
112	1	2	204A	Office 204A	W3	Cracking	Positive	N/A	N/A	N/A	Criterion	2/10/2020	RRP lead paint stabilization	Buttonwood	n/a	CJ Karoly	YES	RRP wipes	see above	N/A	CJ Karoly EPA lead inspector	2/14/2020
113	1	2	204A	Office 204A	W4	Cracking	Positive	N/A	N/A	N/A	Criterion	2/10/2020	RRP lead paint stabilization	Buttonwood	n/a	CJ Karoly	YES	RRP wipes	see above	N/A	CJ Karoly EPA lead inspector	2/14/2020
114	1	2	204B	Restroom in Office 204A	W2	N/A	N/A	Baseboard	Cracking	Positive	Criterion	2/10/2020	RRP lead paint stabilization	Buttonwood	n/a	CJ Karoly	YES	RRP wipes	4 RRP wipes	N/A	CJ Karoly EPA lead inspector	2/14/2020
115	1	2	204B	Restroom in Office 204A	W3	Cracking	Positive	N/A	N/A	N/A	Criterion	2/10/2020	RRP lead paint stabilization	Buttonwood	n/a	CJ Karoly	YES	RRP wipes	see above	N/A	CJ Karoly EPA lead inspector	2/14/2020
116	1	2	205	Classroom 205	W1	Cracking, Chipping, Damaged Plaster	Positive	N/A	N/A	N/A	Criterion	2/10/2020	RRP lead paint stabilization	Buttonwood	n/a	CJ Karoly	YES	RRP wipes	25 RRP wipes	N/A	CJ Karoly EPA lead inspector	2/14/2020
117	1	2	205	Classroom 205	W2	Cracking	Positive	N/A	N/A	N/A	Criterion	2/10/2020	RRP lead paint stabilization	Buttonwood	n/a	CJ Karoly	YES	RRP wipes	see above	N/A	CJ Karoly EPA lead inspector	2/14/2020
118	1	2	205	Classroom 205	W3	Cracking	Positive	N/A	N/A	N/A	Criterion	2/10/2020	RRP lead paint stabilization	Buttonwood	n/a	CJ Karoly	YES	RRP wipes	see above	N/A	CJ Karoly EPA lead inspector	2/14/2020
119	1	2	205	Classroom 205	W4	Cracking	Positive	N/A	N/A	N/A	Criterion	2/10/2020	RRP lead paint stabilization	Buttonwood	n/a	CJ Karoly	YES	RRP wipes	see above	N/A	CJ Karoly EPA lead inspector	2/14/2020
120	1	2	205A	Classroom 205 Storage	W1	Partially Inaccessible/Cracking	Positive	N/A	N/A	N/A	Criterion	2/10/2020	RRP lead paint stabilization	Buttonwood	n/a	CJ Karoly	YES	RRP wipes	3 RRP wipes	N/A	CJ Karoly EPA lead inspector	2/14/2020
121	1	2	205A	Classroom 205 Storage	W3	Partially Inaccessible/Cracking	Positive	N/A	N/A	N/A	Criterion	2/10/2020	RRP lead paint stabilization	Buttonwood	n/a	CJ Karoly	YES	RRP wipes	see above	N/A	CJ Karoly EPA lead inspector	2/14/2020
122	1	2	205A	Classroom 205 Storage	W4	Partially Inaccessible/Efflorescence	Positive	N/A	N/A	N/A	Criterion	2/10/2020	RRP lead paint stabilization	Buttonwood	n/a	CJ Karoly	YES	RRP wipes	see above	N/A	CJ Karoly EPA lead inspector	2/14/2020
123	1	2	206	Classroom 206	W1	Flaking, Damaged Plaster	Positive	N/A	N/A	N/A	Criterion	2/10/2020	RRP lead paint stabilization	Buttonwood	n/a	CJ Karoly	YES	RRP wipes	25 RRP wipes	N/A	CJ Karoly EPA lead inspector	2/14/2020
124	1	2	206	Classroom 206	W3	Flaking	Positive	N/A	N/A	N/A	Criterion	2/10/2020	RRP lead paint stabilization	Buttonwood	n/a	CJ Karoly	YES	RRP wipes	see above	N/A	CJ Karoly EPA lead inspector	2/14/2020
125	1	2	206	Classroom 206	Ceiling	Flaking	Positive	N/A	N/A	N/A	Criterion	2/10/2020	RRP lead paint stabilization	Buttonwood	n/a	CJ Karoly	YES	RRP wipes	see above	N/A	CJ Karoly EPA lead inspector	2/14/2020
126	1	2	207	Classroom 207	W1	Cracking	Positive	N/A	N/A	N/A	Criterion	2/17/2020	RRP lead paint stabilization	Buttonwood	n/a	CJ Karoly	YES	RRP wipes	20 RRP wipes	N/A	CJ Karoly EPA lead inspector	2/20/20
127	1	2	207	Classroom 207	W1	N/A	N/A	Columns	Damaged Plaster	Positive	Criterion	2/17/2020	RRP lead paint stabilization	Buttonwood	n/a	CJ Karoly	YES	RRP wipes	see above	N/A	CJ Karoly EPA lead inspector	2/20/20
128	1	2	207	Classroom 207	W2	Spalling, Cracking	Positive	N/A	N/A	N/A	Criterion	2/17/2020	RRP lead paint stabilization	Buttonwood	n/a	CJ Karoly	YES	RRP wipes	see above	N/A	CJ Karoly EPA lead inspector	2/20/20
129	1	2	207	Classroom 207	W2	N/A	N/A	Columns	Efflorescence	Positive	Criterion	2/17/2020	RRP lead paint stabilization	Buttonwood	n/a	CJ Karoly	YES	RRP wipes	see above	N/A	CJ Karoly EPA lead inspector	2/20/20
130	1	2	207	Classroom 207	W3	Cracking	Positive	N/A	N/A	N/A	Criterion	2/17/2020	RRP lead paint stabilization	Buttonwood	n/a	CJ Karoly	YES	RRP wipes	see above	N/A	CJ Karoly EPA lead inspector	2/20/20
131	1	2	207	Classroom 207	W4	Cracking	Positive	N/A	N/A	N/A	Criterion	2/17/2020	RRP lead paint stabilization	Buttonwood	n/a	CJ Karoly	YES	RRP wipes	see above	N/A	CJ Karoly EPA lead inspector	2/20/20
132	1	2	207	Classroom 207	Ceiling	Efflorescence, Flaking	Positive	N/A	N/A	N/A	Criterion	2/17/2020	RRP lead paint stabilization	Buttonwood	n/a	CJ Karoly	YES	RRP wipes	see above	N/A	CJ Karoly EPA lead inspector	2/20/20
133	1	2	207A	Boy's Restroom next to Room 207	W3	Flaking	Positive	N/A	N/A	N/A	Criterion	2/21/2020	RRP lead paint stabilization	Buttonwood	n/a	CJ Karoly	YES	RRP wipes	8 RRP wipes	N/A	CJ Karoly EPA lead inspector	2/21/20
134	1	2	207A	Boy's Restroom next to Room 207	W4	Flaking	Positive	N/A	N/A	N/A	Criterion	2/21/2020	RRP lead paint stabilization	Buttonwood	n/a	CJ Karoly	YES	RRP wipes	see above	N/A	CJ Karoly EPA lead inspector	2/21/20
135	1	2	207B	Classroom 207 Storage	W1	Damaged Plaster	Positive	N/A	N/A	N/A	Criterion	2/17/2020	RRP lead paint stabilization	Buttonwood	n/a	CJ Karoly	YES	RRP wipes	4 RRP wipes	N/A	CJ Karoly EPA lead inspector	2/20/20
136	1	2	208	Classroom 208	W1	Cracking, Chipping	Positive	N/A	N/A	N/A	Criterion	2/17/2020	RRP lead paint stabilization	Buttonwood	n/a	CJ Karoly	YES	RRP wipes	25 RRP wipes	N/A	CJ Karoly EPA lead inspector	2/20/20
137	1	2	208	Classroom 208	W2	Chipping	Positive	N/A	N/A	N/A	Criterion	2/17/2020	RRP lead paint stabilization	Buttonwood	n/a	CJ Karoly	YES	RRP wipes	see above	N/A	CJ Karoly EPA lead inspector	2/20/20
138	1	2	208	Classroom 208	W3	Cracking	Positive	N/A	N/A	N/A	Criterion	2/17/2020	RRP lead paint stabilization	Buttonwood	n/a	CJ Karoly	YES	RRP wipes	see above	N/A	CJ Karoly EPA lead inspector	2/20/20
139	1	2	208	Classroom 208	W3	N/A	N/A	Columns	Chipping, Cracking	Positive	Criterion	2/17/2020	RRP lead paint stabilization	Buttonwood	n/a	CJ Karoly	YES	RRP wipes	see above	N/A	CJ Karoly EPA lead inspector	2/20/20
140	1	2	208	Classroom 208	W4	Cracking	Positive	N/A	N/A	N/A	Criterion	2/17/2020	RRP lead paint stabilization	Buttonwood	n/a	CJ Karoly	YES	RRP wipes	see above	N/A	CJ Karoly EPA lead inspector	2/20/20
141	1	2	208	Classroom 208	Ceiling	Flaking	Positive	N/A	N/A	N/A	Criterion	2/17/2020	RRP lead paint stabilization	Buttonwood	n/a	CJ Karoly	YES	RRP wipes	see above	N/A	CJ Karoly EPA lead inspector	2/20/20
142	1	2	208A	Classroom 208 Storage	W2	Cracking	Positive	N/A	N/A	N/A	Criterion	2/17/2020	RRP lead paint stabilization	Buttonwood	n/a	CJ Karoly	YES	RRP wipes	4 RRP wipes	N/A	CJ Karoly EPA lead inspector	2/20/20
143	1	2	208A	Classroom 208 Storage	W3	Spalling, Cracking	Positive	N/A	N/A	N/A	Criterion	2/17/2020	RRP lead paint stabilization	Buttonwood	n/a	CJ Karoly	YES	RRP wipes	see above	N/A	CJ Karoly EPA lead inspector	2/20/20
144	1	2	208A	Classroom 208 Storage	W4	Damaged Plaster	Positive	N/A	N/A	N/A	Criterion	2/17/2020	RRP lead paint stabilization	Buttonwood	n/a	CJ Karoly	YES	RRP wipes	see above	N/A	CJ Karoly EPA lead inspector	2/20/20
145	1	2	211	Walkway to Office 212	W2	Cracking, Flaking, Damaged Plaster	Positive	N/A	N/A	N/A	Criterion	2/24/2020	RRP lead paint stabilization	Buttonwood	n/a	CJ Karoly	YES	RRP wipes	25 RRP wipes	N/A	CJ Karoly EPA lead inspector	3/2/20
146	1	2	211	Walkway to Office 212	W3	Cracking	Positive	N/A	N/A	N/A	Criterion	2/24/2020	RRP lead paint stabilization	Buttonwood	n/a	CJ Karoly	YES	RRP wipes	see above	N/A	CJ Karoly EPA lead inspector	3/2/20
147	1	2	211	Walkway to Office 212	W4	Cracking, Flaking, Damaged Plaster	Positive	N/A	N/A	N/A	Criterion	2/24/2020	RRP lead paint stabilization	Buttonwood	n/a	CJ Karoly	YES	RRP wipes	see above	N/A	CJ Karoly EPA lead inspector	3/2/20
148	1	2	212	Office 212	W1	Cracking	Positive	N/A	N/A	N/A	Criterion	2/24/2020	RRP lead paint stabilization	Buttonwood	n/a	CJ Karoly	YES	RRP wipes	15 RRP wipes	N/A	CJ Karoly EPA lead inspector	3/2/20
149	1	2	212	Office 212	W3	Cracking	Positive	N/A	N/A	N/A	Criterion	2/24/2020	RRP lead paint stabilization	Buttonwood	n/a	CJ Karoly	YES	RRP wipes	see above	N/A	CJ Karoly EPA lead inspector	3/2/20
150	1	2	212	Office 212	W4	Cracking	Positive	N/A	N/A	N/A	Criterion	2/24/2020	RRP lead paint stabilization	Buttonwood	n/a	CJ Karoly	YES	RRP wipes	see above	N/A	CJ Karoly EPA lead inspector	3/2/20
151	1	2	H21	Main Hallway at Classrooms 202 to 207	W3	N/A	N/A	Columns	Damaged Plaster	Positive	Criterion	2/12/20	RRP lead paint stabilization	Buttonwood	n/a	CJ Karoly	YES	RRP wipes	20 RRP wipes	N/A	CJ Karoly EPA lead inspector	2/14/20
152	1	2	H21	Main Hallway at Classrooms 202 to 207	Ceiling	Flaking	Positive	N/A	N/A	N/A	Criterion	2/12/20	RRP lead paint stabilization	Buttonwood	n/a	CJ Karoly	YES	RRP wipes	see above	N/A	CJ Karoly EPA lead inspector	2/14/20
153	1	2	H23	Hallway in front of Classroom 201	W4	N/A	N/A	Column	Damaged Plaster	Positive	Criterion	2/12/20	RRP lead paint stabilization	Buttonwood	n/a	CJ Karoly	YES	RRP wipes	15 RRP wipes	N/A	CJ Karoly EPA lead inspector	2/14/20
154	1	2	S21	Stairwell across from Classroom 201	W1	Cracking	Positive	N/A	N/A	N/A	Criterion	2/12/20	RRP lead paint stabilization	Buttonwood	n/a	CJ Karoly	YES	RRP wipes	15 RRP wipes	N/A	CJ Karoly EPA lead inspector	2/4/2020
155	1	2	S21	Stairwell across from Classroom 201	W3	Cracking, contact	Positive	N/A	N/A	N/A	Criterion	2/12/20	RRP lead paint stabilization	Buttonwood	n/a	CJ Karoly	YES	RRP wipes	see above	N/A	CJ Karoly EPA lead inspector	2/4/2020
156	1	2	S3	Fire Tower near Classroom 208 at Element #2	W1	Cracking, Efflorescence	Positive	N/A	N/A	N/A	Criterion	1/21/2020	RRP lead paint stabilization	Buttonwood	n/a	CJ Karoly	YES	RRP wipes	16 RRP wipes	N/A	CJ Karoly EPA lead inspector	1/23/20
157	1	2	S3	Fire Tower near Classroom 208 at Element #2	W2	Cracking	Positive	N/A	N/A	N/A	Criterion	1/21/2020	RRP lead paint stabilization	Buttonwood	n/a	CJ Karoly	YES	RRP wipes	see above	N/A	CJ Karoly EPA lead inspector	1/23/20
158	1	2	S3	Fire Tower near Classroom 208 at Element #2	W3	Cracking, Efflorescence	Positive	N/A	N/A	N/A	Criterion	1/21/2020	RRP lead paint stabilization	Buttonwood	n/a	CJ Karoly	YES	RRP wipes	see above	N/A	CJ Karoly EPA lead inspector	1/23/20
159	1	2	S3	Fire Tower near Classroom 208 at Element #2	W4	Cracking, Efflorescence	Positive	N/A	N/A	N/A	Criterion	1/21/2020	RRP lead paint stabilization	Buttonwood	n/a	CJ Karoly	YES	RRP wipes	see above	N/A	CJ Karoly EPA lead inspector	1/23/20
160	1	3	301	Classroom 301	W1	Cracking	Positive	N/A	N/A	N/A	Criterion	12/20/19	RRP lead paint stabilization	Buttonwood	n/a	CJ Karoly	YES	RRP wipes	10 RRP wipes	N/A	CJ Karoly EPA lead inspector	1/2/20
161	1	3	301	Classroom 301	W3	Flaking	Positive	N/A	N/A	N/A	Criterion	12/20/19	RRP lead paint stabilization	Buttonwood	n/a	CJ Karoly	YES	RRP wipes	see above	N/A	CJ Karoly EPA lead inspector	1/2/20
162	1	3	301	Classroom 301	W3	N/A	N/A	Columns	Cracking	Positive	Criterion	12/20/19	RRP lead paint stabilization	Buttonwood	n/a	CJ Karoly	YES	RRP wipes	see above	N/A	CJ Karoly EPA lead inspector	1/2/20
163	1	3	301	Classroom 301	W3	N/A	N/A	Radiator	Chipping	Positive	Criterion	12/20/19	RRP lead paint stabilization	Buttonwood	n/a	CJ Karoly	YES	RRP wipes	see above	N/A	CJ Karoly EPA lead inspector	1/2/20
164	1	3	301	Classroom 301	W4	Cracking	Positive	N/A	N/A	N/A	Criterion	12/20/19	RRP lead paint stabilization	Buttonwood	n/a	CJ Karoly	YES	RRP wipes	see above	N/A	CJ Karoly EPA lead inspector	1/2/20
165	1	3	301	Classroom 301	Ceiling	Flaking	Positive	N/A	N/A	N/A	Criterion	12/20/19	RRP lead paint stabilization	Buttonwood	n/a	CJ Karoly	YES	RRP wipes	see above	N/A	CJ Karoly EPA lead inspector	1/2/20
166	1	3	301A	Office 301A	W2	Cracking	Positive	N/A	N/A	N/A	Criterion	1/20/2020	RRP lead paint stabilization	Buttonwood	n/a	CJ Karoly	YES	RRP wipes	10 RRP wipes	N/A	CJ Karoly EPA lead inspector	1/23/20

Andrew Morrison ES
EPA Checklist

Task ID	Element	Floor	Space # (on Floor Plan)	On Site Room Name	Primary Component	Description of Paint and Plaster Damage - Primary Component	Primary Component XRF (positive/ negative)	Additional Component	Description of Paint and Plaster Damage - Additional Component	Additional Component XRF (positive/ negative)	Name of Firm	Date of Renovation	Brief Description of Renovation	Name of Assigned Renovator	Name(s) of Trained Worker(s), if used	Name of Dust Sampling Technician, Inspector, or Risk Assessor, if used	Copies of renovator and dust sampling technician qualifications (training certificates, certifications) on file	If yes to the previous, identify the method used, type of test kit used (if applicable), laboratory used to conduct paint chip analysis, describe sampling location and results	Describe the results of post-renovation cleaning verification, including the number of wet and dry cloths used	If dust clearance testing was performed instead, attach a copy of the report	I certify under penalty of law that the previous information is true and complete (name and title)	Date signed
167	1	3	301A	Office 301A	W3	Cracking	Positive	N/A	N/A	N/A	Criterion	1/20/2020	RRP lead paint stabilization	Buttonwood	n/a	CJ Karoly	YES	RRP wipes	see above	N/A	CJ Karoly EPA lead inspector	1/23/20
168	1	3	301A	Office 301A	W4	Cracking	Positive	N/A	N/A	N/A	Criterion	1/20/2020	RRP lead paint stabilization	Buttonwood	n/a	CJ Karoly	YES	RRP wipes	see above	N/A	CJ Karoly EPA lead inspector	1/23/20
169	1	3	301C	Girl's Restroom next to Classroom 301	W2	Cracking	Positive	N/A	N/A	N/A	Criterion	1/20/2020	RRP lead paint stabilization	Buttonwood	n/a	CJ Karoly	YES	RRP wipes	4 RRP wipes	N/A	CJ Karoly EPA lead inspector	1/23/20
170	1	3	301C	Girl's Restroom next to Classroom 301	W3	Cracking, Spalling	Positive	N/A	N/A	N/A	Criterion	1/20/2020	RRP lead paint stabilization	Buttonwood	n/a	CJ Karoly	YES	RRP wipes	see above	N/A	CJ Karoly EPA lead inspector	1/23/20
171	1	3	301D	Storage 301D	W4	Cracking	Positive	N/A	N/A	N/A	Criterion	1/13/2020	RRP lead paint stabilization	Buttonwood	n/a	CJ Karoly	YES	RRP wipes	10 RRP wipes	N/A	CJ Karoly EPA lead inspector	1/15/20
172	1	3	302	Classroom 302	W1	Flaking, Crack in plaster	Positive	N/A	N/A	N/A	Criterion	12/30/19	RRP lead paint stabilization	Buttonwood	n/a	CJ Karoly	YES	RRP wipes	12 RRP wipes	N/A	CJ Karoly EPA lead inspector	1/2/20
173	1	3	302	Classroom 302	W4	Cracking	Positive	N/A	N/A	N/A	Criterion	12/30/19	RRP lead paint stabilization	Buttonwood	n/a	CJ Karoly	YES	RRP wipes	see above	N/A	CJ Karoly EPA lead inspector	1/2/20
174	1	3	303	Classroom 303	W1	Cracking, Chipping	Positive	N/A	N/A	N/A	Criterion	12/30/19	RRP lead paint stabilization	Buttonwood	n/a	CJ Karoly	YES	RRP wipes	10 RRP wipes	N/A	CJ Karoly EPA lead inspector	1/2/20
175	1	3	303	Classroom 303	W2	Cracking, Chipping	Positive	N/A	N/A	N/A	Criterion	12/30/19	RRP lead paint stabilization	Buttonwood	n/a	CJ Karoly	YES	RRP wipes	see above	N/A	CJ Karoly EPA lead inspector	1/2/20
176	1	3	303	Classroom 303	W3	Cracking, Chipping	Positive	N/A	N/A	N/A	Criterion	12/30/19	RRP lead paint stabilization	Buttonwood	n/a	CJ Karoly	YES	RRP wipes	see above	N/A	CJ Karoly EPA lead inspector	1/2/20
177	1	3	303	Classroom 303	W3	N/A	N/A	Columns	Flaking, Cracking, Chipping	Positive	Criterion	12/30/19	RRP lead paint stabilization	Buttonwood	n/a	CJ Karoly	YES	RRP wipes	see above	N/A	CJ Karoly EPA lead inspector	1/2/20
178	1	3	303	Classroom 303	W3	N/A	N/A	Radiator	Chipping	Positive	Criterion	12/30/19	RRP lead paint stabilization	Buttonwood	n/a	CJ Karoly	YES	RRP wipes	see above	N/A	CJ Karoly EPA lead inspector	1/2/20
179	1	3	307	Classroom 307	W1	Cracking	Positive	N/A	N/A	N/A	Criterion	1/7/2020	RRP lead paint stabilization	Buttonwood	n/a	CJ Karoly	YES	RRP wipes	12 RRP wipes	N/A	CJ Karoly EPA lead inspector	1/9/2020
180	1	3	307	Classroom 307	W2	Cracking, Efflorescence	Positive	N/A	N/A	N/A	Criterion	1/7/2020	RRP lead paint stabilization	Buttonwood	n/a	CJ Karoly	YES	RRP wipes	see above	N/A	CJ Karoly EPA lead inspector	1/9/2020
181	1	3	307	Classroom 307	W2	N/A	N/A	Columns	Chipping	Positive	Criterion	1/7/2020	RRP lead paint stabilization	Buttonwood	n/a	CJ Karoly	YES	RRP wipes	see above	N/A	CJ Karoly EPA lead inspector	1/9/2020
182	1	3	307	Classroom 307	W2	N/A	N/A	Radiator	Chipping	Positive	Criterion	1/7/2020	RRP lead paint stabilization	Buttonwood	n/a	CJ Karoly	YES	RRP wipes	see above	N/A	CJ Karoly EPA lead inspector	1/9/2020
183	1	3	307	Classroom 307	W3	Chipping	Positive	N/A	N/A	N/A	Criterion	1/7/2020	RRP lead paint stabilization	Buttonwood	n/a	CJ Karoly	YES	RRP wipes	see above	N/A	CJ Karoly EPA lead inspector	1/9/2020
184	1	3	307	Classroom 307	W4	N/A	N/A	Columns	Chipping	Positive	Criterion	1/7/2020	RRP lead paint stabilization	Buttonwood	n/a	CJ Karoly	YES	RRP wipes	see above	N/A	CJ Karoly EPA lead inspector	1/9/2020
185	1	3	307A	Boy's Restroom next to Classroom 307	Ceiling	Efflorescence, Spalling, Damaged Plaster	Positive	N/A	N/A	N/A	Criterion	1/14/2020	RRP lead paint stabilization	Buttonwood	n/a	CJ Karoly	YES	RRP wipes	10 RRP wipes	N/A	CJ Karoly EPA lead inspector	1/14/2020
186	1	3	307B	Classroom 307 Storage	W1	Efflorescence	Positive	N/A	N/A	N/A	Criterion	1/7/2020	RRP lead paint stabilization	Buttonwood	n/a	CJ Karoly	YES	RRP wipes	6 RRP wipes	N/A	CJ Karoly EPA lead inspector	1/9/2020
187	1	3	307B	Classroom 307 Storage	W2	Spalling, Cracking	Positive	N/A	N/A	N/A	Criterion	1/7/2020	RRP lead paint stabilization	Buttonwood	n/a	CJ Karoly	YES	RRP wipes	see above	N/A	CJ Karoly EPA lead inspector	1/9/2020
188	1	3	307B	Classroom 307 Storage	Ceiling	Cracking, Damaged Plaster	Positive	N/A	N/A	N/A	Criterion	1/7/2020	RRP lead paint stabilization	Buttonwood	n/a	CJ Karoly	YES	RRP wipes	see above	N/A	CJ Karoly EPA lead inspector	1/9/2020
189	1	3	308/308A	Classroom 308	W1	Cracking, Chipping	Positive	N/A	N/A	N/A	Criterion	1/13/2020	RRP lead paint stabilization	Buttonwood	n/a	CJ Karoly	YES	RRP wipes	12 RRP wipes	N/A	CJ Karoly EPA lead inspector	01/17/2020
190	1	3	308/308A	Classroom 308	W2	Cracking	Positive	N/A	N/A	N/A	Criterion	1/13/2020	RRP lead paint stabilization	Buttonwood	n/a	CJ Karoly	YES	RRP wipes	see above	N/A	CJ Karoly EPA lead inspector	01/17/2020
191	1	3	308/308A	Classroom 308	W2	N/A	N/A	Radiator	Chipping	Positive	Criterion	1/13/2020	RRP lead paint stabilization	Buttonwood	n/a	CJ Karoly	YES	RRP wipes	see above	N/A	CJ Karoly EPA lead inspector	01/17/2020
192	1	3	308/308A	Classroom 308	W3	Cracking, Chipping	Positive	N/A	N/A	N/A	Criterion	1/13/2020	RRP lead paint stabilization	Buttonwood	n/a	CJ Karoly	YES	RRP wipes	see above	N/A	CJ Karoly EPA lead inspector	01/17/2020
193	1	3	308/308A	Classroom 308	W3	N/A	N/A	Radiator	Chipping	Positive	Criterion	1/13/2020	RRP lead paint stabilization	Buttonwood	n/a	CJ Karoly	YES	RRP wipes	see above	N/A	CJ Karoly EPA lead inspector	01/17/2020
194	1	3	308/308A	Classroom 308	W3	N/A	N/A	Pipe	Chipping	Positive	Criterion	1/13/2020	RRP lead paint stabilization	Buttonwood	n/a	CJ Karoly	YES	RRP wipes	see above	N/A	CJ Karoly EPA lead inspector	01/17/2020
195	1	3	308/308A	Classroom 308	W3	N/A	N/A	Columns	Chipping, Damaged plaster	Positive	Criterion	1/13/2020	RRP lead paint stabilization	Buttonwood	n/a	CJ Karoly	YES	RRP wipes	see above	N/A	CJ Karoly EPA lead inspector	01/17/2020
196	1	3	308/308A	Classroom 308	W4	Cracking	Positive	N/A	N/A	N/A	Criterion	1/13/2020	RRP lead paint stabilization	Buttonwood	n/a	CJ Karoly	YES	RRP wipes	see above	N/A	CJ Karoly EPA lead inspector	01/17/2020
197	1	3	308/308A	Classroom 308	Ceiling	Flaking, Efflorescence, Damaged plaster	Positive	N/A	N/A	N/A	Criterion	1/13/2020	RRP lead paint stabilization	Buttonwood	n/a	CJ Karoly	YES	RRP wipes	see above	N/A	CJ Karoly EPA lead inspector	01/17/2020
198	1	3	H31	Main Hallway at Classrooms 302 to 307	W1	Flaking	Positive	N/A	N/A	N/A	Criterion	1/7/2020	RRP lead paint stabilization	Buttonwood	n/a	CJ Karoly	YES	RRP wipes	50 RRP wipes	N/A	CJ Karoly EPA lead inspector	01/12/2020
199	1	3	H31	Main Hallway at Classrooms 302 to 307	W1	Flaking	Positive	N/A	N/A	N/A	Criterion	1/7/2020	RRP lead paint stabilization	Buttonwood	n/a	CJ Karoly	YES	RRP wipes	see above	N/A	CJ Karoly EPA lead inspector	01/12/2020
200	1	3	H31	Main Hallway at Classrooms 302 to 307	W3	Friction	Positive	N/A	N/A	N/A	Criterion	1/7/2020	RRP lead paint stabilization	Buttonwood	n/a	CJ Karoly	YES	RRP wipes	see above	N/A	CJ Karoly EPA lead inspector	01/12/2020
201	1	3	H31	Main Hallway at Classrooms 302 to 307	W4	Damaged plaster	Positive	N/A	N/A	N/A	Criterion	1/7/2020	RRP lead paint stabilization	Buttonwood	n/a	CJ Karoly	YES	RRP wipes	see above	N/A	CJ Karoly EPA lead inspector	01/12/2020
202	1	3	H31	Main Hallway at Classrooms 302 to 307	W4	Flaking	Positive	N/A	N/A	N/A	Criterion	1/7/2020	RRP lead paint stabilization	Buttonwood	n/a	CJ Karoly	YES	RRP wipes	see above	N/A	CJ Karoly EPA lead inspector	01/12/2020
203	1	3	H31	Main Hallway at Classrooms 302 to 307	Ceiling	Cracking, Flaking, Efflorescence	Positive	N/A	N/A	N/A	Criterion	1/7/2020	RRP lead paint stabilization	Buttonwood	n/a	CJ Karoly	YES	RRP wipes	see above	N/A	CJ Karoly EPA lead inspector	01/12/2020
204	1	3	H32	Hallway in front of Classroom 308	W2	Cracking	Positive	N/A	N/A	N/A	Criterion	1/10/2020	RRP lead paint stabilization	Buttonwood	n/a	CJ Karoly	YES	RRP wipes	25 RRP wipes	N/A	CJ Karoly EPA lead inspector	1/12/2020
205	1	3	H32	Hallway in front of Classroom 308	W4	Cracking	Positive	N/A	N/A	N/A	Criterion	1/10/2020	RRP lead paint stabilization	Buttonwood	n/a	CJ Karoly	YES	RRP wipes	see above	N/A	CJ Karoly EPA lead inspector	1/12/2020
206	1	3	H32	Hallway in front of Classroom 308	Ceiling	Cracking, Flaking, Efflorescence	Positive	N/A	N/A	N/A	Criterion	1/10/2020	RRP lead paint stabilization	Buttonwood	n/a	CJ Karoly	YES	RRP wipes	see above	N/A	CJ Karoly EPA lead inspector	1/12/2020
207	1	3	S31	Stairwell across from Classroom 301	Ceiling	Efflorescence, Spalling, Flaking	Positive	N/A	N/A	N/A	Criterion	1/28/2020	RRP lead paint stabilization	Buttonwood	n/a	CJ Karoly	YES	RRP wipes	20 RRP wipes	N/A	CJ Karoly EPA lead inspector	2/4/2020
208	1	3	S33	Fire Tower near Classroom 308 at Element #2	W1	Cracking	Positive	N/A	N/A	N/A	Criterion	1/21/2020	RRP lead paint stabilization	Buttonwood	n/a	CJ Karoly	YES	RRP wipes	18 RRP wipes	N/A	CJ Karoly EPA lead inspector	1/23/2020
209	1	3	S33	Fire Tower near Classroom 308 at Element #2	W2	Cracking	Positive	N/A	N/A	N/A	Criterion	1/21/2020	RRP lead paint stabilization	Buttonwood	n/a	CJ Karoly	YES	RRP wipes	see above	N/A	CJ Karoly EPA lead inspector	1/23/2020
210	1	3	S33	Fire Tower near Classroom 308 at Element #2	W3	Cracking, Efflorescence, Flaking	Positive	N/A	N/A	N/A	Criterion	1/21/2020	RRP lead paint stabilization	Buttonwood	n/a	CJ Karoly	YES	RRP wipes	see above	N/A	CJ Karoly EPA lead inspector	1/23/2020
211	1	3	S33	Fire Tower near Classroom 308 at Element #2	W4	Cracking, Efflorescence	Positive	N/A	N/A	N/A	Criterion	1/21/2020	RRP lead paint stabilization	Buttonwood	n/a	CJ Karoly	YES	RRP wipes	see above	N/A	CJ Karoly EPA lead inspector	1/23/2020
212	1	B	1	Cafeteria	W1	Efflorescence, Flaking	Positive	N/A	N/A	N/A	Criterion	1/27/2020	RRP lead paint stabilization	Buttonwood	n/a	CJ Karoly	YES	COLORMETRIC/EPA FLAME ANALYSIS	20 RRP wipes	6.87 µg/ft2	CJ KAROLY EPA LEAD INSPECTOR	1/29/20
213	1	B	1	Cafeteria	W2	Cracking	Positive	N/A	N/A	N/A	Criterion	1/27/2020	RRP lead paint stabilization	Buttonwood	n/a	CJ Karoly	YES	COLORMETRIC/EPA FLAME ANALYSIS	see above	see above	CJ KAROLY EPA LEAD INSPECTOR	1/29/20
214	1	B	1	Cafeteria	W3	Efflorescence	Positive	N/A	N/A	N/A	Criterion	1/27/2020	RRP lead paint stabilization	Buttonwood	n/a	CJ Karoly	YES	COLORMETRIC/EPA FLAME ANALYSIS	see above	see above	CJ KAROLY EPA LEAD INSPECTOR	1/29/20
215	1	B	1	Cafeteria	W4	Efflorescence	Positive	N/A	N/A	N/A	Criterion	1/27/2020	RRP lead paint stabilization	Buttonwood	n/a	CJ Karoly	YES	COLORMETRIC/EPA FLAME ANALYSIS	see above	see above	CJ KAROLY EPA LEAD INSPECTOR	1/29/20
216	1	B	2	Kitchen	W1	Cracking	Positive	N/A	N/A	N/A	Criterion	4/28/2020	RRP lead paint stabilization	Buttonwood	n/a	CJ Karoly	YES	COLORMETRIC/EPA FLAME ANALYSIS	50 RRP wipes	43.01 µg/ft2, 124.03 µg/ft2, <5 µg/ft2	CJ KAROLY EPA LEAD INSPECTOR	5/4/2020
217	1	B	2	Kitchen	W1	Cracking	Positive	N/A	N/A	N/A	Criterion	4/28/2020	RRP lead paint stabilization	Buttonwood	n/a	CJ Karoly	YES	COLORMETRIC/EPA FLAME ANALYSIS	see above	see above	CJ KAROLY EPA LEAD INSPECTOR	5/4/2020
218	1	B	2	Kitchen	W2	Cracking	Positive	N/A	N/A	N/A	Criterion	4/28/2020	RRP lead paint stabilization	Buttonwood	n/a	CJ Karoly	YES	COLORMETRIC/EPA FLAME ANALYSIS	see above	see above	CJ KAROLY EPA LEAD INSPECTOR	5/4/2020
219	1	B	2	Kitchen	Ceiling	Cracking	Positive	N/A	N/A	N/A	Criterion	4/28/2020	RRP lead paint stabilization	Buttonwood	n/a	CJ Karoly	YES	COLORMETRIC/EPA FLAME ANALYSIS	see above	see above	CJ KAROLY EPA LEAD INSPECTOR	5/4/2020
220	1	B	3	Classroom 003	W1	Chipping	Positive	N/A	N/A	N/A	Criterion	5/1/2020	RRP lead paint stabilization	Buttonwood	n/a	CJ Karoly	YES	RRP wipes	25 RRP wipes	n/a	CJ KAROLY EPA LEAD INSPECTOR	5/5/2020
221	1	B	3	Classroom 003	W1	N/A	N/A	Drain Pipe	Cracking	Positive	Criterion	5/1/2020	RRP lead paint stabilization	Buttonwood	n/a	CJ Karoly	YES	RRP wipes	see above	n/a	CJ KAROLY EPA LEAD INSPECTOR	5/5/2020
222	1	B	3A	Classroom 003A in Classroom 003	W3	Cracking, Flaking	Positive	N/A	N/A	N/A	Criterion	5/1/2020	RRP lead paint stabilization	Buttonwood	n/a	CJ Karoly	YES	RRP wipes	8 RRP wipes	n/a	CJ KAROLY EPA LEAD INSPECTOR	5/5/2020
223	1	B	3B	Classroom 003B in Classroom 003	W3	Cracking, Flaking	Positive	N/A	N/A	N/A	Criterion	5/1/2020	RRP lead paint stabilization	Buttonwood	n/a	CJ Karoly	YES	RRP wipes	see above	n/a	CJ KAROLY EPA LEAD INSPECTOR	5/5/2020
224	1	B	4	Music Storage	Ceiling	Flaking	Positive	N/A	N/A	N/A	Criterion	5/4/2020	RRP lead paint stabilization	Buttonwood	n/a	CJ Karoly	YES	RRP wipes	10 RRP wipes	n/a	CJ KAROLY EPA LEAD INSPECTOR	5/5/2020

Andrew Morrison ES
EPA Checklist

Task ID	E l e m e n t	F l o o r	Space # (on Floor Plan)	On Site Room Name	Primary Component	Description of Paint and Plaster Damage - Primary Component	Primary Component XRF (positive/ negative)	Additional Component	Description of Paint and Plaster Damage - Additional Component	Additional Component XRF (positive/ negative)	Name of Firm	Date of Renovation	Brief Description of Renovation	Name of Assigned Renovator	Name(s) of Trained Worker(s), if used	Name of Dust Sampling Technician, Inspector, or Risk Assessor, if used	Copies of renovator and dust sampling technician qualifications (training certificates, certifications) on file	If yes to the previous, identify the method used, type of test kit used (if applicable), laboratory used to conduct paint chip analysis, describe sampling location and results	Describe the results of post-renovation cleaning verification, including the number of wet and dry cloths used	If dust clearance testing was performed instead, attach a copy of the report	I certify under penalty of law that the previous information is true and complete (name and title)	Date signed
225	1	B	5	Storage across from Student Restrooms	Ceiling	Flaking	Positive	N/A	N/A	N/A	Criterion	5/5/2020	RRP lead paint stabilization	Buttonwood	n/a	CJ Karoly	YES	RRP wipes	6 RRP wipes	n/a	CJ KAROLY EPA LEAD INSPECTOR	5/6/2020
226	1	B	5	Storage across from Student Restrooms	Ceiling	N/A	N/A	Ductwork	Flaking	Positive	Criterion	5/5/2020	RRP lead paint stabilization	Buttonwood	n/a	CJ Karoly	YES	RRP wipes	see above	n/a	CJ KAROLY EPA LEAD INSPECTOR	5/6/2020
227	1	B	6	Boy's Restroom	W3	Flaking, Efflorescence	Positive	N/A	N/A	N/A	Criterion	4/20/2020	RRP lead paint stabilization	Buttonwood	n/a	CJ Karoly	YES	RRP wipes	6 RRP wipes	n/a	CJ KAROLY EPA LEAD INSPECTOR	4/20/2020
228	1	B	7	Girl's Restroom next to Classroom B1	W2	Cracking	Positive	N/A	N/A	N/A	Criterion	4/20/2020	RRP lead paint stabilization	Buttonwood	n/a	CJ Karoly	YES	RRP wipes	10 RRP wipes	n/a	CJ KAROLY EPA LEAD INSPECTOR	4/20/2020
229	1	B	7	Girl's Restroom next to Classroom B1	W3	Cracking, Flaking	Positive	N/A	N/A	N/A	Criterion	4/20/2020	RRP lead paint stabilization	Buttonwood	n/a	CJ Karoly	YES	RRP wipes	see above	n/a	CJ KAROLY EPA LEAD INSPECTOR	4/20/2020
230	1	B	B1	Classroom B1	W4	N/A	N/A	Pipe Jacket	Cracking	Positive	Criterion	4/17/2020	RRP lead paint stabilization	Buttonwood	n/a	CJ Karoly	YES	COLORMETRIC/EPA FLAME ANALYSIS	7 RRP wipes	<5 µg/ft2	CJ KAROLY EPA LEAD INSPECTOR	4/17/2020
231	1	B	B1	Classroom B1	Ceiling	Flaking	Positive	N/A	N/A	N/A	Criterion	4/17/2020	RRP lead paint stabilization	Buttonwood	n/a	CJ Karoly	YES	COLORMETRIC/EPA FLAME ANALYSIS	see above	n/a	CJ KAROLY EPA LEAD INSPECTOR	4/17/2020
232	1	B	9	Fan Room	W1	Flaking, Cracking	Positive	N/A	N/A	N/A	Criterion											
233	1	B	9	Fan Room	W1	Flaking, Cracking	Positive	N/A	N/A	N/A	Criterion											
234	1	B	9	Fan Room	W1	N/A	N/A	Columns	Flaking	Positive	Criterion											
235	1	B	9	Fan Room	W1	N/A	N/A	Columns	Flaking	Positive	Criterion											
236	1	B	9	Fan Room	W1	N/A	N/A	Columns	Chipping	Positive	Criterion											
237	1	B	9	Fan Room	W2	Flaking, Cracking	Positive	N/A	N/A	N/A	Criterion											
238	1	B	9	Fan Room	W2	Flaking, Cracking	Positive	N/A	N/A	N/A	Criterion											
239	1	B	9	Fan Room	W2	N/A	N/A	Columns	Flaking	Positive	Criterion											
240	1	B	9	Fan Room	W2	N/A	N/A	Columns	Flaking	Positive	Criterion											
241	1	B	9	Fan Room	W3	Flaking, Cracking	Positive	N/A	N/A	N/A	Criterion											
242	1	B	9	Fan Room	W3	Flaking, Cracking	Positive	N/A	N/A	N/A	Criterion											
243	1	B	9	Fan Room	W3	N/A	N/A	Columns	Flaking	Positive	Criterion											
244	1	B	9	Fan Room	W3	N/A	N/A	Columns	Flaking	Positive	Criterion											
245	1	B	9	Fan Room	W4	Flaking, Cracking	Positive	N/A	N/A	N/A	Criterion											
246	1	B	9	Fan Room	W4	Flaking, Cracking	Positive	N/A	N/A	N/A	Criterion											
247	1	B	9	Fan Room	W4	N/A	N/A	Columns	Flaking	Positive	Criterion											
248	1	B	9	Fan Room	W4	N/A	N/A	Columns	Flaking	Positive	Criterion											
249	1	B	9	Fan Room	W4	N/A	N/A	Pipe	Flaking	Positive	Criterion											
250	1	B	9	Fan Room	W4	N/A	N/A	Pipe	Flaking	Positive	Criterion											
251	1	B	9	Fan Room	Ceiling	Flaking	Positive	N/A	N/A	N/A	Criterion											
252	1	B	9	Fan Room	Ceiling	N/A	N/A	Ductwork	Flaking	Positive	Criterion											
253	1	B	9	Fan Room	Ceiling	N/A	N/A	Ductwork	Flaking	Positive	Criterion											
254	1	B	9	Fan Room	Floor	Chipping	Positive	N/A	N/A	N/A	Criterion											
255	1	B	9	Fan Room	Floor	N/A	N/A	AHU	Flaking	Positive	Criterion											
256	1	B	9	Fan Room	Floor	N/A	N/A	Hand rails	Cracking	Positive	Criterion											
257	1	B	9	Fan Room	Floor	N/A	N/A	Stair tread	Cracking	Positive	Criterion											
258	1	B	9	Fan Room	Floor	N/A	N/A	Stair riser	Cracking	Positive	Criterion											
259	1	B	9	Fan Room	Floor	N/A	N/A	Stair tread	Cracking	Positive	Criterion											
260	1	B	9	Fan Room	Floor	N/A	N/A	Stair riser	Cracking	Positive	Criterion											
261	1	B	9	Fan Room	Floor	N/A	N/A	Hand rails	Chipping	Positive	Criterion											
262	1	B	10	Fan Room Storage	W3	N/A	N/A	Window Frame	Chipping	Positive	Criterion											
263	1	B	10	Fan Room Storage	W3	N/A	N/A	Window Mullion	Chipping	Positive	Criterion											
264	1	B	11	Boiler Room	W1	Flaking, Cracking	Positive	N/A	N/A	N/A	Criterion											
265	1	B	11	Boiler Room	W2	Flaking, Cracking	Positive	N/A	N/A	N/A	Criterion											
266	1	B	11	Boiler Room	W3	Flaking, Cracking	Positive	N/A	N/A	N/A	Criterion											
267	1	B	11	Boiler Room	W3	N/A	N/A	Columns	Flaking	Positive	Criterion											
268	1	B	11	Boiler Room	W3	N/A	N/A	Pipe	Flaking	Positive	Criterion											
269	1	B	11	Boiler Room	W3	N/A	N/A	Pipe	Flaking	Positive	Criterion											
270	1	B	11	Boiler Room	W4	Flaking, Cracking	Positive	N/A	N/A	N/A	Criterion											
271	1	B	11	Boiler Room	W4	Flaking, Cracking	Positive	N/A	N/A	N/A	Criterion											
272	1	B	11	Boiler Room	W4	N/A	N/A	Columns	Flaking	Positive	Criterion											
273	1	B	11	Boiler Room	W4	N/A	N/A	Columns	Flaking	Positive	Criterion											
274	1	B	11	Boiler Room	Ceiling	N/A	N/A	Ductwork	Flaking	Positive	Criterion											
275	1	B	12	Water Main Room	W1	Flaking	Positive	N/A	N/A	N/A	Criterion											
276	1	B	12	Water Main Room	W1	N/A	N/A	Columns	Flaking	Positive	Criterion											
277	1	B	12	Water Main Room	W1	N/A	N/A	Columns	Cracking	Positive	Criterion											
278	1	B	12	Water Main Room	W2	Flaking	Positive	N/A	N/A	N/A	Criterion											
279	1	B	12	Water Main Room	W2	Flaking	Positive	N/A	N/A	N/A	Criterion											
280	1	B	12	Water Main Room	W3	Flaking	Positive	N/A	N/A	N/A	Criterion											
281	1	B	12	Water Main Room	W4	Flaking	Positive	N/A	N/A	N/A	Criterion											
282	1	B	14	Music Room	W3	Friction	Positive	N/A	N/A	N/A	Criterion	5/5/2020	RRP lead paint stabilization	Buttonwood	n/a	CJ Karoly	YES	COLORMETRIC/EPA FLAME ANALYSIS	8 RRP wipes	n/a	CJ KAROLY EPA LEAD INSPECTOR	05/06/2020
283	1	B	16	Storage room outside Boiler Room	W1	Cracking	Positive	N/A	N/A	N/A	Criterion	5/5/2020	RRP lead paint stabilization	Buttonwood	n/a	CJ Karoly	YES	RRP wipes	15 RRP wipes	n/a	CJ KAROLY EPA LEAD INSPECTOR	05/06/2020
284	1	B	16	Storage room outside Boiler Room	W2	Cracking	Positive	N/A	N/A	N/A	Criterion	5/5/2020	RRP lead paint stabilization	Buttonwood	n/a	CJ Karoly	YES	RRP wipes	see above	n/a	CJ KAROLY EPA LEAD INSPECTOR	05/06/2020
285	1	B	16	Storage room outside Boiler Room	W3	Cracking	Positive	N/A	N/A	N/A	Criterion	5/5/2020	RRP lead paint stabilization	Buttonwood	n/a	CJ Karoly	YES	RRP wipes	see above	n/a	CJ KAROLY EPA LEAD INSPECTOR	05/06/2020
286	1	B	16	Storage room outside Boiler Room	W4	Cracking	Positive	N/A	N/A	N/A	Criterion	5/5/2020	RRP lead paint stabilization	Buttonwood	n/a	CJ Karoly	YES	RRP wipes	see above	n/a	CJ KAROLY EPA LEAD INSPECTOR	05/06/2020
287	1	B	H02	Hallway at Music Room 14	W2	Flaking, Cracking	Positive	N/A	N/A	N/A	Criterion	4/27/2020	RRP lead paint stabilization	Buttonwood	n/a	CJ Karoly	YES	RRP wipes	22 RRP wipes	n/a	CJ KAROLY EPA LEAD INSPECTOR	04/29/2020
288	1	B	H02	Hallway at Music Room 14	W3	Cracking	Positive	N/A	N/A	N/A	Criterion	4/27/2020	RRP lead paint stabilization	Buttonwood	n/a	CJ Karoly	YES	RRP wipes	see above	n/a	CJ KAROLY EPA LEAD INSPECTOR	04/29/2020
289	1	B	H02	Hallway at Music Room 14	W4	Flaking, Cracking	Positive	N/A	N/A	N/A	Criterion	4/27/2020	RRP lead paint stabilization	Buttonwood	n/a	CJ Karoly	YES	RRP wipes	see above	n/a	CJ KAROLY EPA LEAD INSPECTOR	04/29/2020
290	1	B	H02	Hallway at Music Room 14	Ceiling	Flaking, Damaged Plaster	Positive	N/A	N/A	N/A	Criterion	4/27/2020	RRP lead paint stabilization	Buttonwood	n/a	CJ Karoly	YES	RRP wipes	see above	n/a	CJ KAROLY EPA LEAD INSPECTOR	04/29/2020
291	1	B	H02	Hallway at Music Room 14	Ceiling	N/A	N/A	Ductwork	Flaking	Positive	Criterion	4/27/2020	RRP lead paint stabilization	Buttonwood	n/a	CJ Karoly	YES	RRP wipes	see above	n/a	CJ KAROLY EPA LEAD INSPECTOR	04/29/2020
292	1	B	H02	Hallway at Music Room 14	Floor	N/A	N/A	Trench Grate	Flaking, Chipping	Positive	Criterion	4/27/2020	RRP lead paint stabilization	Buttonwood	n/a	CJ Karoly	YES	RRP wipes	see above	n/a	CJ KAROLY EPA LEAD INSPECTOR	04/29/2020
293	1	B	H02	Hallway at Music Room 14	Floor	N/A	N/A	Stair tread	Cracking, Flaking	Positive	Criterion	4/27/2020	RRP lead paint stabilization	Buttonwood	n/a	CJ Karoly	YES	RRP wipes	see above	n/a	CJ KAROLY EPA LEAD INSPECTOR	04/29/2020
294	1	B	H02	Hallway at Music Room 14	Floor	N/A	N/A	Stair riser	Cracking, Flaking	Positive	Criterion	4/27/2020	RRP lead paint stabilization	Buttonwood	n/a	CJ Karoly	YES	RRP wipes	see above	n/a	CJ KAROLY EPA LEAD INSPECTOR	04/29/2020
295	1	B	H03	Hallway at Student Restrooms	W2	Cracking	Positive	N/A	N/A	N/A	Criterion	4/23/2020	RRP lead paint stabilization	Buttonwood	n/a	CJ Karoly	YES	RRP wipes	20 RRP wipes	n/a	CJ KAROLY EPA LEAD INSPECTOR	4/24/20
296	1	B	H03	Hallway at Student Restrooms	W4	Cracking	Positive	N/A	N/A	N/A	Criterion	4/23/2020	RRP lead paint stabilization	Buttonwood	n/a	CJ Karoly	YES	RRP wipes	see above	n/a	CJ KAROLY EPA LEAD INSPECTOR	4/24/20
297	1	B	H03	Hallway at Student Restrooms	Floor	N/A	N/A	Trench Grate	Flaking, Chipping	Positive	Criterion	4/23/2020	RRP lead paint stabilization	Buttonwood	n/a	CJ Karoly	YES	RRP wipes	see above	n/a	CJ KAROLY EPA LEAD INSPECTOR	4/24/20
298	1	B	S01	Stairwell on Student Restrooms side	W3	Efflorescence	Positive	N/A	N/A	N/A	Criterion	2/6/2020	RRP lead paint stabilization	Buttonwood	n/a	CJ Karoly	YES	RRP wipes	25 RRP wipes	n/a	CJ KAROLY EPA LEAD INSPECTOR	2/10/20
299	1	B	S01	Stairwell on Student Restrooms side	W3	Efflorescence	Positive	N/A	N/A	N/A	Criterion	2/6/2020	RRP lead paint stabilization	Buttonwood	n/a	CJ Karoly	YES	RRP wipes	see above	n/a	CJ KAROLY EPA LEAD INSPECTOR	2/10/20
300	1	B	S01	Stairwell on Student Restrooms side	Floor	N/A	N/A	Newel posts	Chipping	Positive	Criterion	2/6/2020	RRP lead paint stabilization	Buttonwood	n/a	CJ Karoly	YES	RRP wipes	see above	n/a	CJ KAROLY EPA LEAD INSPECTOR	2/10/20
301	1	B	S02	Stairwell on Boiler Room side	W1	Contact	Positive	N/A	N/A	N/A	Criterion	2/13/2020	RRP lead paint stabilization	Buttonwood	n/a	CJ Karoly	YES	RRP wipes	25 RRP wipes	n/a	CJ KAROLY EPA LEAD INSPECTOR	2/15/20
302	1	B	S02	Stairwell on Boiler Room side	W2	Spalling	Positive	N/A	N/A	N/A	Criterion	2/13/2020	RRP lead paint stabilization	Buttonwood	n/a	CJ Karoly	YES	RRP wipes	see above	n/a	CJ KAROLY EPA LEAD INSPECTOR	2/15/20
303	1	B	S02	Stairwell on Boiler Room side	W3	N/A	N/A	Column	Spalling	Positive	Criterion	2/13/2020	RRP lead paint stabilization	Buttonwood	n/a	CJ Karoly	YES	RRP wipes	see above	n/a	CJ KAROLY EPA LEAD INSPECTOR	2/15/20
304	1	B	S02	Stairwell on Boiler Room side	Floor	Chipping, Contact	Positive	N/A	N/A	N/A	Criterion	2/13/2020	RRP lead paint stabilization	Buttonwood	n/a	CJ Karoly	YES	RRP wipes	see above	n/a	CJ KAROLY EPA LEAD INSPECTOR	2/15/20
305	1	B	S																			

Andrew Morrison ES EPA Checklist

[illegible]

Appendix C. Oversight Table

Andrew Morrison ES
Oversight

Task ID	E l e m e n t	F l o o r	Space # (on Floor Plan)	On Site Room Name	Primary Component	Description of Paint and Plaster Damage - Primary Component	Primary Component (positive/negative)	Additional Component	Description of Paint and Plaster Damage - Additional Component	Additional Component XRF (positive/negative)	Date Mold DDC Issued	Date Asbestos DDC Issued	Miscellaneous Items (e.g. missing/stained ceiling tiles, steam leaks, missing lens covers, buckled floors, etc.)	Date Notified FAC	Pre-Cleaning Completed (date)	Contents Moved (date)	Work Area Prepped (date)	Surfaces Stabilized (date)	Contents Back in Place (date)	Final Inspection Approval and Photos (date)	Square Footage of Work Area	Number of Required RRP Wipes	Number of Colorimetric Wipes Used to Pass	Final Colorimetric Wipe Submitted for AAS Analysis (yes/no)	AAS Analysis Results
1	1	1	101B	Girls Restroom next to Classroom 102	Ceiling	Cracking	Positive	N/A	N/A	N/A	N/A	N/A	N/A	prior	prior	prior	2/23/2020	2/23/2020		2/23/2020	250	8	1	yes	<5 µg/ft2
2	1	1	102	Classroom 102	W 1	Damaged Plaster	Positive	N/A	N/A	N/A	N/A	N/A	N/A	prior	prior	prior	3/2/2020	3/5/2020		3/5/2020	400	10	1	yes	<5 µg/ft2
3	1	1	102	Classroom 102	W2	Cracking	Positive	N/A	N/A	N/A	N/A	N/A	N/A	prior	prior	prior	3/2/2020	3/5/2020		3/5/2020	see above	see above	see above	see above	see above
4	1	1	102	Classroom 102	W4	N/A	N/A	Columns	Cracking	Positive	N/A	N/A	N/A	prior	prior	prior	3/2/2020	3/5/2020		3/5/2020	see above	see above	see above	see above	see above
5	1	1	102A	Classroom 102 Storage	W2	Cracking	Positive	N/A	N/A	N/A	N/A	N/A	N/A	prior	prior	prior	3/2/2020	3/5/2020		3/5/2020	80	12	2	yes	Initial: 10.17 µg/ft2, Retest: <5 µg/ft2
6	1	1	102A	Classroom 102 Storage	W4	Cracking	Positive	N/A	N/A	N/A	N/A	N/A	N/A	prior	prior	prior	3/2/2020	3/5/2020		3/5/2020	see above	see above	see above	see above	see above
7	1	1	103	Classroom 103	W 1	Cracking	Positive	N/A	N/A	N/A	N/A	N/A	N/A	prior	prior	prior	3/2/2020	3/5/2020		3/5/2020	400	14	1	yes	<5 µg/ft2
8	1	1	103	Classroom 103	W3	Cracking	Positive	N/A	N/A	N/A	N/A	N/A	N/A	prior	prior	prior	3/2/2020	3/5/2020		3/5/2020	see above	see above	see above	see above	see above
9	1	1	103	Classroom 103	W3	N/A	N/A	Columns	Cracking	Positive	N/A	N/A	N/A	prior	prior	prior	3/2/2020	3/5/2020		3/5/2020	see above	see above	see above	see above	see above
10	1	1	103	Classroom 103	Ceiling	Flaking	Positive	N/A	N/A	N/A	N/A	N/A	N/A	prior	prior	prior	3/2/2020	3/5/2020		3/5/2020	see above	see above	see above	see above	see above
11	1	1	103AA	Classroom 103 Storage Foyer	W3	Cracking	Positive	N/A	N/A	N/A	N/A	N/A	N/A	prior	prior	prior	3/2/2020	3/5/2020		3/5/2020	80	8	1	yes	<5 µg/ft2
12	1	1	104	Classroom 104	W 1	Cracking, Flaking	Positive	N/A	N/A	N/A	N/A	N/A	N/A	prior	prior	prior	3/2/2020	3/5/2020		3/5/2020	400	14	1	yes	<5 µg/ft2
13	1	1	104	Classroom 104	W2	Cracking, Flaking	Positive	N/A	N/A	N/A	N/A	N/A	N/A	prior	prior	prior	3/2/2020	3/5/2020		3/5/2020	see above	see above	see above	see above	see above
14	1	1	104	Classroom 104	W3	Cracking, Flaking	Positive	N/A	N/A	N/A	N/A	N/A	N/A	prior	prior	prior	3/2/2020	3/5/2020		3/5/2020	see above	see above	see above	see above	see above
15	1	1	104	Classroom 104	W3	N/A	N/A	Columns	Flaking	Positive	N/A	N/A	N/A	prior	prior	prior	3/2/2020	3/5/2020		3/5/2020	see above	see above	see above	see above	see above
16	1	1	104	Classroom 104	Ceiling	Flaking	Positive	N/A	N/A	N/A	N/A	N/A	N/A	prior	prior	prior	3/2/2020	3/5/2020		3/5/2020	see above	see above	see above	see above	see above
17	1	1	104A	Classroom 104 Storage	W3	Partially Inaccessible/Cracking	Positive	N/A	N/A	N/A	N/A	N/A	N/A	prior	prior	prior	3/2/2020	3/5/2020		3/5/2020	80	10	1	yes	6.18 µg/ft2
18	1	1	105	Main Office	W 1	Chipping	Positive	N/A	N/A	N/A	N/A	N/A	N/A	prior	prior	prior	4/13/2020	4/16/20		4/20/20	400	10	2	yes	Initial: 12.47 µg/ft2, Retest: 9.51µg/ft2
19	1	1	105	Main Office	W4	Flaking	Positive	N/A	N/A	N/A	N/A	N/A	N/A	prior	prior	prior	4/13/2020	4/16/20		4/20/20	see above	see above	see above	see above	see above
20	1	1	105	Main Office	Ceiling	Efflorescence, Flaking	Positive	N/A	N/A	N/A	N/A	N/A	N/A	prior	prior	prior	4/13/2020	4/16/20		4/20/20	see above	see above	see above	see above	see above
21	1	1	105A	Principal's Office	W 1	Cracking	Positive	N/A	N/A	N/A	N/A	N/A	N/A	prior	prior	prior	4/13/2020	4/16/20		4/20/20	200	20	3	yes	Initial: 25, 67 µg/ft2. 1st Retest: 45 µg/ft2, 2nd Retest: 11.39 µg/ft2, 3rd Retest: <5 µg/ft2
22	1	1	105A	Principal's Office	W3	Cracking	Positive	N/A	N/A	N/A	N/A	N/A	N/A	prior	prior	prior	4/13/2020	4/16/20		4/20/20	see above	see above	see above	see above	see above
23	1	1	105C	Stationery Closet in Main Office	W 1	Cracking/Damaged Plaster	Positive	N/A	N/A	N/A	N/A	N/A	N/A	prior	prior	prior	4/13/2020	4/16/20		4/20/20	100	3	n/a	no	n/a
24	1	1	106/106A	Teacher's Lounge	W2	Cracking	Positive	N/A	N/A	N/A	N/A	N/A	N/A	prior	prior	prior	4/13/2020	4/16/20		4/20/20	600	15	n/a	no	n/a
25	1	1	106/106A	Teacher's Lounge	W3	N/A	N/A	Columns	Cracking	Positive	N/A	N/A	N/A	prior	prior	prior	4/13/2020	4/16/20		4/20/20	see above	see above	n/a	see above	n/a
26	1	1	106/106A	Teacher's Lounge	W3	N/A	N/A	Radiator	Chipping	Positive	N/A	N/A	N/A	prior	prior	prior	4/13/2020	4/16/20		4/20/20	see above	see above	n/a	see above	n/a
27	1	1	107	Classroom 107	W 1	Flaking	Positive	N/A	N/A	N/A	N/A	N/A	N/A	prior	prior	prior	3/9/2020	3/12/20		3/12/20	400	12	1	yes	6.19 µg/ft2
28	1	1	107	Classroom 107	W2	Cracking	Positive	N/A	N/A	N/A	N/A	N/A	N/A	prior	prior	prior	3/9/2020	3/12/20		see above	see above	see above	see above	see above	see above
29	1	1	107	Classroom 107 Coat Room	W2	N/A	N/A	Columns	Flaking	Positive	N/A	N/A	N/A	prior	prior	prior	3/9/2020	3/12/20		see above	see above	see above	see above	see above	see above
30	1	1	107	Classroom 107	W3	Flaking	Positive	N/A	N/A	N/A	N/A	N/A	N/A	prior	prior	prior	3/9/2020	3/12/20		see above	see above	see above	see above	see above	see above
31	1	1	107	Classroom 107	W4	flaking	Positive	N/A	N/A	N/A	N/A	N/A	N/A	prior	prior	prior	3/9/2020	3/12/20		see above	see above	see above	see above	see above	see above
32	1	1	107	Classroom 107	Ceiling	Cracking, Efflorescence	Positive	N/A	N/A	N/A	N/A	N/A	N/A	prior	prior	prior	3/9/2020	3/12/20		see above	see above	see above	see above	see above	see above
33	1	1	107B	Classroom 107 Coat Room	W 1	Cracking, Damaged Plaster	Positive	N/A	N/A	N/A	N/A	N/A	N/A	prior	prior	prior	3/9/2020	3/12/20		3/12/20	80	12	2	yes	Initial: 40.32 µg/ft2, Retest: 7.86 µg/ft2
34	1	1	107B	Classroom 107 Coat Room	W2	Cracking	Positive	N/A	N/A	N/A	N/A	N/A	N/A	prior	prior	prior	3/9/2020	3/12/20		see above	see above	see above	see above	see above	see above
35	1	1	107A	Boy's Restroom next to Classroom 107	Ceiling	Flaking	Positive	N/A	N/A	N/A	N/A	N/A	N/A	prior	prior	prior	2/23/2020	2/23/20		2/23/20	250	24	3	yes	Initial: 21.68 µg/ft2, 1st Retest: 18.46 µg/ft2, 2nd Retest: <5 µg/ft2
36	1	1	108	Classroom 108	W 1	Flaking	Positive	N/A	N/A	N/A	N/A	N/A	N/A	prior	prior	prior	12/27/19	12/30/19		1/2/19	400	10	1	yes	14.09 µg/ft2
37	1	1	108	Classroom 108	W2	Flaking	Positive	N/A	N/A	N/A	N/A	N/A	N/A	prior	prior	prior	12/27/19	12/30/19		see above	see above	see above	see above	see above	see above
38	1	1	108	Classroom 108	W3	Cracking	Positive	N/A	N/A	N/A	N/A	N/A	N/A	prior	prior	prior	12/27/19	12/30/19		see above	see above	see above	see above	see above	see above
39	1	1	108A	Classroom 108 Storage	W3	Efflorescence	Positive	N/A	N/A	N/A	N/A	N/A	N/A	prior	prior	prior	12/27/19	12/30/19		1/2/19	50	3	1	yes	<5 µg/ft2
40	1	1	109A	Auditorium	W 1	Cracking, flaking	Positive	N/A	N/A	N/A	N/A	N/A	N/A	prior	prior	prior	3/30/2020	4/9/2020		4/9/2020	1600	120	12	yes	19.21 µg/ft2, 10.12 µg/ft2, 9.73 µg/ft2, 11.85 µg/ft2; 8.67 µg/ft2, 6.39 µg/ft2, 10.43 µg/ft2, 10.43 µg/ft2; 9.07 µg/ft2, <5 µg/ft2, 5.13 µg/ft2, 5.4 µg/ft2
41	1	1	109A	Auditorium	W3	Crack in Plaster	Positive	N/A	N/A	N/A	N/A	N/A	N/A	prior	prior	prior	3/30/2020	4/9/2020		4/9/2020	see above	see above	see above	see above	see above
42	1	1	109A	Auditorium	W4	Cracking	Positive	N/A	N/A	N/A	N/A	N/A	N/A	prior	prior	prior	3/30/2020	4/9/2020		4/9/2020	see above	see above	see above	see above	see above
43	1	1	109A	Auditorium	Ceiling	Flaking, Cracking	Positive	N/A	N/A	N/A	N/A	N/A	N/A	prior	prior	prior	3/30/2020	4/9/2020		4/9/2020	see above	see above	see above	see above	see above
44	1	1	109S	Stage	W2	Crack in Plaster, Hole in Plaster	Positive	N/A	N/A	N/A	N/A	N/A	N/A	prior	prior	prior	3/30/2020	4/9/2020		4/9/2020	800	20	2	yes	<5 µg/ft2, 8.96 µg/ft2
45	1	1	109S	Stage	W2	N/A	N/A	Radiator	Chipping	Positive	N/A	N/A	N/A	prior	prior	prior	3/30/2020	4/9/2020		4/9/2020	see above	see above	see above	see above	see above
46	1	1	109S	Stage	W3	Cracking	Positive	N/A	N/A	N/A	N/A	N/A	N/A	prior	prior	prior	3/30/2020	4/9/2020		4/9/2020	see above	see above	see above	see above	see above
47	1	1	109S	Stage	W4	N/A	N/A	Radiator	Chipping	Positive	N/A	N/A	N/A	prior	prior	prior	3/30/2020	4/9/2020		4/9/2020	see above	see above	see above	see above	see above
48	1	1	110	Storage to the right of Stage	W 1	Flaking	Positive	N/A	N/A	N/A	N/A	N/A	N/A	prior	prior	prior	4/17	4/23/2020		4/23/2020	250	7	n/a	no	n/a
49	1	1	110	Storage to the right of Stage	W2	Flaking	Positive	N/A	N/A	N/A	N/A	N/A	N/A	prior	prior	prior	4/17	4/23/2020		4/23/2020	see above		n/a	no	n/a

Andrew Morrison ES
Oversight

Task ID	E l e m e n t	F l o o r	Space # (on Floor Plan)	On Site Room Name	Primary Component	Description of Paint and Plaster Damage - Primary Component	Primary Component (positive/negative)	Additional Component	Description of Paint and Plaster Damage - Additional Component	Additional Component XRF (positive/negative)	Date Mold DDC Issued	Date Asbestos DDC Issued	Miscellaneous Items (e.g. missing/stained ceiling tiles, steam leaks, missing lens covers, buckled floors, etc.)	Date Notified FAC	Pre-Cleaning Completed (date)	Contents Moved (date)	Work Area Prepped (date)	Surfaces Stabilized (date)	Contents Back in Place (date)	Final Inspection Approval and Photos (date)	Square Footage of Work Area	Number of Required RRP Wipes	Number of Colorimetric Wipes Used to Pass	Final Colorimetric Wipe Submitted for AAS Analysis (yes/no)	AAS Analysis Results
50	1	1	110	Storage to the right of Stage	W3	Flaking	Positive	N/A	N/A	N/A	N/A	N/A	N/A	prior	prior	prior	4/17	4/23/2020		4/23/2020	see above		n/a	no	n/a
51	1	1	111	Philadelphia Police Office	W3	N/A	N/A	Radiator	Chipping	Positive	N/A	N/A	N/A	prior	prior	prior	4/17	4/23/2020		4/23/2020	250	8	n/a	no	n/a
52	1	1	112	Walkway behind Stage leading to Philadelphia Police Office	W2	Cracking	Positive	N/A	N/A	N/A	N/A	N/A	N/A	prior	prior	prior	4/17	4/23/2020		4/23/2020	600	15	n/a	no	n/a
53	1	1	112	Walkway behind Stage leading to Philadelphia Police Office	W4	Cracking	Positive	N/A	N/A	N/A	N/A	N/A	N/A	prior	prior	prior	4/17	4/23/2020		4/23/2020	see above	see above	n/a	no	n/a
54	1	1	112	Walkway behind Stage leading to Philadelphia Police Office	W4	N/A	N/A	Radiator	Chipping	Positive	N/A	N/A	N/A	prior	prior	prior	4/17	4/23/2020		4/23/2020	see above	see above	n/a	no	n/a
55	1	1	114A	Left side Electrical Equipment/Storage in the Main Hallway across from Main Office	W1	Cracking	Positive	N/A	N/A	N/A	N/A	N/A	N/A	prior	prior	prior	4/6/2020	4/9/2020		4/10/2020	100	3	n/a	no	n/a
56	1	1	114A	Left side Electrical Equipment/Storage in the Main Hallway across from Main Office	W2	Flaking	Positive	N/A	N/A	N/A	N/A	N/A	N/A	prior	prior	prior	4/6/2020	4/9/2020		4/10/2020	see above	see above	n/a	no	n/a
57	1	1	114B	Right side Electrical Equipment/Storage in the Main Hallway across from Main Office	W1	Cracking	Positive	N/A	N/A	N/A	N/A	N/A	N/A	prior	prior	prior	4/6/2020	4/9/2020		4/10/2020	100	3	n/a	no	n/a
58	1	1	114B	Right side Electrical Equipment/Storage in the Main Hallway across from Main Office	W3	Crack in Plaster	Positive	N/A	N/A	N/A	N/A	N/A	N/A	prior	prior	prior	4/6/2020	4/9/2020		4/10/2020	see above	see above	n/a	no	n/a
59	1	1	114B	Right side Electrical Equipment/Storage in the Main Hallway across from Main Office	W4	Holes in Plaster	Positive	N/A	N/A	N/A	N/A	N/A	N/A	prior	prior	prior	4/6/2020	4/9/2020		4/10/2020	see above	see above	n/a	no	n/a
60	1	1	115	Storage in the Main Hallway across from Classroom 104	W3	Partially Inaccessible/Cracking	Positive	N/A	N/A	N/A	N/A	N/A	N/A	prior	prior	prior	4/17/2020	4/19/20		4/20/20	100	3	n/a	no	n/a
61	1	1	115	Storage in the Main Hallway across from Classroom 104	W4	Flaking	Positive	N/A	N/A	N/A	N/A	N/A	N/A	prior	prior	prior	4/17/2020	4/19/20		4/20/20	see above	see above	n/a	no	n/a
62	1	1	115A	Stationery Closet next to Stairwell across from Classroom 103	W4	Damaged Plaster	Positive	N/A	N/A	N/A	N/A	N/A	N/A	prior	prior	prior	4/17/2020	4/19/20		4/20/20	see above	see above	n/a	no	n/a
63	1	1	H11	Main Hallway at Classrooms 102 to 107	W1	Flaking	Positive	N/A	N/A	N/A	N/A	N/A	N/A	prior	prior	prior	3/26/2020	3/30/20		4/2/20	1000	25	n/a	no	n/a
64	1	1	H11	Main Hallway at Classrooms 102 to 107	W1	Flaking	Positive	N/A	N/A	N/A	N/A	N/A	N/A	prior	prior	prior	3/26/2020	3/30/20		4/2/20	see above	see above	n/a	no	n/a
65	1	1	H11	Main Hallway at Classrooms 102 to 107	W2	Flaking	Positive	N/A	N/A	N/A	N/A	N/A	N/A	prior	prior	prior	3/26/2020	3/30/20		4/2/20	see above	see above	n/a	no	n/a
66	1	1	H11	Main Hallway at Classrooms 102 to 107	W3	N/A	N/A	Columns	Flaking, Damaged Plaster	Positive	N/A	N/A	N/A	prior	prior	prior	3/26/2020	3/30/20		4/2/20	see above	see above	n/a	no	n/a
67	1	1	H11	Main Hallway at Classrooms 102 to 107	Ceiling	Flaking	Positive	N/A	N/A	N/A	N/A	N/A	N/A	prior	prior	prior	3/26/2020	3/30/20		4/2/20	see above	see above	n/a	no	n/a
68	1	1	H12	Hallway in front of Classroom 108	W2	Chipping	Positive	N/A	N/A	N/A	N/A	N/A	N/A	prior	prior	prior	4/1/2020	4/2/2020		4/2/2020	600	20	n/a	no	n/a
69	1	1	H13	Hallway in front of Nurse's Office	W4	Cracking	Positive	N/A	N/A	N/A	N/A	N/A	N/A	prior	prior	prior	3/11/2020	3/11/2020		3/11/2020	100	5	n/a	no	n/a
70	1	1	S11	Stairwell on Girls Restroom side	W1	Scratched	Positive	N/A	N/A	N/A	N/A	N/A	N/A	prior	prior	prior	3/4/2020	3/6/2020		3/6/2020	600	20	n/a	no	n/a
71	1	1	S11	Stairwell on Girls Restroom side	Floor	N/A	N/A	Stair riser	Chipping, Contact	Positive	N/A	N/A	N/A	prior	prior	prior	3/4/2020	3/6/2020		3/6/2020	see above	see above	n/a	no	n/a
72	1	1	S11	Stairwell on Girls Restroom side	Floor	N/A	N/A	Newel posts	Chipping, Contact	Positive	N/A	N/A	N/A	prior	prior	prior	3/4/2020	3/6/2020		3/6/2020	see above	see above	n/a	no	n/a
73	1	1	S11-EF	Exit Foyer in Middle Landing at Stairwell on Girls Restroom side	W2	N/A	N/A	Baseboard	Chipping	Positive	N/A	N/A	N/A	prior	prior	prior	3/11/2020	3/12/2020		3/13/2020	100	3	n/a	no	n/a
74	1	1	S11-EF	Exit Foyer in Middle Landing at Stairwell on Girls Restroom side	W4	Cracking	Positive	N/A	N/A	N/A	N/A	N/A	N/A	prior	prior	prior	3/11/2020	3/12/2020		3/13/2020	see above	see above	n/a	no	n/a
75	1	1	S11-EF	Exit Foyer in Middle Landing at Stairwell on Girls Restroom side	W4	Cracking	Positive	N/A	N/A	N/A	N/A	N/A	N/A	prior	prior	prior	3/11/2020	3/12/2020		3/13/2020	see above	see above	n/a	no	n/a
76	1	1	S12	Stairwell across from Classroom 108	W1	Chipping	Positive	N/A	N/A	N/A	N/A	N/A	N/A	prior	prior	prior	1/21/20	1/22/20		1/24/20	800	22	n/a	no	n/a
77	1	1	S12	Stairwell across from Classroom 108	Floor	N/A	N/A	Stair riser	Chipping, Contact	Positive	N/A	N/A	N/A	prior	prior	prior	1/21/20	1/22/20		1/24/20	see above	see above	n/a	no	n/a
78	1	1	S12	Stairwell across from Classroom 108	Floor	N/A	N/A	Newel posts	Chipping, Contact	Positive	N/A	N/A	N/A	prior	prior	prior	1/21/20	1/22/20		1/24/20	see above	see above	n/a	no	n/a
79	1	1	S12-EF	Exit Foyer in Middle Landing at Stairwell across from Classroom 108	W2	N/A	N/A	Baseboard	Chipping	Positive	N/A	N/A	N/A	prior	prior	prior	1/21/2020	1/22/2020		1/22/2020	800	4	n/a	no	n/a
80	1	1	S12-EF	Exit Foyer in Middle Landing at Stairwell across from Classroom 108	W4	N/A	N/A	Baseboard	Chipping	Positive	N/A	N/A	N/A	prior	prior	prior	1/21/2020	1/22/2020		1/22/2020	see above	see above	n/a	no	n/a
81	1	1	S3	Fire Tower near Classroom 108 at Element #2	W1	Cracking, Efflorescence	Positive	N/A	N/A	N/A	N/A	N/A	N/A	prior	prior	prior	1/21/20	1/21/20		1/22/20	800	20	n/a	no	n/a
82	1	1	S3	Fire Tower near Classroom 108 at Element #2	W2	Cracking	Positive	N/A	N/A	N/A	N/A	N/A	N/A	prior	prior	prior	1/21/20	1/21/20		1/22/20	see above	see above	n/a	no	n/a
83	1	1	S3	Fire Tower near Classroom 108 at Element #2	W3	Cracking, Efflorescence	Positive	N/A	N/A	N/A	N/A	N/A	N/A	prior	prior	prior	1/21/20	1/21/20		1/22/20	see above	see above	n/a	no	n/a
84	1	1	S3	Fire Tower near Classroom 108 at Element #2	W3	N/A	N/A	Pipe	Flaking	Positive	N/A	N/A	N/A	prior	prior	prior	1/21/20	1/21/20		1/22/20	see above	see above	n/a	no	n/a
85	1	1	S3	Fire Tower near Classroom 108 at Element #2	W4	Cracking, Efflorescence	Positive	N/A	N/A	N/A	N/A	N/A	N/A	prior	prior	prior	1/21/20	1/21/20		1/22/20	see above	see above	n/a	no	n/a
86	1	2	201	Classroom 201	W1	Cracking	Positive	N/A	N/A	N/A	N/A	N/A	N/A	prior	prior	prior	2/3/20	2/5/20		2/6/20	800	20	n/a	no	n/a
87	1	2	201	Classroom 201	W2	Flaking, Damaged Plaster	Positive	N/A	N/A	N/A	N/A	N/A	N/A	prior	prior	prior	2/3/20	2/5/20		2/6/20	see above	see above	n/a	no	n/a
88	1	2	201	Classroom 201	W3	Cracking	Positive	N/A	N/A	N/A	N/A	N/A	N/A	prior	prior	prior	2/3/20	2/5/20		2/6/20	see above	see above	n/a	no	n/a
89	1	2	201	Classroom 201	W3	N/A	N/A	Columns	Chipping	Positive	N/A	N/A	N/A	prior	prior	prior	2/3/20	2/5/20		2/6/20	see above	see above	n/a	no	n/a
90	1	2	201	Classroom 201	W4	Cracking	Positive	N/A	N/A	N/A	N/A	N/A	N/A	prior	prior	prior	2/3/20	2/5/20		2/6/20	see above	see above	n/a	no	n/a
91	1	2	201A	Office 201A next to Classroom 201	W2	Cracking	Positive	N/A	N/A	N/A	N/A	N/A	N/A	prior	prior	prior	2/5/2020	2/6/20		2/7/20	300	10	n/a	no	n/a
92	1	2	201A	Office 201A next to Classroom 201	W3	Cracking	Positive	N/A	N/A	N/A	N/A	N/A	N/A	prior	prior	prior	2/5/2020	2/6/20		2/7/20	see above	see above	n/a	no	n/a
93	1	2	201A	Office 201A next to Classroom 201	W4	Cracking	Positive	N/A	N/A	N/A	N/A	N/A	N/A	prior	prior	prior	2/5/2020	2/6/20		2/7/20	see above	see above	n/a	no	n/a
94	1	2	201A	Office 201A next to Classroom 201	Ceiling	Efflorescence, Flaking	Positive	N/A	N/A	N/A	N/A	N/A	N/A	prior	prior	prior	2/5/2020	2/6/20		2/7/20	see above	see above	n/a	no	n/a
95	1	2	202	Classroom 202	W1	Cracking, Damaged Plaster	Positive	N/A	N/A	N/A	N/A	N/A	N/A	prior	prior	prior	2/3/20	2/5/20		2/6/20	800	20	n/a	no	n/a
96	1	2	202	Classroom 202	W2	Cracking	Positive	N/A	N/A	N/A	N/A	N/A	N/A	prior	prior	prior	2/3/20	2/5/20		2/6/20	see above	see above	n/a	no	n/a
97	1	2	202	Classroom 202	W3	Cracking	Positive	N/A	N/A	N/A	N/A	N/A	N/A	prior	prior	prior	2/3/20	2/5/20		2/6/20	see above	see above	n/a	no	n/a
98	1	2	202	Classroom 202	W4	Cracking	Positive	N/A	N/A	N/A	N/A	N/A	N/A	prior	prior	prior	2/3/20	2/5/20		2/6/20	see above	see above	n/a	no	n/a
99	1	2	202	Classroom 202	Ceiling	Flaking	Positive	N/A	N/A	N/A	N/A	N/A	N/A	prior	prior	prior	2/3/20	2/5/20		2/6/20	see above	see above	n/a	no	n/a
100	1	2	203	Classroom 203	W1	Cracking	Positive	N/A	N/A	N/A	N/A	N/A	N/A	prior	prior	prior	2/3/20	2/4/20		2/6/20	800	24	n/a	no	n/a
101	1	2	203	Classroom 203	W2	Cracking	Positive	N/A	N/A	N/A	N/A	N/A	N/A	prior	prior	prior	2/3/20	2/4/20		2/6/20	see above	see above	n/a	no	n/a
102	1	2	203	Classroom 203	W3	Cracking	Positive	N/A	N/A	N/A	N/A	N/A	N/A	prior	prior	prior	2/3/20	2/4/20		2/6/20	see above	see above	n/a	no	n/a
103	1	2	203	Classroom 203	W3	N/A	N/A	Columns	Cracking, Damaged Plaster	Positive	N/A	N/A	N/A	prior	prior	prior	2/3/20	2/4/20		2/6/20	see above	see above	n/a	no	n/a
104	1	2	203	Classroom 203	Ceiling	Efflorescence	Positive	N/A	N/A	N/A	N/A	N/A	N/A	prior	prior	prior	2/3/20	2/4/20		2/6/20	see above	see above	n/a	no	n/a
105	1	2	204	Classroom 204	W1	Cracking	Positive	N/A	N/A	N/A	N/A	N/A	N/A	prior	prior	prior	2/10/2020	2/12/20		2/14/20	800	20	n/a	no	n/a
106	1	2	204	Classroom 204	W2	Cracking, Damaged Plaster	Positive	N/A	N/A	N/A	N/A	N/A	N/A	prior	prior	prior	2/10/2020	2/12/20		2/14/20	see above	see above	n/a	no	n/a
107	1	2	204	Classroom 204	W3	N/A	N/A	Columns	Chipping, Cracking	Positive	N/A	N/A	N/A	prior	prior	prior	2/10/2020	2/12/20		2/14/20	see above	see above	n/a	no	n/a
108	1	2	204	Classroom 204	W4	Cracking	Positive	N/A	N/A	N/A	N/A	N/A	N/A	prior	prior	prior	2/10/2020	2/12/20		2/14/20	see above	see above	n/a	no	n/a
109	1	2	204	Classroom 204	Ceiling	Flaking	Positive	N/A	N/A	N/A	N/A	N/A	N/A	prior	prior	prior	2/10/2020	2/12/20		2/14/20	see above	see above	n/a	no	n/a

Andrew Morrison ES
Oversight

Task ID	Element	Fl oor	Space # (on Floor Plan)	On Site Room Name	Primary Component	Description of Paint and Plaster Damage - Primary Component	Primary Component (positive/negative)	Additional Component	Description of Paint and Plaster Damage - Additional Component	Additional Component XRF (positive/negative)	Date Mold DDC Issued	Date Asbestos DDC Issued	Miscellaneous Items (e.g. missing/stained ceiling tiles, steam leaks, missing lens covers, buckled floors, etc.)	Date Notified FAC	Pre-Cleaning Completed (date)	Contents Moved (date)	Work Area Prepped (date)	Surfaces Stabilized (date)	Contents Back in Place (date)	Final Inspection Approval and Photos (date)	Square Footage of Work Area	Number of Required RRP Wipes	Number of Colorimetric Wipes Used to Pass	Final Colorimetric Wipe Submitted for AAS Analysis (yes/no)	AAS Analysis Results
110	1	2	204A	Office 204A	W1	Cracking	Positive	N/A	N/A	N/A	N/A	N/A	N/A	prior	prior	prior	2/10/2020	2/12/20		2/14/20	400	10	n/a	no	n/a
111	1	2	204A	Office 204A	W2	Cracking	Positive	N/A	N/A	N/A	N/A	N/A	N/A	prior	prior	prior	2/10/2020	2/12/20		2/14/20	see above	see above	n/a	no	n/a
112	1	2	204A	Office 204A	W3	Cracking	Positive	N/A	N/A	N/A	N/A	N/A	N/A	prior	prior	prior	2/10/2020	2/12/20		2/14/20	see above	see above	n/a	no	n/a
113	1	2	204A	Office 204A	W4	Cracking	Positive	N/A	N/A	N/A	N/A	N/A	N/A	prior	prior	prior	2/10/2020	2/12/20		2/14/20	see above	see above	n/a	no	n/a
114	1	2	204B	Restroom in Office 204A	W2	N/A	N/A	Baseboard	Cracking	Positive	N/A	N/A	N/A	prior	prior	prior	2/10/2020	2/12/20		2/14/20	80	4	n/a	no	n/a
115	1	2	204B	Restroom in Office 204A	W3	Cracking	Positive	N/A	N/A	N/A	N/A	N/A	N/A	prior	prior	prior	2/10/2020	2/12/20		2/14/20	see above	see above	n/a	no	n/a
116	1	2	205	Classroom 205	W1	Cracking, Chipping, Damaged Plaster	Positive	N/A	N/A	N/A	N/A	N/A	N/A	prior	prior	prior	2/10/2020	2/12/20		2/14/20	800	25	n/a	no	n/a
117	1	2	205	Classroom 205	W2	Cracking	Positive	N/A	N/A	N/A	N/A	N/A	N/A	prior	prior	prior	2/10/2020	2/12/20		2/14/20	see above	see above	n/a	no	n/a
118	1	2	205	Classroom 205	W3	Cracking	Positive	N/A	N/A	N/A	N/A	N/A	N/A	prior	prior	prior	2/10/2020	2/12/20		2/14/20	see above	see above	n/a	no	n/a
119	1	2	205	Classroom 205	W4	Cracking	Positive	N/A	N/A	N/A	N/A	N/A	N/A	prior	prior	prior	2/10/2020	2/12/20		2/14/20	see above	see above	n/a	no	n/a
120	1	2	205A	Classroom 205 Storage	W1	Partially Inaccessible/Cracking	Positive	N/A	N/A	N/A	N/A	N/A	N/A	prior	prior	prior	2/10/2020	2/12/20		2/14/20	100	3	n/a	no	n/a
121	1	2	205A	Classroom 205 Storage	W3	Partially Inaccessible/Cracking	Positive	N/A	N/A	N/A	N/A	N/A	N/A	prior	prior	prior	2/10/2020	2/12/20		2/14/20	see above	see above	n/a	no	n/a
122	1	2	205A	Classroom 205 Storage	W4	Partially Inaccessible/Efflorescence	Positive	N/A	N/A	N/A	N/A	N/A	N/A	prior	prior	prior	2/10/2020	2/12/20		2/14/20	see above	see above	n/a	no	n/a
123	1	2	206	Classroom 206	W1	Flaking, Damaged Plaster	Positive	N/A	N/A	N/A	N/A	N/A	N/A	prior	prior	prior	2/10/2020	2/12/20		2/14/20	800	25	n/a	no	n/a
124	1	2	206	Classroom 206	W3	Flaking	Positive	N/A	N/A	N/A	N/A	N/A	N/A	prior	prior	prior	2/10/2020	2/12/20		2/14/20	see above	see above	n/a	no	n/a
125	1	2	206	Classroom 206	Ceiling	Flaking	Positive	N/A	N/A	N/A	N/A	N/A	N/A	prior	prior	prior	2/10/2020	2/12/20		2/14/20	see above	see above	n/a	no	n/a
126	1	2	207	Classroom 207	W1	Cracking	Positive	N/A	N/A	N/A	N/A	N/A	N/A	prior	prior	prior	2/17/2020	2/19/2020		2/20/2020	800	20	n/a	no	n/a
127	1	2	207	Classroom 207	W1	N/A	N/A	Columns	Damaged Plaster	Positive	N/A	N/A	N/A	prior	prior	prior	2/17/2020	2/19/2020		2/20/2020	see above	see above	n/a	no	n/a
128	1	2	207	Classroom 207	W2	Spalling, Cracking	Positive	N/A	N/A	N/A	N/A	N/A	N/A	prior	prior	prior	2/17/2020	2/19/2020		2/20/2020	see above	see above	n/a	no	n/a
129	1	2	207	Classroom 207	W2	N/A	N/A	Columns	Efflorescence	Positive	N/A	N/A	N/A	prior	prior	prior	2/17/2020	2/19/2020		2/20/2020	see above	see above	n/a	no	n/a
130	1	2	207	Classroom 207	W3	Cracking	Positive	N/A	N/A	N/A	N/A	N/A	N/A	prior	prior	prior	2/17/2020	2/19/2020		2/20/2020	see above	see above	n/a	no	n/a
131	1	2	207	Classroom 207	W4	Cracking	Positive	N/A	N/A	N/A	N/A	N/A	N/A	prior	prior	prior	2/17/2020	2/19/2020		2/20/2020	see above	see above	n/a	no	n/a
132	1	2	207	Classroom 207	Ceiling	Efflorescence, Flaking	Positive	N/A	N/A	N/A	N/A	N/A	N/A	prior	prior	prior	2/17/2020	2/19/2020		2/20/2020	see above	see above	n/a	no	n/a
133	1	2	207A	Boy's Restroom next to Room 207	W3	Flaking	Positive	N/A	N/A	N/A	N/A	N/A	N/A	prior	prior	prior	2/21/2020	2/21/20		2/21/20	250	8	n/a	no	n/a
134	1	2	207A	Boy's Restroom next to Room 207	W4	Flaking	Positive	N/A	N/A	N/A	N/A	N/A	N/A	prior	prior	prior	2/21/2020	2/21/20		2/21/20	see above	see above	n/a	no	n/a
135	1	2	207B	Classroom 207 Storage	W1	Damaged Plaster	Positive	N/A	N/A	N/A	N/A	N/A	N/A	prior	prior	prior	2/17/2020	2/19/2020		2/20/2020	100	4	n/a	no	n/a
136	1	2	208	Classroom 208	W1	Cracking, Chipping	Positive	N/A	N/A	N/A	N/A	N/A	N/A	prior	prior	prior	2/17/2020	2/19/2020		2/20/2020	800	25	n/a	no	n/a
137	1	2	208	Classroom 208	W2	Chipping	Positive	N/A	N/A	N/A	N/A	N/A	N/A	prior	prior	prior	2/17/2020	2/19/2020		2/20/2020	see above	see above	n/a	no	n/a
138	1	2	208	Classroom 208	W3	Cracking	Positive	N/A	N/A	N/A	N/A	N/A	N/A	prior	prior	prior	2/17/2020	2/19/2020		2/20/2020	see above	see above	n/a	no	n/a
139	1	2	208	Classroom 208	W3	N/A	N/A	Columns	Chipping, Cracking	Positive	N/A	N/A	N/A	prior	prior	prior	2/17/2020	2/19/2020		2/20/2020	see above	see above	n/a	no	n/a
140	1	2	208	Classroom 208	W4	Cracking	Positive	N/A	N/A	N/A	N/A	N/A	N/A	prior	prior	prior	2/17/2020	2/19/2020		2/20/2020	see above	see above	n/a	no	n/a
141	1	2	208	Classroom 208	Ceiling	Flaking	Positive	N/A	N/A	N/A	N/A	N/A	N/A	prior	prior	prior	2/17/2020	2/19/2020		2/20/2020	see above	see above	n/a	no	n/a
142	1	2	208A	Classroom 208 Storage	W2	Cracking	Positive	N/A	N/A	N/A	N/A	N/A	N/A	prior	prior	prior	2/17/2020	2/19/2020		2/20/2020	100	4	n/a	no	n/a
143	1	2	208A	Classroom 208 Storage	W3	Spalling, Cracking	Positive	N/A	N/A	N/A	N/A	N/A	N/A	prior	prior	prior	2/17/2020	2/19/2020		2/20/2020	see above	see above	n/a	no	n/a
144	1	2	208A	Classroom 208 Storage	W4	Damaged Plaster	Positive	N/A	N/A	N/A	N/A	N/A	N/A	prior	prior	prior	2/17/2020	2/19/2020		2/20/2020	see above	see above	n/a	no	n/a
145	1	2	211	Walkway to Office 212	W2	Cracking, Flaking, Damaged Plaster	Positive	N/A	N/A	N/A	N/A	N/A	N/A	prior	prior	prior	2/24/2020	2/28/2020		3/2/2020	800	25	n/a	no	n/a
146	1	2	211	Walkway to Office 212	W3	Cracking	Positive	N/A	N/A	N/A	N/A	N/A	N/A	prior	prior	prior	2/24/2020	2/28/2020		3/2/2020	see above	see above	n/a	no	n/a
147	1	2	211	Walkway to Office 212	W4	Cracking, Flaking, Damaged Plaster	Positive	N/A	N/A	N/A	N/A	N/A	N/A	prior	prior	prior	2/24/2020	2/28/2020		3/2/2020	see above	see above	n/a	no	n/a
148	1	2	212	Office 212	W1	Cracking	Positive	N/A	N/A	N/A	N/A	N/A	N/A	prior	prior	prior	2/24/2020	2/26/2020		3/2/2020	400	15	n/a	no	n/a
149	1	2	212	Office 212	W3	Cracking	Positive	N/A	N/A	N/A	N/A	N/A	N/A	prior	prior	prior	2/24/2020	2/26/2020		3/2/2020	see above	see above	n/a	no	n/a
150	1	2	212	Office 212	W4	Cracking	Positive	N/A	N/A	N/A	N/A	N/A	N/A	prior	prior	prior	2/24/2020	2/26/2020		3/2/2020	see above	see above	n/a	no	n/a
151	1	2	H21	Main Hallway at Classrooms 202 to 207	W3	N/A	N/A	Columns	Damaged Plaster	Positive	N/A	N/A	N/A	prior	prior	prior	2/12/20	2/13/20		2/14/20	800	20	n/a	no	n/a
152	1	2	H21	Main Hallway at Classrooms 202 to 207	Ceiling	Flaking	Positive	N/A	N/A	N/A	N/A	N/A	N/A	prior	prior	prior	2/12/20	2/13/20		2/14/20	see above	see above	n/a	no	n/a
153	1	2	H23	Hallway in front of Classroom 201	W4	N/A	N/A	Column	Damaged Plaster	Positive	N/A	N/A	N/A	prior	prior	prior	2/12/20	2/13/20		2/14/20	600	15	n/a	no	n/a
154	1	2	S21	Stairwell across from Classroom 201	W1	Cracking	Positive	N/A	N/A	N/A	N/A	N/A	N/A	prior	prior	prior	1/28/20	1/30/20		2/4/20	600	15	n/a	no	n/a
155	1	2	S21	Stairwell across from Classroom 201	W3	Cracking, contact	Positive	N/A	N/A	N/A	N/A	N/A	N/A	prior	prior	prior	1/28/20	1/30/20		2/4/20	see above	see above	n/a	no	n/a
156	1	2	S3	Fire Tower near Classroom 208 at Element #2	W1	Cracking, Efflorescence	Positive	N/A	N/A	N/A	N/A	N/A	N/A	prior	prior	prior	1/21/20	1/21/20		1/23/20	600	16	n/a	no	n/a
157	1	2	S3	Fire Tower near Classroom 208 at Element #2	W2	Cracking	Positive	N/A	N/A	N/A	N/A	N/A	N/A	prior	prior	prior	1/21/20	1/21/20		1/23/20	see above	see above	n/a	no	n/a
158	1	2	S3	Fire Tower near Classroom 208 at Element #2	W3	Cracking, Efflorescence	Positive	N/A	N/A	N/A	N/A	N/A	N/A	prior	prior	prior	1/21/20	1/21/20		1/23/20	see above	see above	n/a	no	n/a
159	1	2	S3	Fire Tower near Classroom 208 at Element #2	W4	Cracking, Efflorescence	Positive	N/A	N/A	N/A	N/A	N/A	N/A	prior	prior	prior	1/21/20	1/21/20		1/23/20	see above	see above	n/a	no	n/a
160	1	3	301	Classroom 301	W1	Cracking	Positive	N/A	N/A	N/A	N/A	N/A	N/A	prior	prior	prior	12/30/19	12/31/19		1/2/19	400	10	n/a	no	n/a
161	1	3	301	Classroom 301	W3	Flaking	Positive	N/A	N/A	N/A	N/A	N/A	N/A	prior	prior	prior	12/30/19	12/31/19		1/2/19	see above	see above	n/a	no	n/a
162	1	3	301	Classroom 301	W3	N/A	N/A	Columns	Cracking	Positive	N/A	N/A	N/A	prior	prior	prior	12/30/19	12/31/19		1/2/19	see above	see above	n/a	no	n/a
163	1	3	301	Classroom 301	W3	N/A	N/A	Radiator	Chipping	Positive	N/A	N/A	N/A	prior	prior	prior	12/30/19	12/31/19		1/2/19	see above	see above	n/a	no	n/a
164	1	3	301	Classroom 301	W4	Cracking	Positive	N/A	N/A	N/A	N/A	N/A	N/A	prior	prior	prior	12/30/19	12/31/19		1/2/19	see above	see above	n/a	no	n/a
165	1	3	301	Classroom 301	Ceiling	Flaking	Positive	N/A	N/A	N/A	N/A	N/A	N/A	prior	prior	prior	12/30/19	12/31/19		1/2/19	see above	see above	n/a	no	n/a
166	1	3	301A	Office 301A	W2	Cracking	Positive	N/A	N/A	N/A				prior	prior	prior	1/20/20	1/22/20		1/23/20	300	10	n/a	no	n/a
167	1	3	301A	Office 301A	W3	Cracking	Positive	N/A	N/A	N/A	N/A	N/A	N/A	prior	prior	prior	1/20/20	1/22/20		1/23/20	see above	see above	n/a	no	n/a
168	1	3	301A	Office 301A	W4	Cracking	Positive	N/A	N/A	N/A	N/A	N/A	N/A	prior	prior	prior	1/20/20	1/22/20		1/23/20	see above	see above	n/a	no	n/a
169	1	3	301C	Girl's Restroom next to Classroom 301	W2	Cracking	Positive	N/A	N/A	N/A	N/A	N/A	N/A	prior	prior	prior	1/20/20	1/22/20		1/23/20	50	4	n/a	no	n/a

Andrew Morrison ES
Oversight

Task ID	Element	Floor	Space # (on Floor Plan)	On Site Room Name	Primary Component	Description of Paint and Plaster Damage - Primary Component	Primary Component (positive/negative)	Additional Component	Description of Paint and Plaster Damage - Additional Component	Additional Component XRF (positive/negative)	Date Mold DDC Issued	Date Asbestos DDC Issued	Miscellaneous Items (e.g. missing/stained ceiling tiles, steam leaks, missing lens covers, buckled floors, etc.)	Date Notified FAC	Pre-Cleaning Completed (date)	Contents Moved (date)	Work Area Prepped (date)	Surfaces Stabilized (date)	Contents Back in Place (date)	Final Inspection Approval and Photos (date)	Square Footage of Work Area	Number of Required RRP Wipes	Number of Colorimetric Wipes Used to Pass	Final Colorimetric Wipe Submitted for AAS Analysis (yes/no)	AAS Analysis Results
170	1	3	301C	Girls Restroom next to Classroom 301	W3	Cracking, Spalling	Positive	N/A	N/A	N/A	N/A	N/A	N/A	prior	prior	prior	1/20/20	1/22/20		1/23/20	see above	see above	n/a	no	n/a
171	1	3	301D	Storage 301D	W4	Cracking	Positive	N/A	N/A	N/A	N/A	N/A	N/A	prior	prior	prior	1/13/2020	1/14/20		1/15/20	250	10	n/a	no	n/a
172	1	3	302	Classroom 302	W1	Flaking, Crack in plaster	Positive	N/A	N/A	N/A	N/A	N/A	N/A	prior	prior	prior	12/30/19	12/31/19		1/2/20	400	12	n/a	no	n/a
173	1	3	302	Classroom 302	W4	Cracking	Positive	N/A	N/A	N/A	N/A	N/A	N/A	prior	prior	prior	12/30/19	12/31/19		1/2/20	see above	see above	n/a	no	n/a
174	1	3	303	Classroom 303	W1	Cracking, Chipping	Positive	N/A	N/A	N/A	N/A	N/A	N/A	prior	prior	prior	12/30/19	12/31/19		1/2/20	400	10	n/a	no	n/a
175	1	3	303	Classroom 303	W2	Cracking, Chipping	Positive	N/A	N/A	N/A	N/A	N/A	N/A	prior	prior	prior	12/30/19	12/31/19		1/2/20	see above	see above	n/a	no	n/a
176	1	3	303	Classroom 303	W3	Cracking, Chipping	Positive	N/A	N/A	N/A	N/A	N/A	N/A	prior	prior	prior	12/30/19	12/31/19		1/2/20	see above	see above	n/a	no	n/a
177	1	3	303	Classroom 303	W3	N/A	N/A	Columns	Flaking, Cracking, Chipping	Positive	N/A	N/A	N/A	prior	prior	prior	12/30/19	12/31/19		1/2/20	see above	see above	n/a	no	n/a
178	1	3	303	Classroom 303	W3	N/A	N/A	Radiator	Chipping	Positive	N/A	N/A	N/A	prior	prior	prior	12/30/19	12/31/19		1/2/20	see above	see above	n/a	no	n/a
179	1	3	307	Classroom 307	W1	Cracking	Positive	N/A	N/A	N/A	N/A	N/A	N/A	prior	prior	prior	1/7/20	1/7/20		1/9/20	400	12	n/a	no	n/a
180	1	3	307	Classroom 307	W2	Cracking, Efflorescence	Positive	N/A	N/A	N/A	N/A	N/A	N/A	prior	prior	prior	1/7/20	1/7/20		1/9/20	see above	see above	n/a	no	n/a
181	1	3	307	Classroom 307	W2	N/A	N/A	Columns	Chipping	Positive	N/A	N/A	N/A	prior	prior	prior	1/7/20	1/7/20		1/9/20	see above	see above	n/a	no	n/a
182	1	3	307	Classroom 307	W2	N/A	N/A	Radiator	Chipping	Positive	N/A	N/A	N/A	prior	prior	prior	1/7/20	1/7/20		1/9/20	see above	see above	n/a	no	n/a
183	1	3	307	Classroom 307	W3	Chipping	Positive	N/A	N/A	N/A	N/A	N/A	N/A	prior	prior	prior	1/7/20	1/7/20		1/9/20	see above	see above	n/a	no	n/a
184	1	3	307	Classroom 307	W4	N/A	N/A	Columns	Chipping	Positive	N/A	N/A	N/A	prior	prior	prior	1/7/20	1/7/20		1/9/20	see above	see above	n/a	no	n/a
185	1	3	307A	Boy's Restroom next to Classroom 307	Ceiling	Efflorescence, Spalling, Damaged Plaster	Positive	N/A	N/A	N/A	N/A	N/A	N/A	prior	prior	prior	1/14	1/14/20		1/14/20	160	10	n/a	no	n/a
186	1	3	307B	Classroom 307 Storage	W1	Efflorescence	Positive	N/A	N/A	N/A	N/A	N/A	N/A	prior	prior	prior	1/7/20	1/7/20		1/9/20	80	6	n/a	no	n/a
187	1	3	307B	Classroom 307 Storage	W2	Spalling, Cracking	Positive	N/A	N/A	N/A	N/A	N/A	N/A	prior	prior	prior	1/7/20	1/7/20		1/9/20	see above	see above	n/a	no	n/a
188	1	3	307B	Classroom 307 Storage	Ceiling	Cracking, Damaged Plaster	Positive	N/A	N/A	N/A	N/A	N/A	N/A	prior	prior	prior	1/7/20	1/7/20		1/9/20	see above	see above	n/a	no	n/a
189	1	3	308/308A	Classroom 308	W1	Cracking, Chipping	Positive	N/A	N/A	N/A	N/A	N/A	N/A	prior	prior	prior	1/13/20	1/16/20		1/17/20	400	12	n/a	no	n/a
190	1	3	308/308A	Classroom 308	W2	Cracking	Positive	N/A	N/A	N/A	N/A	N/A	N/A	prior	prior	prior	1/13/20	1/16/20		1/17/20	see above	see above	n/a	no	n/a
191	1	3	308/308A	Classroom 308	W2	N/A	N/A	Radiator	Chipping	Positive	N/A	N/A	N/A	prior	prior	prior	1/13/20	1/16/20		1/17/20	see above	see above	n/a	no	n/a
192	1	3	308/308A	Classroom 308	W3	Cracking, Chipping	Positive	N/A	N/A	N/A	N/A	N/A	N/A	prior	prior	prior	1/13/20	1/16/20		1/17/20	see above	see above	n/a	no	n/a
193	1	3	308/308A	Classroom 308	W3	N/A	N/A	Radiator	Chipping	Positive	N/A	N/A	N/A	prior	prior	prior	1/13/20	1/16/20		1/17/20	see above	see above	n/a	no	n/a
194	1	3	308/308A	Classroom 308	W3	N/A	N/A	Pipe	Chipping	Positive	N/A	N/A	N/A	prior	prior	prior	1/13/20	1/16/20		1/17/20	see above	see above	n/a	no	n/a
195	1	3	308/308A	Classroom 308	W3	N/A	N/A	Columns	Chipping, Damaged plaster	Positive	N/A	N/A	N/A	prior	prior	prior	1/13/20	1/16/20		1/17/20	see above	see above	n/a	no	n/a
196	1	3	308/308A	Classroom 308	W4	Cracking	Positive	N/A	N/A	N/A	N/A	N/A	N/A	prior	prior	prior	1/13/20	1/16/20		1/17/20	see above	see above	n/a	no	n/a
197	1	3	308/308A	Classroom 308	Ceiling	Flaking, Efflorescence, Damaged plaster	Positive	N/A	N/A	N/A	N/A	N/A	N/A	prior	prior	prior	1/13/20	1/16/20		1/17/20	see above	see above	n/a	no	n/a
198	1	3	H31	Main Hallway at Classrooms 302 to 307	W 1	Flaking	Positive	N/A	N/A	N/A	N/A	N/A	N/A	prior	prior	prior	1/7/20	1/10/20		1/12/20	1600	50	n/a	no	n/a
199	1	3	H31	Main Hallway at Classrooms 302 to 307	W1	Flaking	Positive	N/A	N/A	N/A	N/A	N/A	N/A	prior	prior	prior	1/7/20	1/10/20		1/12/20	see above	see above	n/a	no	n/a
200	1	3	H31	Main Hallway at Classrooms 302 to 307	W3	Friction	Positive	N/A	N/A	N/A	N/A	N/A	N/A	prior	prior	prior	1/7/20	1/10/20		1/12/20	see above	see above	n/a	no	n/a
201	1	3	H31	Main Hallway at Classrooms 302 to 307	W4	Damaged plaster	Positive	N/A	N/A	N/A	N/A	N/A	N/A	prior	prior	prior	1/7/20	1/10/20		1/12/20	see above	see above	n/a	no	n/a
202	1	3	H31	Main Hallway at Classrooms 302 to 307	W4	Flaking	Positive	N/A	N/A	N/A				prior	prior	prior	1/7/20	1/10/20		1/12/20	see above	see above	n/a	no	n/a
203	1	3	H31	Main Hallway at Classrooms 302 to 307	Ceiling	Cracking, Flaking, Efflorescence	Positive	N/A	N/A	N/A	N/A	N/A	N/A	prior	prior	prior	1/7/20	1/10/20		1/12/20	see above	see above	n/a	no	n/a
204	1	3	H32	Hallway in front of Classroom 308	W2	Cracking	Positive	N/A	N/A	N/A	N/A	N/A	N/A	prior	prior	prior	1/10/20	1/11/20		1/12/20	1000	25	n/a	no	n/a
205	1	3	H32	Hallway in front of Classroom 308	W4	Cracking	Positive	N/A	N/A	N/A	N/A	N/A	N/A	prior	prior	prior	1/10/20	1/11/20		1/12/20	see above	see above	n/a	no	n/a
206	1	3	H32	Hallway in front of Classroom 308	Ceiling	Cracking, Flaking, Efflorescence	Positive	N/A	N/A	N/A	N/A	N/A	N/A	prior	prior	prior	1/10/20	1/11/20		1/12/20	see above	see above	n/a	no	n/a
207	1	3	S31	Stairwell across from Classroom 301	Ceiling	Efflorescence, Spalling, Flaking	Positive	N/A	N/A	N/A	N/A	N/A	N/A	prior	prior	prior	1/28/2020	1/30/20		2/4/20	800	20	n/a	no	n/a
208	1	3	S33	Fire Tower near Classroom 308 at Element #2	W1	Cracking	Positive	N/A	N/A	N/A	N/A	N/A	N/A	prior	prior	prior	1/21/20	1/21/20		1/23/20	600	18	n/a	no	n/a
209	1	3	S33	Fire Tower near Classroom 308 at Element #2	W2	Cracking	Positive	N/A	N/A	N/A	N/A	N/A	N/A	prior	prior	prior	1/21/20	1/21/20		1/23/20	see above	see above	n/a	no	n/a
210	1	3	S33	Fire Tower near Classroom 308 at Element #2	W3	Cracking, Efflorescence, Flaking	Positive	N/A	N/A	N/A	N/A	N/A	N/A	prior	prior	prior	1/21/20	1/21/20		1/23/20	see above	see above	n/a	no	n/a
211	1	3	S33	Fire Tower near Classroom 308 at Element #2	W4	Cracking, Efflorescence	Positive	N/A	N/A	N/A	N/A	N/A	N/A	prior	prior	prior	1/21/20	1/21/20		1/23/20	see above	see above	n/a	no	n/a
212	1	B	1	Cafeteria	W1	Efflorescence, Flaking	Positive	N/A	N/A	N/A	N/A	N/A	N/A	prior	prior	prior	1/27/2020	1/27/2020		1/27/20	800	20	2	yes	6.87 µg/ft2
213	1	B	1	Cafeteria	W2	Craacking	Positive	N/A	N/A	N/A	N/A	N/A	N/A	prior	prior	prior	1/27/2020	1/27/2020		1/27/20	see above	see above	see above	see above	see above
214	1	B	1	Cafeteria	W3	Efflorescence	Positive	N/A	N/A	N/A	N/A	N/A	N/A	prior	prior	prior	1/27/2020	1/27/2020		1/27/20	see above	see above	see above	see above	see above
215	1	B	1	Cafeteria	W4	Efflorescence	Positive	N/A	N/A	N/A	N/A	N/A	N/A	prior	prior	prior	1/27/2020	1/27/2020		1/27/20	see above	see above	see above	see above	see above
216	1	B	2	Kitchen	W1	Cracking	Positive	N/A	N/A	N/A	N/A	N/A	N/A	prior	prior	prior	4/28/2020	4/28/2020		5/4/20	500	50	3	yes	Initial: 43.01 µg/ft2, 1st Retest: 124.03 µg/ft2, 2nd Retest: <5 µg/ft2
217	1	B	2	Kitchen	W1	Cracking	Positive	N/A	N/A	N/A	N/A	N/A	N/A	prior	prior	prior	4/28/2020	4/28/2020		5/4/20	see above	see above	see above	see above	see above
218	1	B	2	Kitchen	W2	Cracking	Positive	N/A	N/A	N/A	N/A	N/A	N/A	prior	prior	prior	4/28/2020	4/28/2020		5/4/20	see above	see above	see above	see above	see above
219	1	B	2	Kitchen	Ceiling	Cracking	Positive	N/A	N/A	N/A	N/A	N/A	N/A	prior	prior	prior	4/28/2020	4/28/2020		5/4/20	see above	see above	see above	see above	see above
220	1	B	3	Classroom 003	W1	Chipping	Positive	N/A	N/A	N/A	N/A	N/A	N/A	prior	prior	prior	5/1/2020	5/4/20		5/5/20	600	25	n/a	no	n/a
221	1	B	3	Classroom 003	W1	N/A	N/A	Drain Pipe	Cracking	Positive	N/A	N/A	N/A	prior	prior	prior	5/1/2020	5/4/20		5/5/20	see above	see above	n/a	no	n/a
222	1	B	3A	Classroom 003A in Classroom 003	W3	Cracking, Flaking	Positive	N/A	N/A	N/A	N/A	N/A	N/A	prior	prior	prior	5/1/2020	5/4/20		5/5/20	250	8	n/a	no	n/a
223	1	B	3B	Classroom 003B in Classroom 003	W3	Cracking, Flaking	Positive	N/A	N/A	N/A	N/A	N/A	N/A	prior	prior	prior	5/1/2020	5/4/20		5/5/20	see above	see above	n/a	no	n/a
224	1	B	4	Music Storage	Ceiling	Flaking	Positive	N/A	N/A	N/A	N/A	N/A	N/A	prior	prior	prior	5/4/2020	5/4/20		5/5/20	250	10	n/a	no	n/a
225	1	B	5	Storage across from Student Restrooms	Ceiling	Flaking	Positive	N/A	N/A	N/A	N/A	N/A	N/A	prior	prior	prior	5/5/2020	5/6/20		5/6/20	200	6	n/a	no	n/a
226	1	B	5	Storage across from Student Restrooms	Ceiling	N/A	N/A	Ductwork	Flaking	Positive	N/A	N/A	N/A	prior	prior	prior	5/5/2020	5/6/20		5/6/20	see above	see above	n/a	no	n/a
227	1	B	6	Boy's Restroom	W3	Flaking, Efflorescence	Positive	N/A	N/A	N/A	N/A	N/A	N/A	prior	prior	prior	4/20/2020	4/20/2020		4/20/2020	200	6	n/a	no	n/a

Andrew Morrison ES
Oversight

Task ID	Element	Floor	Space # (on Floor Plan)	On Site Room Name	Primary Component	Description of Paint and Plaster Damage - Primary Component	Primary Component (positive/negative)	Additional Component	Description of Paint and Plaster Damage - Additional Component	Additional Component XRF (positive/negative)	Date Mold DDC Issued	Date Asbestos DDC Issued	Miscellaneous Items (e.g. missing/stained ceiling tiles, steam leaks, missing lens covers, buckled floors, etc.)	Date Notified FAC	Pre-Cleaning Completed (date)	Contents Moved (date)	Work Area Prepped (date)	Surfaces Stabilized (date)	Contents Back in Place (date)	Final Inspection Approval and Photos (date)	Square Footage of Work Area	Number of Required RRP Wipes	Number of Colorimetric Wipes Used to Pass	Final Colorimetric Wipe Submitted for AAS Analysis (yes/no)	AAS Analysis Results
228	1	B	7	Girls Restroom next to Classroom B1	W2	Cracking	Positive	N/A	N/A	N/A	N/A	N/A	N/A	prior	prior	prior	4/20/2020	4/20/2020		4/20/2020	400	10	n/a	no	n/a
229	1	B	7	Girls Restroom next to Classroom B1	W3	Cracking, Flaking	Positive	N/A	N/A	N/A	N/A	N/A	N/A	prior	prior	prior	4/20/2020	4/20/2020		4/20/2020	see above	see above	n/a	no	n/a
230	1	B	B1	Classroom B1	W4	N/A	N/A	Pipe Jacket	Cracking	Positive	N/A	4/17/2020	DDC issued for the closet	prior	prior	prior	4/17/2020	4/17/2020		4/17/2020	200	7	1	yes	<5 µg/ft2
231	1	B	B1	Classroom B1	Ceiling	Flaking	Positive	N/A	N/A	N/A	N/A	4/17/2020	DDC issued for the closet	prior	prior	prior	4/17/2020	4/17/2020		4/17/2020	see above	see above	see above	see above	see above
232	1	B	9	Fan Room	W1	Flaking, Cracking	Positive	N/A	N/A	N/A	N/A	5/1/2020													
233	1	B	9	Fan Room	W1	Flaking, Cracking	Positive	N/A	N/A	N/A	N/A	5/1/2020													
234	1	B	9	Fan Room	W1	N/A	N/A	Columns	Flaking	Positive	N/A	5/1/2020													
235	1	B	9	Fan Room	W1	N/A	N/A	Columns	Flaking	Positive	N/A	5/1/2020													
236	1	B	9	Fan Room	W1	N/A	N/A	Columns	Chipping	Positive	N/A	5/1/2020													
237	1	B	9	Fan Room	W2	Flaking, Cracking	Positive	N/A	N/A	N/A	N/A	5/1/2020													
238	1	B	9	Fan Room	W2	Flaking, Cracking	Positive	N/A	N/A	N/A	N/A	5/1/2020													
239	1	B	9	Fan Room	W2	N/A	N/A	Columns	Flaking	Positive	N/A	5/1/2020													
240	1	B	9	Fan Room	W2	N/A	N/A	Columns	Flaking	Positive	N/A	5/1/2020													
241	1	B	9	Fan Room	W3	Flaking, Cracking	Positive	N/A	N/A	N/A	N/A	5/1/2020													
242	1	B	9	Fan Room	W3	Flaking, Cracking	Positive	N/A	N/A	N/A	N/A	5/1/2020													
243	1	B	9	Fan Room	W3	N/A	N/A	Columns	Flaking	Positive	N/A	5/1/2020													
244	1	B	9	Fan Room	W3	N/A	N/A	Columns	Flaking	Positive	N/A	5/1/2020													
245	1	B	9	Fan Room	W4	Flaking, Cracking	Positive	N/A	N/A	N/A	N/A	5/1/2020													
246	1	B	9	Fan Room	W4	Flaking, Cracking	Positive	N/A	N/A	N/A	N/A	5/1/2020													
247	1	B	9	Fan Room	W4	N/A	N/A	Columns	Flaking	Positive	N/A	5/1/2020													
248	1	B	9	Fan Room	W4	N/A	N/A	Columns	Flaking	Positive	N/A	5/1/2020													
249	1	B	9	Fan Room	W4	N/A	N/A	Pipe	Flaking	Positive	N/A	5/1/2020													
250	1	B	9	Fan Room	W4	N/A	N/A	Pipe	Flaking	Positive	N/A	5/1/2020													
251	1	B	9	Fan Room	Ceiling	Flaking	Positive	N/A	N/A	N/A	N/A	5/1/2020													
252	1	B	9	Fan Room	Ceiling	N/A	N/A	Ductwork	Flaking	Positive	N/A	5/1/2020													
253	1	B	9	Fan Room	Ceiling	N/A	N/A	Ductwork	Flaking	Positive	N/A	5/1/2020													
254	1	B	9	Fan Room	Floor	Chipping	Positive	N/A	N/A	N/A	N/A	5/1/2020													
255	1	B	9	Fan Room	Floor	N/A	N/A	AHU	Flaking	Positive	N/A	5/1/2020													
256	1	B	9	Fan Room	Floor	N/A	N/A	Hand rails	Cracking	Positive	N/A	5/1/2020													
257	1	B	9	Fan Room	Floor	N/A	N/A	Stair tread	Cracking	Positive	N/A	5/1/2020													
258	1	B	9	Fan Room	Floor	N/A	N/A	Stair riser	Cracking	Positive	N/A	5/1/2020													
259	1	B	9	Fan Room	Floor	N/A	N/A	Stair tread	Cracking	Positive	N/A	5/1/2020													
260	1	B	9	Fan Room	Floor	N/A	N/A	Stair riser	Cracking	Positive	N/A	5/1/2020													
261	1	B	9	Fan Room	Floor	N/A	N/A	Hand rails	Chipping	Positive	N/A	5/1/2020													
262	1	B	10	Fan Room Storage	W3	N/A	N/A	Window Frame	Chipping	Positive	N/A	5/1/2020													
263	1	B	10	Fan Room Storage	W3	N/A	N/A	Window Mullion	Chipping	Positive	N/A	5/1/2020													
264	1	B	11	Boiler Room	W1	Flaking, Cracking	Positive	N/A	N/A	N/A	N/A	5/1/2020													
265	1	B	11	Boiler Room	W2	Flaking, Cracking	Positive	N/A	N/A	N/A	N/A	5/1/2020													
266	1	B	11	Boiler Room	W3	Flaking, Cracking	Positive	N/A	N/A	N/A	N/A	5/1/2020													
267	1	B	11	Boiler Room	W3	N/A	N/A	Columns	Flaking	Positive	N/A	5/1/2020													
268	1	B	11	Boiler Room	W3	N/A	N/A	Pipe	Flaking	Positive	N/A	5/1/2020													
269	1	B	11	Boiler Room	W3	N/A	N/A	Pipe	Flaking	Positive	N/A	5/1/2020													
270	1	B	11	Boiler Room	W4	Flaking, Cracking	Positive	N/A	N/A	N/A	N/A	5/1/2020													
271	1	B	11	Boiler Room	W4	Flaking, Cracking	Positive	N/A	N/A	N/A	N/A	5/1/2020													
272	1	B	11	Boiler Room	W4	N/A	N/A	Columns	Flaking	Positive	N/A	5/1/2020													
273	1	B	11	Boiler Room	W4	N/A	N/A	Columns	Flaking	Positive	N/A	5/1/2020													
274	1	B	11	Boiler Room	Ceiling	N/A	N/A	Ductwork	Flaking	Positive	N/A	5/1/2020													
275	1	B	12	Water Main Room	W1	Flaking	Positive	N/A	N/A	N/A	N/A	5/1/2020													
276	1	B	12	Water Main Room	W1	N/A	N/A	Columns	Flaking	Positive	N/A	5/1/2020													
277	1	B	12	Water Main Room	W1	N/A	N/A	Columns	Cracking	Positive	N/A	5/1/2020													
278	1	B	12	Water Main Room	W2	Flaking	Positive	N/A	N/A	N/A	N/A	5/1/2020													
279	1	B	12	Water Main Room	W2	Flaking	Positive	N/A	N/A	N/A	N/A	5/1/2020													
280	1	B	12	Water Main Room	W3	Flaking	Positive	N/A	N/A	N/A	N/A	5/1/2020													
281	1	B	12	Water Main Room	W4	Flaking	Positive	N/A	N/A	N/A	N/A	5/1/2020													
282	1	B	14	Music Room	W3	Friction	Positive	N/A	N/A	N/A	N/A	N/A	N/A	prior	prior	prior	5/5/2020	5/5/2020		5/6/2020	250	8	1	yes	<5 µg/ft2
283	1	B	16	Storage room outside Boiler Room	W1	Cracking	Positive	N/A	N/A	N/A	N/A	N/A	N/A	prior	prior	prior	5/5/2020	5/5/2020		5/6/2020	400	15	n/a	no	n/a
284	1	B	16	Storage room outside Boiler Room	W2	Cracking	Positive	N/A	N/A	N/A	N/A	N/A	N/A	prior	prior	prior	5/5/2020	5/5/2020		5/6/2020	see above	see above	n/a	no	n/a
285	1	B	16	Storage room outside Boiler Room	W3	Cracking	Positive	N/A	N/A	N/A	N/A	N/A	N/A	prior	prior	prior	5/5/2020	5/5/2020		5/6/2020	see above	see above	n/a	no	n/a
286	1	B	16	Storage room outside Boiler Room	W4	Cracking	Positive	N/A	N/A	N/A	N/A	N/A	N/A	prior	prior	prior	5/5/2020	5/5/2020		5/6/2020	see above	see above	n/a	no	n/a
287	1	B	H02	Hallway at Music Room 14	W2	Flaking, Cracking	Positive	N/A	N/A	N/A	N/A	N/A	N/A	prior	prior	prior	4/27/2020	4/28/2020		4/29/2020	800	22	n/a	no	n/a

Appendix D. Sample Results Table

Andrew Morrison ES

Sample Results

[illegible]

Appendix E. Photographs

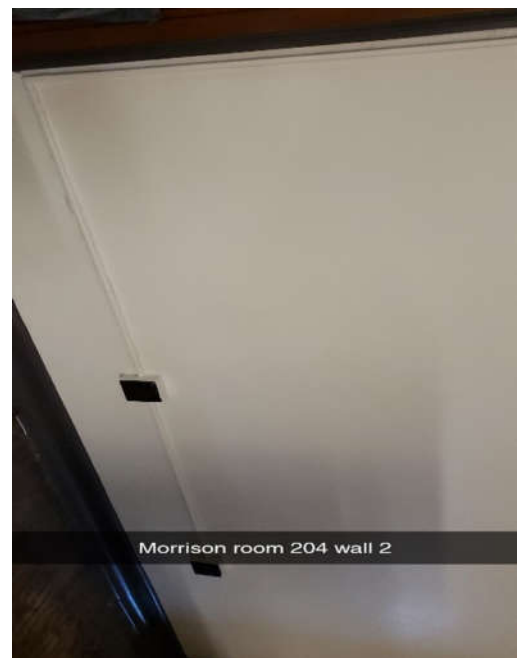



Appendix F. Environmental Firm Certification Documentation of Training

CRITERION LABORATORIES, INC.

400 STREET ROAD, BENSALEM, PA 19020
PHONE: (215) 244-1300, FAX: (215) 244-4349
WWW.CRITERIONLABS.COM

Certificate of Attendance and Successful Completion

Dust Sampling Technician – English
Per 40 CFR Part 745.225

Christopher Karoly

3232 Skippack Pike, Lansdale, PA 19446

Certificate Number: D-I-19014-18-747435

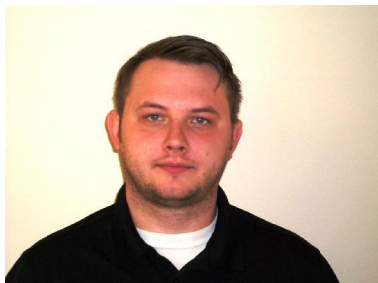

Course Date: 11/20/2018
Examination Date: 11/20/2018
Expiration Date: 11/20/2023

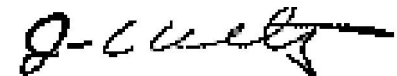

JAMES A. WELTZ, CIH
Training Manager / Principal Instructor

CRITERION LABORATORIES, INC.

400 STREET ROAD, BENSALEM, PA 19020
PHONE: (215) 244-1300, FAX: (215) 244-4349
WWW.CRITERIONLABS.COM

Certificate of Attendance and Successful Completion

Lead RRP Initial – English
Per 40 CFR Part 745.225

Christopher Karoly

3232 Skippack Pike, Lansdale, PA 19446

Certificate Number: R-I-19014-18-747541



Course Date: 12/17/2018
Examination Date: 12/17/2018
Expiration Date: 12/17/2023



JAMES A. WELTZ, CIH
Training Manager / Principal Instructor

Appendix G. Painting Contractor Certifications or Documentation of Training

United States Environmental Protection Agency

This is to certify that



Buttonwood Co., Inc.

has fulfilled the requirements of the Toxic Substances Control Act (TSCA) Section 402, and has received certification to conduct lead-based paint renovation, repair, and painting activities pursuant to 40 CFR Part 745.89

In the Jurisdiction of:

All EPA Administered States, Tribes, and Territories

This certification is valid from the date of issuance and expires March 10, 2021

NAT-86266-2

Certification #

February 24, 2016

Issued On



A handwritten signature in black ink, appearing to read "Michelle Price".

Michelle Price, Chief

Lead, Heavy Metals, and Inorganics Branch