

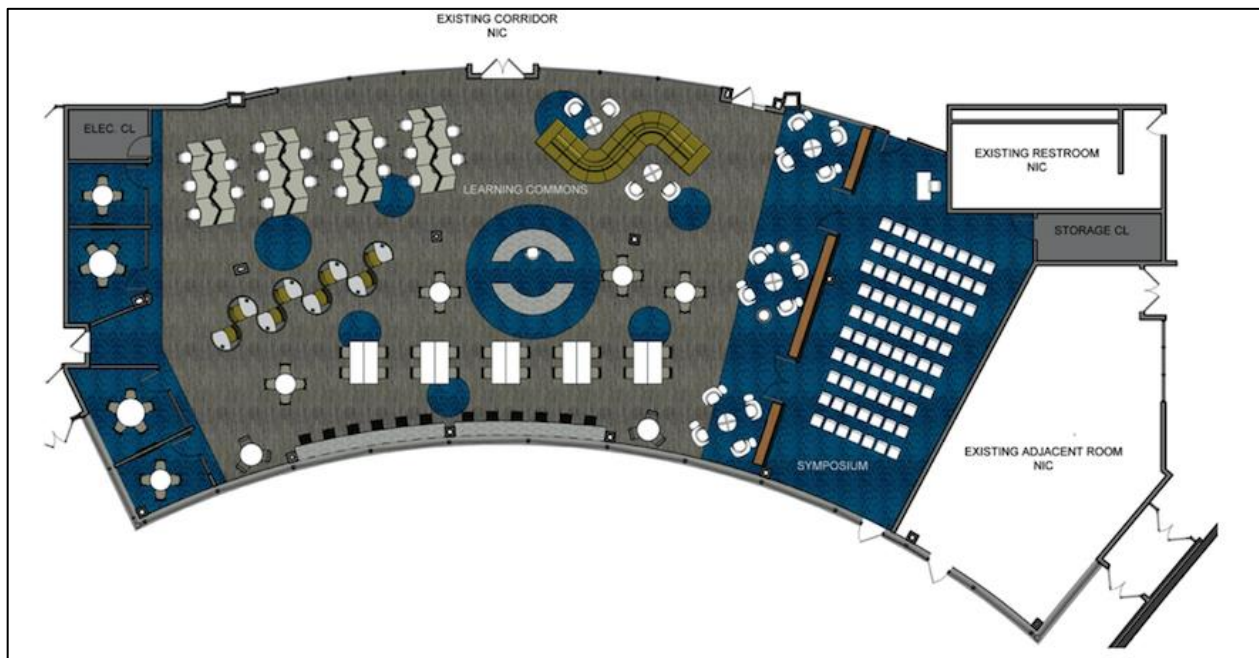

GEORGE WASHINGTON CARVER  
**Engineering and Science**  
HIGH SCHOOL · MIDDLE SCHOOL

Carver Engineering and Science is a selective-admissions, college-preparatory public school serving 900 students in grades 7-12. Our academically talented student body comes from a diverse, mostly underrepresented, population living in all areas of the city. 100% of our students are accepted to college every year with *67% of our students aiming to be the first in their family to graduate from college*. Our students choose from a range of options from community college to our nation's most prestigious schools. Our alumni post-secondary graduation rate exceeds the national average and changes the life trajectory for our students.

### Carver Commons



To continue to propel our college success environment, we are redesigning our existing library from an outdated, underutilized space void of a librarian to a **vibrant learning commons**.



This space will offer our students:

- Center for inquiry-based learning
- Hub for scholarly research
- Full service Writing Center
- Collaborative work spaces
- Individual study areas
- Symposium area for larger presentations

The Carver Commons will support our mission of creating a *transformative educational experience* for our students through introducing them to a collegiate setting with embedded supports.

Please join us in making this space a reality for our students. Visit [hses.philasd.org/CarverCommons](https://hses.philasd.org/CarverCommons).