

Penn Alexander Capital Campaign for Community Field and Fitness

Estimated Cost \$500,000

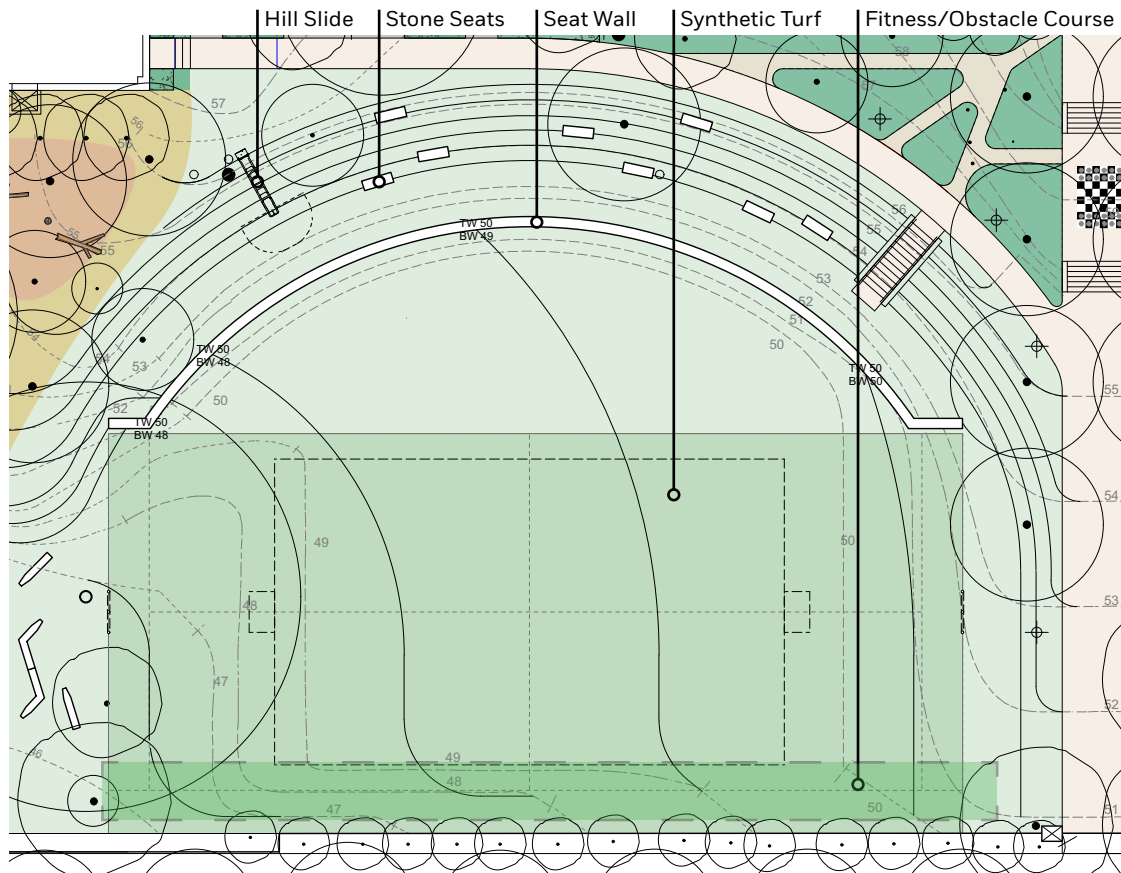



Field

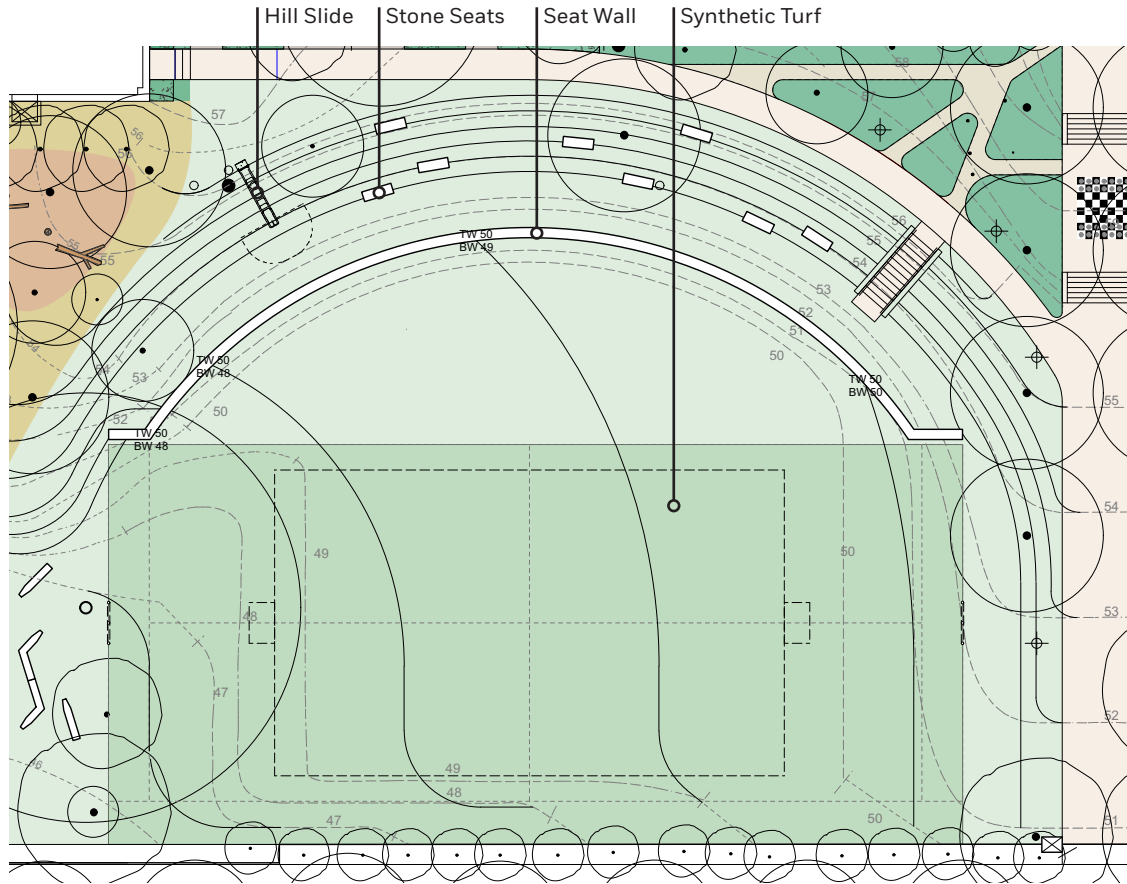

SYNTHETIC TURF

SOIL TURF

PRO's

Low maintenance	Soft grass
No field time lost	
Great drainage	
Low annual cost	
No fertilizer needed	
No bees	

CON's

Expensive up-front cost	Regular maintenance and cost required
Not as soft as grass	Fertilizer required (can be organic)
No dogs allowed - will need to put up signs or control access; may need to flush the field sometimes	Must aerate and reseed annually
Seams may show over time with great use	Irrigation required
Repair may be needed from time to time	Field use may be limited for maintenance
	Field use is dependent on weather
	Annual maintenance cost: \$17,000





The field is regraded and converted to synthetic turf. This space is very clearly the core of student recess activity. Striping the field and offering smaller side fields will allow multiple game types to happen at once. A new seat wall both helps maintain the grade and offers seating. A hill slide aids in some of the more imaginative renditions of tag we heard about from many students.

Fitness Equipment

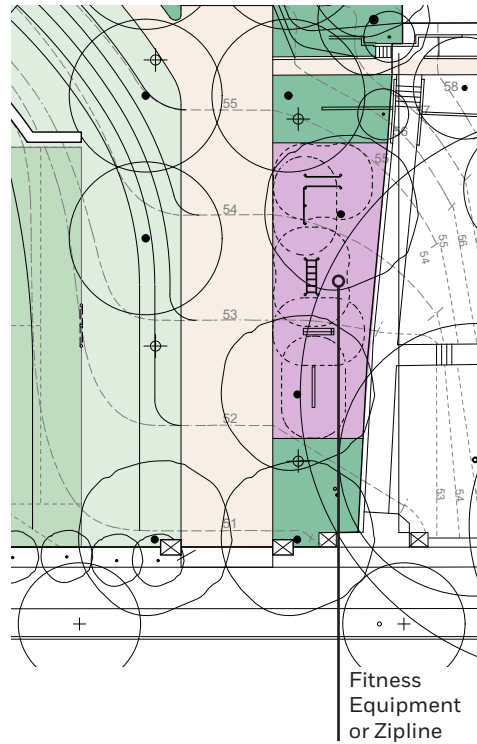

Proposed fitness equipment.



Alternatively, a zipline would fit in this space.